

ACCESS TO COMPOUND A1

**KEY:**

- VEHICLE TRACKING
- HIGHWAY BOUNDARY
- PROPOSED ROAD EDGE

**VEHICLE DETAILS**

MAX LEGAL LENGTH (UK) ARTICULATED VEHICLE (16.5m)

OVERALL LENGTH	16.500m
OVERALL WIDTH	2.550m
OVERALL BODY HEIGHT	3.681m
MIN BODY GROUND CLEARANCE	0.411m
MAX TRACK WIDTH	2.500m
LOCK TO LOCK TIME	6.00s
KERB TO KERB TURNING RADIUS	6.530m

**NETWORK RAIL (EAST WEST RAIL WESTERN SECTION PHASE 2)**

**NOTES:**

1. THIS DRAWING IS NOT TO BE SCALED.
2. ALL DIMENSIONS ARE IN METRES (m) UNLESS SHOWN OTHERWISE.
3. VEHICLE TRACKING IS UNDERTAKEN WITH COMPUTER MODELLING SOFTWARE AND IS BASED ON IDEAL SITUATIONS WHERE REAL WORLD OBSTRUCTIONS ON THE ROAD NETWORK SUCH AS PARKING OR LOADING ACTIVITY WOULD NOT HAVE BEEN FORESEEN.
4. THE MODELLING IS BASED IN 2D PLAN WHERE SWEEPED PATHS ARE INFLUENCED BY ANTICIPATED MOVEMENTS AND THEREFORE LEAD TO IDEAL APPROACH ANGLES, WHICH MIGHT NOT BE OBVIOUS IN REALITY.
5. APPROACH SPEEDS, APPROACH ANGLES, ROAD SURFACE, WEATHER CONDITIONS AND TYRE WEAR ARE ALL FACTORS THAT WILL INFLUENCE VEHICLE PATHS.
6. THE COMPOUND ACCESS IS INTENDED FOR TWO WAY VEHICLE IN AND OUT.
7. JUNCTION INTERVISIBILITY ZONE IN ACCORDANCE WITH DMRB TD50.

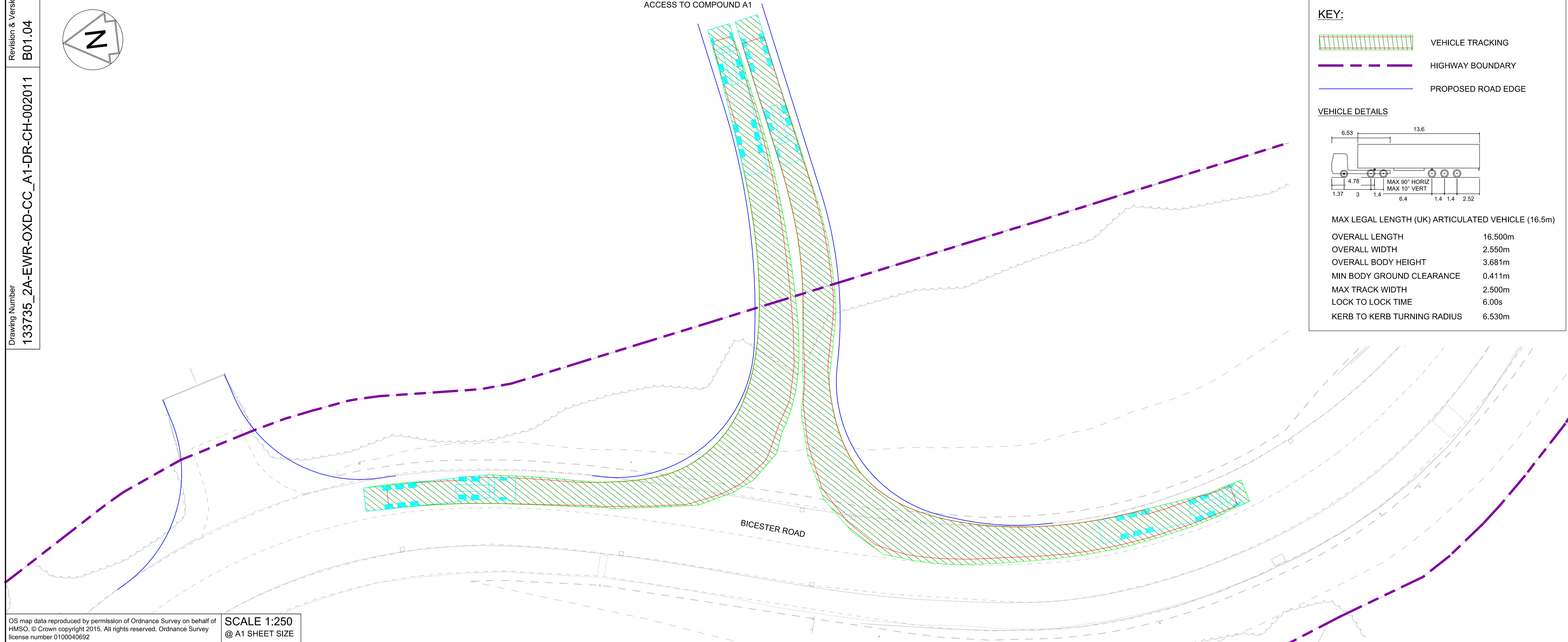

OS map data reproduced by permission of Ordnance Survey on behalf of HMSO. © Crown copyright 2015. All rights reserved. Ordnance Survey license number 0100040692

SCALE 1:250  
@ A1 SHEET SIZE

ACCESS TO COMPOUND A1

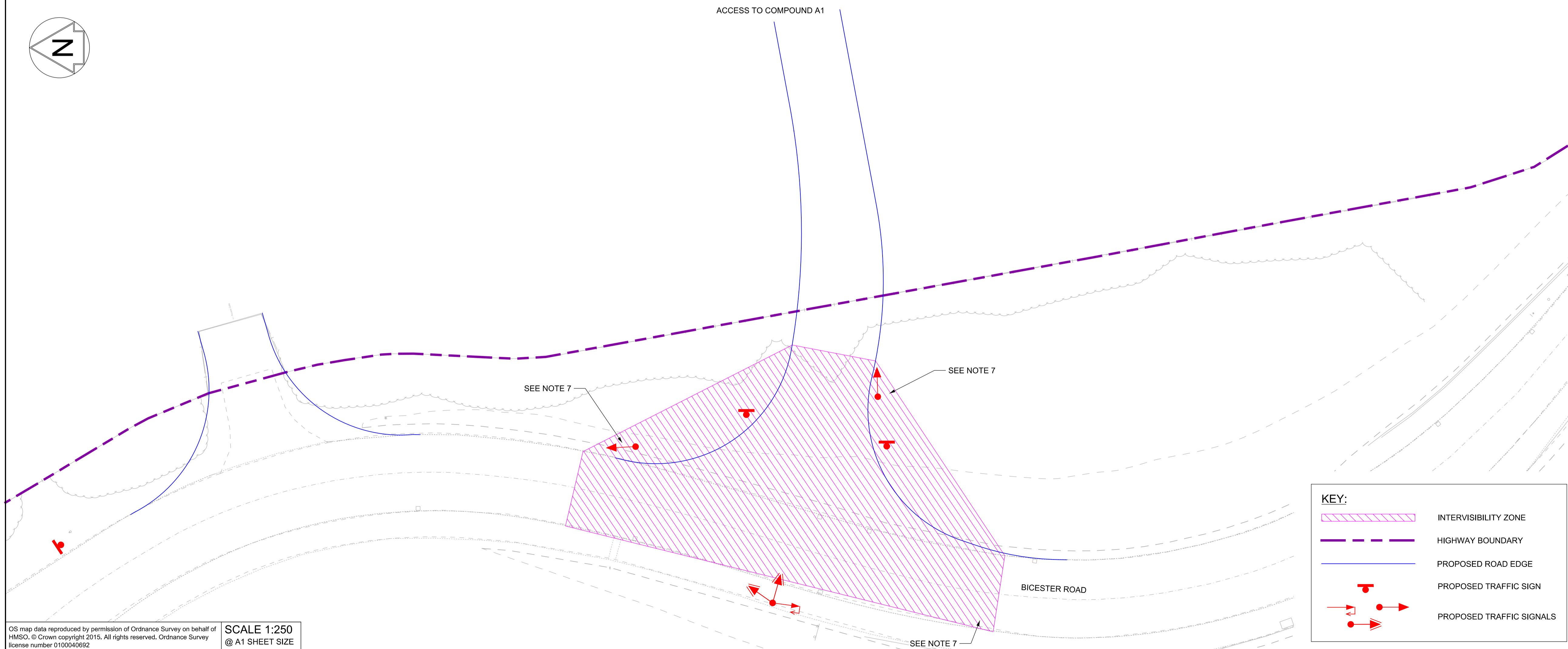

OS map data reproduced by permission of Ordnance Survey on behalf of HMSO. © Crown copyright 2015. All rights reserved. Ordnance Survey license number 0100040692

SCALE 1:250  
@ A1 SHEET SIZE

**KEY:**

- INTERVISIBILITY ZONE
- HIGHWAY BOUNDARY
- PROPOSED ROAD EDGE
- PROPOSED TRAFFIC SIGN
- PROPOSED TRAFFIC SIGNALS

Rev	Date	Description of Revisions	Desd	Chkd	Appr	T.L.	G.J.	E.F.
B01	24/05/19	FOR INFORMATION						

Status: **SHARED - for Content Check** Suitability: **S1**



Project  
**East West Rail (Western Section) Phase 2**

Drawing Title  
**ACCESS TO COMPOUND A1 VEHICLE SWEEPED PATH ANALYSIS AND INTERVISIBILITY ZONE**

Designed	Tamsin Leaman-Hewitt	Signed	Leaman-Hewitt	Date	24/05/19
Drawn	Ravikumar KN	Signed	R. KN	Date	18/12/18
Checked	Gareth Johnston	Signed	G. Johnston	Date	24/05/19
Approved	Edward Findlay	Signed	E. Findlay	Date	24/05/19

Scale(s)  
1:250  
ELR - Project Chainage (Miles Yards)  
OXD - 108820

Design Package Risk Classification  
**Normal**

Alternative Reference  
Revision  
B01

Drawing Number  
133735\_2A-EWR-OXD-CC\_A1-DR-CH-002011