

Scale 1:75 @ A1

**Notes**

All furniture shown for information only.  
Do not scale from drawing.

Standard stair pod footprint is 2.4x4.8m  
Stair pod roof sizes vary from partial  
(2.4x1.2m\*) to full coverage (2.4x4.8m\*).  
\*approximate dimensions

All standard fitted floor covering is vinyl.  
Carpet can be quoted on request on a m<sup>2</sup>  
basis.

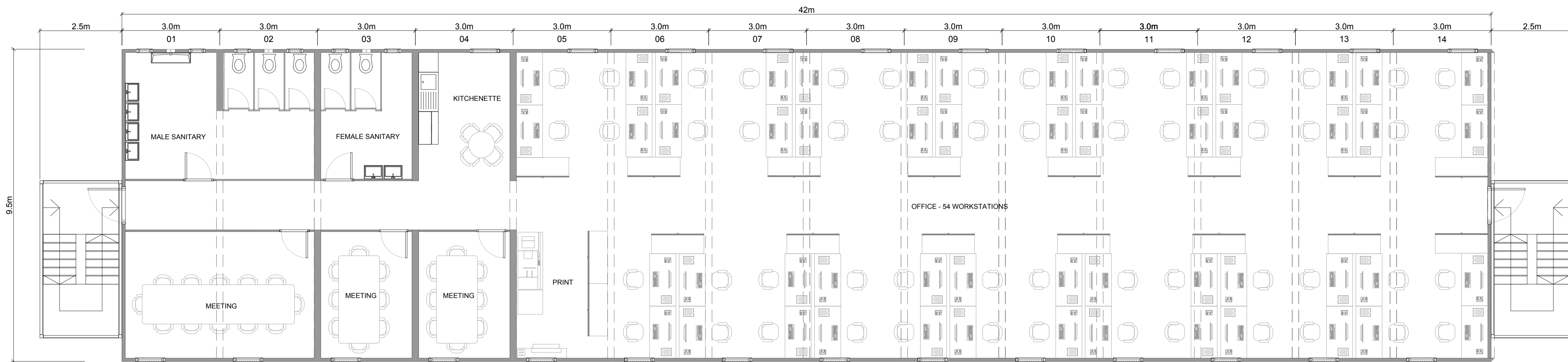

SECOND FLOOR

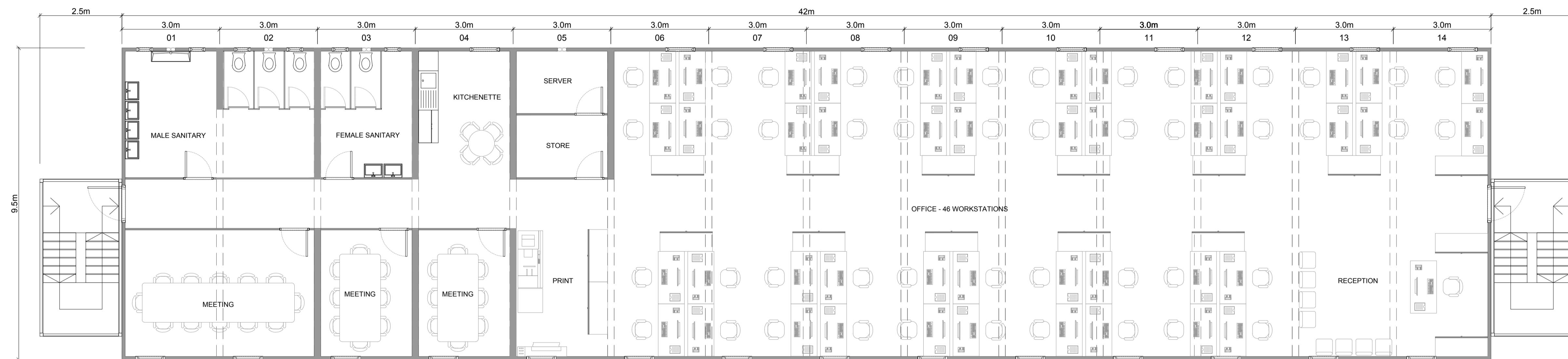

FIRST FLOOR

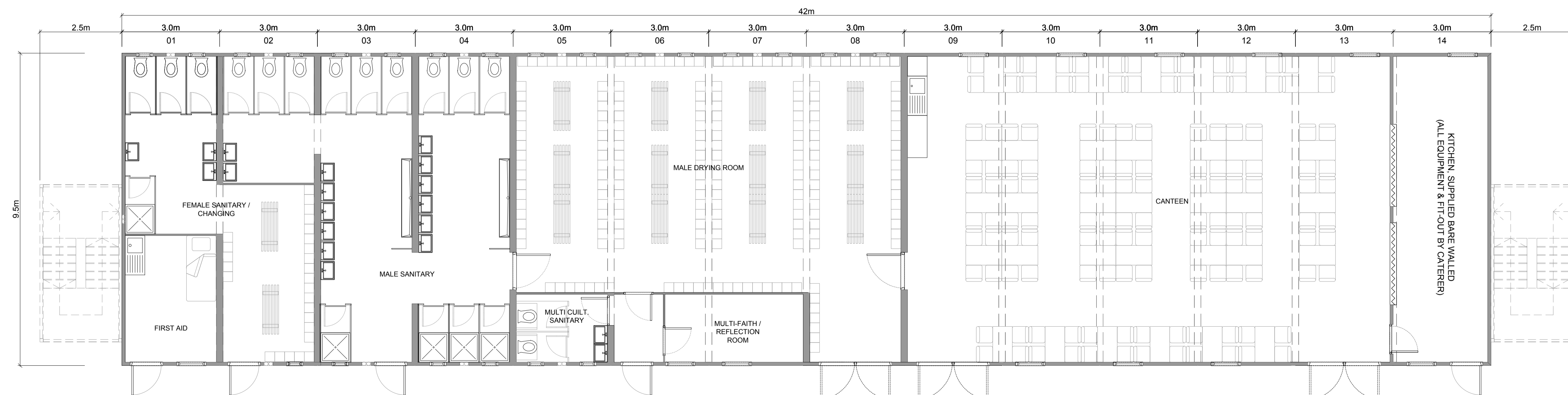

GROUND FLOOR



Select Plant Hire Company Ltd.

Site/Project	Date	Drawn	Approval Signature	Drawing status	Rev Description	Date	Rev
EWR - SITE A1 LAYOUT	16/7/18	CA			Amended to suit comments drawn by TT	28/4/19	B