

NOTES

- Building Drainage**
- All connections to adoptable manholes from private building drainage to be 150mm diameter pipes unless otherwise specified.
 - All house drainage to be 100mm dia unless otherwise stated, and laid in accordance with current Building Regulations and BS8301 : 1985.
 - All private drainage products are to be Polypipe or similar approved.
 - Pipe bedding material is to be Class 5 with 150mm minimum thickness surround.
 - Backfill is to be with selected fill free of stones larger than 40mm, lumps of clay over 100mm, timber, frozen material and vegetable matter.
 - Pipe protection of house drainage runs is required in accordance with the Typical House Drainage Details drawing. The contractor shall satisfy themselves and agree with the Site Management the actual extent of pipe protection required.
 - Pipes entering and leaving manholes/inspection chambers shall include a rocker pipe, 600mm in length.
 - Brickwork to chambers shall be Class B Engineering to BS3921.
 - Rainwater pipes are to be sited on side elevations whenever possible.
 - All retaining walls with a height of 600mm or greater are to include 1.2m high post and rail fencing unless located in rear gardens. Similar retaining walls in rear gardens are to include 900mm height picket fence.
 - All flights of steps to primary level access, with more than 2 steps are to be provided with handrailing, except where the steps are 900mm are more apart.
 - Drainage and road design subject to Water and Highway Authority approval.
 - Edge restraint to private/blockwork - 2 stretcher course (unless noted otherwise).



NOTES

- Contractors must check all dimensions on site. Only figured dimensions are to be worked from. Discrepancies must be reported to the architect or engineer before proceeding. © This drawing is copyright.
- Reproduced from OS Sitemap © by permission of Ordnance Survey® on behalf of The Controller of Her Majesty's Stationery Office. © Crown copyright 2008. All rights reserved. Licence number 100007126.
- Until technical approval has been obtained from the relevant authorities, all drawings are issued as preliminary and not for construction. Should the contractor commence site work prior to approval being given it is entirely at his own risk.

KEY



- Adoptable Foul Sewer
- Adoptable Surface Water Sewer
- Private Foul I.C. (450mm dia.)
- Private Surface Water I.C. (450mm dia.)
- Rodding Eye

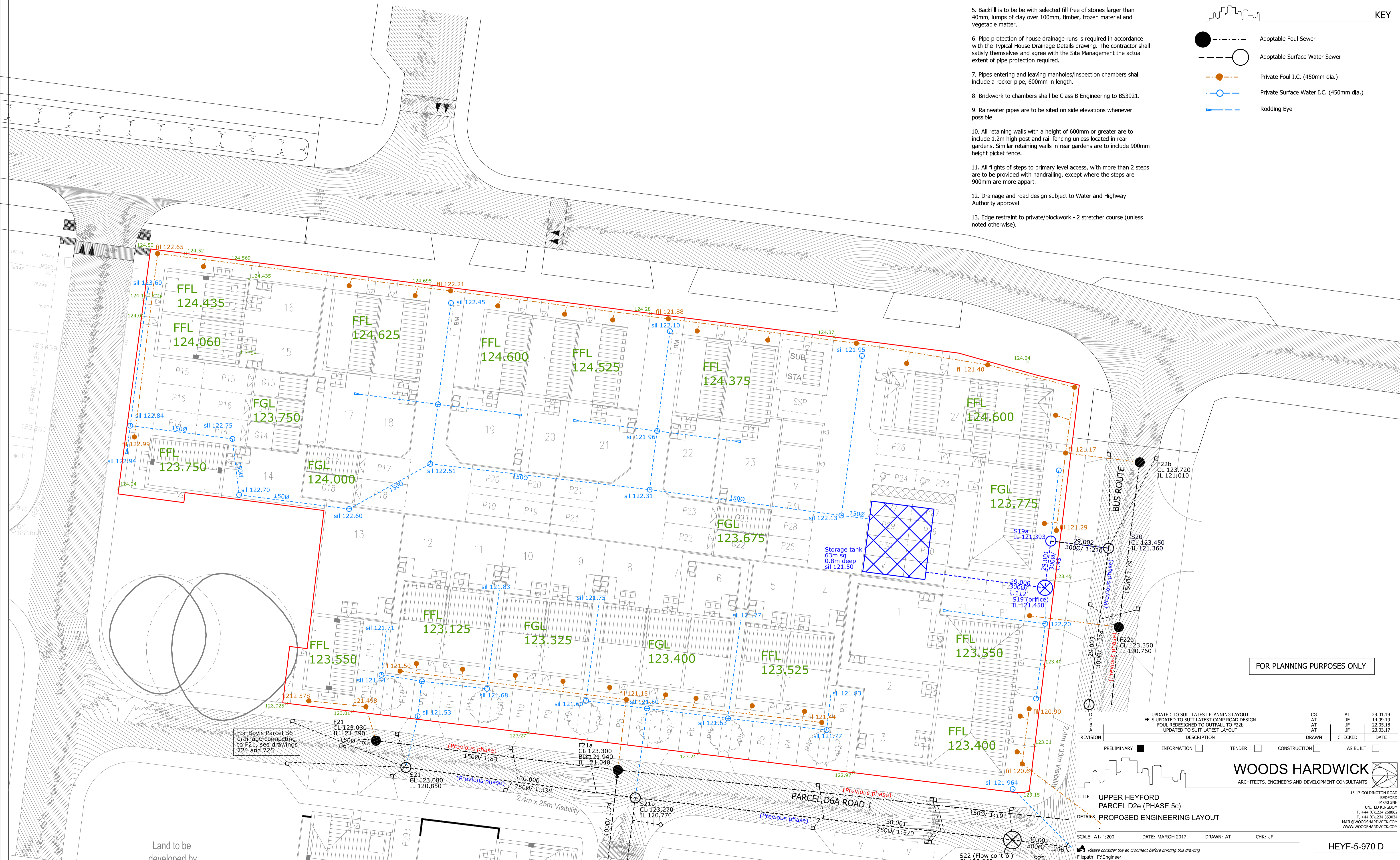

FOR PLANNING PURPOSES ONLY

UPDATED TO SUIT LATEST PLANNING LAYOUT
 FFLS UPDATED TO SUIT LATEST CAMP ROAD DESIGN
 FOUL REDESIGNED TO OUTFALL TO F22b
 UPDATED TO SUIT LATEST LAYOUT

REVISION	DESCRIPTION	CG	AT	DATE
		CG	AT	29.01.19
		AT	JF	14.09.19
		AT	JF	22.05.18
		AT	JF	23.03.17

PRELIMINARY
 INFORMATION
 TENDER
 CONSTRUCTION
 AS BUILT

WOODS HARDWICK
 ARCHITECTS, ENGINEERS AND DEVELOPMENT CONSULTANTS

TITLE: UPPER HEYFORD PARCEL D2e (PHASE 5c)
 DETAILS: PROPOSED ENGINEERING LAYOUT
 SCALE: A1-1:200 DATE: MARCH 2017 DRAWN: AT CHK: JF

S22 (Flow control) CL 122.960 IL 120.690
 S23 CL 123.070 IL 120.770

Please consider the environment before printing this drawing
 Filepath: F:\Engineer

15-17 GOLDINGTON ROAD
 BEDFORD MK40 3RH
 UNITED KINGDOM
 T: +44 (0)1234 268862
 F: +44 (0)1234 353034
 MAIL@WOODSHARDWICK.COM
 WWW.WOODSHARDWICK.COM

HEYF-5-970 D

For Bovis Parcel B6 drainage connecting to F21, see drawings 724 and 725

Land to be developed by