

NORTHERN EXTENT @ 1:1250 SCALE

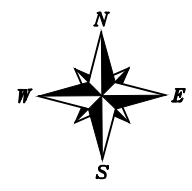

SITE ACCESS JUNCTION @ 1:1250 SCALE



- NOTES**
- THIS IS NOT A CONSTRUCTION DRAWING AND IS FOR INDICATIVE PURPOSES ONLY. IT IS SUBJECT TO FURTHER DESIGN ANALYSIS, TOPOGRAPHICAL MAPPING & HIGHWAY/THIRD PARTY LAND BOUNDARIES.
- INDICATIVE SITE BOUNDARY
 - DENOTES NEW KERBS
 - EXISTING ADOPTED HIGHWAY (BASED ON OS)
 - DENOTES NEW 0.5M VERGE
 - EXISTING DRIVEWAY

2M FOOTWAY/PED REFUGE WITH POTENTIAL BUS STOP LOCATIONS @ 1:500 SCALE

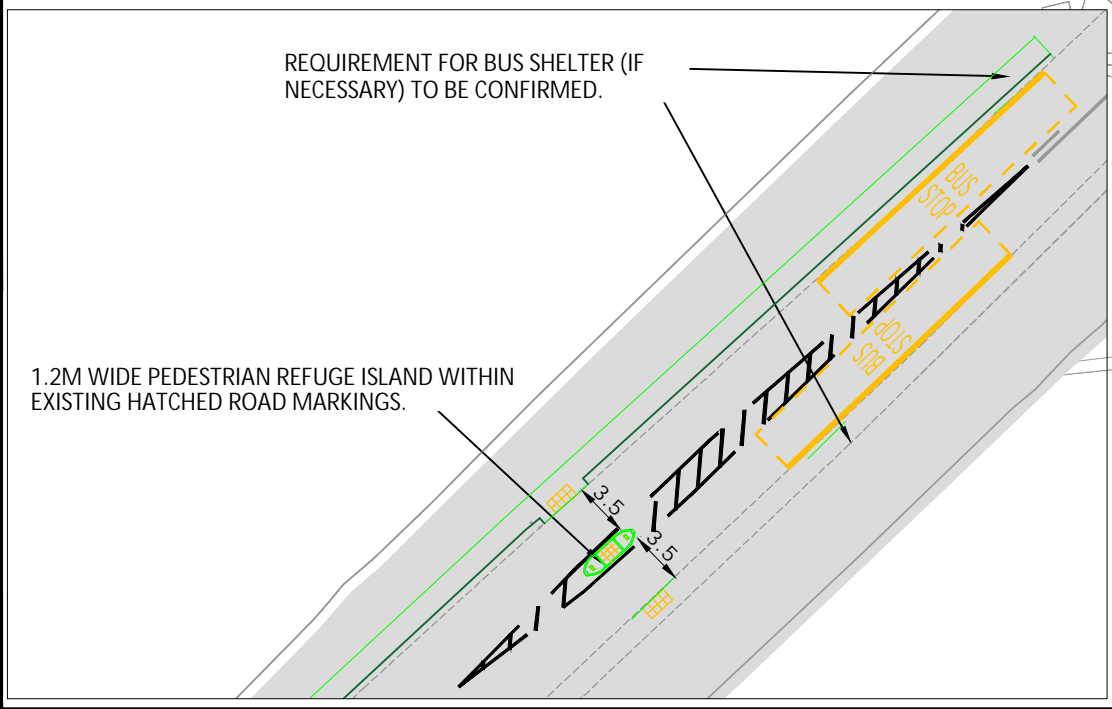

G	1.5M FOOTWAY 0.5 VERGE ADDED	LB	JC	NOV 19
F	EXTRA OS ADDED	LB	MC	OCT 19
E	BASED ON OS PLAN	LB	JC	AUG 19
D	BUS STOPS ADDED	LB	MC	JUL 19
C	DESIGN BASED ON FULL TOPO SURVEY	JC	PJW	APR 18
A	ACCESS LOCATION MOVED NORTH	JC	PJW	SEP 17
REV.	DETAILS	DRAWN	CHECKED	DATE

CLIENT:
HOLLINS STRATEGIC LAND

PROJECT:
BERRY HILL ROAD, ADDERBURY

DRAWING TITLE:
PROPOSED HIGHWAY IMPROVEMENT PLAN (ON OS BASE)

SCALES:
1:2000 @ A3

DRAWN:	JC	CHECKED:	PJW	DATE:	SEP 17
--------	----	----------	-----	-------	--------

9 Jordan Street,
Manchester,
M15 4PY

croft
Transport Solutions

Email: info@crofts.co.uk
Tel: 0161 667 3746
Web: www.crofts.co.uk

DRAWING NUMBER:	1899-F01	REVISION:	G
-----------------	-----------------	-----------	----------

Z:\projects\1899 Berry Hill Road, Adderbury\CAD\Croft Drawings\1899-F01 REV G.dwg