

THIS WORKING DRAWING IS TO BE READ IN CONJUNCTION WITH THE CREST STANDARD CONSTRUCTION NOTES AND THE STANDARD WORKMANSHIP AND MATERIALS SPECIFICATION

## RISK SCHEDULE

ITEM	DESCRIPTION OF RISK & ACTION
	Risk - Handling of large / heavy flat gauge liner Action - A method statement to be provided by supplier and approved prior to commencement on site

### WINDOW NOTE:

- All external glazing to be double glazed sealed units
- Purge ventilation to be provided to all habitable rooms at a rate of not less than 1/20th room floor area when window opens 30deg or more. Windows that open less than 30deg should be at least 1/10th of the floor area of the room.
- Background ventilation to be in accordance with trickle vent sizes specified on structural plans
- All glazing located within a door or side light within 1500mm above floor level and 300mm either side of the door shall be carried out using toughened glass. All glazing to ground floor windows and those above porches/bays to be toughened or laminated.
- Any window or glazed panel within 800mm above floor level shall be carried out using safety glass as defined in BS5262 part 4 1994 and BS6206 1981.
- Cavity trays to be used over lintels, architraves, meter boxes, horizontal fire cavity barrier, porch/canopy roofs, walls and roof abutments or as otherwise noted on drawings. A cavity tray or DPC should also be installed under stone sills. All cavity trays to have 150mm stop ends with Pylons Ryweep clear cavity weep vents (2 no. minimum per tray) at 450mm centres in outer leaf. Refer to Crest Nicholson standard construction notes 2013.

### First Floor Construction

- Decking to be 22mm tongue and grooved moisture resistant chipboard decking glued and nailed to timber joists.
- Joists (240mm thick) to be installed at a maximum 600mm centres in accordance with specialist designs and supported on uncut internal load bearing block work and coursed onto joist or hangers to external walls. Holes and notching to be carried out in accordance with manufacturers written instructions. Lining to underside of joists to be 15mm plasterboard to achieve 30mins fire resistance.

### Ground Floor Construction

- 75mm thick sand cement of C35 concrete screed reinforced with galvanised A142 mesh on packer feet on 600g gas barrier membrane on insulated all-in-one thermal floor system with non structural topping.
- Beams to be laid on DPC on load bearing walls.
- Provide a minimum 250mm ventilated void below insulation depth to suit site ground conditions.
- Refer to site specific details for variation to this specification where Radon protection is required.

### Roof Construction

- Approved concrete interlocking or non-interlocking tiles/slates on John Brash JB red pre-graded roof battens on Proctor roofshield membrane. All on specialist manufactured 38mm min. trussed rafters set at maximum 600mm centres, or traditional cut & pitch loose-fill timbers set at max. 600mm c/s. Trusses to be mechanically fixed to 100x50mm C16 lanalised sw wallplates (bedded on mortar).
- Roofshield to be dressed down over Klobber underlay support tray used as eaves carrier. Eaves fascia to be painted Timber.
- Underside of trusses & associated infill ceiling joists to be lined with 12.5mm Knaurf Wallboard.
- Roof insulation to generally consist of 3 No. layers of Krauf Earthwood Loft Roll 44 (0.044W/mK) to BS EN 13162:2012 laid cross ply 400mm thick. The first 100mm layer being laid between the ceiling joists/trusses, the second layer of 200mm being laid across the ceiling joists/trusses and the third 100mm layer at right angle to the preceding layer

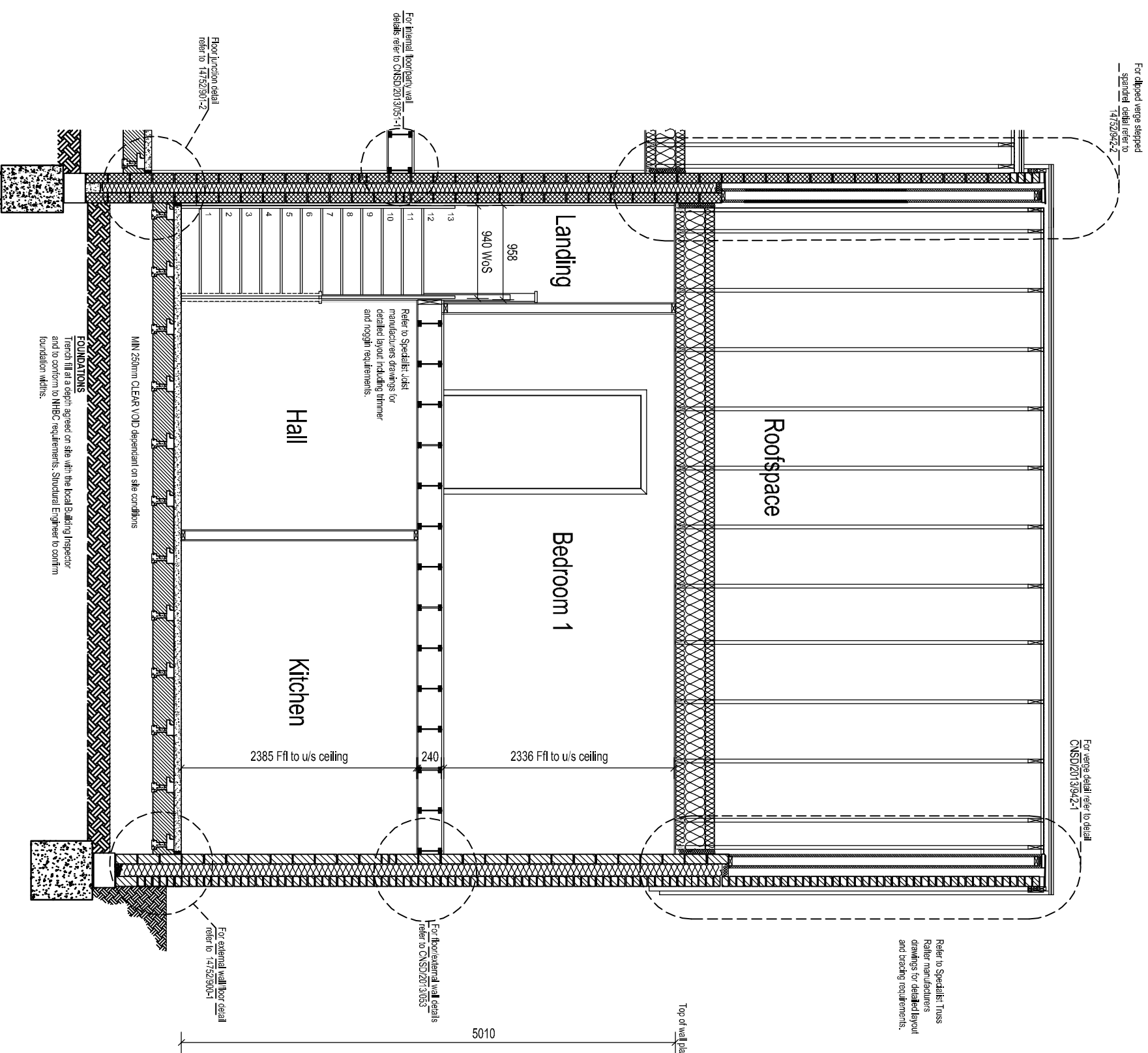

## SECTION B-B

AS: 60	BRICK
--------	-------

<p>C1 CONSTRUCTION ISSUE</p> <p>T1 TENDER/SUE</p> <p>Rev. Description.</p>		<p>30.09.19 LMB</p> <p>17.05.19 DLR</p> <p>Date. Initial.</p>
<p>Drawing Status: CONSTRUCTION</p>		
<p><b>CREST NICHOLSON Ltd.</b></p> <p>Pacific House Relay Point Wiltneocle Tamworth B77 5PA</p> <p>www.crestnicholson.com</p>		
Site:	CONSTRUCTION	Unit Size 114 m <sup>2</sup> 1227 ft <sup>2</sup>
House Type:	AH2B WC	
Dwg Title:	SECTION B-B	
Scale:	1:50	
Page Size:	A3	Date: MAR 19
Drawn:	OR	Checked: DL
Drawing No:	14752-HMA-AH2BWC-SEC-A-1026	Revision: C1