

Manhole Schedule:

SWMH01	100.201	100.900	0.699	0.450	D400
SWMH02	98.653	99.550	0.897	0.450	D400
SWMH03	97.220	97.850	0.630	0.450	D400

NOTES:

1. DO NOT SCALE - Use figured dimensions only.
2. All dimensions shown are in millimetres unless otherwise stated.
3. All levels are in metres above ordnance datum unless otherwise stated.
4. The Contractor is to verify all dimensions on site before commencing work.
5. This drawing is to be read in conjunction with all Engineers and Architects drawings.
6. Site investigation indicates infiltration rate is 0.05705 m/hr
7. All surface water inspection chambers to have 300mm silt trap sump.
8. All surface water drainage pipes to be 150mm diameter.
9. Surface water drainage pipes to be laid at a gradient no less than 1:150.
10. See typical section through infiltration basin on drawing FEDS-218132-002.
11. Exceedance flow routes identified by blue arrows.
12. See SuDS Calculations for Short-Term and Long-Term maintenance schedule.

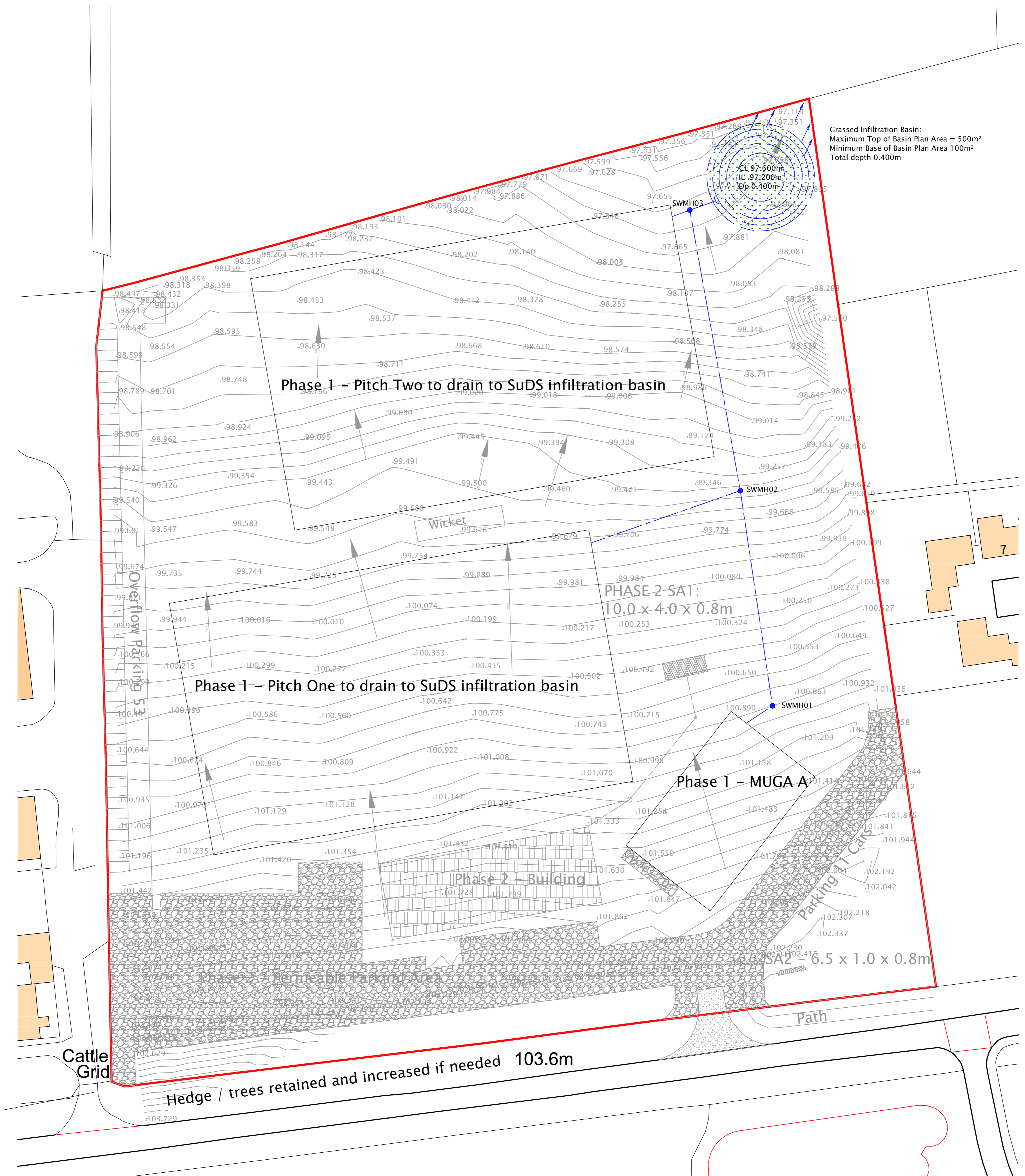

Client:
Adderbury Parish Council

Project:
Proposed Recreation Ground Land Off
Milton Road, Adderbury, Banbury OX15

FEDS-218132

Title:
Phase 1 - Sports Pitches' Sustainable Drainage System Layout

Drawn by: AK	Checked by: DKP	Size: A1
Date: 27.11.18	Scale: 1:500	
Dwg.no: 218132-001	Rev: A	

Forge Engineering Design Solutions
Forge House
30 Digging Lane
Fyfield, Abingdon
Oxfordshire, OX13 5LY
tel: 01865 362 780
info@f-eds.co.uk
www.f-eds.co.uk