

**01** Boundary Railing detail to different Level change greater than 600mm scale 1:20

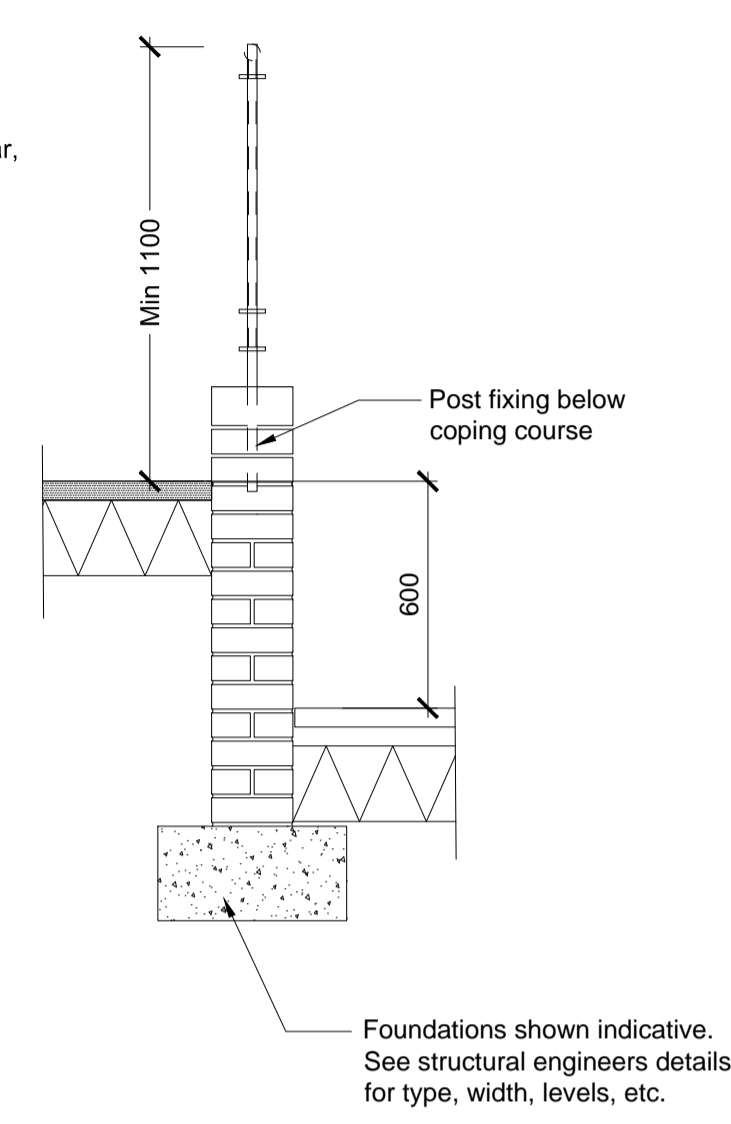

**03** Bekstone boundary wall scale 1:20

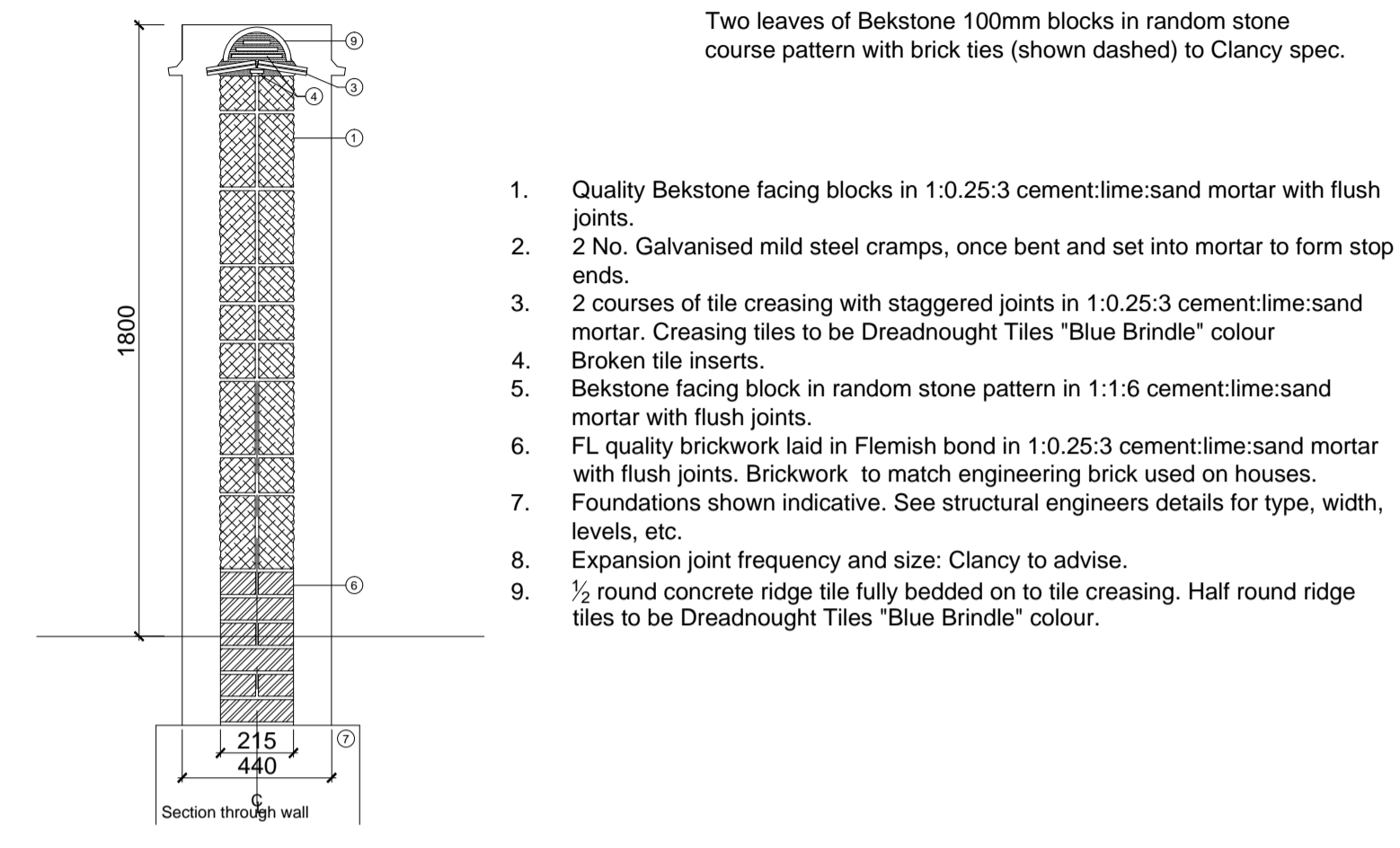
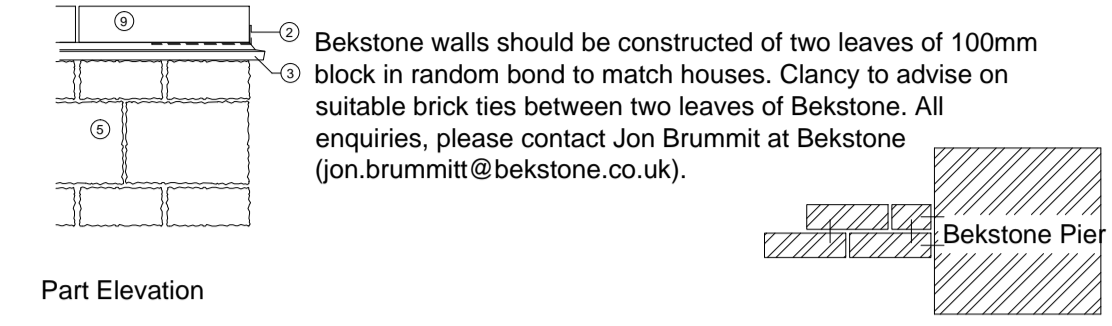

- Quality Bekstone facing blocks in 1:0.25:3 cement:lime:sand mortar with flush joints.
- 2 No. Galvanised mild steel cramps, once bent and set into mortar to form stop ends.
- 2 courses of tile creasing with staggered joints in 1:0.25:3 cement:lime:sand mortar. Creasing tiles to be Dreadnought Tiles "Blue Brindle" colour
- Broken tile inserts.
- Bekstone facing block in random stone pattern in 1:1:6 cement:lime:sand mortar with flush joints.
- FL quality brickwork laid in Flemish bond in 1:0.25:3 cement:lime:sand mortar with flush joints. Brickwork to match engineering brick used on houses.
- Foundations shown indicative. See structural engineers details for type, width, levels, etc.
- Expansion joint frequency and size: Clancy to advise.
- 1/2 round concrete ridge tile fully bedded on to tile creasing. Half round ridge tiles to be Dreadnought Tiles "Blue Brindle" colour.

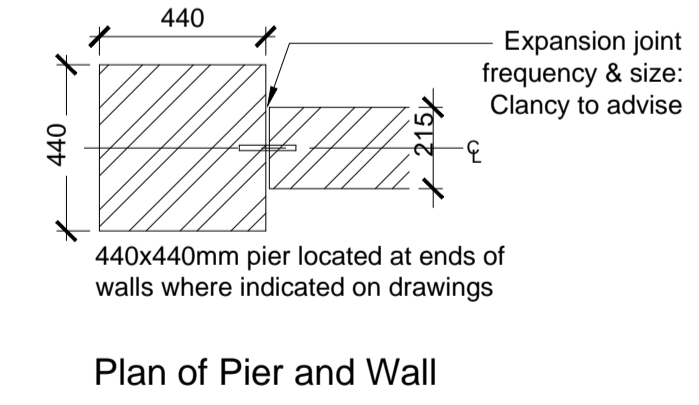
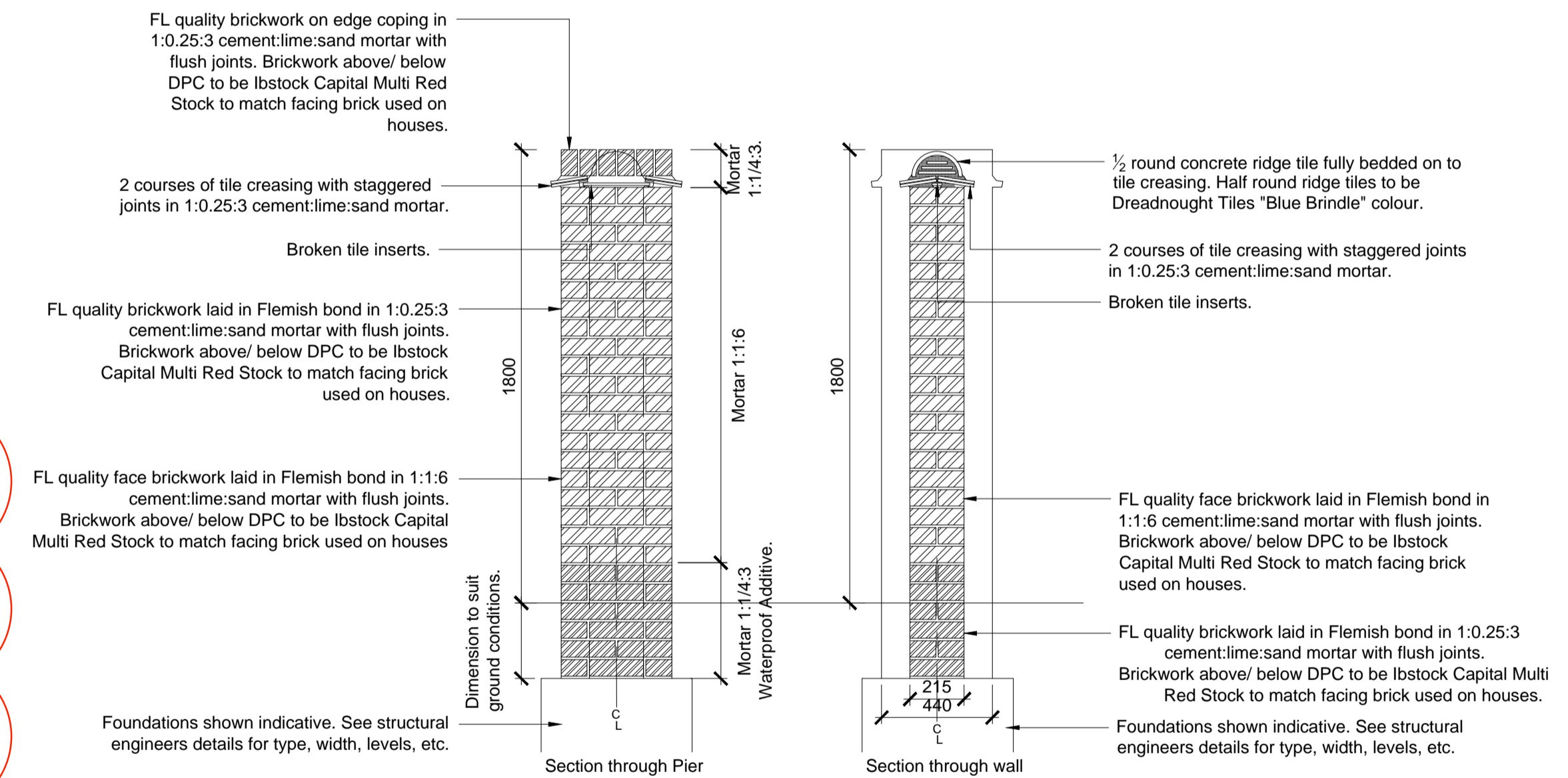

**04** Boundary Wall detail scale 1:20

NOTE:  
 1 1/2 brick thickness required for 1800mm high wall as worse case scenario unless structural engineer can prove otherwise.  
 Refer to:  
 "Your Garden Walls" - Better to be Safe (DCLG) and BRE GBG 14 (May 1994).

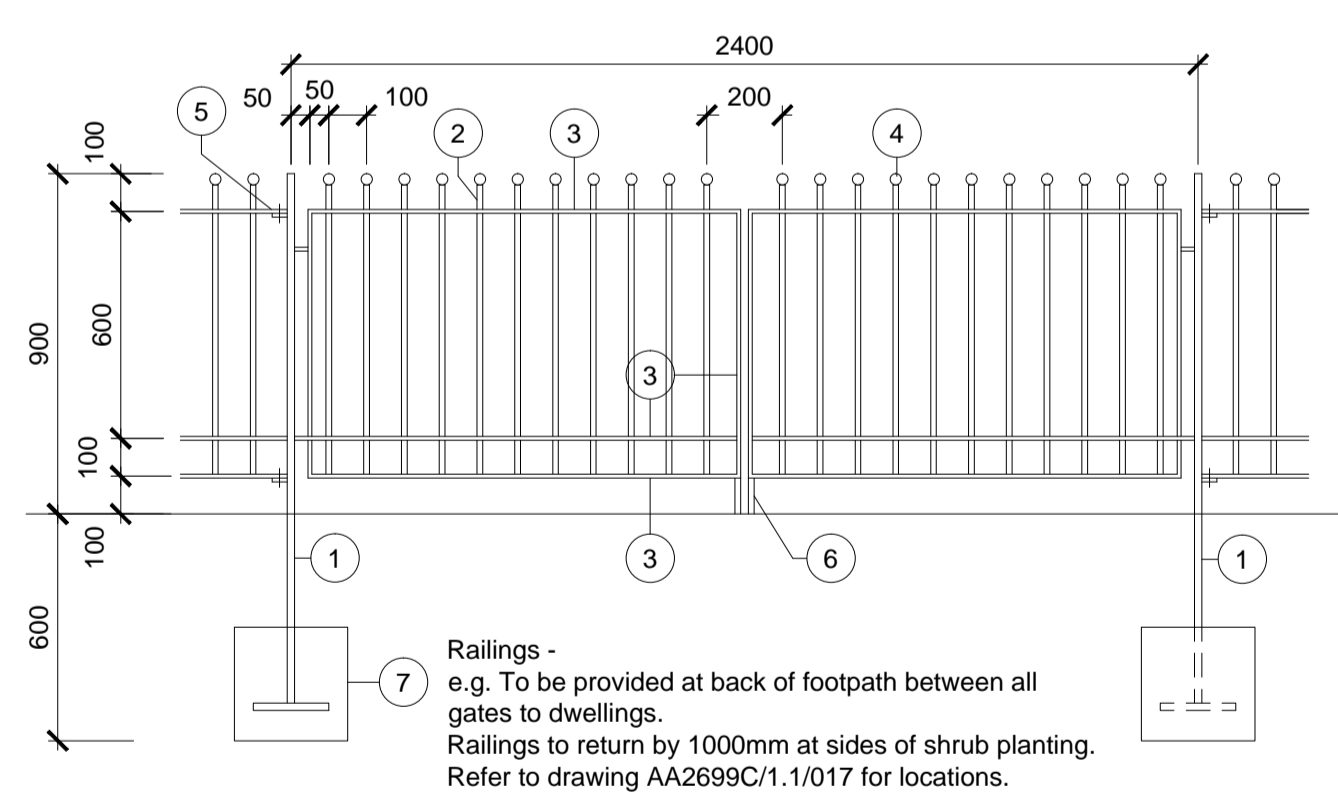

**02** Boundary Railing detail to front gardens scale 1:20

- Fencing to conform to BS 1722: Part 9: 1992
- 50 x 20mm galvanised steel end bar, painted black.
  - 15mm diameter galvanised steel bar, painted black.
  - 50 x 10mm galvanised steel flat bar, painted black.
  - 30mm diameter galvanised steel spheres, painted black.
  - 40 x 10mm galvanised steel fishplate, painted black.
  - Car park gates to be fitted with drop bolts, with sockets at both the open and closed positions. Drop bolts to incorporate a hasp locking device.
  - Straining posts shall be set in the ground to a depth of 0.6m for fences 0.9m high. Posts shall be set in concrete foundations at least 0.45m x 0.45m in plan.
- All hinge and bolt/catch mechanisms to gates to be agreed between manufacturer and architect.  
 All metal work to be galvanised steel with paint finish. Colour: Black. All similar to 'Ball-Top Railings' manufactured by Chiltern Lintels Ltd.  
 Refer to CCL drawing 3/9354/50 for foundation details.

Rev	Date	Description	Drawn	Checked
B	20.09.17	Drawing status updated	MQ	MQ
A	08.10.16	Detail 02 amended	TH	MQ
-	08.07.16	First Issue	TH	MQ

**Bicester Eco Town Exemplar Site Phase 2**  
 Site wide typical detail  
 Boundary details

**AL6157C\_3032** **REV B**  
 CONSTRUCTION

Drawn TH Checked MQ Date 18/03/16 Scale @ A1 1:20