

NOTES

- The contractor is responsible for checking dimensions, tolerances and references. Any discrepancy to be verified with the Architect before proceeding with the works.
- Where an item is covered by drawings to different scales the larger scale drawing is to be worked to.
- Do not scale drawing. Figured dimensions to be worked to in all cases.

The structural / civil engineering and other non-architectural information shown on this drawing is purely for co-ordination purposes only and in no way does it take on any responsibility or liability for MBA Ltd. For all detailed information relating to these items see the relevant consultants drawings and full design information.

Do not copy in full or in part without the expressed consent of MBA Ltd.

© MBA 2019

CDM Regulations 2015

ALL current drawings and specifications for the project must be read in conjunction with the Designer's Hazard and Environmental Assessment Record.

Use	Designation	Proposed by system	As specified (UK standard)	Minimum standard used	Minimum compression strength
Walls up to DPC	FL, FN, ML, MN	FL, FN, ML, MN	FL, FN, ML, MN	FL, FN, ML, MN	25
Walls up to DPC (sulphates in soils)	FL, FN, ML, MN	FL, FN, ML, MN	FL, FN, ML, MN	FL, FN, ML, MN	25
Concrete blocks	Min strength 20N/mm <sup>2</sup>	Min strength 20N/mm <sup>2</sup>	Min strength 20N/mm <sup>2</sup>	Min strength 20N/mm <sup>2</sup>	50
Block work	Min strength 7N/mm <sup>2</sup> and density greater than 1500kg/m <sup>3</sup>	Min strength 7N/mm <sup>2</sup> and density greater than 1500kg/m <sup>3</sup>	Min strength 7N/mm <sup>2</sup> and density greater than 1500kg/m <sup>3</sup>	Min strength 7N/mm <sup>2</sup> and density greater than 1500kg/m <sup>3</sup>	50

Brick/block type	Use/minimum standard of brick or block	
	Walls up to DPC	Walls up to DPC (sulphates in soils)
Clay bricks	FL, FN, ML, MN	FL, FN, ML, MN
Calcium silicate bricks	Class 3	Class 3
Concrete bricks	Min strength 20N/mm <sup>2</sup>	Min strength 20N/mm <sup>2</sup>
Block work	Min strength 7N/mm <sup>2</sup> and density greater than 1500kg/m <sup>3</sup>	Min strength 7N/mm <sup>2</sup> and density greater than 1500kg/m <sup>3</sup>

Notes: (M) If the site is wet or saturated at ground level use FL or FN bricks only.  
 (N) Denotes a minimum standard - higher classifications may be used.  
 (S) For Class 1 and Class 2 sulphates, check with manufacturers to confirm suitability of brick; for Class 3 sulphates, use engineering quality concrete bricks.  
 (A) Autoclaved aerated blocks with independent appropriate third party certification are acceptable.

**GROUND FLOOR BUILD-UP**  
**U- Value - 0.12w/m2K**

- 75mm min finishing screed topping.
- 100mm Cellotex XR4000 floor insulation or equal
- PA ration = 0.17
- 1200 min gauge DPM with 300mm laps and dressed up blockwork
- oversite slab - to SE spec and design
- heave protection to SE design
- 10mm Bridgestop Quilt with Bridgestop tie
- 3mm Bridgestop High Performance Membrane
- 195 Siliconized sealant by Sika or equal
- PFC - Corofill acoustic intumescent sealant

Plasterboard on 10mm dabs; continuous ribbon of adhesive to top and bottom of wall, around all openings (incl. elec. switches and sockets) and at internal corners. 3mm skim finish

Skirting - 19x94mm square edge rounded; screw fixed to blockwork

Flexible sealant applied between floor finish and skirting.

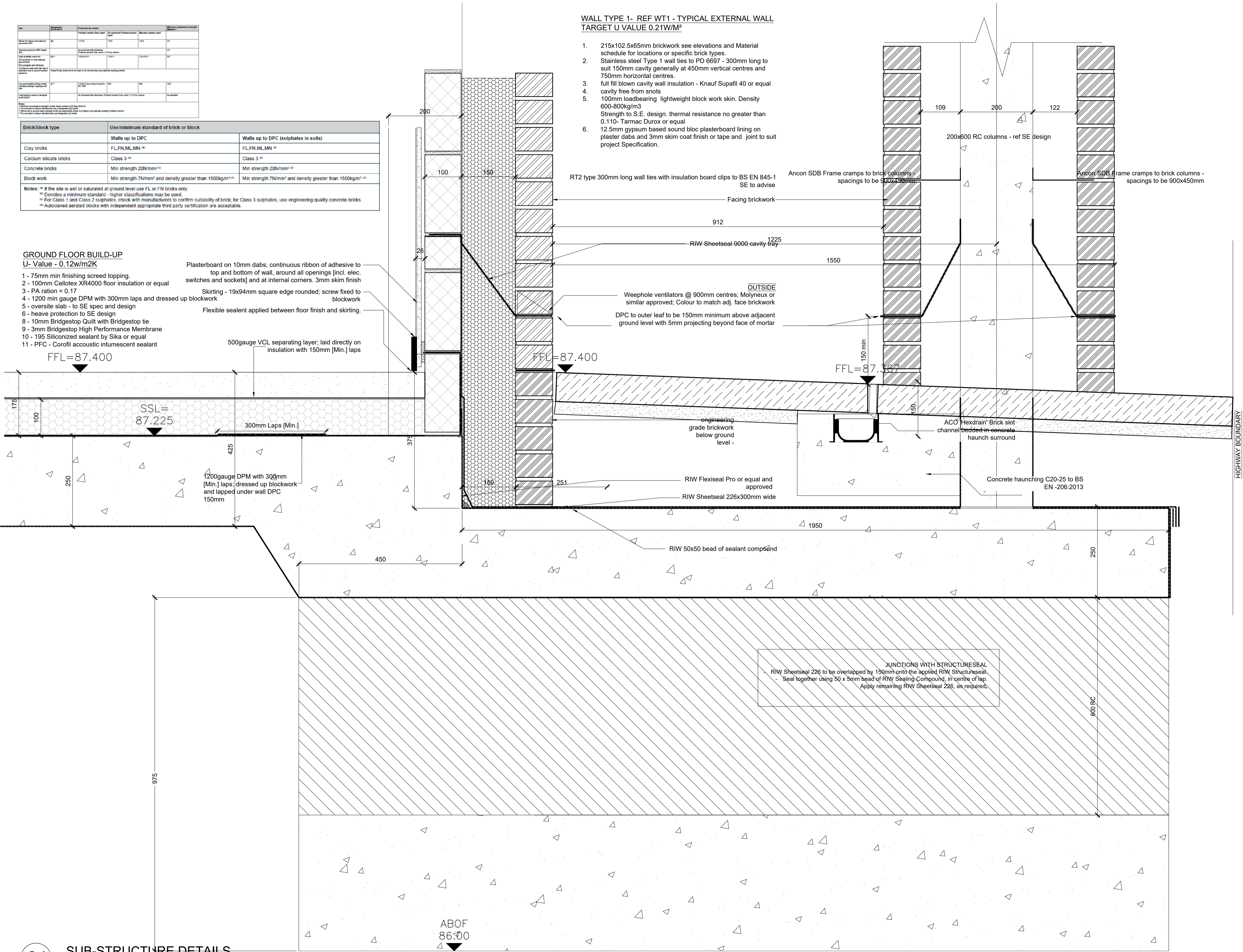

**WALL TYPE 1- REF WT1 - TYPICAL EXTERNAL WALL**  
**TARGET U VALUE 0.21W/M<sup>2</sup>**

- 215x102.5x65mm brickwork see elevations and Material schedule for locations or specific brick types.
- Stainless steel Type 1 wall ties to PD 6697 - 300mm long to suit 150mm cavity generally at 450mm vertical centres and 750mm horizontal centres.
- full fill blown cavity wall insulation - Knauf Supafil 40 or equal cavity free from snots
- 100mm loadbearing lightweight block work skin. Density 600-800kg/m<sup>3</sup> Strength to S.E. design, thermal resistance no greater than 0.110- Tarmac Durox or equal
- 12.5mm gypsum based sound bloc plasterboard lining on plaster dabs and 3mm skim coat finish or tape and joint to suit project Specification.

RT2 type 300mm long wall ties with insulation board clips to BS EN 845-1 SE to advise

Ancon SDB Frame cramps to brick columns - spacings to be 900x450mm

Ancon SDB Frame cramps to brick columns - spacings to be 900x450mm

OUTSIDE

Weephole ventilators @ 900mm centres; Molyneux or similar approved; Colour to match adj. face brickwork

DPC to outer leaf to be 150mm minimum above adjacent ground level with 5mm projecting beyond face of mortar

JUNCTIONS WITH STRUCTURE SEAL

RIW Sheetseal 226 to be overlapped by 150mm onto the applied RIW Structureseal. Seal together using 50 x 5mm bead of RIW Sealing Compound, in centre of lap. Apply remaining RIW Sheetseal 226, as required.

REV:	DESCRIPTION:	BY:	DATE:
			
STATUS: Contractor/Tender set			
			
CLIENT:	Taylor French Taylor French Barns Shipton Winslow - MK18 3JL		
ARCHITECT:	Mark Bell Architects Ltd The Braid, Little Street Sulgrave, Oxfordshire OX17 2SG Tel 07788251765 W-markbellarchitects.com		
SITE:	ELMSBROOK NEIGHBOURHOOD CENTRE, NW BICESTER		
TITLE:	SUPERSTRUCTURE DETAILS - sheet 11		
SCALE AT A1:	DATE:	DRAWN:	CHECKED:
1:5/1:10	08/04/20	MDB	MB
PROJECT NO:	DRAWING NO:	REVISION:	
AA048	AA048/6.1/011	C1	