

NOTES

- The contractor is responsible for checking dimensions, tolerances and references. Any discrepancy to be verified with the Architect before proceeding with the works.
- Where an item is covered by drawings to different scales the larger scale drawing is to be worked to.
- Do not scale drawing. Figured dimensions to be worked to in all cases.

The structural / civil engineering and other non-architectural information shown on this drawing is purely for co-ordination purposes only and in no way does it take on any responsibility or liability for MBA Ltd. For all detailed information relating to these items see the relevant consultants drawings and full design information.

Do not copy in full or in part without the expressed consent of MBA Ltd.

© MBA 2019
CDM Regulations 2015

ALL current drawings and specifications for the project must be read in conjunction with the Designer's Hazard and Environmental Assessment Record.

GROUND FLOOR BUILD-UP
U-Value - 0.12w/m2K

- 1 - 75mm min finishing screed topping.
- 2 - 100mm Cellotex XR4000 floor insulation or equal
- 3 - PA ration = 0.17
- 4 - 1200 min gauge DPM with 300mm laps and dressed up blockwork
- 5 - oversite slab - to SE spec and design
- 6 - heave protection to SE design
- 8 - 10mm Bridgestop Quilt with Bridgestop tie
- 9 - 3mm Bridgestop High Performance Membrane
- 10 - 195 Siliconized sealant by Sika or equal
- 11 - PFC - Corofill acoustic intumescent sealant

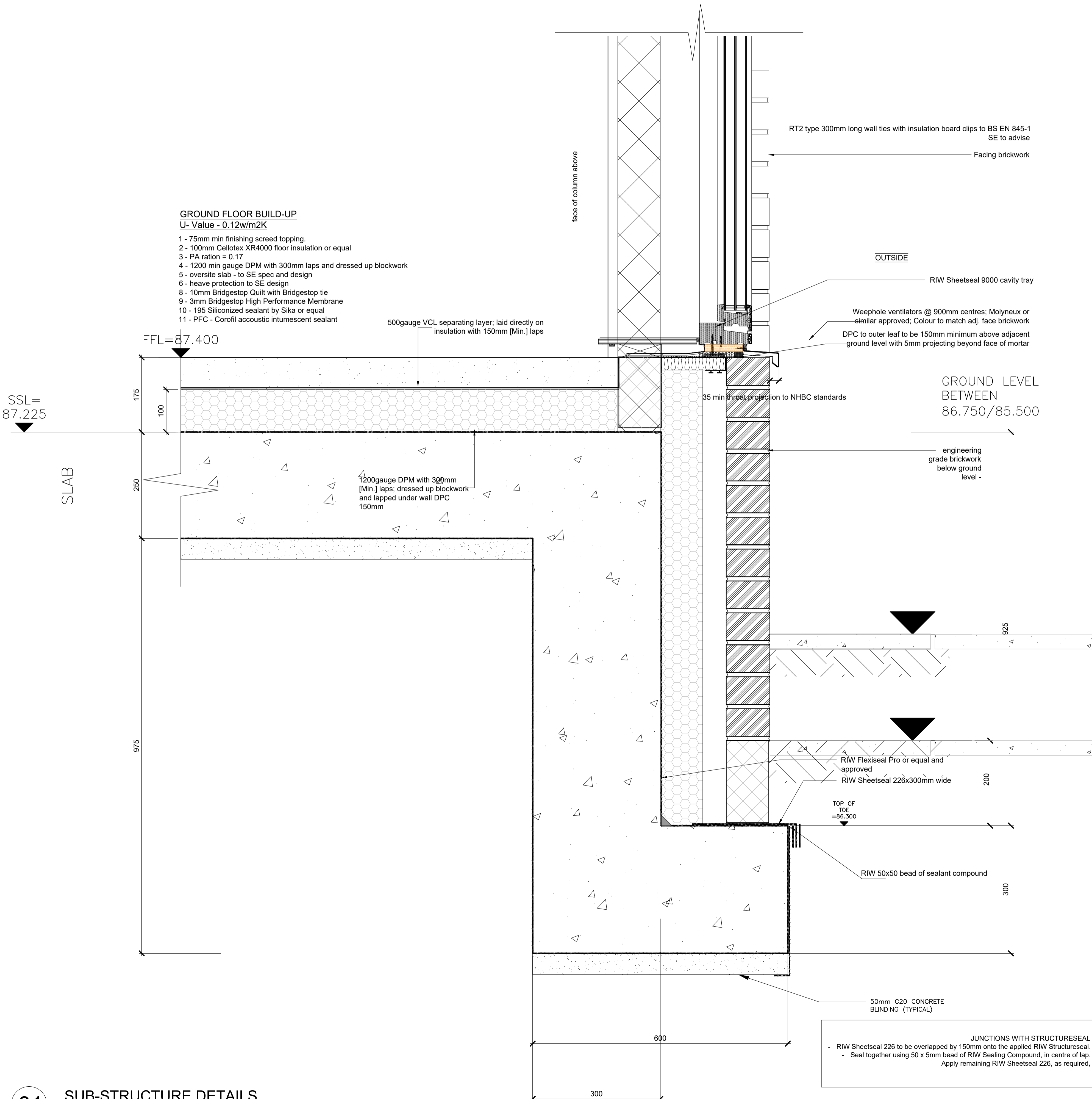

01 SUB-STRUCTURE DETAILS
GROUND FLOOR PERIMETER WALL INTERFACE

REV:	DESCRIPTION:	BY:	DATE:

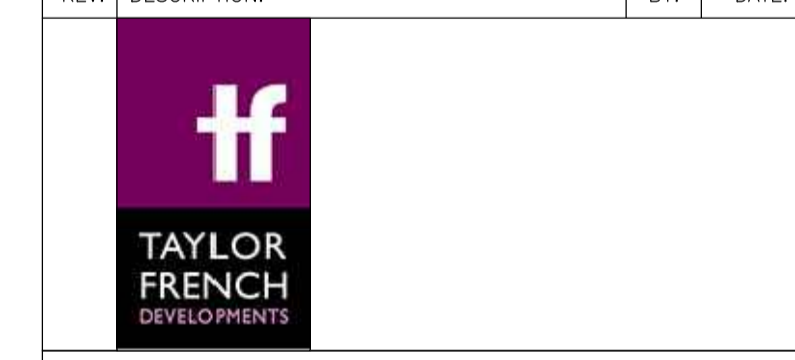

STATUS: **Contractor/Tender set**



CLIENT: **Taylor French**
Taylor French Barns
Shipston
Winslow - MK18 3JL

ARCHITECT: **Mark Bell Architects Ltd**
The Braid, Little Street
Sulgrave, Oxfordshire OX17 2SG
Tel 07788251765 W-markbellarchitects.com

SITE: **ELMSBROOK NEIGHBOURHOOD CENTRE, NW BICESTER**

TITLE: **SUPERSTRUCTURE DETAILS - sheet 13**

SCALE AT A1:	DATE:	DRAWN:	CHECKED:
1:5/1:10	08/04/20	MDB	MB
PROJECT NO:	DRAWING NO:	REVISION:	
AA048	AA048/6.1/013	C1	