

NOTES

- The contractor is responsible for checking dimensions, tolerances and references. Any discrepancy to be verified with the Architect before proceeding with the works.
- Where an item is covered by drawings to different scales the larger scale drawing is to be worked to.
- Do not scale drawing. Figured dimensions to be worked to in all cases.

The structural / civil engineering and other non-architectural information shown on this drawing is purely for co-ordination purposes only and in no way does it take on any responsibility or liability for M&E Ltd. For all detailed information relating to these items see the relevant consultants drawings and full design information.

Do not copy in full or in part without the expressed consent of MBA Ltd.

© MBA 2019

CDM Regulations 2015

ALL current drawings and specifications for the project must be read in conjunction with the Designer's Hazard and Environmental Assessment Record.

**INTERNAL SEPARATING UPPER FLOOR GRD- 1ST FLOOR  
60 MIN FIRE RESISTANCE**

- 1 - 75mm min finishing screed topping.
- 2 - 6mm Iso-rubber code layer (resilient layer) TBC, with IsoEdge flanking strip OR YeloFon HD10+ E & J strips also by Celecta
- 3 - 525mm RC slab to SE details- min 2400kg/m3 density (without screed)
- 4 - optional - 25mm min absorbent Ceiling quilt in 150mm void (can reduce to 100mm if 200mm planks used- (1ST-2ND FLOOR ONLY)
- 5 - 35mm acoustic ceiling tiles by Troldekt min 12kg/m2 fibre board and a suspended ceiling system, eg Troldekt Plus or equal (E-FC-18 requires 10kg/m2)
- 6 - 3.8mm thick wall cap membrane with Monarfloor wall cap clips (1ST-2ND FLOOR ONLY)
- 7 - 10mm Bridgestop Quilt with Bridgestop tie
- 8 - 3mm Bridgestop High Performance Membrane
- 9 - 195 Siliconized sealant by Sika or equal
- 10 - PFC - Corofill acoustic intumescent sealant

**Floor type based on Robust detail E-FC-18 to achieve acoustic performance  
AD Part E = 5Db improvement**

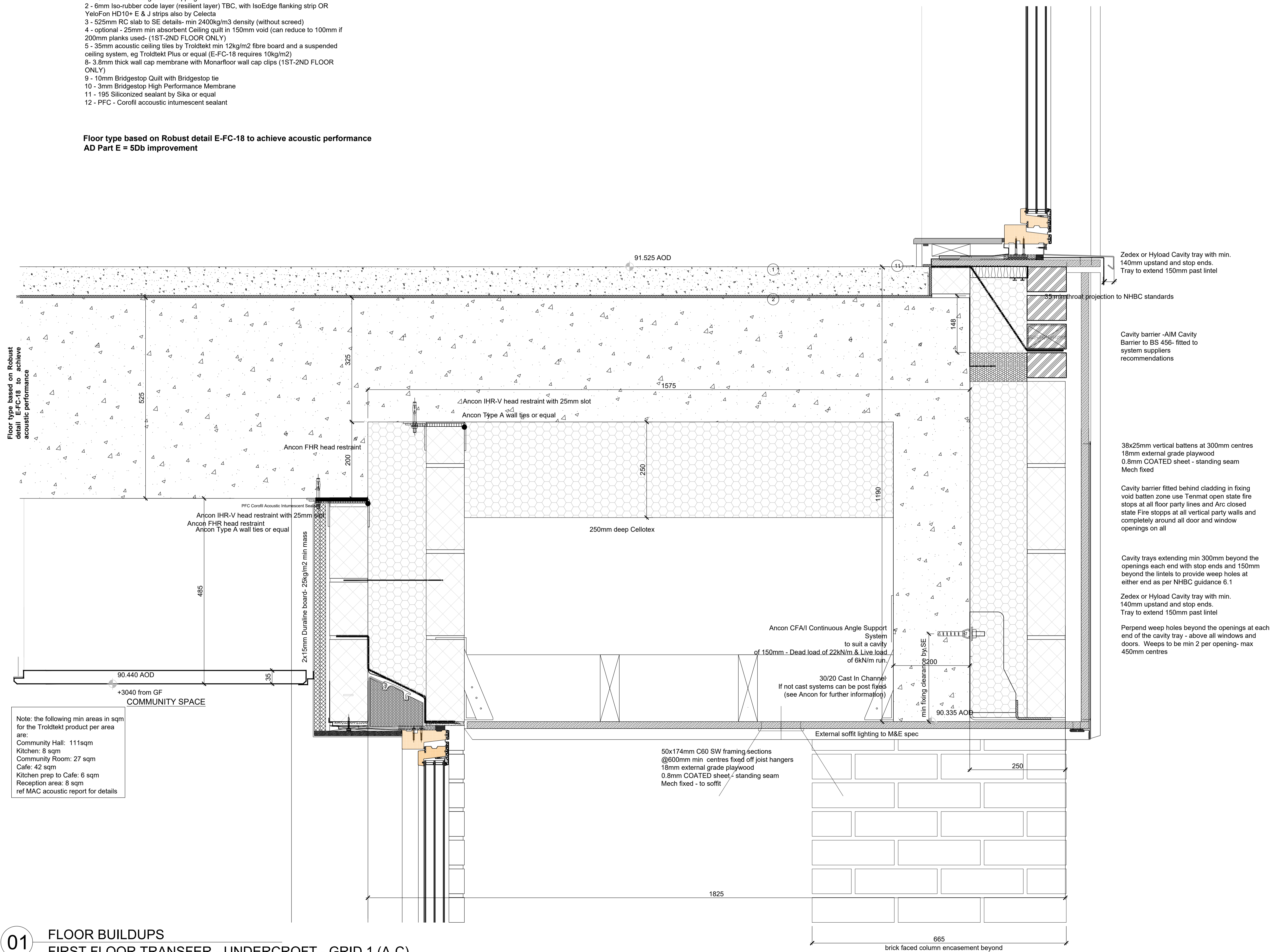

Floor type based on Robust detail E-FC-18 to achieve acoustic performance

Note: the following min areas in sqm for the Troldekt product per area are:  
Community Hall: 111sqm  
Kitchen: 8 sqm  
Community Room: 27 sqm  
Cafe: 42 sqm  
Kitchen prep to Cafe: 6 sqm  
Reception area: 8 sqm  
ref MAC acoustic report for details

REV:	DESCRIPTION:	BY:	DATE:
------	--------------	-----	-------

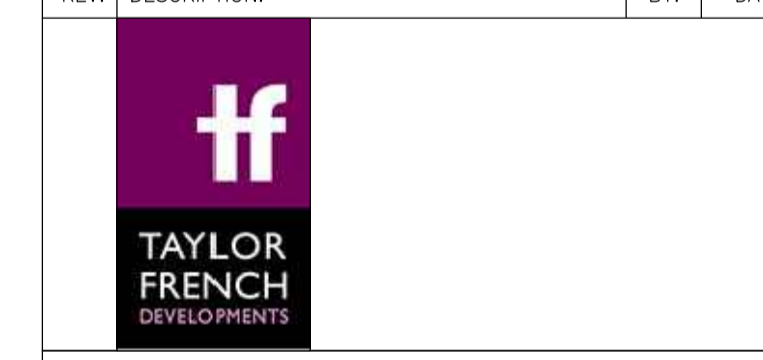

STATUS: Contractor/Tender set



CLIENT: Taylor French  
Taylor French Barns  
Shipston  
Winslow - MK18 3JL

ARCHITECT: Mark Bell Architects Ltd  
The Braid, Little Street  
Sulgrave, Oxfordshire OX17 2SG  
Tel 07788251765 W-markbellarchitects.com

SITE: ELMSBROOK NEIGHBOURHOOD CENTRE, NW BICESTER

TITLE: SUPERSTRUCTURE DETAILS - sheet 17

SCALE AT A1: 1:5/1:10	DATE: 08/04/20	DRAWN: MDB	CHECKED: MB
PROJECT NO: AA048	DRAWING NO: AA048/6.1/017	REVISION:	C1