

**PLANTING SCHEDULE SPECIMENS**

| Species                                | Height    | Girth | Pot Size | Specification  | Quantity |
|--|-----------|-------|----------|--|----------|
| Cydonia oblonga 'Vranja'               | 175-200cm |       | 10-15L   | Half Standard: Pyrus communis Rootstock: 3 brks: C: Clear Stem 100-125cm | 3 No.    |
| Malus domestica 'Bramley's Seedling'   | 175-200cm |       |          | Half Standard: MM106 Rootstock: 3 brks: B: Clear Stem 100-125cm          | 3 No.    |
| Malus domestica 'Cox's Orange Pippin'  | 175-200cm |       |          | Half Standard: MM106 Rootstock: 3 brks: B: Clear Stem 100-125cm          | 3 No.    |
| Malus domestica 'Discovery'            | 175-200cm |       |          | Half Standard: MM106 Rootstock: 3 brks: B: Clear Stem 100-125cm          | 2 No.    |
| Malus domestica 'Egremont Russet'      | 175-200cm |       |          | Half Standard: MM106 Rootstock: 3 brks: B: Clear Stem 100-125cm          | 3 No.    |
| Malus domestica 'James Grieve'         | 175-200cm |       |          | Half Standard: MM106 Rootstock: 3 brks: B: Clear Stem 100-125cm          | 3 No.    |
| Malus domestica 'Katy'                 | 175-200cm |       |          | Half Standard: MM106 Rootstock: 3 brks: B: Clear Stem 100-125cm          | 3 No.    |
| Malus domestica 'Laxton's Superb'      | 175-200cm |       |          | Half Standard: MM106 Rootstock: 3 brks: B: Clear Stem 100-125cm          | 3 No.    |
| Mespilus germanica 'Nottingham'        | 175-200cm |       |          | Half Standard: Pyrus communis Rootstock: 3 brks: B: Clear Stem 100-125cm | 3 No.    |
| Prunus avium 'Stella'                  | 175-200cm |       |          | Half Standard: Prunus F.12.1 Rootstock: 3 brks: B: Clear Stem 100-125cm  | 3 No.    |
| Prunus domestica 'Opal'                | 175-200cm |       |          | Half Standard: Myrobalan B Rootstock: 3 brks: B: Clear Stem 100-125cm    | 3 No.    |
| Prunus domestica 'Oullins Golden Gage' | 175-200cm |       |          | Half Standard: Myrobalan B Rootstock: 3 brks: B: Clear Stem 100-125cm    | 3 No.    |
| Pyrus communis 'Beurré Hardy'          | 175-200cm |       |          | Half Standard: Pyrus communis Rootstock: 3 brks: B: Clear Stem 100-125cm | 2 No.    |
| Pyrus communis 'Doyenné du Comice'     | 175-200cm |       |          | Half Standard: Pyrus communis Rootstock: 3 brks: B: Clear Stem 100-125cm | 2 No.    |
| Ribes nigrum 'Ben Hope'                | 60-80cm   | 3L    |          | Bush: 3/5 Shoots: C  | 5 No.    |
| Ribes rubrum 'Red Lake'                | 60-80cm   | 3L    |          | Bush: 3/4 Shoots: C  | 4 No.    |
| Ribes rubrum 'White Versailles'        | 60-80cm   | 3L    |          | Bush: 3/4 Shoots: C  | 3 No.    |
| Ribes uva-crispa 'Hinnonmaki Red'      | 40-60cm   | 3L    |          | Bush: 5/8 Shoots: C  | 4 No.    |
| Ribes uva-crispa 'Hinnonmaki Green'    | 40-60cm   | 3L    |          | Bush: 5/8 Shoots: C  | 4 No.    |
| Rubus idaeus 'Autumn Bliss'            | 40-60cm   | 2L    |          | Strong Cane: C   | 2 No.    |
| Rubus idaeus 'Glen Fyne'               | 40-60cm   | 2L    |          | Strong Cane: C   | 3 No.    |
| Rubus idaeus 'Glen Magna'              | 40-60cm   | 2L    |          | Strong Cane: C   | 2 No.    |
| Rubus idaeus 'Glen Moy'                | 40-60cm   | 2L    |          | Strong Cane: C   | 2 No.    |

**HEDGES**

| Species            | Height  | Specification                                      | Density                                | Quantity |
|--------------------|---------|--|--|----------|
| Corylus avellana   | 60-80cm | 1+2: Transplant - seed raised: Branched: 3 brks: B | 0.3Ctr Double Staggered at 0.1m offset | 582 No.  |
| Crataegus monogyna | 60-80cm | 1+1: Transplant - seed raised: B                   | 0.3Ctr Double Staggered at 0.1m offset | 865 No.  |
| Malus sylvestris   | 60-80cm | 1+1: Transplant - seed raised: B                   | 0.3Ctr Double Staggered at 0.1m offset | 296 No.  |
| Prunus cerasifera  | 60-80cm | 1+1: Transplant - seed raised: Branched: 3 brks: B | 0.3Ctr Double Staggered at 0.1m offset | 296 No.  |
| Prunus insititia   | 60-80cm | 1+1: Transplant - seed raised: Branched: 3 brks: B | 0.3Ctr Double Staggered at 0.1m offset | 296 No.  |
| Prunus spinosa     | 60-80cm | 1+1: Transplant - seed raised: Branched: 2 brks: B | 0.3Ctr Double Staggered at 0.1m offset | 296 No.  |
| Rosa canina        | 60-80cm | 1+1: Transplant - seed raised: Branched: 3 brks: B | 0.3Ctr Double Staggered at 0.1m offset | 296 No.  |

**PLANTING AREAS**

| Species                                   | Diameter | Height | Pot Size | Specification              | Density | Quantity |
|---|----------|--------|----------|----------------------------|---------|----------|
| Allium schoenoprasum                      |          |        | 3L       | Full Pot: C                | 5/m²    | 4 No.    |
| Fragaria vesca                            |          |        | 3L       | Full Pot: C                | 5/m²    | 18 No.   |
| Fragaria x ananassa 'Cambridge Favourite' |          |        | 3L       | Full pot: 2 Strong Buds: C | 6/m²    | 8 No.    |
| Lavandula angustifolia 'Hidcote'          | 20-30cm  |        | 3L       | Bushy: 5 brks: C           | 3/m²    | 4 No.    |
| Lavandula x intermedia 'Alba'             | 20-30cm  |        | 3L       | Bushy: 5 brks: C           | 3/m²    | 4 No.    |
| Melissa officinalis 'Aurea'               |          |        | 3L       | Full Pot: C                | 5/m²    | 6 No.    |
| Mentha spicata                            |          |        | 3L       | Full Pot: C                | 3/m²    | 2 No.    |
| Mentha x piperita                         |          |        | 3L       | Full Pot: C                | 3/m²    | 2 No.    |
| Origanum vulgare 'Aureum'                 |          |        | 3L       | Full Pot: C                | 4/m²    | 5 No.    |
| Rheum x hybridum 'Timperley Early'        |          |        | 3L       | Full pot: 2 Strong Buds: C | No.     | 3 No.    |
| Ribes nigrum 'Ben Hope'                   | 60-80cm  | 3L     |          | Bush: 3/5 Shoots: C        | No.     | 1 No.    |
| Ribes uva-crispa 'Hinnonmaki Red'         | 40-60cm  | 3L     |          | Bush: 5/8 Shoots: C        | No.     | 1 No.    |
| Rosmarinus officinalis 'Prostratus'       | 20-30cm  | 3L     |          | Bushy: 4 brks: C           | 3/m²    | 4 No.    |
| Salvia officinalis                        |          |        | 3L       | Full Pot: C                | 5/m²    | 6 No.    |
| Thymus vulgaris                           |          |        | 3L       | Full Pot: C                | 4/m²    | 5 No.    |
| Thymus x citriodorus 'Bertram Anderson'   |          |        | 3L       | Full Pot: C                | 4/m²    | 5 No.    |

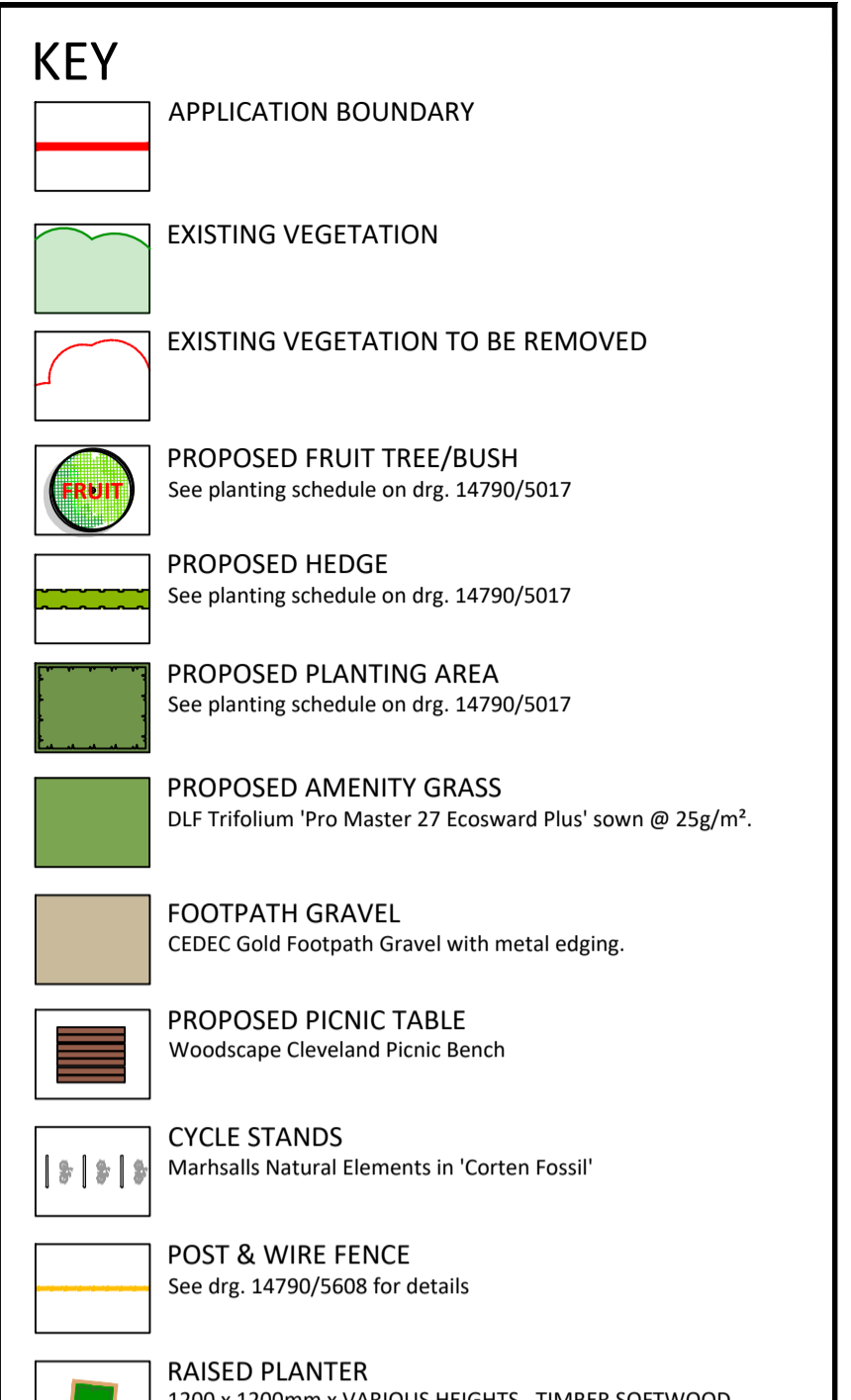

**Notes**

Issue: Drawn by David Jarvis Associates Limited (CROWN COPYRIGHT. ALL RIGHTS RESERVED 2015 LICENCE NUMBER 0100031). This drawing is for Planning purposes only - Do not use this drawing for construction. The information contained in the drawing should be used as a guide to the final forms and finishes of the landscape scheme. Any revisions to be approved by the Client and Local Authority

Scaling: Do not scale this drawing. Use given dimensions only.

Setting out: refer to Engineers for information regarding setting out. In the event of discrepancy refer to Engineers in the first instance.

Survey: Original survey provided by the Client.

Services: Where possible these are identified on the drawings but, for the avoidance of doubt all service/utility locations should be considered indicative until identified on site. To ensure those services / utilities shown are current refer to the original survey provider or utilities designer or Client for confirmation and further information regarding easements. In the event of new services being installed refer to the appointed Engineer. It is recommended that hazard warning tape 'danger electric cable'/ 'danger services' to be installed over all service routes (to remain on site) to current BS guidelines (BS7671).

Lighting: Refer to lighting engineers drawings.

Planting: Plant species are selected and located in line with consideration of the site conditions, NHBC guidelines and discussions with the Local Authority and design team. All plants and planting procedure to conform to the David Jarvis Associates Limited Landscape Specification that will accompany the Construction issue drawings. No species or plant location is to be varied without prior consent of the Landscape Architect.

Foundations: Developers / Contractors to ensure that all foundations (buildings and external walling) are designed and constructed so as to take into account, at the time of maturity, any existing or proposed trees, hedgerows or other vegetation on the application site or existing vegetation on land adjoining the site at the time of construction and any trees felled or hedgerows removed on or adjacent to the site during the previous 15 years. For this purpose the developer / contractors will submit all relevant details to the authority dealing with the Building Regulations Certificate.

Design Levels: Refer to Engineers where design levels are not shown.

CDM: Drawings to be read in conjunction with Designers risk assessment. Potential risks above that of those associated with the general construction typical to the drawing are identified below;

**Allotment Sheds**

Storage shed to be formed by 'Empire shed' by Wayfair or similar approved. To incorporating vertical and horizontal slat timber cladding, fully lockable doors to match cladding, Colour- Natural, Pent roof, timber Post and roof fixed. Size as shown.

Two 'Ecosure' Water butt by Tankshop or similar approved. Incorporating 1050 Litres of water each and Weatherproof (Resistant against corrosion). Size as shown.

see drgs. 14790 5017 & 14790 5018 for further information



Drawing Revision

| Rev. | Date       | Description                                      | Drawn | Checked |
|------|------------|--|-------|---------|
| P2   | 12/02/2018 | Allotment sheds added to community gardens 1 & 4 | GR    | BS      |
| P1   | 04/12/2017 | First issue.                                     | GR    | BS      |

Status **PLANNING**

**DAVID JARVIS ASSOCIATES**

DAVID JARVIS ASSOCIATES LIMITED  
1 Tenison Street Swindon Wiltshire SN1 5DT  
t: 01793 612173  
e: mail@davidjarvis.biz  
w: www.davidjarvis.biz

Client  
**ELMSBROOK (CREST A2D) LLP**

Project  
**ELMSBROOK, BICESTER PHASES 3 & 4**

Drawing Title  
**COMMUNITY GARDENS & ALLOTMENTS SHEET 1 OF 2**

|                                  |                         |                           |
|----------------------------------|-------------------------|---------------------------|
| Scale<br><b>1:200</b>            | Sheet Size<br><b>A1</b> | Date<br><b>04/12/2017</b> |
| Drawing No.<br><b>14790/5017</b> | Revision<br><b>P2</b>   |                           |