

PRELIMINARY TPP

COPYRIGHT RESERVED
DO NOT SCALE FROM THIS DRAWING

Tree Survey Drawing Key

- Tree Protection Area #2
- Tree Canopy Extent
- Stem Location / Coloured disc denotes BS 5837 Category
- Tree Number

See Innovation Environmental Tree Survey for Individual Tree Details

KEY

- Tree to be retained
- Tree to be Pruned
- Tree to be removed
- Tree protective fencing
- No Dig Surface
- Supervised Excavations
- Construction Exclusion Zone
- Temporary Ground Protection
- Proposed Development Area

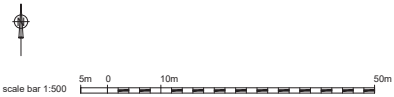

innovation group environmental SERVICES

Environmental Services
Unit 4, Lincol Court,
Cawledge Business Park
Aylesley, Notts, NG22 9DD

T: +44 (0) 330 380 1036
F: +44 (0) 330 380 1038
E: office@innovation-environmental.co.uk
W: www.innovation-environmental.co.uk

REV. AMENDMENTS DRAWN DATE AUTH

**Bicester Airfield,
Skimmingdish Lane,
Bicester, OX26 5HA**

Bicester Airfield

**Tree Protection Plan (TPP)
Sheet 1 of 4**

| | | | | |
|------------------|-------------------|----------------|------------|--------|
| REF: 00807161029 | SCALE: 1:500 @ A1 | DATE: 30/07/16 | REF: 13109 | REV: - |
|------------------|-------------------|----------------|------------|--------|

Innovation Group

Tree Survey Datasheet Key

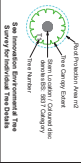

KEY

- Tree to be retained
- Trees to be Pruned
- Tree to be removed
- Tree protective birthing
- No Dig Surface
- Supervised Excavations
- Construction Exclusion Zone
- Temporary Ground Protection
- Proposed Development Area

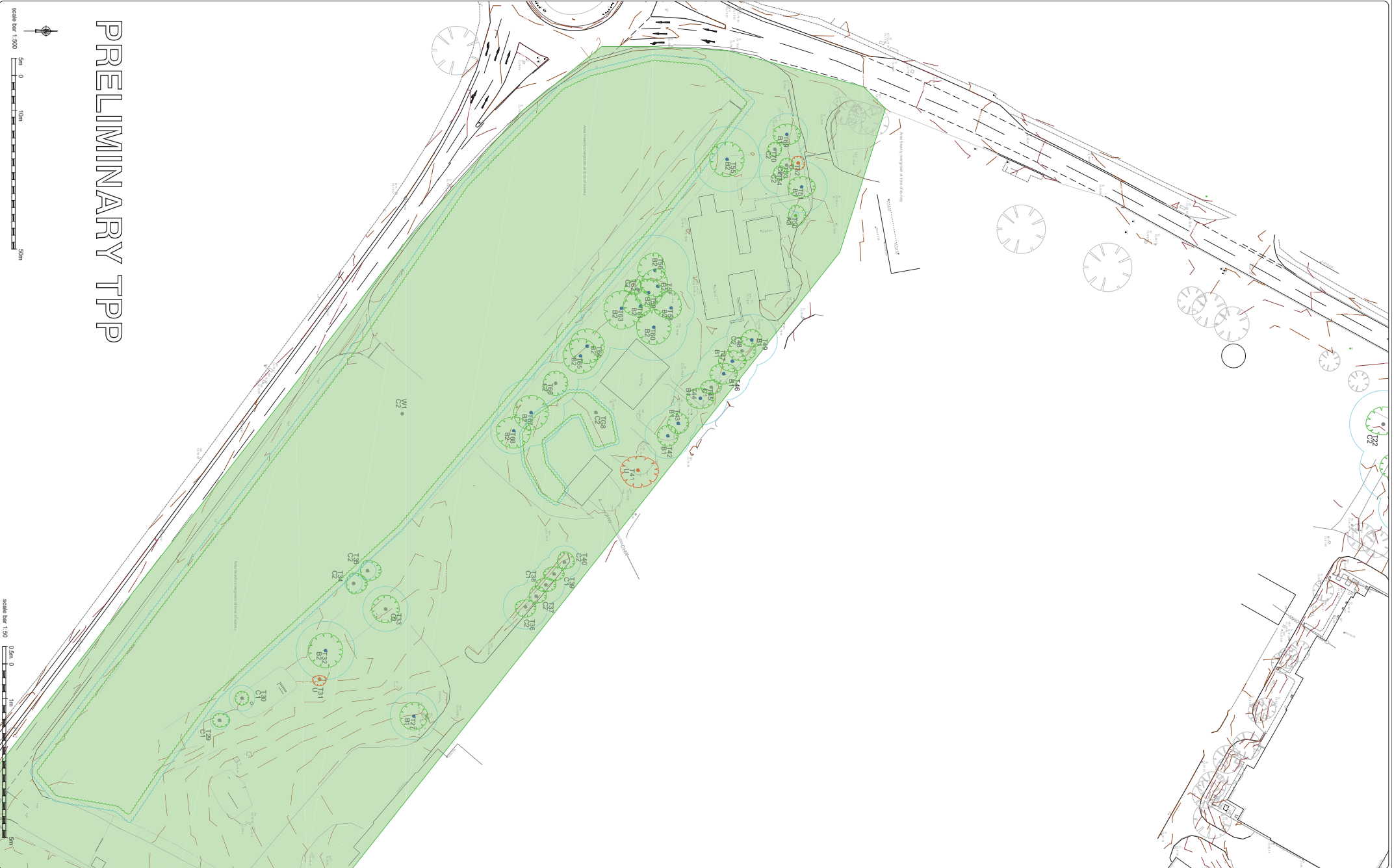

PRELIMINARY TPP

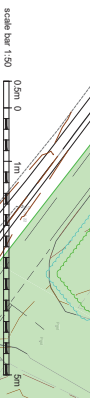
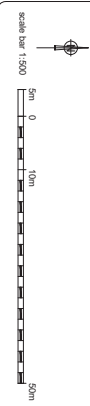

NOTES

Bicester Airfield,
 Skimmingdish Lane,
 Bicester, OX26 5HA
 Bicester Airfield

Environmental Services

Tree Protection Plan (TPP)
 Sheet 2 of 4
 13109

Innovation Group