



KEY

- APPLICATION BOUNDARY
- EXISTING VEGETATION
- EXISTING VEGETATION TO BE REMOVED
- PROPOSED TREE
See planting schedule on drg. 14790/5001
- PROPOSED FRUIT TREE
See fruit tree notes.
- PROPOSED HEDGE
See planting schedule on drg. 14790/5001
- PROPOSED PLANTING AREA
See planting schedule on drg. 14790/5001
- PROPOSED AMENITY GRASS
DLF Trifolium 'Pro Master 27 Ecosward Plus' sown @ 25g/m².
- PROPOSED LONG GRASS
'WG20 Eco Species Rich Lawn' @ 10g/m².
- STEPPING LOGS
ProLudic, Origin Timber stepping logs (J4904)
- BALANCE BEAM
ProLudic, Origin Timber balance beam (J4903)
- CLIMBING/BALANCE BEAM
ProLudic, Origin Timber balance beam (J4901)
- CLIMBING/BALANCE BEAM
ProLudic, Origin Timber balance beam (J4908)
- 91.53 EXISTING LEVELS
- +90.32 PROPOSED LEVELS
- PROPOSED LEVELS FEATHERED DOWN/UP TO TIE INTO EXISTING LEVELS AT 1:3 OR SHALLOWER

Notes

Issue: Drawn by David Jarvis Associates Limited (CROWN COPYRIGHT). ALL RIGHTS RESERVED 2018 LICENCE NUMBER 0100031. This drawing is for planning purposes only. Do not use this drawing for construction. The information contained in the drawing should be used as a guide to the final forms and finishes of the landscape scheme. Any revisions to be approved by the Client and Local Authority.

Scaling: Do not scale this drawing. Use given dimensions only.

Setting out: refer to Engineers for information regarding setting out. In the event of discrepancy refer to Engineers in the first instance.

Services: Where possible these are identified on the drawings but, for the avoidance of doubt all service/utility locations should be considered indicative unless identified on site. To ensure those services / utilities shown are current refer to the original survey provider or utilities designer or Client for confirmation and further information regarding assessments, in the event of new services being installed refer to the appointed Engineer.

Lighting: Refer to lighting engineers drawings.

Planting: Plant species are selected and located in line with consideration of the site conditions, NHBC guidelines and discussions with the Local Authority and design team. All plants and planting procedure to conform to the David Jarvis Associates Limited Landscape Specification that will accompany the Construction Issue drawings. No species or plant location is to be varied without prior consent of the Landscape Architect.

Foundations: Developers / Contractors to ensure that all foundations (buildings and external walls) are designed and constructed so as to take into account, at the time of maturity, any existing or proposed trees, hedgerows or other vegetation on the application site or existing vegetation on land adjoining the site at the time of construction and any trees felled or hedgerows removed on or adjacent to the site during the previous 15 years.

Design Levels: Refer to Engineers where design levels are not shown.

PLANTING SCHEDULE

SPECIES	Height	Girth	Pot Size	Specification	Quantity
Acer campestre	500-550cm	20-25cm		Semi-Mature: 3x: RB: Clear Stem min. 200cm	28 No.
Amelanchier lamarckii	350-400cm			Umbrella Shape: Multi-Stemmed: 200-300cm wide: 6x: RB: Clear Stems 150-200cm: Clipped	1 No.
Betula pendula	500-550cm	20-25cm		Semi-Mature: 3x: RB: Clear Stem min. 200cm	51 No.
Carpinus betulus	500-550cm	20-25cm		Semi-Mature: 3x: RB: Clear Stem min. 200cm	12 No.
Carpinus betulus 'Frans Fontaine'	500-550cm	20-25cm		Semi-Mature: 3x: RB: Clear Stem min. 200cm	8 No.
Fagus sylvatica	500-550cm	20-25cm		Semi-Mature: 3x: RB: Clear Stem min. 200cm	4 No.
Fargesia robusta	175-200cm	25-35L		Several shoots: 10 breaks	16 No.
Malus sylvestris	min. 450cm	20-25cm		Semi-Mature: 3x: RB: Clear Stem min. 200cm	15 No.
Malus triobata	500-550cm	20-25cm		Semi-Mature: 3x: RB: Clear Stem min. 200cm	45 No.
Prunus avium	500-550cm	20-25cm		Semi-Mature: 3x: RB: Clear Stem min. 200cm	7 No.
Prunus padus	500-550cm	20-25cm		Semi-Mature: 3x: RB: Clear Stem min. 200cm	3 No.
Sorbus aria	500-550cm	20-25cm		Semi-Mature: 3x: RB: Clear Stem min. 200cm	7 No.
Sorbus aucuparia	500-550cm	20-25cm		Semi-Mature: 3x: RB: Clear Stem min. 200cm	11 No.
Sorbus torminalis	500-550cm	20-25cm		Semi-Mature: 3x: RB: Clear Stem min. 200cm	10 No.
Tilia cordata	500-550cm	20-25cm		Semi-Mature: 3x: RB: Clear Stem min. 200cm	
Tilia platyphyllos	500-550cm	20-25cm		Semi-Mature: 3x: RB: Clear Stem min. 200cm	

HEDGES

Species	Height	Pot Size	Specification	Density	Quantity
Carpinus betulus	100-125cm		1+2: Feathered: B	0.3ctr Double Staggered at 0.1m offset	321 No.
Ligustrum vulgare	60-80cm	3L	Branched: 4 brks: C	0.3ctr	1142 No.
Osmanthus x burkwoodii	40-60cm	5-7.5L	Bushy: 5 brks: C	0.3ctr	2713 No.

PLANTING AREAS

Species	Diameter	Height	Pot Size	Specification	Density	Quantity
Ajuga reptans 'Catlin's Giant'			3L	Full Pot: C	8/m ²	903 No.
Anemone x hybrida 'Honorine Jobert'			3L	Full Pot: C	8/m ²	26 No.
Bergenia 'Silberlicht'			3L	Full Pot: C	8/m ²	1773 No.
Cornus alba 'Aurea'	60-80cm	5L	Branched: 4 brks: C	5/m ²	2925 No.	
Cornus alba 'Sibirica'	60-80cm	3L	Branched: 4 brks: C	5/m ²	2861 No.	
Hedera helix	40-60cm	2L	Several Shoots: 3 brks: C	8/m ²	7053 No.	
Lavandula angustifolia 'Hidcote'	20-30cm	3L	Bushy: 5 brks: C	5/m ²	732 No.	
Leucanthemum vulgare			3L	Full Pot: C	8/m ²	411 No.
Luzula sylvatica 'Marginata'			3L	Full Pot: C	8/m ²	500 No.
Osmanthus x burkwoodii	40-60cm	5-7.5L	Bushy: 5 brks: C	5/m ²	318 No.	
Pyracantha 'Sappho Orange'	40-60cm	3L	Leader with Laterals: 4 brks: C	5/m ²	990 No.	
Ribes odoratum	40-60cm	3L	Branched: 3 brks: C	5/m ²	189 No.	
Rosa pimpinellifolia	60-80cm	3L	Bush: 5 brks: C	5/m ²	385 No.	
Rosa Yellow Dagmar Hastrup	40-60cm	10L	Roses - Cutting: Bush: 5 brks: C	5/m ²	17 No.	
Rosmarinus 'Miss Jessop's Upright'	30-40cm	5L	Bushy: 5 brks: C	5/m ²	271 No.	
Rosmarinus 'Prostratus'	30-40cm	5L	Bushy: 6 brks: C	5/m ²	1952 No.	
Rubus tricolor			2L	Several Shoots: 3 brks: C	5/m ²	312 No.
Salvia officinalis			3L	Full Pot: C	5/m ²	44 No.
Sarcococca humilis	25-30cm	5L	Bushy: 6 brks: C	5/m ²	831 No.	
Stipa gigantea			5L	Full Pot: C	5/m ²	383 No.
Thymus vulgaris			3L	Full Pot: C	8/m ²	1941 No.
Viburnum davidii	30-40cm	5-7.5L	Bushy: 4 brks: C	5/m ²	1276 No.	
Viburnum opulus	40-60cm	3L	Branched: 4 brks: C	5/m ²	359 No.	

PLANTING NOTES

- Base of all planting to be covered with 75mm of well composted bark mulch.
- Species to be planted at densities shown in groups of 6-9 individuals.
- Stipa gigantea along primary street to be planted in evenly spaced groups of 3-4 plants.
- Species to be planted in ascending size from front to rear of borders.
- Terram RootGuard, or equal & approved root barriers to be installed where services or hard surfacing fall within 5m of a proposed tree.
- Existing ecotone vegetation around periphery to be assessed and retained where possible.
- Herbicide use should be minimised in these areas.

Residents able to choose 1 no. fruit tree from the following list; to be planted at marked locations; choice subject to foundation offset requirements:

Common Name	Specification	Ultimate Height ¹	Water Demand ²	Min. offset from foundations ³
Apple 'Cox Self Fertile'	Bush; MM106 rootstock; 5 brks; 2-3 years old; 150-175cm height; 10-12L; Container	4m	Moderate	2m
Plum 'Victoria'	Bush; St Julien A rootstock; 5 brks; 2 years old; 125-150cm height; 10-12L; Container	5m	Moderate	2.5m
Pear 'Doyenné du Comice'	Bush; Quince A rootstock; 5 brks; 2-3 years old; 150-175cm height; 10-12L; Container	4.5m	Moderate	2.25m

¹ Ultimate height based upon RHS guidance for the selected rootstock (<https://www.rhs.org.uk/advice/profile?PID=359>)
² Water demand as given in NHBC 'Building near Trees' Table 3
³ Min. offset from foundations calculated as 0.5m x mature height; in accordance with NHBC 'Building near Trees' Table 5; based upon a min. foundation depth of 1.2m, a low shrinkage soil and ultimate height and water demand as shown.
⁴ Exact locations to be determined on site to avoid as built services.
⁵ Root barriers to used where trees are within 3m of service locations.

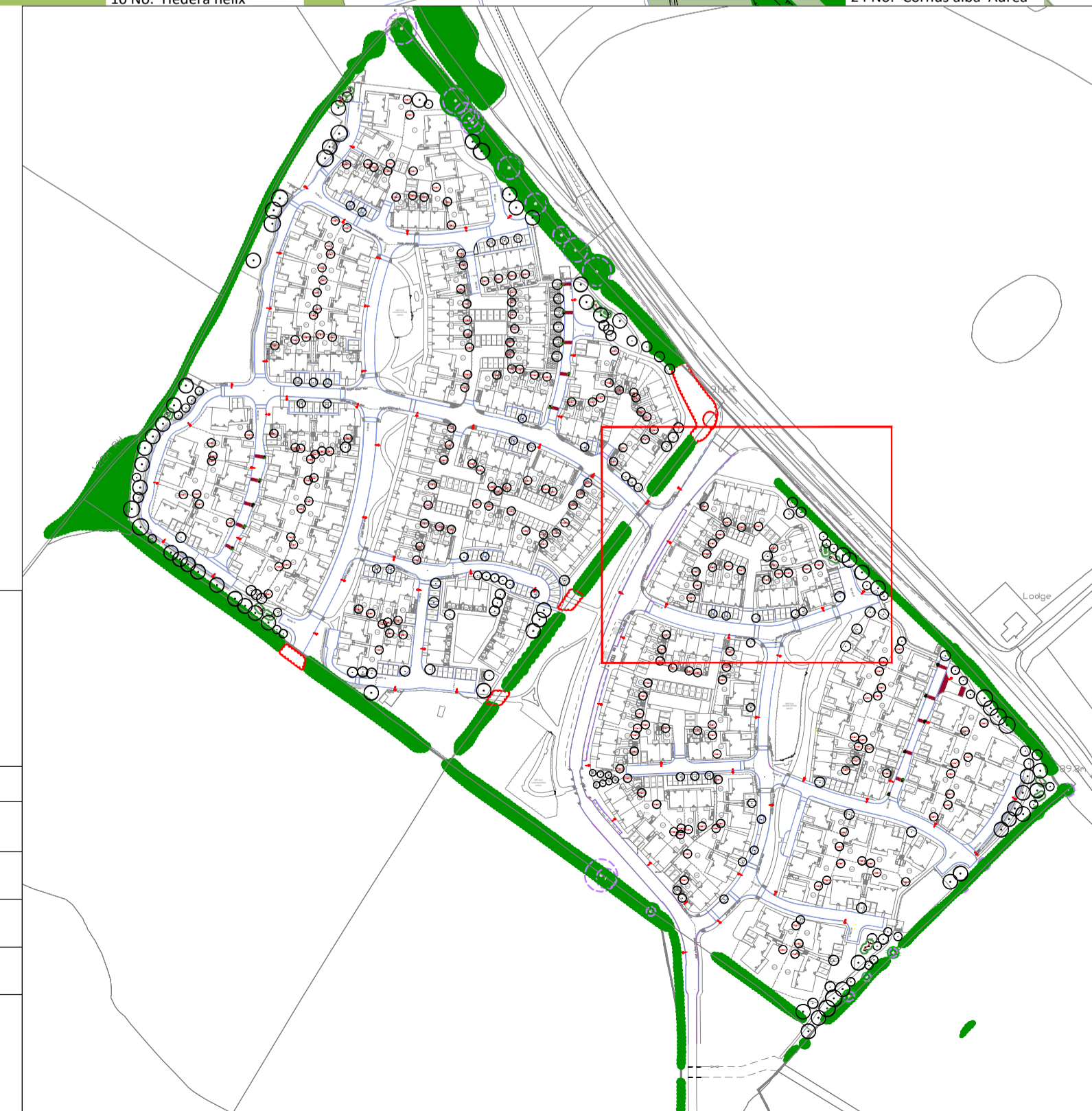

Drawing Revision

Rev.	Date	Description	Drawn	Checked
PS	30/11/2018	Updated to CDC comments dated 16/11/18 rec'd 28/11/18	GR	BS
P4	31/10/2018	Updated to CDC comments dated 24/07/18 rev 191018	GR	BS
P3	16/04/2018	Updated following CDC comments.	GR	BS
P2	06/12/2017	Updated to Crest comments.	GR	BS
P1	04/12/2017	First Issue.	GR	BS

PLANNING

DAVID JARVIS ASSOCIATES

DAVID JARVIS ASSOCIATES LIMITED
 1 Tenison Street Swindon Wiltshire SN1 5DT
 t: 01793 612173
 e: mail@davidjarvis.biz
 w: www.davidjarvis.biz

Client
ELMSBROOK (CREST A2D) LLP

Project
ELMSBROOK, BICESTER PHASES 3 & 4

Drawing Title
LANDSCAPE PROPOSALS SHEET 1 OF 12

Scale	Sheet Size	Date
1:200	A1	04/12/2017
Drawing No.	Revision	
14790/5001	P5	