

PRELIMINARY CONSTRUCTION



Drawings must be printed/reproduced in colour.

Revision	Date	Revision notes	Design change	Issued by
A	05.11.13	General drawing update: Chestnut pale fencing removed where clouded. References to tarmac resurfacing removed. Change of material to raised performance space. Benching removed. Drawing number changed from L1900 to L1920.	LH	JN
B	03.12.13	Landscape amended to suit marked up drawings. Area of paving slabs changed to tarmac. area of grass increased.	SN	CH
C	07.04.14	Landscape amended to suit Kier comments 02.04.14	SN	U
D	22.04.14	Landscape amended to suit Kier comments 17.04.14	SN	U
E	24.04.14	Landscape amended to suit Kier comments 24.04.14	SN	U
F	12.05.14	Levels amended to north elevation	SN	U
G	19.06.14	Levels checked and main entrance pavement amended	JN	JN
H	02.07.14	Planning Issue	TFW	TFW
I	15.08.14	Amendments in line with Kier meeting 30.07.13 and updates from engineers.	CH	JN
J	13.11.14	Drawing number changed from L900 to L1900	TW	CH
K	20.11.14	Bike hoop hard standing amended.	U	CH
L	21.01.15	Soft landscape amended in line with comments from Tim Screen	CH	JN
M	29.01.15	Junior cycle shelter added	CH	JN
N	04.03.15	Nursery area amended	CH	JN
O	05.03.15	Nursery area amended	CH	JN
P	01.06.17	Sports equipment added	JT	JN

Job title
Heyford Park Free School Sports Hall

Drawing title
Proposed Landscape Plan

First issued	01.11.13
Drawn by	LH
Drawing sheet size	A1
Scale	1:200
Issued by	JN
Job code	HFSK-SH
Drawing number prefix	L
Drawing number	1900
Revision	P



33a Victoria Street
Birmingham
B1 3ND
T +44(0)121 234 4460
F +44(0)121 234 6450
bham@dp-architects.co.uk
www.dp-architects.co.uk

Check all dimensions and verify on site. Report any errors or omissions

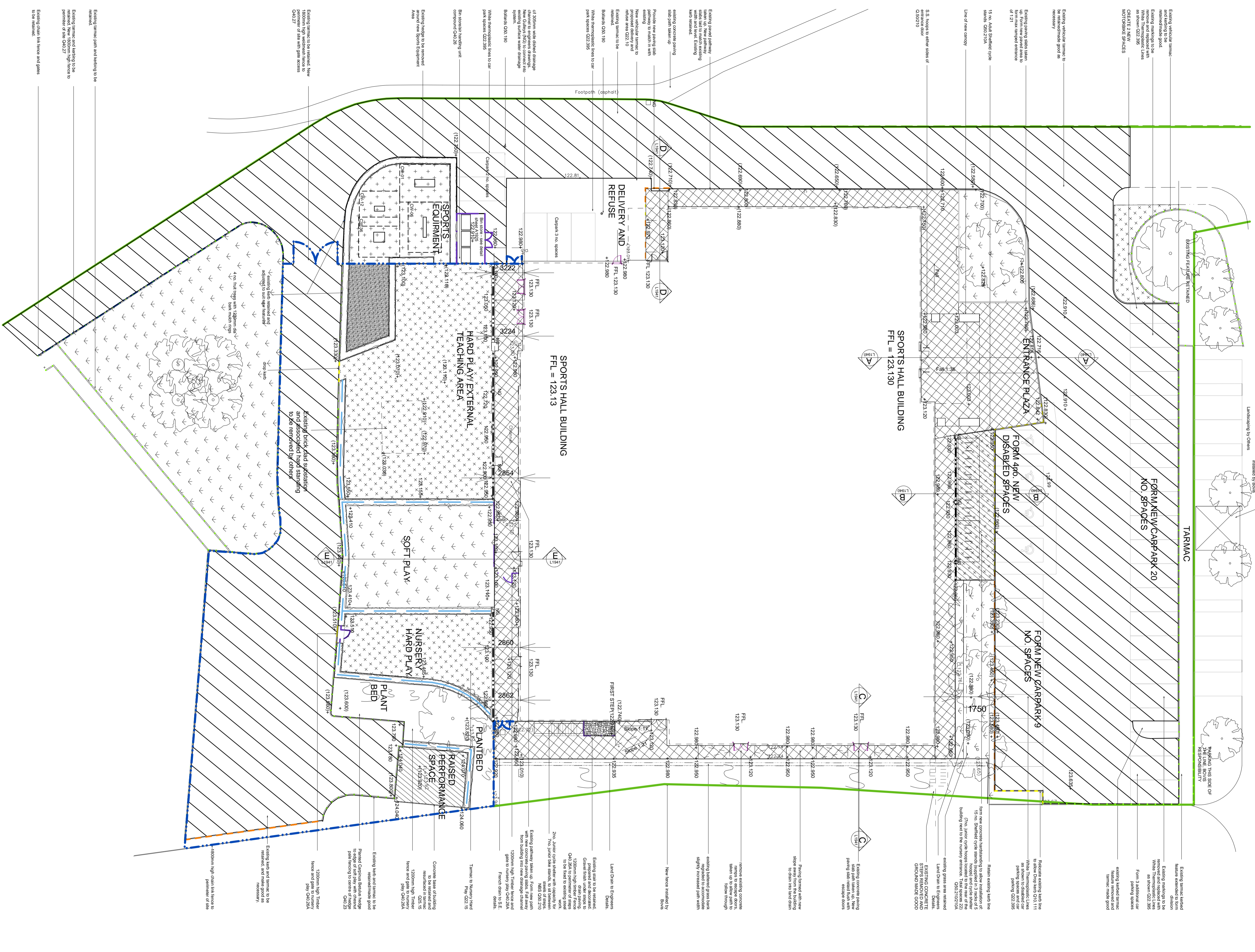

LEGEND

- Standard Pin Kerb Q10.110
- Standard Concrete Kerb Q10.111
- Existing Concrete Kerb to be Retained Q10.111
- Drop Kerb Q10.111
- 1800mm/1200mm High Inner fill and mesh fencing Q40.26/25A
- 1800mm High wild mesh fence to form secure line Q40.27B
- Chestnut Pale Fencing Q40.23
- Boundary Line (No Fence)
- Dished channel
- Land Drain
- Tarmacadam, standard vehicular to be retained.
- Tarmacadam, standard vehicular Q22.10
- Proposed Pedestrian Tarmacadam Q22.15
- Bushes Concrete handstanding
- Paving Slabs Q25.315
- Grass
- Gravel
- Soil
- Existing level +100.00
- Proposed levels +0.00 to +10.000m
- OK = top of kerb
- DK = top of wall
- Proposed coordinates

Existing vehicle ramps: Existing ramps to be retained where possible. Existing ramps to be removed where necessary. Existing ramps to be replaced with new ramps. Existing ramps to be replaced with new ramps. Existing ramps to be replaced with new ramps.

Existing ground levels: Existing ground levels to be retained where possible. Existing ground levels to be removed where necessary. Existing ground levels to be replaced with new ground levels. Existing ground levels to be replaced with new ground levels.

Existing walls and fences: Existing walls and fences to be retained where possible. Existing walls and fences to be removed where necessary. Existing walls and fences to be replaced with new walls and fences. Existing walls and fences to be replaced with new walls and fences.

Existing trees and shrubs: Existing trees and shrubs to be retained where possible. Existing trees and shrubs to be removed where necessary. Existing trees and shrubs to be replaced with new trees and shrubs. Existing trees and shrubs to be replaced with new trees and shrubs.

Existing paths and walkways: Existing paths and walkways to be retained where possible. Existing paths and walkways to be removed where necessary. Existing paths and walkways to be replaced with new paths and walkways. Existing paths and walkways to be replaced with new paths and walkways.

Existing drainage: Existing drainage to be retained where possible. Existing drainage to be removed where necessary. Existing drainage to be replaced with new drainage. Existing drainage to be replaced with new drainage.

Existing services: Existing services to be retained where possible. Existing services to be removed where necessary. Existing services to be replaced with new services. Existing services to be replaced with new services.

Existing structures: Existing structures to be retained where possible. Existing structures to be removed where necessary. Existing structures to be replaced with new structures. Existing structures to be replaced with new structures.

Existing furniture: Existing furniture to be retained where possible. Existing furniture to be removed where necessary. Existing furniture to be replaced with new furniture. Existing furniture to be replaced with new furniture.

Existing lighting: Existing lighting to be retained where possible. Existing lighting to be removed where necessary. Existing lighting to be replaced with new lighting. Existing lighting to be replaced with new lighting.

Existing signage: Existing signage to be retained where possible. Existing signage to be removed where necessary. Existing signage to be replaced with new signage. Existing signage to be replaced with new signage.

Existing landscaping: Existing landscaping to be retained where possible. Existing landscaping to be removed where necessary. Existing landscaping to be replaced with new landscaping. Existing landscaping to be replaced with new landscaping.

Existing materials: Existing materials to be retained where possible. Existing materials to be removed where necessary. Existing materials to be replaced with new materials. Existing materials to be replaced with new materials.

Existing finishes: Existing finishes to be retained where possible. Existing finishes to be removed where necessary. Existing finishes to be replaced with new finishes. Existing finishes to be replaced with new finishes.

Existing colors: Existing colors to be retained where possible. Existing colors to be removed where necessary. Existing colors to be replaced with new colors. Existing colors to be replaced with new colors.

Existing textures: Existing textures to be retained where possible. Existing textures to be removed where necessary. Existing textures to be replaced with new textures. Existing textures to be replaced with new textures.

Existing sounds: Existing sounds to be retained where possible. Existing sounds to be removed where necessary. Existing sounds to be replaced with new sounds. Existing sounds to be replaced with new sounds.

Existing smells: Existing smells to be retained where possible. Existing smells to be removed where necessary. Existing smells to be replaced with new smells. Existing smells to be replaced with new smells.

Existing tastes: Existing tastes to be retained where possible. Existing tastes to be removed where necessary. Existing tastes to be replaced with new tastes. Existing tastes to be replaced with new tastes.

Existing feelings: Existing feelings to be retained where possible. Existing feelings to be removed where necessary. Existing feelings to be replaced with new feelings. Existing feelings to be replaced with new feelings.

Existing thoughts: Existing thoughts to be retained where possible. Existing thoughts to be removed where necessary. Existing thoughts to be replaced with new thoughts. Existing thoughts to be replaced with new thoughts.

Existing actions: Existing actions to be retained where possible. Existing actions to be removed where necessary. Existing actions to be replaced with new actions. Existing actions to be replaced with new actions.

Existing reactions: Existing reactions to be retained where possible. Existing reactions to be removed where necessary. Existing reactions to be replaced with new reactions. Existing reactions to be replaced with new reactions.

Existing responses: Existing responses to be retained where possible. Existing responses to be removed where necessary. Existing responses to be replaced with new responses. Existing responses to be replaced with new responses.

Existing behaviors: Existing behaviors to be retained where possible. Existing behaviors to be removed where necessary. Existing behaviors to be replaced with new behaviors. Existing behaviors to be replaced with new behaviors.

Existing attitudes: Existing attitudes to be retained where possible. Existing attitudes to be removed where necessary. Existing attitudes to be replaced with new attitudes. Existing attitudes to be replaced with new attitudes.

Existing values: Existing values to be retained where possible. Existing values to be removed where necessary. Existing values to be replaced with new values. Existing values to be replaced with new values.

Existing beliefs: Existing beliefs to be retained where possible. Existing beliefs to be removed where necessary. Existing beliefs to be replaced with new beliefs. Existing beliefs to be replaced with new beliefs.

Existing opinions: Existing opinions to be retained where possible. Existing opinions to be removed where necessary. Existing opinions to be replaced with new opinions. Existing opinions to be replaced with new opinions.

Existing judgments: Existing judgments to be retained where possible. Existing judgments to be removed where necessary. Existing judgments to be replaced with new judgments. Existing judgments to be replaced with new judgments.

Existing conclusions: Existing conclusions to be retained where possible. Existing conclusions to be removed where necessary. Existing conclusions to be replaced with new conclusions. Existing conclusions to be replaced with new conclusions.

Existing decisions: Existing decisions to be retained where possible. Existing decisions to be removed where necessary. Existing decisions to be replaced with new decisions. Existing decisions to be replaced with new decisions.

Existing actions: Existing actions to be retained where possible. Existing actions to be removed where necessary. Existing actions to be replaced with new actions. Existing actions to be replaced with new actions.

Existing reactions: Existing reactions to be retained where possible. Existing reactions to be removed where necessary. Existing reactions to be replaced with new reactions. Existing reactions to be replaced with new reactions.

Existing responses: Existing responses to be retained where possible. Existing responses to be removed where necessary. Existing responses to be replaced with new responses. Existing responses to be replaced with new responses.

Existing behaviors: Existing behaviors to be retained where possible. Existing behaviors to be removed where necessary. Existing behaviors to be replaced with new behaviors. Existing behaviors to be replaced with new behaviors.

Existing attitudes: Existing attitudes to be retained where possible. Existing attitudes to be removed where necessary. Existing attitudes to be replaced with new attitudes. Existing attitudes to be replaced with new attitudes.

Existing values: Existing values to be retained where possible. Existing values to be removed where necessary. Existing values to be replaced with new values. Existing values to be replaced with new values.

Existing beliefs: Existing beliefs to be retained where possible. Existing beliefs to be removed where necessary. Existing beliefs to be replaced with new beliefs. Existing beliefs to be replaced with new beliefs.

Existing opinions: Existing opinions to be retained where possible. Existing opinions to be removed where necessary. Existing opinions to be replaced with new opinions. Existing opinions to be replaced with new opinions.

Existing judgments: Existing judgments to be retained where possible. Existing judgments to be removed where necessary. Existing judgments to be replaced with new judgments. Existing judgments to be replaced with new judgments.

Existing conclusions: Existing conclusions to be retained where possible. Existing conclusions to be removed where necessary. Existing conclusions to be replaced with new conclusions. Existing conclusions to be replaced with new conclusions.

Existing decisions: Existing decisions to be retained where possible. Existing decisions to be removed where necessary. Existing decisions to be replaced with new decisions. Existing decisions to be replaced with new decisions.

This line should measure 100mm along x and y axes when printed