

This drawing is on a base produced by Wardell Armstrong (Drawing Number CA02305_01) which was an amalgamation of the Ordnance Survey digital topographical plan and the USAF base comprehensive plan dated Sept 1984 (revised Dec 1993 and amended Apr 2002) © Crown copyright 100035542

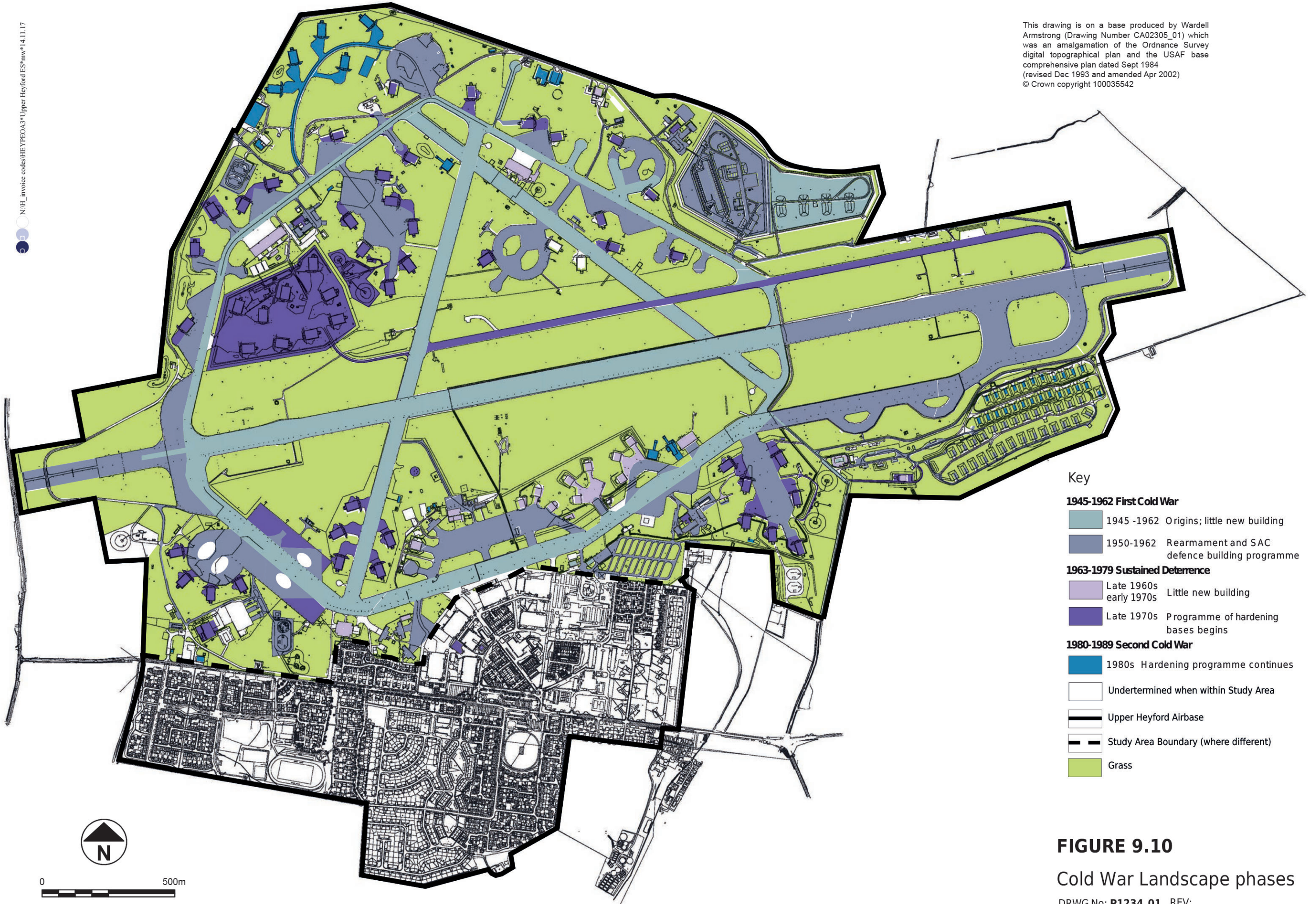

Key

1945-1962 First Cold War

- 1945 -1962 Origins; little new building
- 1950-1962 Rearmament and SAC defence building programme

1963-1979 Sustained Deterrence

- Late 1960s early 1970s Little new building
- Late 1970s Programme of hardening bases begins

1980-1989 Second Cold War

- 1980s Hardening programme continues
- Underdetermined when within Study Area
- Upper Heyford Airbase
- Study Area Boundary (where different)
- Grass

FIGURE 9.10

Cold War Landscape phases

DRWG No: **P1234_01** REV:

Date: 14.11.2017

Scale: 1:12500 @A3