

EXISTING SIGN 1 AND 2



EXISTING SIGN 3



EXISTING SIGN 1 AND 3

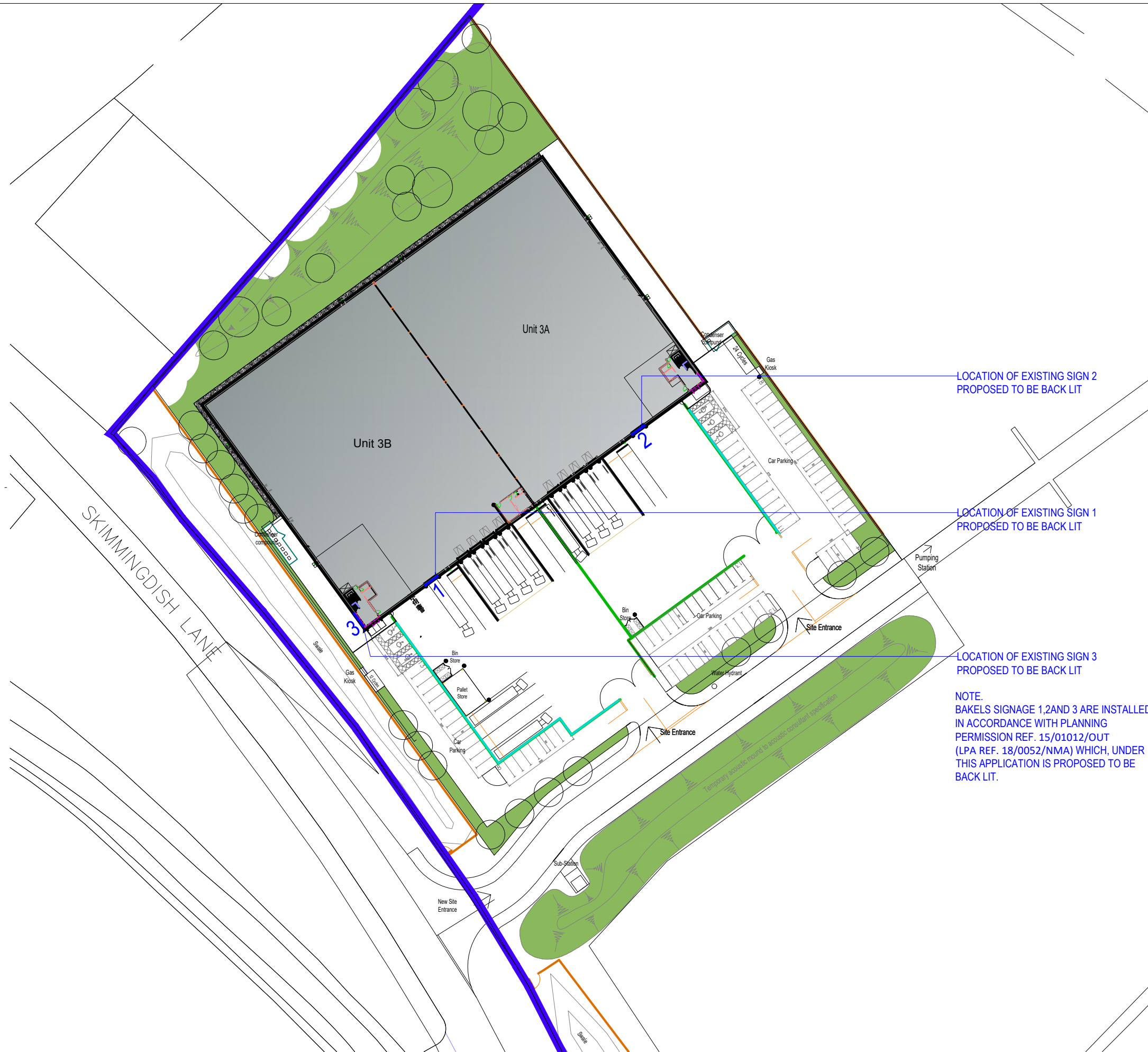

LOCATION OF EXISTING SIGN 2  
PROPOSED TO BE BACK LIT

LOCATION OF EXISTING SIGN 1  
PROPOSED TO BE BACK LIT

LOCATION OF EXISTING SIGN 3  
PROPOSED TO BE BACK LIT

NOTE:  
BAKELS SIGNAGE 1, 2 AND 3 ARE INSTALLED  
IN ACCORDANCE WITH PLANNING  
PERMISSION REF. 15/01012/OUT  
(LPA REF. 18/0052/NMA) WHICH, UNDER  
THIS APPLICATION IS PROPOSED TO BE  
BACK LIT.

**NOTES**  
All dimensions and levels to be checked by Contractor and verified before work commences; dimensions must be not be scaled from this drawing.  
Copyright reserved.

**EC REGULATIONS - GENERAL NOTE**  
Where reference is made on this drawing to British Standards or to specific manufacturer's products or trade names, this is intended to indicate a minimum acceptable standard of performance etc. Materials and components conforming to an equivalent European Standard may be used and supporting evidence shall be produced at tender stage to confirm fitness for purpose.

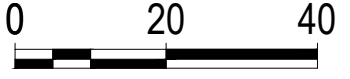

Scale Bar (m) 1:1000 @A3

**KEY:**  
Ownership Boundary  
Difference

P2	PLANNING ISSUE	10.10.2018
P	PLANNING ISSUE	31.07.2018

revisions

**PLANNING**

Threeways House  
36 George Street, Oxford OX1 2BJ  
Tel: 01865 260 600

One Bridge Wharf  
156 Caledonian Road, London N1 9UU  
Tel: 020 7636 6833

e-mail: info@tmd-surveyors.co.uk  
www.tmd-surveyors.co.uk



Project  
**LINK9- SKIMMINGDISH LANE  
UNIT 3A & 3B  
BICESTER**

Drawing:  
**LOCATION OF EXISTING SIGNS**

Scale: 1:500@A1-1:1000@A3	Date: June 2017	Drawn By: AB	Checked By: NEM
Job No. 20004	Orig. No. AP01	Rev'n P P2	