

NOTES

1. CONTRACTORS MUST CHECK ALL DIMENSIONS ON SITE. ONLY FIGURED DIMENSIONS ARE TO BE WORKED FROM. DISCREPANCIES MUST BE REPORTED TO THE ARCHITECT OR ENGINEER BEFORE PROCEEDING. © THIS DRAWING IS COPYRIGHT.
2. REPRODUCED FROM OS SITEMAP © BY PERMISSION OF ORDNANCE SURVEY® ON BEHALF OF THE CONTROLLER OF HER MAJESTY'S STATIONERY OFFICE. © CROWN COPYRIGHT 2008. ALL RIGHTS RESERVED. LICENCE NUMBER 100007126.
3. UNTIL TECHNICAL APPROVAL HAS BEEN OBTAINED FROM THE RELEVANT AUTHORITIES, ALL DRAWINGS ARE ISSUED AS PRELIMINARY AND NOT FOR CONSTRUCTION. SHOULD THE CONTRACTOR COMMENCE SITE WORK PRIOR TO APPROVAL BEING GIVEN IT IS ENTIRELY AT HIS OWN RISK.
4. PRINCIPLES TO BE DISCUSSED AND AGREED WITH OXFORDSHIRE COUNTY COUNCIL AS PART OF A SECTION 38 APPLICATION.

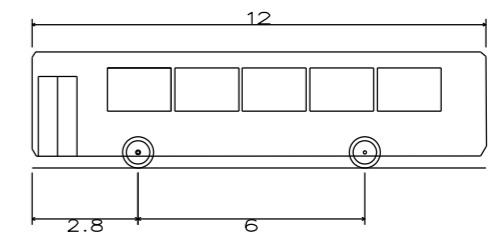

'Standard' Rigid Bus	
Overall Length	12.000m
Overall Width	2.550m
Overall Body Height	3.069m
Min Body Ground Clearance	0.309m
Track Width	2.350m
Lock to Lock Time	4.00s
Wall to Wall Turning Radius	10.771m

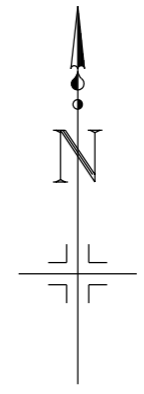
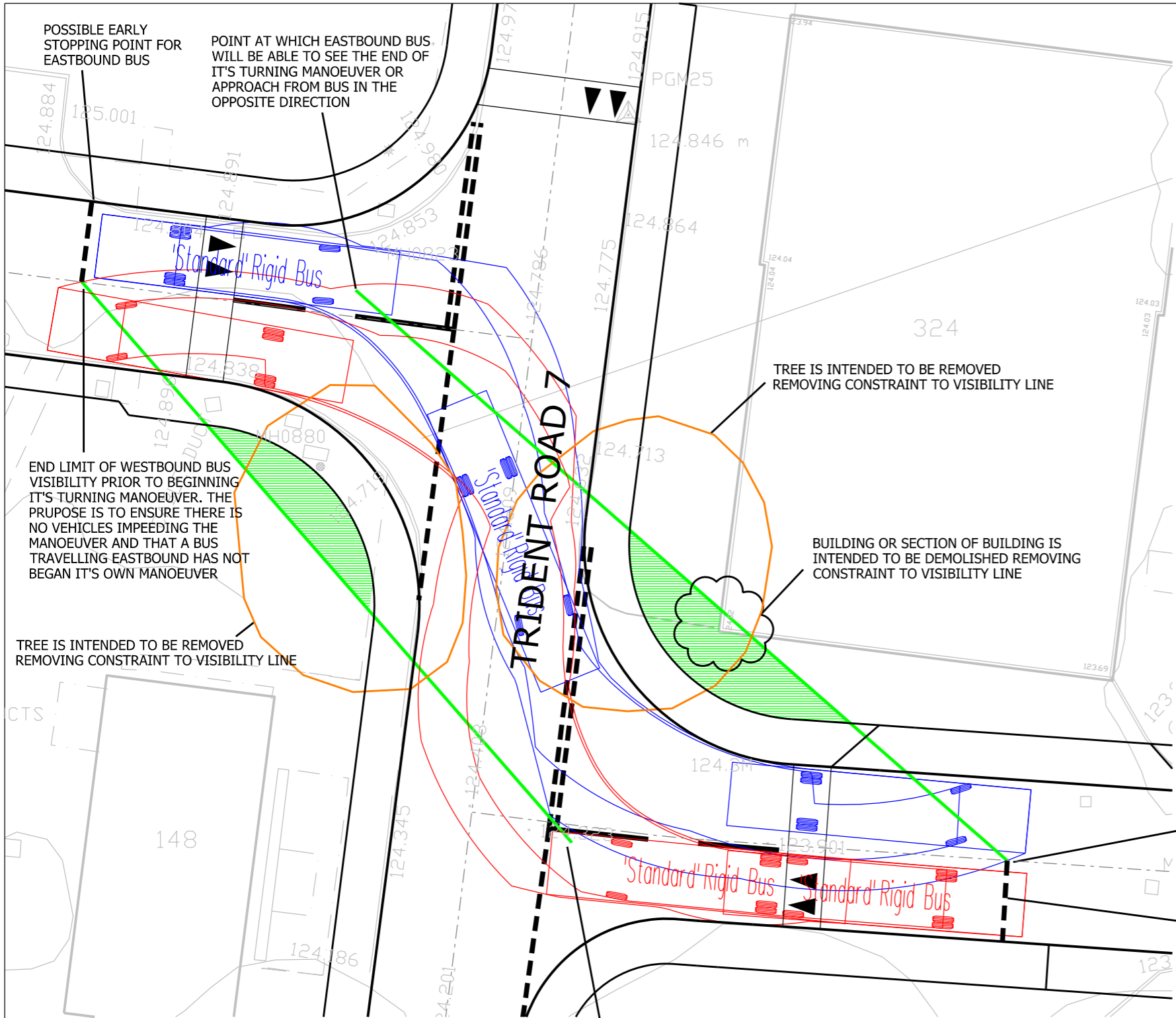

END LIMIT OF EASTBOUND BUS VISIBILITY PRIOR TO BEGINNING IT'S TURNING MANOEUVRE. THE PRUPOSE IS TO ENSURE THERE IS NO VEHICLES IMPEEDING THE MANOEUVRE AND THAT A BUS TRAVELLING WESTBOUND HAS NOT BEGAN IT'S OWN MANOEUVRE

A	ANNOTATION ADDED	AT	JF	24.04.18	
REVISION	DESCRIPTION	DRAWN	CHECKED	DATE	
	PRELIMINARY <input checked="" type="checkbox"/>	INFORMATION <input type="checkbox"/>	TENDER <input type="checkbox"/>	CONSTRUCTION <input type="checkbox"/>	AS BUILT <input type="checkbox"/>



WOODS HARDWICK
ARCHITECTS, ENGINEERS AND DEVELOPMENT CONSULTANTS

TITLE **CAMP ROAD
UPPER HEYFORD**

DETAILS **TRIDENT ROADS
JUNCTION TRACKING**

15-17 GOLDINGTON ROAD
BEDFORD, MK40 3NH
T. +44 (0)1234 268862
FORT DUNLOP, FORT PARKWAY
BIRMINGHAM, B24 9FE
UNITED KINGDOM
T. +44 (0)121 6297784
MAIL@WOODSHARDWICK.COM
WWW.WOODSHARDWICK.COM

SCALE: 1:200 @ A3 DATE: OCTOBER 2017 DRAWN: AT CHK: AT

Please consider the environment before printing this drawing
Filepath: F:\Engineer

HEYF-SK342 A