

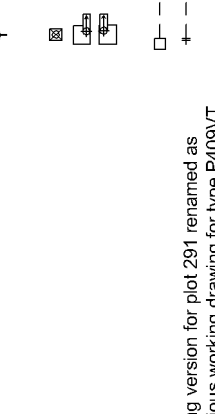

- movement joint
- 3.8N/m<sup>2</sup> blackwork
- 7.3N/m<sup>2</sup> blackwork
- 10.0N/m<sup>2</sup> blackwork
- 75mm O.A. metal stud partition (50mm studs) with 25mm glass mineral wool between studs
- 75mm/100mm O.A. timber stud partition (50mm/75mm studs)
- 125mm stud cladding wall (75mm studs)
- SDW
- b balanced flue boiler, wall mounted
- f refrigerator position
- oven position
- hob position
- washing machine position
- dishwasher position
- 30min fire resistant door
- ceiling mounted smoke detector
- ceiling mounted heat detector
- boiler/heating programmer fitted under boiler unless otherwise shown. Bottom of unit 250mm above ceiling
- wall mounted room thermostat. Bottom of unit 1500mm above FFL
- non-dedicated pendant light fitting with energy efficient bulb
- non-dedicated bathroom light fitting with energy efficient bulb
- LED downlighter
- light to underside of wall unit
- porch light wiring only, tail centre 1850mm above FFL
- light switch
- two way light switch
- top of plate 1200mm above FFL
- shaver point
- 3A fused double pole isolating switch (for cylinder)
- 3A fused double pole isolator (for boiler)
- fused switch
- unfused, unswitched spur
- oven spur
- 30A cooker panel
- grid switch
- 13A switched single socket for two-way between ceiling
- 13A switched double socket (TV, BT, SAT)
- media connector point
- tv aerial point
- telephone point
- incoming telephone connection
- consumer unit, 1350-1450 to centre of switches above FFL
- hot, cold water draw off points
- gas point
- semi-enclosed gas meter
- wall mounted gas meter box
- wall mounted electrical meter box
- 100mm soil vent pipe, insulated
- aav in roof space, where civil engineer requires slab to be externally vented. Termination is to be at file vent or near abutment
- standing waste
- radiator
- background ventilator with equivalent area of 1700mm<sup>2</sup>
- background ventilator with equivalent area of 4400mm<sup>2</sup>
- background ventilator with equivalent area of 5000mm<sup>2</sup>



MECHANICAL VENT CODES

recessed ceiling-mounted mechanical vents refer to standard detail for definition of mechanical vents product codes

scuff terminal ducting terminals

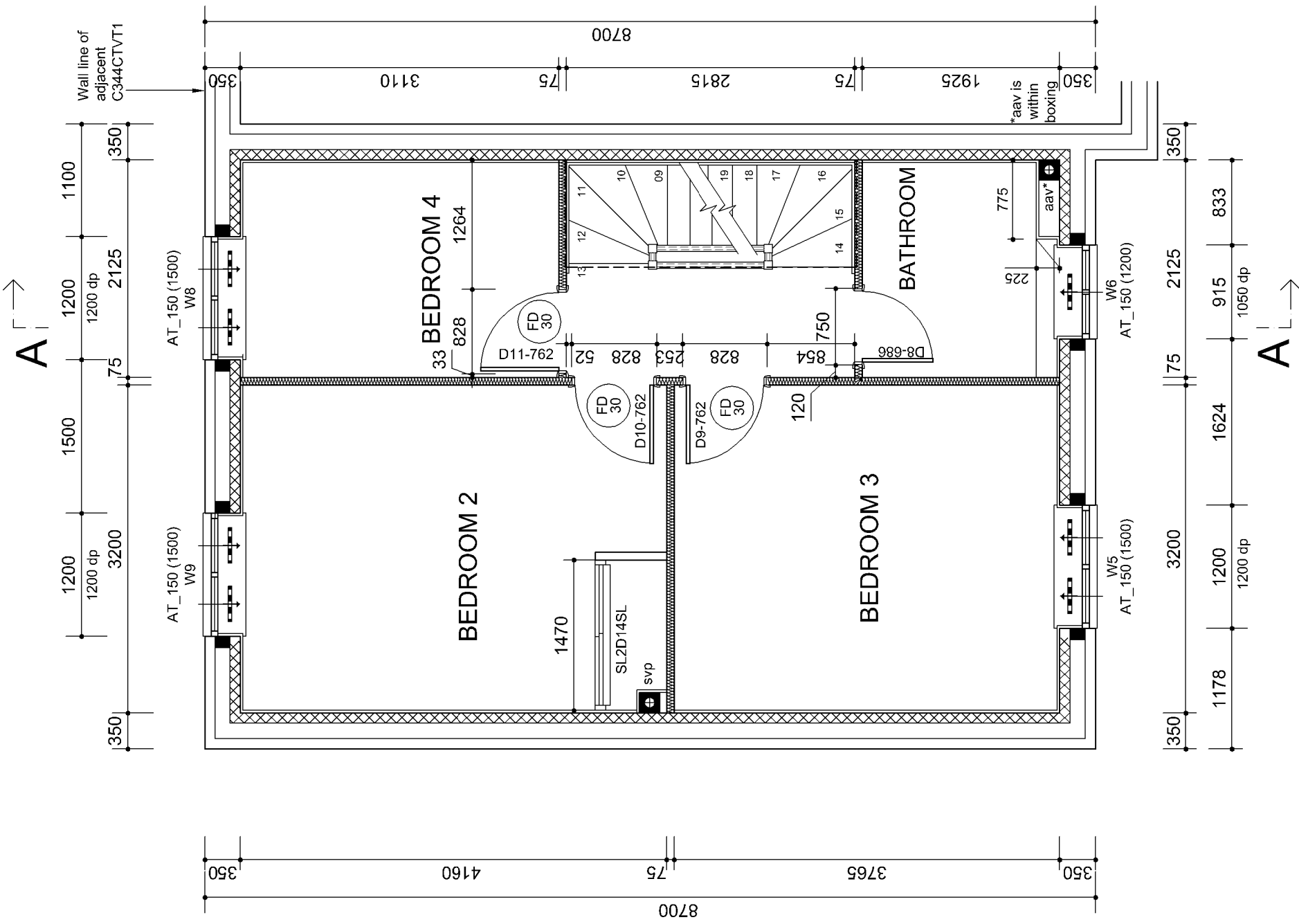

B 06.12.16 AH - Landmark planning version for plot 291 renamed as P409VT1 and extracted from previous working drawing for type P409VT. Changes include window W6 repositioned in bathroom & height increased to 1050mm. Rear wall alignment with adjacent plot 290 now flush.

A 24.11.16 AH - Drawing taken from Portfolio Rev A. Re-fitted for Upper Heyford B6. Internal door setting out added.

SITE/DRAWING REF:	B
Upper Heyford Phase B6	
DRAWING TITLE:	P409VT Setting Out First Floor

B6 PLOTS:  
AS - 291  
HANDED - None

FIRST FLOOR