

NOTES:

1. GRANITE SETTS SHALL BE 150 X 100 X 200 AND SHALL COMPLY WITH BS EN 1242. THEY SHALL BE LAID TO SHOW THE 100 X 200 SURFACE IN STRETCHER BOND.
2. JOINTS BETWEEN GRANITE SETTS SHALL BE NOMINALLY 15mm WIDE AND SHALL BE FILLED AND POINTED WITH DESIGNATION (I) MORTAR TO CLAUSE 2404, OR WITH A POLYESTER RESIN MORTAR WHERE SPECIFIED IN THE CONTRACT

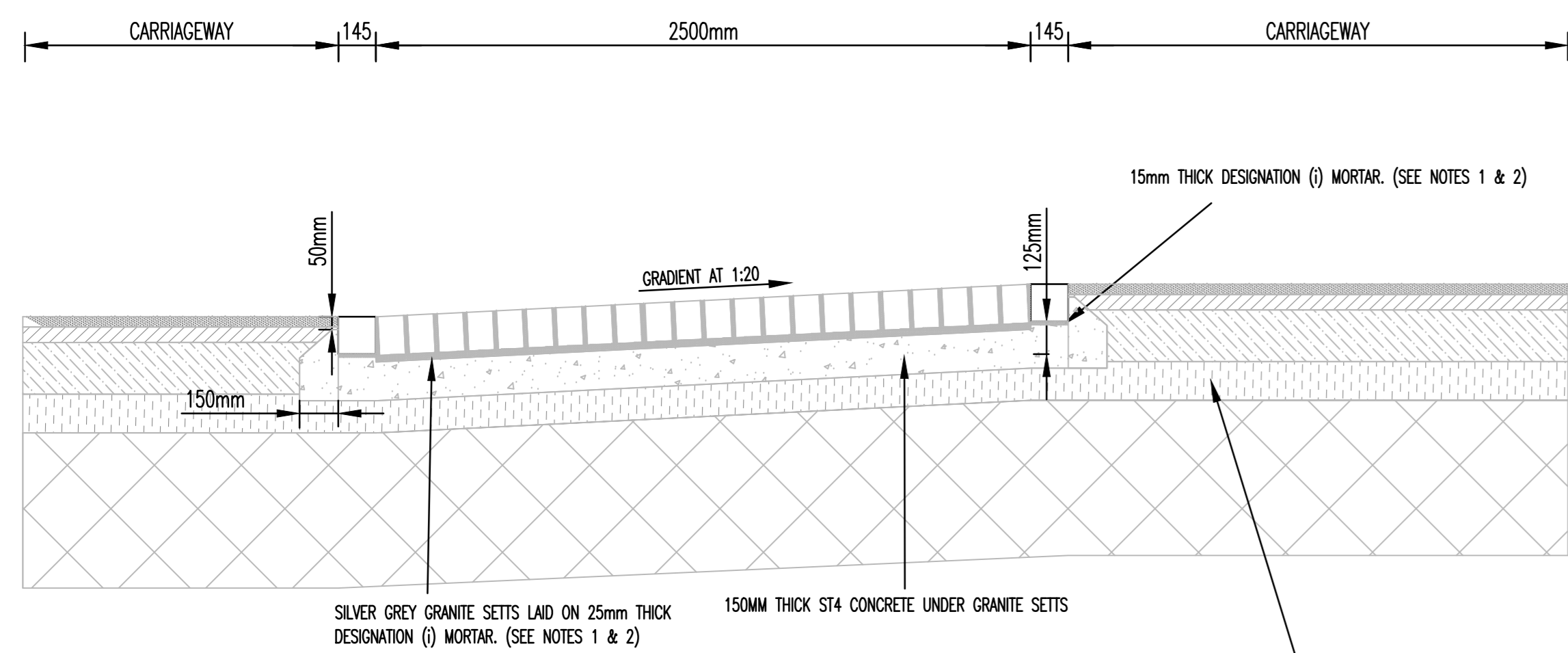

TYPICAL SECTION THROUGH MAGIC CARPET RAMP

SCALE 1:20

NOTES:

1. GRANITE SETTS SHALL BE 150 X 100 X 200 AND SHALL COMPLY WITH BS EN 1242. THEY SHALL BE LAID TO SHOW THE 100 X 200 SURFACE IN STRETCHER BOND.
2. JOINTS BETWEEN GRANITE SETTS SHALL BE NOMINALLY 15mm WIDE AND SHALL BE FILLED AND POINTED WITH DESIGNATION (I) MORTAR TO CLAUSE 2404, OR WITH A POLYESTER RESIN MORTAR WHERE SPECIFIED IN THE CONTRACT

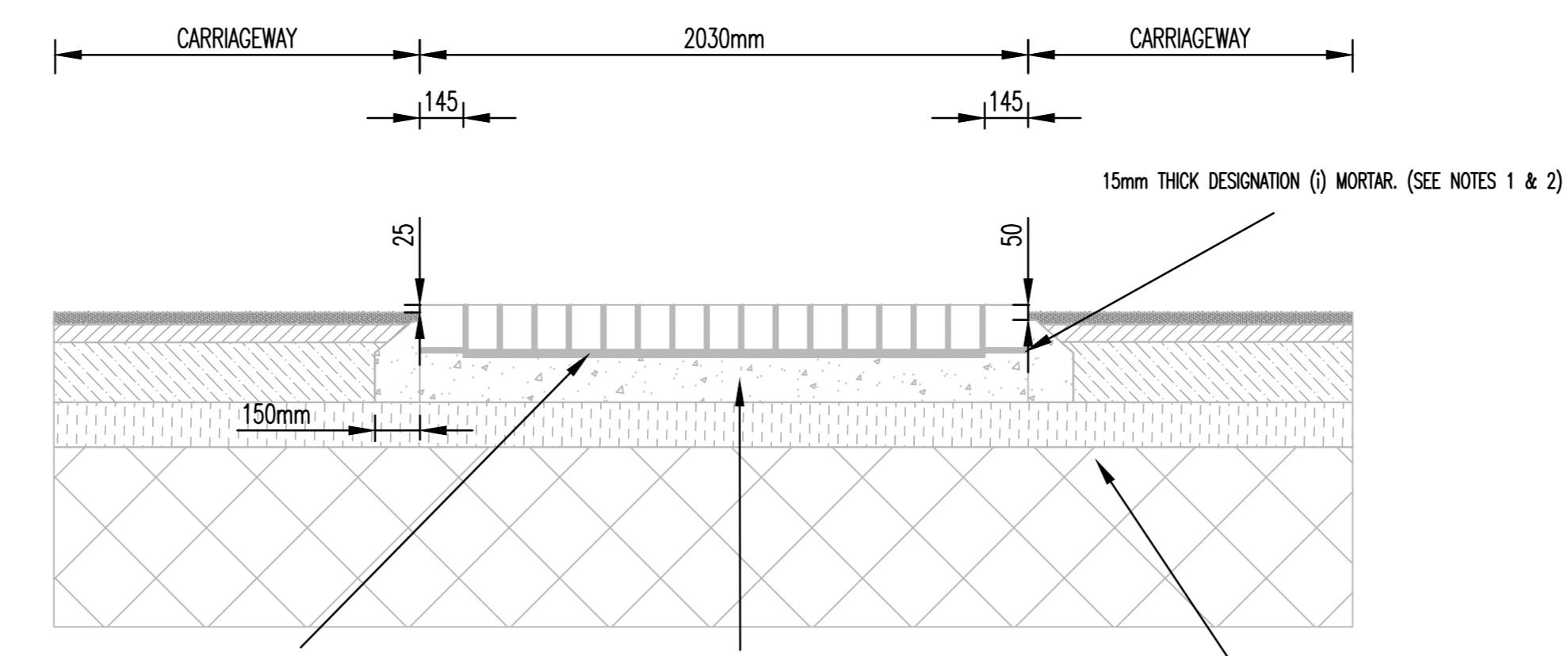

TYPICAL SECTION THROUGH BUMBLE STRIP

SCALE 1:20

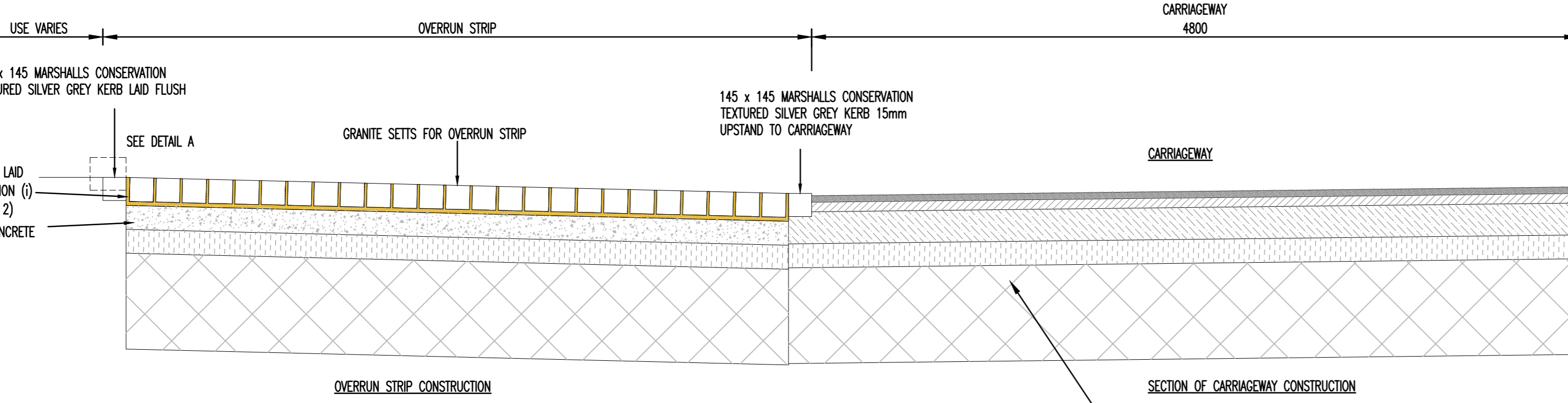
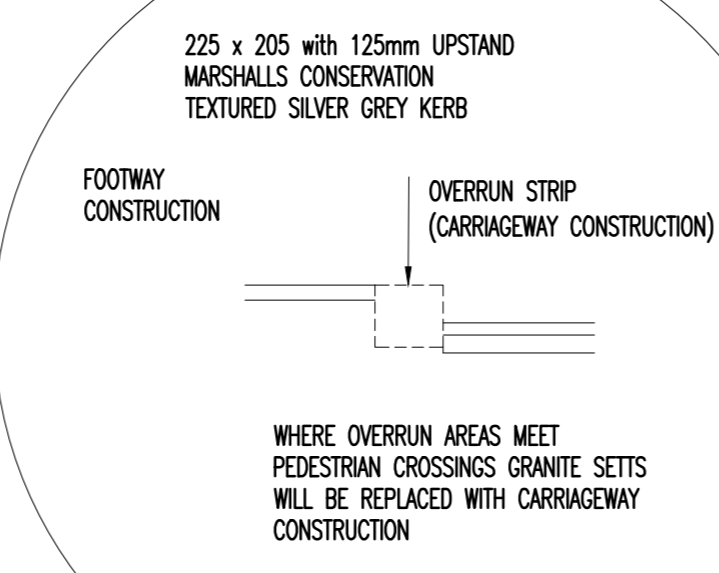
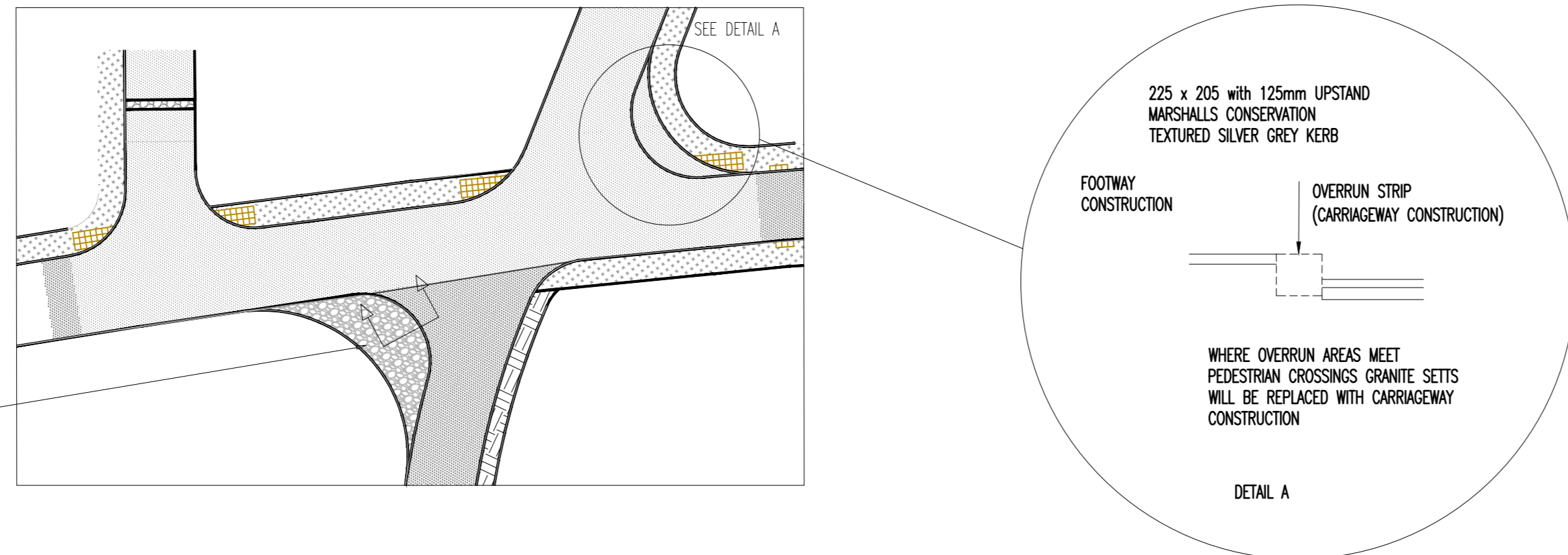

SECTION THROUGH OVERSTRIP & CARRAGEWAY

SCALE 1:25

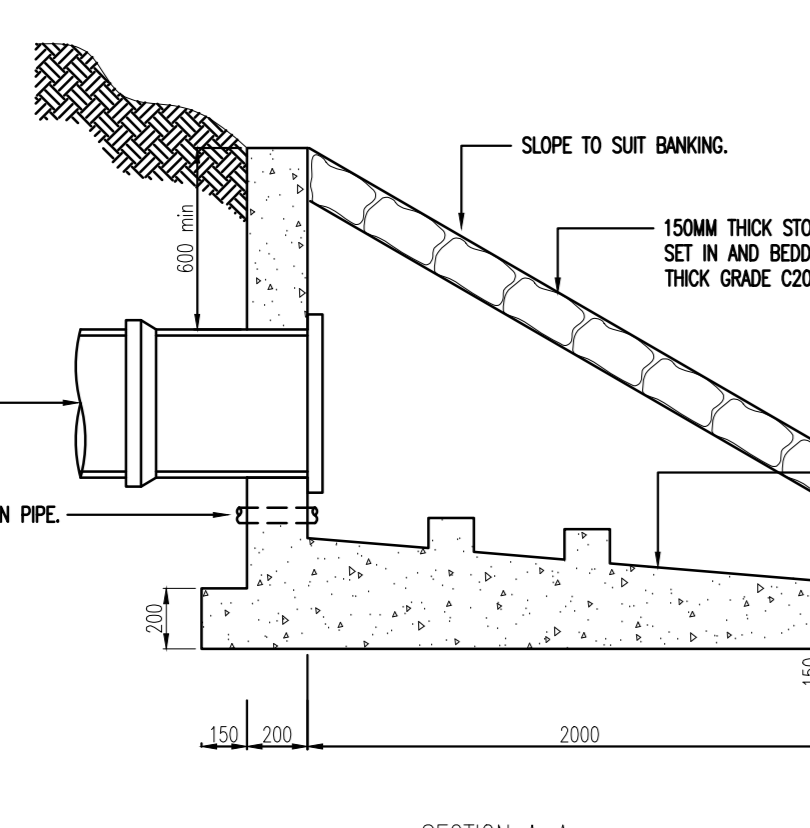

SECTION A-A

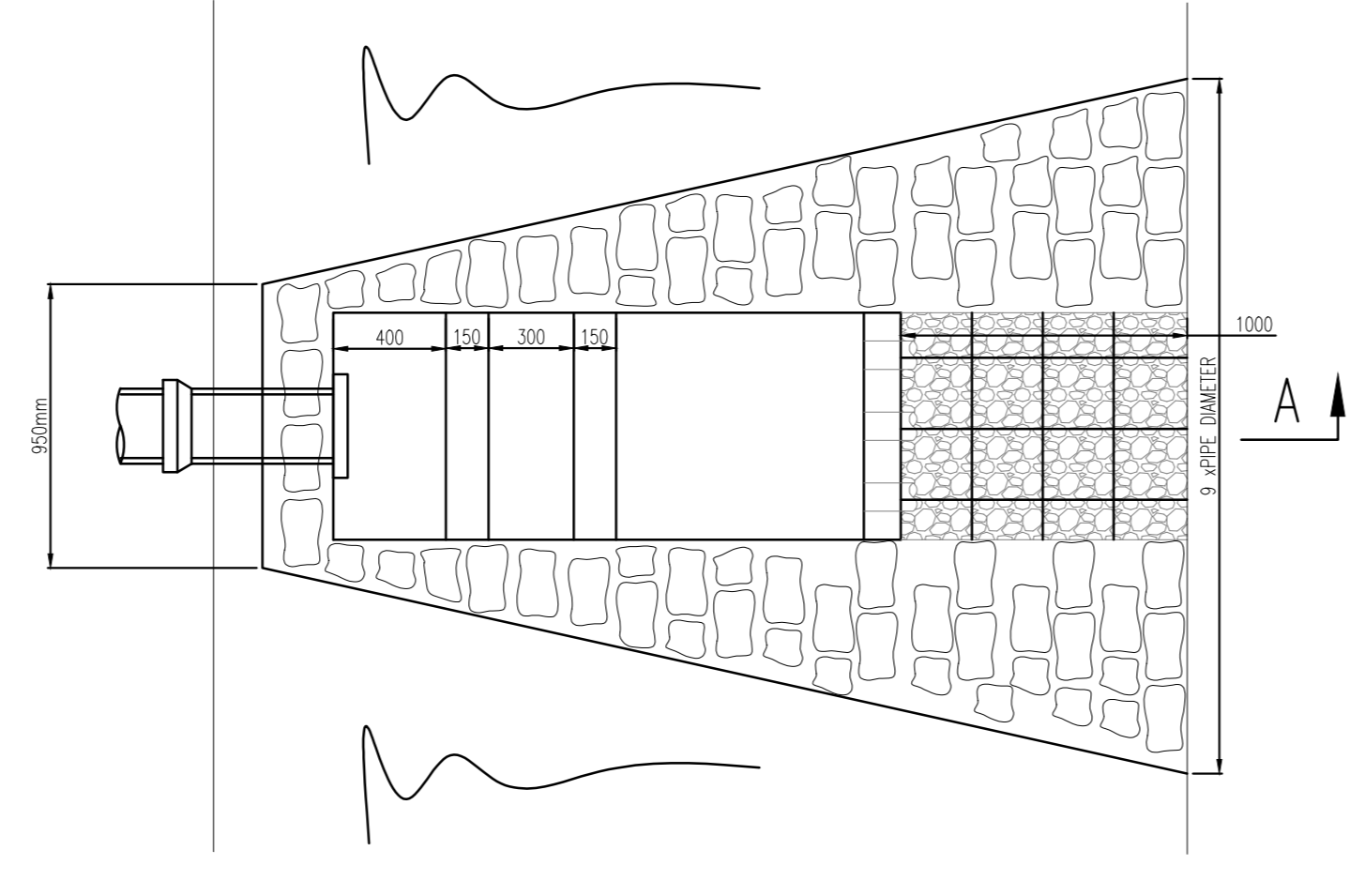

PLAN

TYPICAL DETAIL AT OUTFALL TO WATERCOURSE

SCALE 1:25

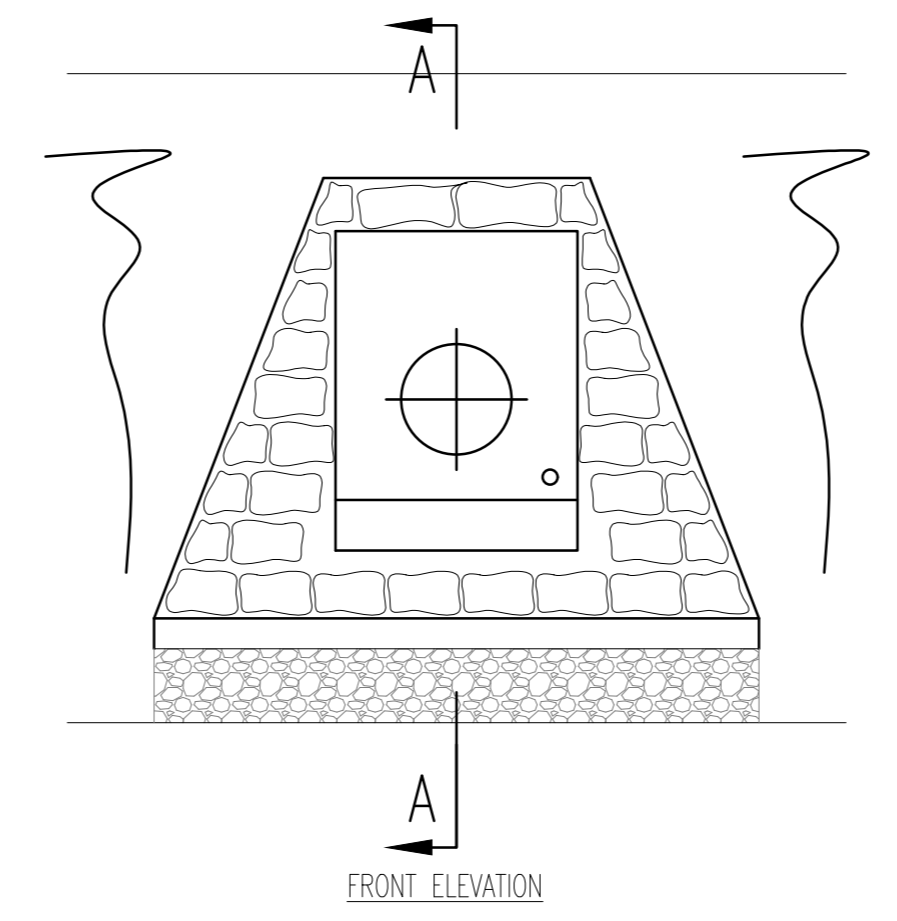

FRONT ELEVATION

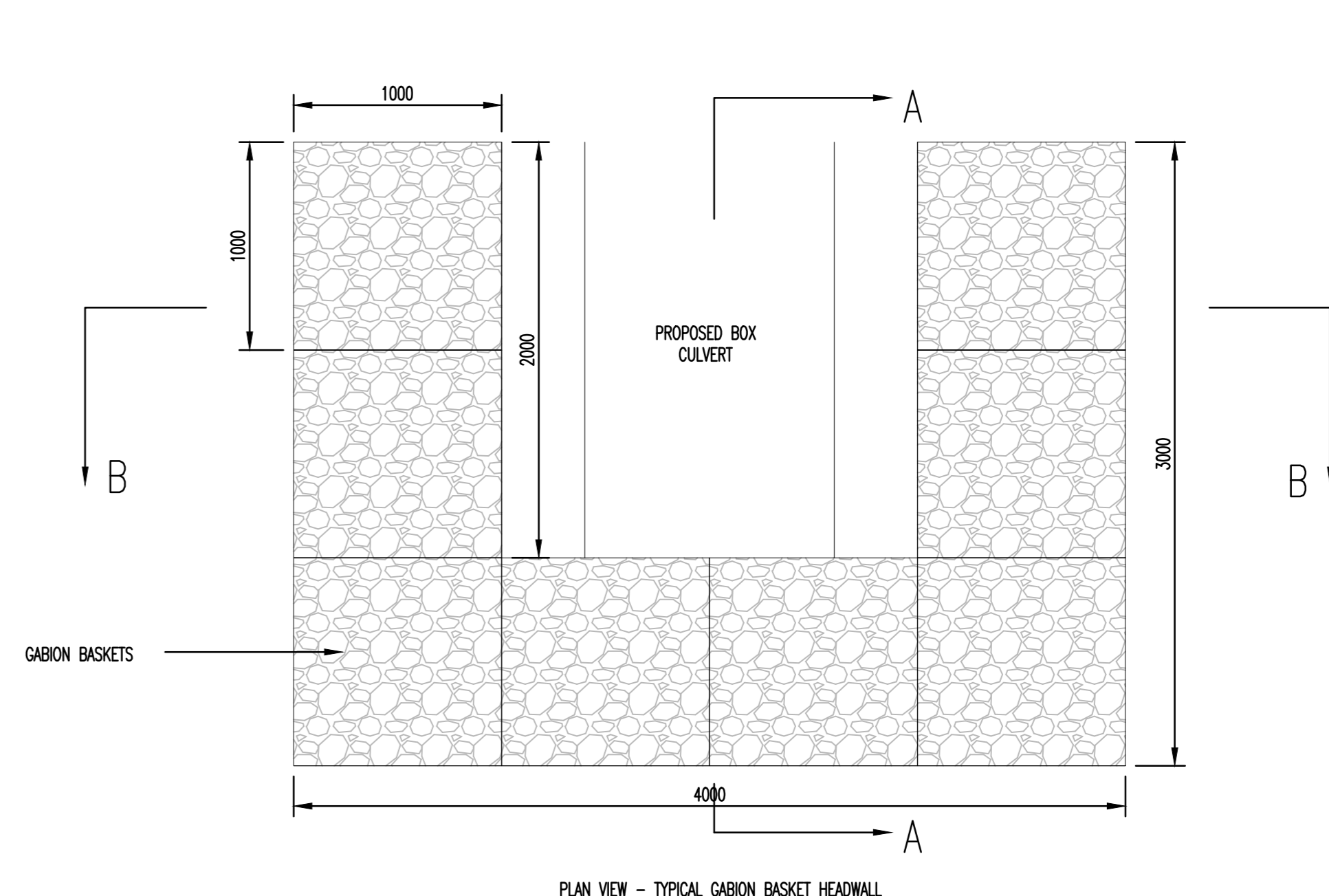

PLAN VIEW - TYPICAL GABION BASKET HEADWALL

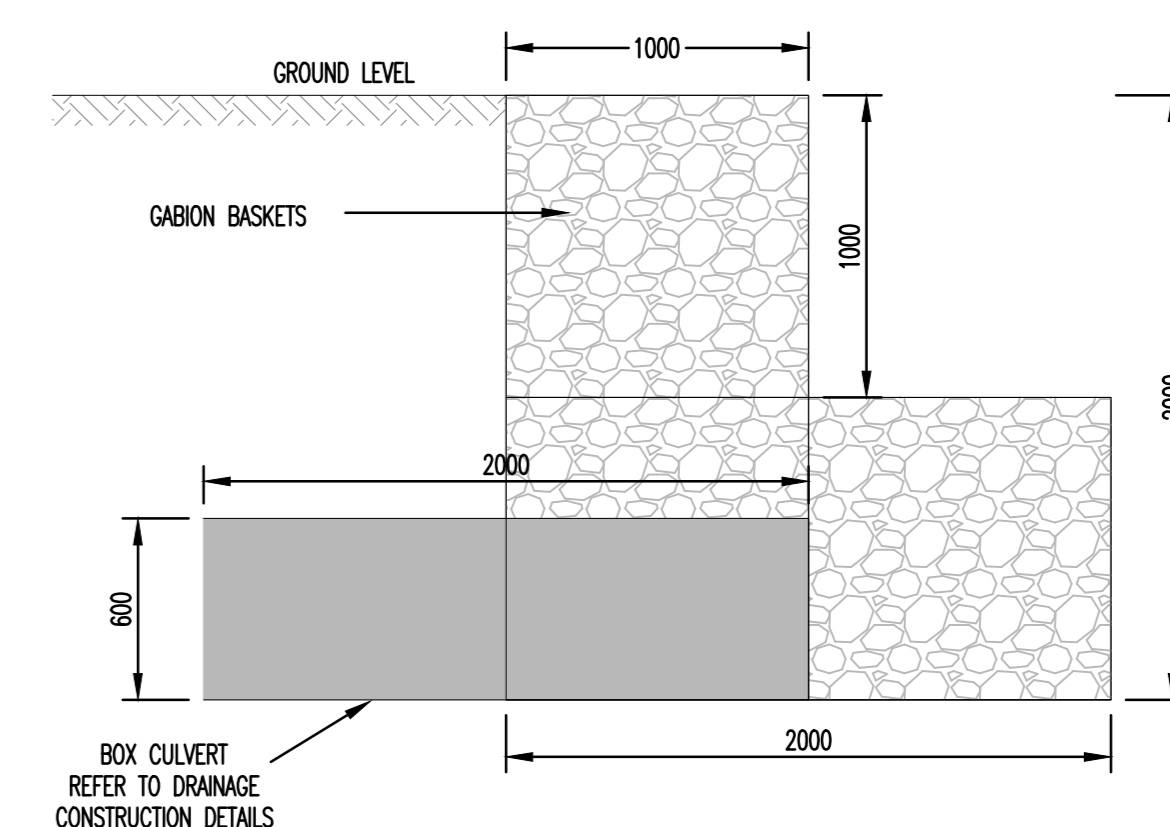

Section A - A

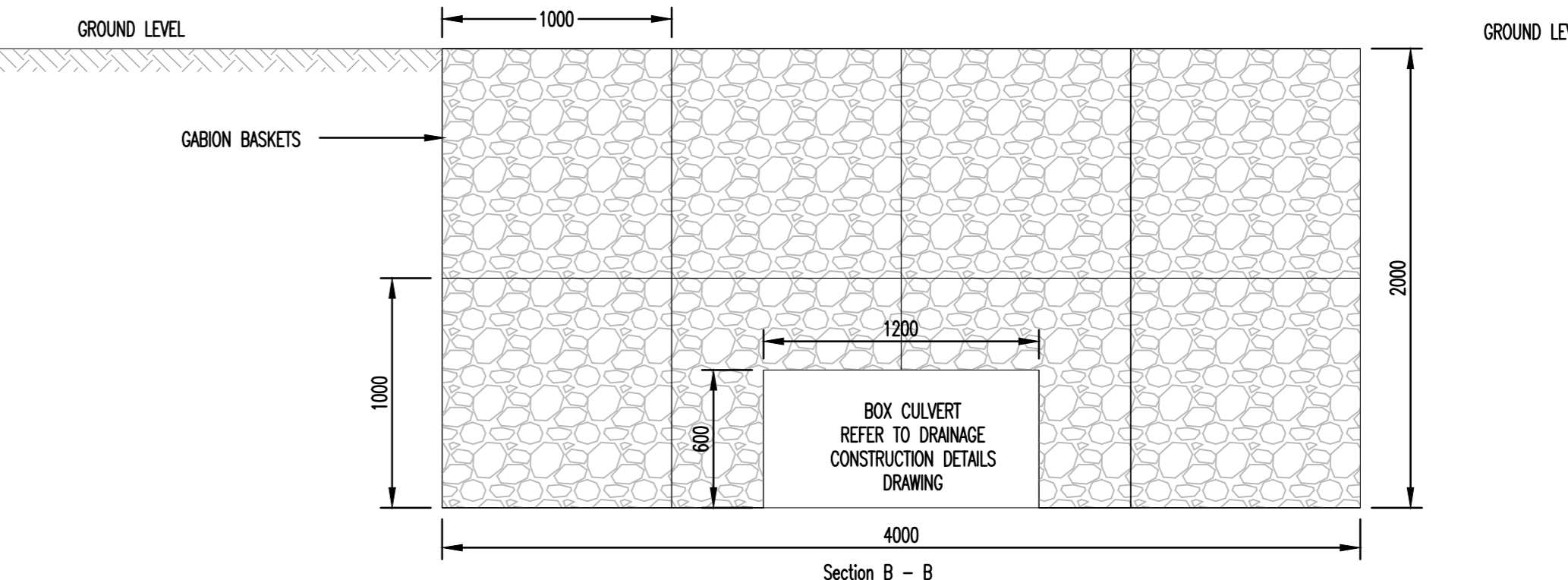

PROPOSED GABION BASKETS HEADWALL

SCALE 1:25

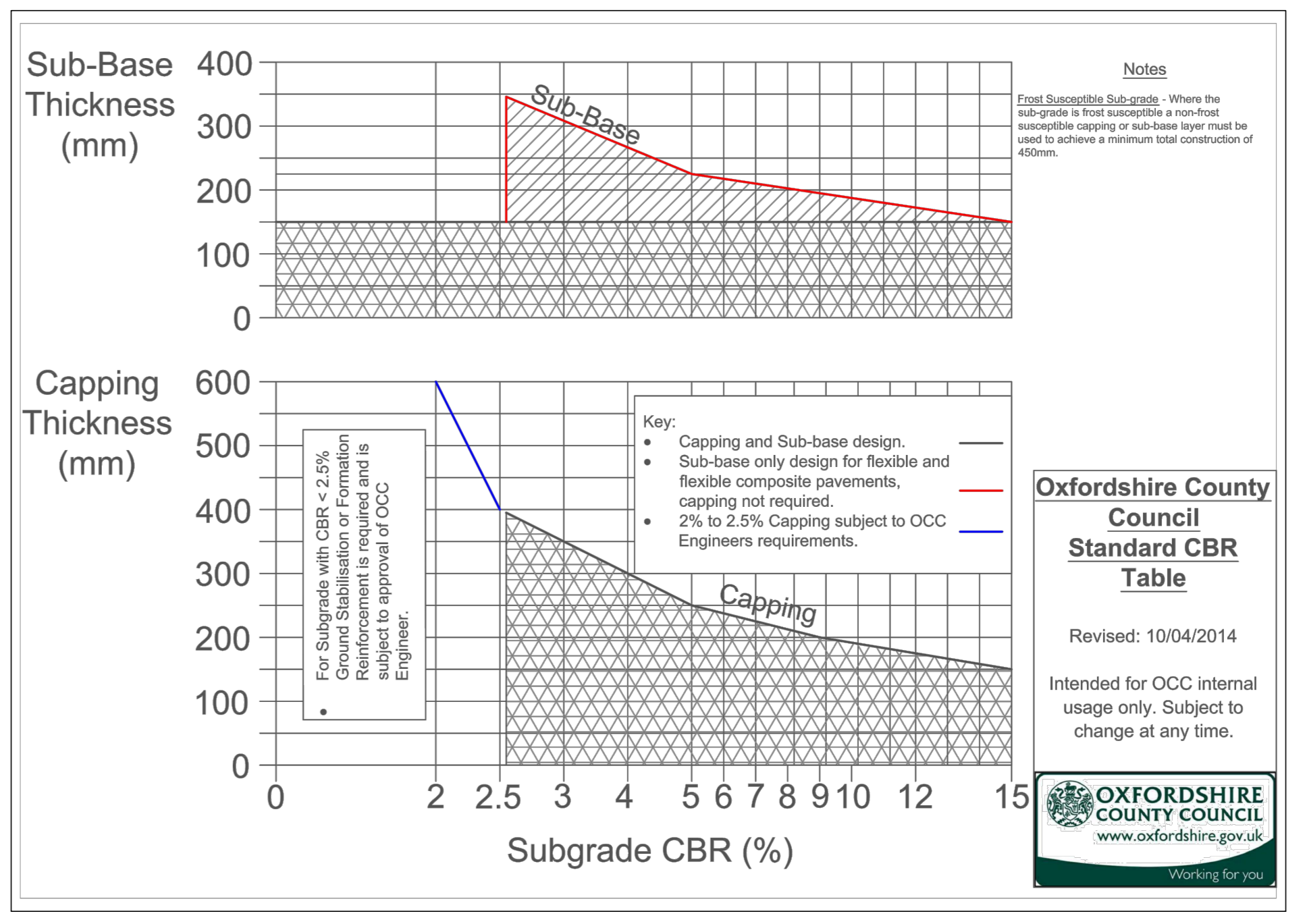

SCALE NTS

This drawing should not be scaled. Dimensions to be verified on site. Any discrepancies should be referred to the Engineer prior to work being put in hand. This drawing is the property of Waterman Infrastructure & Environment Limited, and the drawing is issued on the condition that it is not copied, reproduced, retained or disclosed to any unauthorised person, either wholly or in part without the consent in writing of Waterman Infrastructure & Environment Limited. Prokerala Street, Clark Street, London SE1 1QG. T 020 7928 7888. F 020 7922 0262

GENERAL NOTES

1. THIS DRAWING IS TO BE READ IN CONJUNCTION WITH ALL ENGINEERS, ARCHITECTS OR OTHER RELEVANT DRAWINGS AND SPECIFICATIONS.
2. ALL DIMENSIONS AND LEVELS ARE TO BE CHECKED ON SITE BY THE CONTRACTOR PRIOR TO PREPARING ANY WORKING DRAWINGS OR COMMENCING ON SITE.
3. THE CONTRACTOR MUST ENSURE AND WILL BE HELD RESPONSIBLE FOR THE OVERALL STABILITY OF THE BUILDING/STRUCTURE/EXCAVATION AT ALL STAGES OF THE WORK.
4. ALL WORK BY THE CONTRACTOR MUST BE CARRIED OUT IN SUCH A MANNER THAT ALL REQUIREMENTS UNDER THE HEALTH AND SAFETY AT WORK ACT ARE SATISFIED.
5. ALL WORK IS TO BE CARRIED OUT IN COMPLIANCE WITH THE REQUIREMENTS OF THE RELEVANT STATUTORY AUTHORITIES AND REGULATIONS.
6. ALL DIMENSIONS IN MILLIMETRES UNLESS OTHERWISE NOTED.

Rev	Date	Description	By
004	07.02.17	BUMBLE STRIP DETAIL ADDED. MAGIC CARPET RAMP DETAIL AMENDED. ISSUED FOR CONSTRUCTION.	AJ
003	13.09.16	DETAILS AMENDED, CBR TABLE ADDED, OUTFALL DETAIL TO WATERCOURSE ADDED, GABION HEADWALL DIMENSIONS ADDED, MAGIC CARPET DETAIL AMENDED, LAYOUT REVISED.	KK
002	31.05.16	ISSUED FOR SECTION 3B	KK
001	12.02.16	ISSUED FOR TENDER	KK

Project: **GRAVEN HILL, BICESTER**

Title: **CONSTRUCTION PHASE 1a**
CONSTRUCTION DETAIL 2 OF 2

Client: **GRAVEN HILL VILLAGE DEVELOPMENT COMPANY LIMITED**

Waterman

5th Floor, One Cornwell Street, Birmingham, B3 2DX
0121 212 7700
info@watermangroup.com www.watermangroup.com

CONSTRUCTION				
Drawn by	Checked by	Date	Revision	Number
KK	AJ	February 2016		CIV15119
Scale: 1:25	Scale: 1:25	Scale: 1:25	Scale: 1:25	Scale: 1:25
Author	Zone	Category	Number	Revision
C	SA	90	0418	E01