

### Legend:

#### Play Equipment

- ① 6.17000 Hexagonal Swing( 6 tyres)
- ② 6.51700 Balance Blocks
- ③ 6.06000 Jumping Disc, x5
- ④ 6.05000 Totter Beam
- ⑤ 4.14906 Platform House 4904
- ⑥ 6.27300 Wobble Dish
- ⑦ 4.24150 Swinging Horse, x2
- ⑧ 6.14520 Nest Swing
- ⑨ 6.51009 Climbing Structure 08
- ⑩ 9.02410 Sound Cushions, x4
- ⑪ 6.11620 Twin See-saw

#### Landscape Elements

- ⑫ 9.20000 Bench on legs with back, x2
- ⑬ 9.70000 Waste Bin, stainless steel
- ⑭ Grass Mats Safety Surface
- ⑮ Glacial Boulders, x4
- ⑯ Fallen Logs, 2
- ⑰ Stepping Logs, x8

← Gate, site entrance (proposed by others)

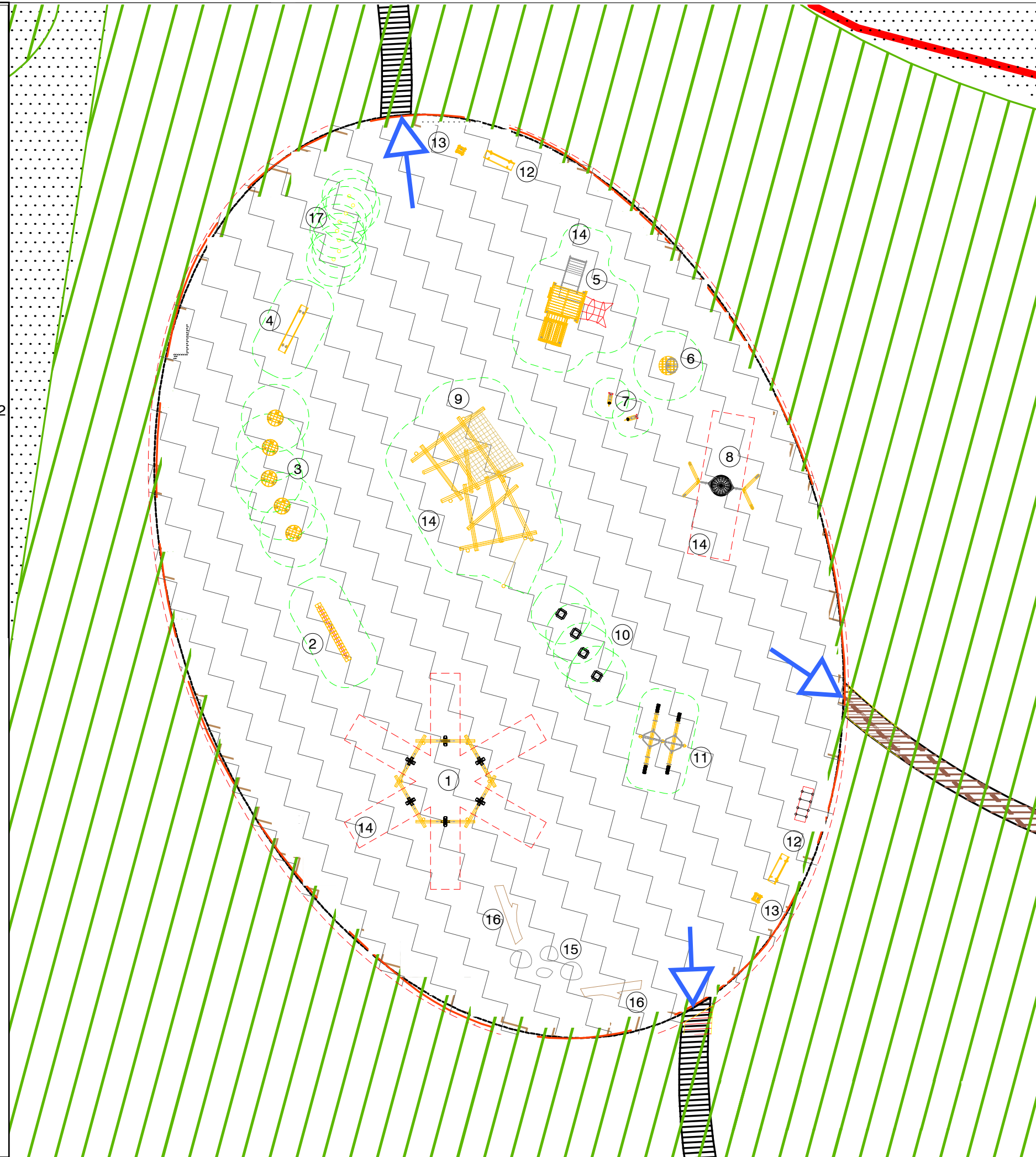

#### LEGEND

- EXISTING TREES, WOODLAND & VEGETATION TO BE RETAINED
- INDICATIVE TREE PLANTING
- INDICATIVE AMENITY GRASS Outside of scope of works
- INDICATIVE FOOTPATH/CYCLE WAY
- INDICATIVE AREA CONTAINING PLAY EQUIPMENT WITHIN EXISTING WOODLAND
- INDICATIVE EXTENT OF AREA WITHIN WHICH LE.A.P. ACTIVITIES TO BE ESTABLISHED
- BIKE RACKS



Project **Graven Hill, Bicester**

Title  
**Conceptual, 702 Play Area Proposal  
General Arrangement Plan**

Client  
  
**Graven Hill Village Development Company Limited**



COPYRIGHT: All rights to the design and equipment lie with Timberplay Ltd. and Richter GmbH. This drawing is the property of Timberplay Ltd. Copyright is reserved by them and the drawing is issued on the condition that it is not copied, reproduced, retained or disclosed to any unauthorized person either wholly or in part without the consent of Timberplay.

Drawing Status **PLANNING**

Designed by	Checked by <b>MR</b>	Quotation No <b>12391-S-01</b>
Drawn by <b>NK</b>	Date <b>29-11-17</b>	
Scales @ A3 <b>DO NOT SCALE</b> <small>work to figured dimensions only</small>		Kings C0281 - LEAP - 223 - PL

Publisher	Zone	Category	Number	Revision
			<b>702</b>	<b>B</b>