

**KEY**

- Constructed or approved FW drainage
- Constructed or approved SW drainage
- - - Proposed village centre FW drainage
- - - Proposed village centre SW drainage

**NOTES**

1. CONTRACTORS MUST CHECK ALL DIMENSIONS ON SITE. ONLY FIGURED DIMENSIONS ARE TO BE WORKED FROM. DISCREPANCIES MUST BE REPORTED TO THE ARCHITECT OR ENGINEER BEFORE PROCEEDING. © THIS DRAWING IS COPYRIGHT.
2. REPRODUCED FROM OS SITEMAP © BY PERMISSION OF ORDNANCE SURVEY® ON BEHALF OF THE CONTROLLER OF HER MAJESTY'S STATIONERY OFFICE. © CROWN COPYRIGHT 2008. ALL RIGHTS RESERVED. LICENCE NUMBER 100007126.
3. UNTIL TECHNICAL APPROVAL HAS BEEN OBTAINED FROM THE RELEVANT AUTHORITIES, ALL DRAWINGS ARE ISSUED AS PRELIMINARY AND NOT FOR CONSTRUCTION. SHOULD THE CONTRACTOR COMMENCE SITE WORK PRIOR TO APPROVAL BEING GIVEN IT IS ENTIRELY AT HIS OWN RISK.
4. LEVELS TO BE +/- 450mm.

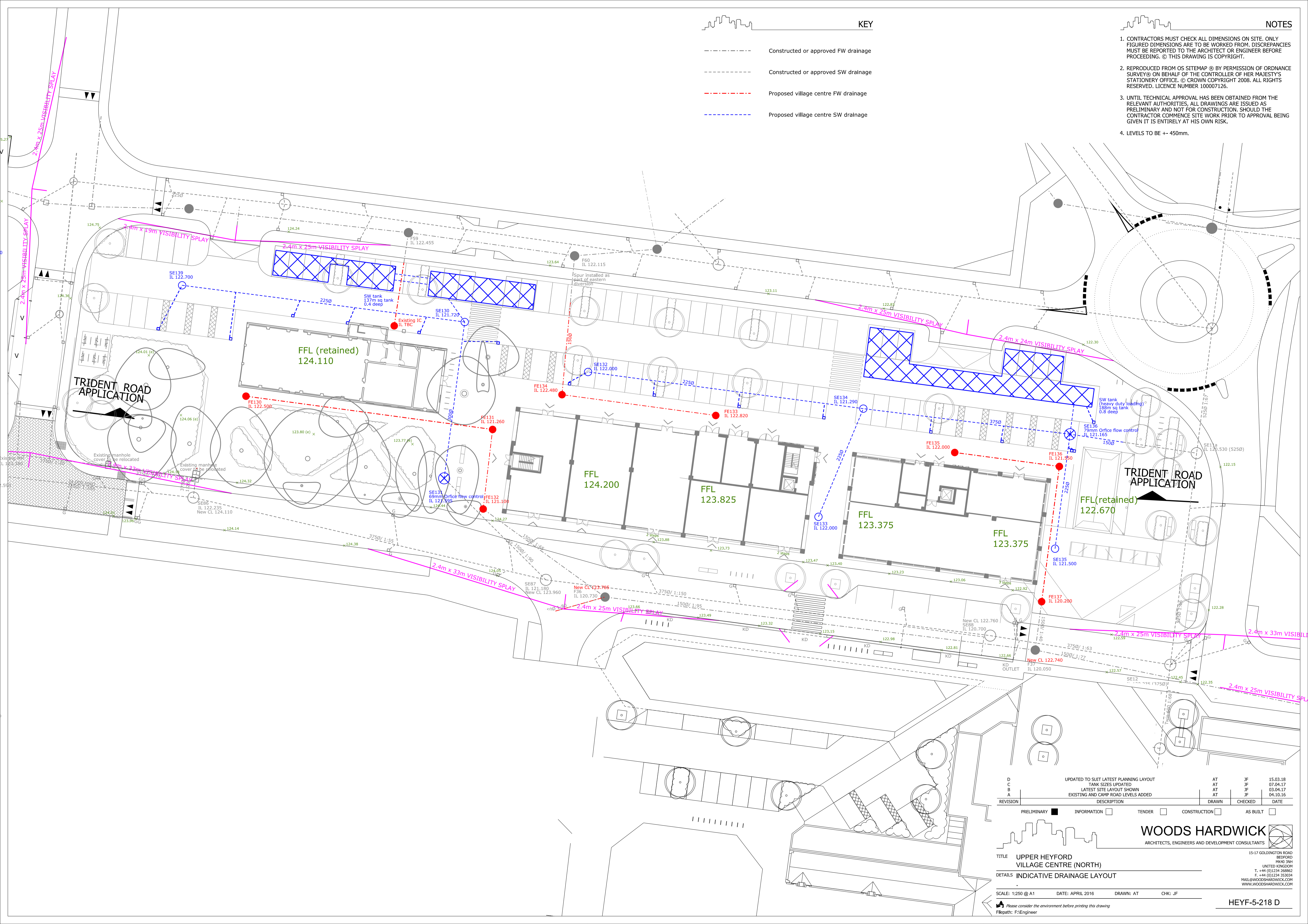

D	UPDATED TO SUIT LATEST PLANNING LAYOUT	AT	JF	15.03.18
C	TANK SIZES UPDATED	AT	JF	07.04.17
B	LATEST SITE LAYOUT SHOWN	AT	JF	03.04.17
A	EXISTING AND CAMP ROAD LEVELS ADDED	AT	JF	04.10.16

REVISION	DESCRIPTION	DRAWN	CHECKED	DATE
PRELIMINARY	<input checked="" type="checkbox"/>			
INFORMATION	<input type="checkbox"/>			
TENDER	<input type="checkbox"/>			
CONSTRUCTION	<input type="checkbox"/>			
AS BUILT	<input type="checkbox"/>			

**WOODS HARDWICK**  
ARCHITECTS, ENGINEERS AND DEVELOPMENT CONSULTANTS

TITLE: UPPER HEYFORD VILLAGE CENTRE (NORTH)  
DETAILS: INDICATIVE DRAINAGE LAYOUT

SCALE: 1:250 @ A1    DATE: APRIL 2016    DRAWN: AT    CHK: JF

Please consider the environment before printing this drawing  
Filepath: F:\Engineer

15-17 GOLDINGTON ROAD  
BEDFORD MK40 3RH  
UNITED KINGDOM  
T. +44 (0)1234 268862  
F. +44 (0)1234 353034  
MAIL@WOODSHARDWICK.COM  
WWW.WOODSHARDWICK.COM

HEYF-5-218 D