

NOTES:
 RESPONSIBILITY IS NOT ACCEPTED FOR ERRORS MADE BY OTHERS IN SCALING FROM THIS DRAWING.
 ALL CONSTRUCTION INFORMATION SHOULD BE TAKEN FROM FIGURED DIMENSIONS ONLY. NO WARRANTY AS TO THE PRECISION OF THIS DRAWING IS GIVEN NOR SHOULD BE INFERRED. CONSTRUCTION DRAWINGS TO BE READ IN CONJUNCTION WITH SPECIFICATIONS, SCHEDULES AND DRAWINGS FROM STRUCTURAL AND MECHANICAL ENGINEERS.

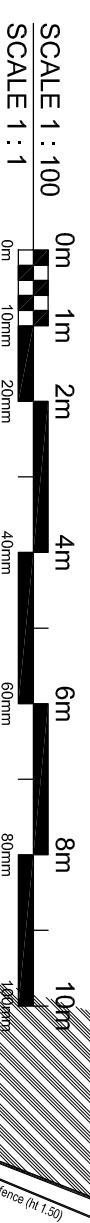
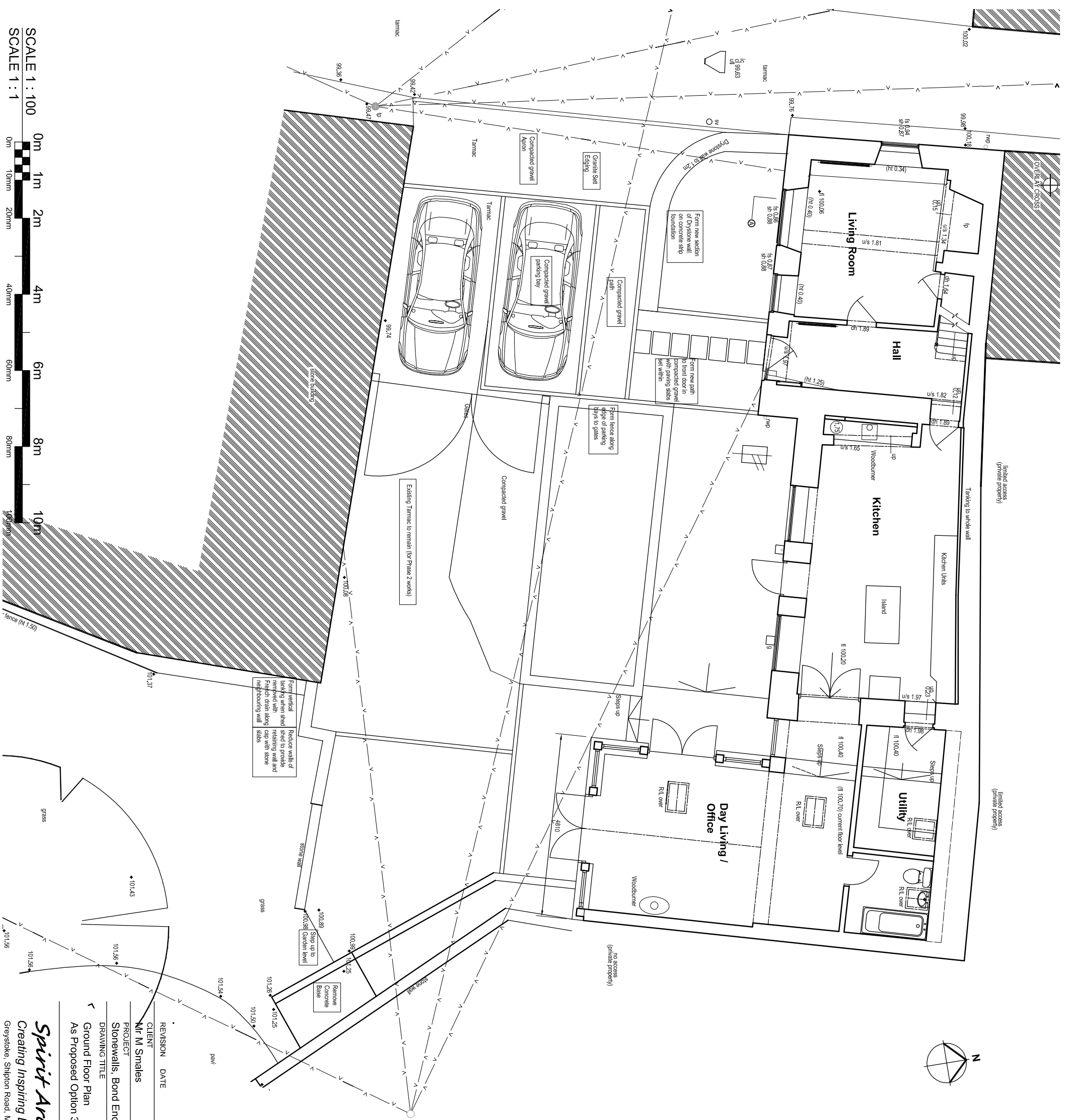

REVISION	DATE	DRAWN	CHECKED	DESCRIPTION
CLIENT	Mr M Smales			
PROJECT	Stonewells, Bond End Lane, Sibford Gower, OX15 5RT			
DRAWING TITLE	Ground Floor Plan			
	As Proposed Option 3			

SCALE	DATE
1:100 @ A3	December 2014
DRAWN	CHECKED
MH	MH
JOB NUMBER	DRAWING NO.
1306	12
	REVISION
	C

Spirit Architecture
 Creating Inspiring Design & Sustainable Architecture
 Grey Stoke, Siplinton Road, Milton-under-Wychwood, Chipping Norton, OX7 6JT Tel: 01865 349012 E: enquiries@spiritarchitecture.co.uk

© ALL RIGHTS RESERVED
 NO PARTS OF THIS DRAWING TO BE REPRODUCED WITHOUT THE WRITTEN PERMISSION OF SPIRIT ARCHITECTURE