

NOTES

EXISTING GULLIES TO BE REPOSITIONED TO NEW KERB LINE - EXISTING CONNECTIONS TO BE REVISED.

- KEY**
- EXTENT OF PROPOSED CARRIAGEWAY WIDENING
 - PROPOSED NEW HB2 KERB
 - PROPOSED NEW BULLNOSED KERB
 - PROPOSED DROPPED KERB
 - EXISTING HB2 KERB TO BE BROKEN OUT
 - PROPOSED NEW ACCESS ONTO FUTURE PLOT
 - PROPOSED VIS SPLAY (4.5m X 70m)
 - PROPOSED NEW ACCESS ONTO FUTURE PLOT
 - PROPOSED BIRDSMOUTH FENCE AS PER OCC DETAIL

ENGINEERING LAYOUT SCALE 1:250

TSRGD REF	DIMENSIONS
1003	
1023	
1009	
1039	
1038	
1029	
1040.2	
1018.1	
602	
956	
966	

NOTE: DRAINAGE PROPOSALS TO BE CONFIRMED UPON RECEIPT OF EXISTING HIGHWAY DRAINAGE PLANS.

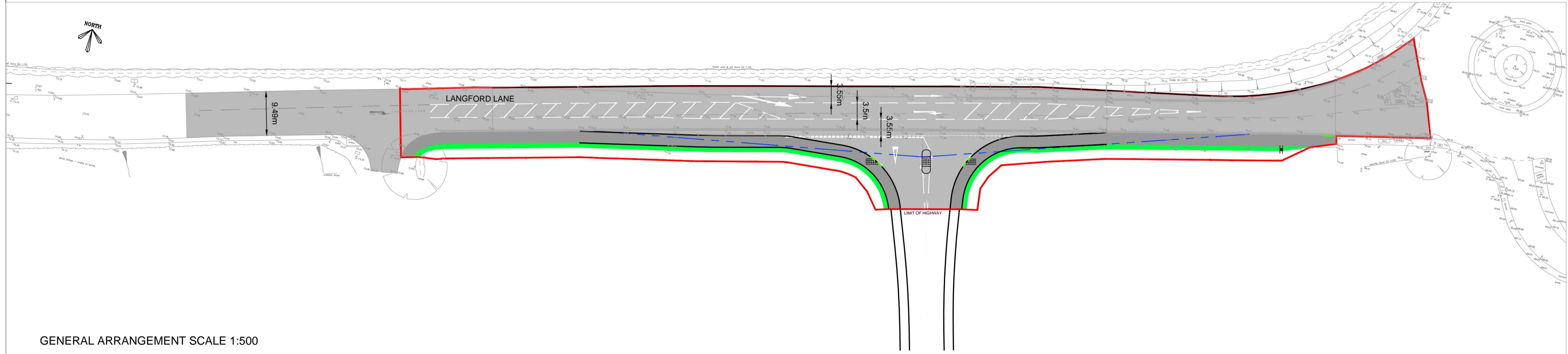

GENERAL ARRANGEMENT SCALE 1:500

FOR COMMENT

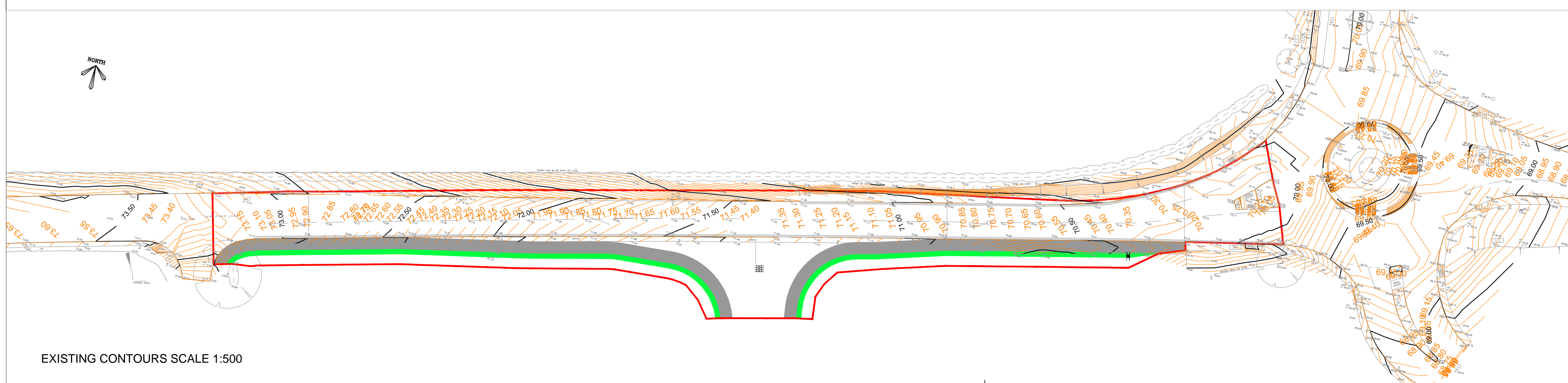

EXISTING CONTOURS SCALE 1:500

Rev	Date	Description	By	Checked By
H	14.06.17	TSRGD 966 ADDED TO SCHEDULE.	JH	GL
G	13.03.17	AMENDMENTS MADE TO REFLECT O.C.C COMMENTS.	JH	GL
F	17.02.17	AMENDMENTS MADE TO REFLECT O.C.C COMMENTS.	JH	GL
E	07.02.17	AMENDMENTS MADE TO REFLECT O.C.C COMMENTS.	JH	GL
D	07.12.16	SIGNS AND LINES WITH SCHEDULE.	JH	GL
C	28.10.16	TAPER BACK INTO THE NORTH EAST SIDE NEAR THE ROUNDABOUT MADE SMOOTHER.	JH	GL
B	05.10.16	PROPOSED YELLOW LINING ADDED TO PLAN.	JH	GL
A	19.08.16	PEDESTRIAN CROSSING AMENDED TO 1.8m WIDE.	JH	GL

Project	Dwg Number	Rev.
OXFORD TECHNOLOGY PARK	12076/622	H

Scale @ A1 - Date AUG 2016

Title PROPOSED ACCESS 278 WORKS PLAN

Drawn by JH Checked by GL Project Engineer GL

Baynham Meikle Partnership
 consulting structural + civil engineers
 8 Meadow Road, Edgbaston, Birmingham B17 8BU
 Telephone: 0121 434 4100 Fax: 0121 434 4073 Email: admin@bm-p.co.uk