

CHANCEL COTTAGE
ASTON 0x25 4SF

17BK-D3

NOTES: CONTACT SPECIALIST FOR THESE WORKS.

ROTAFIX LOCAL CONTACT DETAILS:

- 1) JASON WAKEFIELD 07900 958 263
jasonwakefield@timberwise.co.uk
- 2) JOHN BRETHERTON 07919 085 962
john@jbjoinery.com

APPROX 500mm LONG.
NEW TIMBER PIECE SIZE
& SPECIES TO MATCH EXISTING.

ROOF FINISHES BY
OTHERS

2 No. H12 BARS
CAST INTO T&G
150 EMBEDMENT

DPC TO ARCHITECT'S
DETAILS

EXISTING TRUSS
RAFTER 240x110
RETAINED.

2 No. H12 BARS
RESINED INTO
SIDE SLOTS &
DOWELED INTO
NEW PIECE

4 No. 20 Ø BARS IN
ROTAFIX STRUCTURAL
ADHESIVE

2ND FLOOR

BOTTOM CHORD
OF TRUSS 200x150
RETAINED. EXISTING
FLOOR JOISTS NOT
SHOWN FOR CLARITY
NOTE GRD FLOOR BEAMS
REPAIRED IN SAME WAY
IF DISCOVERED ROTTEN
CONTRACTOR TO INSPECT.

FINISHES TO
ARCHITECT'S
DETAILS.

EXISTING JOISTS
ADJACENT TO
REPAIR TO BE
SUPPORTED ON
JOIST HANGERS.

2 No. H20 BARS

2 No. H20
BARS

400 EMBEDMENT

500 CUT

REFORMED IN STRUCTURAL
RESIN T&G BY ROTAFIX

NEW OAK LINTELS
AS PER THE PLANS.

TYPICAL PRINCIPLE TRUSS

REPAIR DETAIL (1:10)

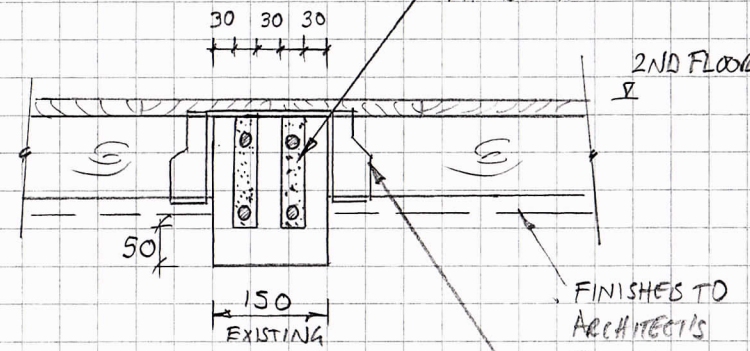

SECTION A-A

(1:10)