

THERE ARE NO EXCEPTIONAL RISKS ASSOCIATED WITH THESE WORKS. REFER TO THE DESIGNER'S RISK ASSESSMENT FOR THE FULL ASSESSMENT OF RISKS.

1. CONTRACTORS MUST CHECK ALL DIMENSIONS ON SITE. ONLY FIGURED DIMENSIONS ARE TO BE WORKED FROM. DISCREPANCIES MUST BE REPORTED TO THE ARCHITECT OR ENGINEER BEFORE PROCEEDING. © THIS DRAWING IS COPYRIGHT.
2. REPRODUCED FROM OS SITEMAP © BY PERMISSION OF ORDNANCE SURVEYS © ON BEHALF OF THE CONTROLLER OF HER MAJESTY'S STATIONERY OFFICE. © CROWN COPYRIGHT 2008. ALL RIGHTS RESERVED. LICENCE NUMBER 100007126.
3. UNTIL TECHNICAL APPROVAL HAS BEEN OBTAINED FROM THE RELEVANT AUTHORITIES, ALL DRAWINGS ARE ISSUED AS PRELIMINARY AND NOT FOR CONSTRUCTION. SHOULD THE CONTRACTOR COMMENCE SITE WORK PRIOR TO APPROVAL BEING GIVEN IT IS ENTIRELY AT HIS OWN RISK.

KEY

- EXCAVATE IN FULL & RECONSTRUCT IN FULL BITUMINOUS CARRIAGEWAY
- EXCAVATE IN FULL & RECONSTRUCT IN FULL BLOCK PAVING. BLOCK PAVING TO BE MARSHALLS KEYBLOCK BURNT OCHE OR SIMILAR APPROVED
- EXCAVATE IN FULL & RECONSTRUCT IN FULL BITUMINOUS FOOTWAY
- EXCAVATE IN FULL & REINSTATE AS VERGE
- PRIVATE AREA TO BE REGRADED TO EXISTING LEVELS AT MAX 1:3 - SOFT LANDSCAPING
- PRIVATE AREA TO BE REGRADED TO EXISTING LEVELS AT MAX 1:12 - HARD LANDSCAPING
- HALF BATTERED KERB 125 x 255mm (H82) 125mm UPSTAND
- BULLROUSE KERB 125 x 150mm (B4) 25mm UPSTAND
- EDGING KERB 150 x 50mm (E4) 0mm UPSTAND
- CHANNEL KERB
- HIGHWAY BOUNDARY MARKERS AT 5m INTERVALS
- 2.4m x 3.0m VISIBILITY SPALL VISIBILITY SPALL
- BOLLARD WITH REFLECTIVE STRIP
- 9 ADOPTABLE STREET LIGHTING (FOR DETAILS AND CASE SEE CROSSROADS DRAWING HEYF-5-1002 S)

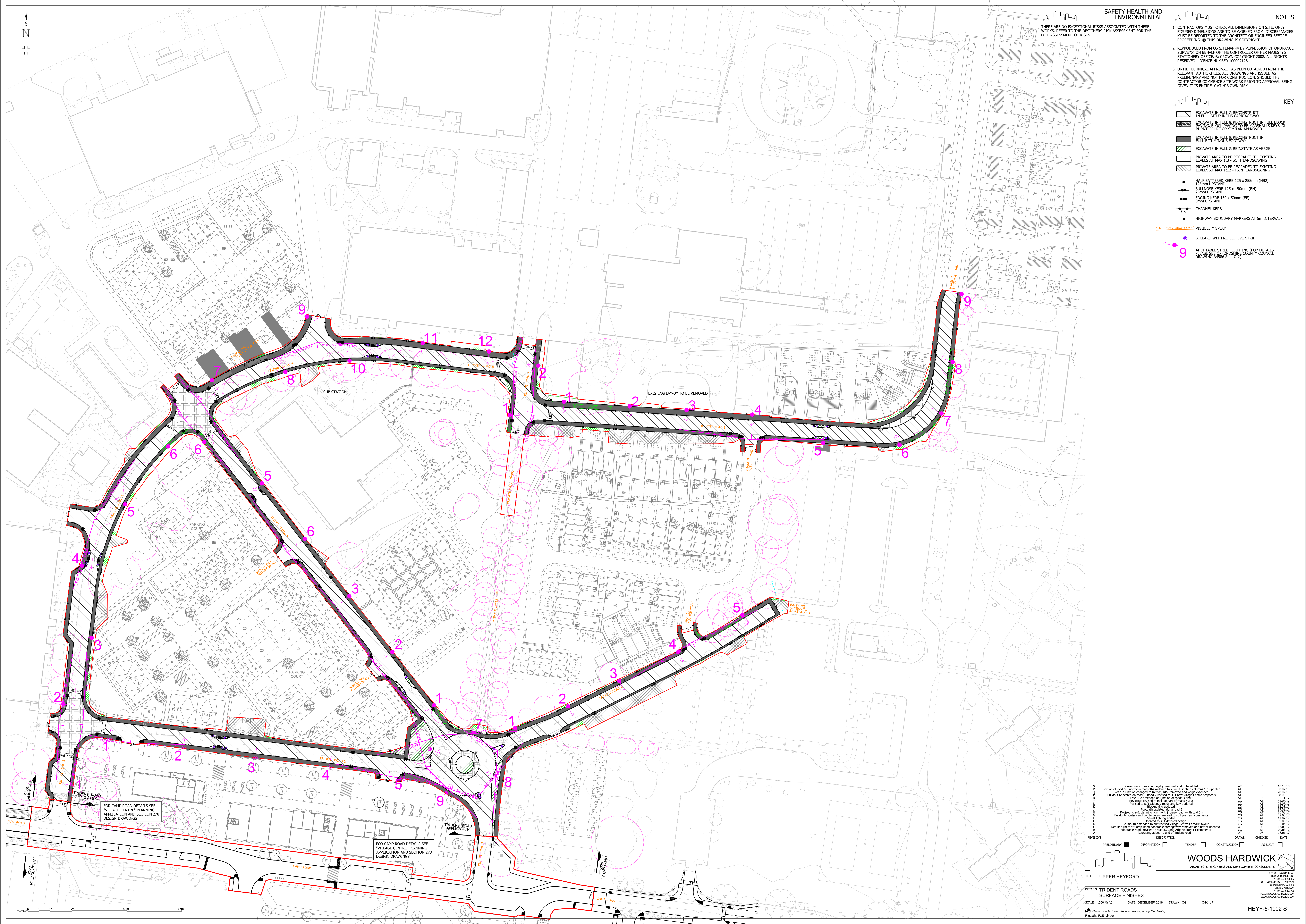

FOR CAMP ROAD DETAILS SEE "VILLAGE CENTRE" PLANNING APPLICATION AND SECTION 278 DESIGN DRAWINGS

FOR CAMP ROAD DETAILS SEE "VILLAGE CENTRE" PLANNING APPLICATION AND SECTION 278 DESIGN DRAWINGS

REVISION	DESCRIPTION	DESIGNED	CHECKED	DATE
S	Crossovers to existing lay-by removed and note added	AT	JF	10.10.18
G	Section of road full width to be widened by 2.0m to lighting columns 1-4 updated	AT	JF	20.02.18
H	Block 7 junction changed to roundabout. 8m x 8m lighting columns 1-4 updated	AT	JF	08.03.18
I	Block 7 junction changed to roundabout. 8m x 8m lighting columns 1-4 updated	AT	JF	07.03.18
M	Block 7 junction changed to roundabout. 8m x 8m lighting columns 1-4 updated	AT	JF	11.11.17
K	Key cloud revised to include part of roads 8 & 9	CG	AT	31.08.17
J	Revised to suit planning comments. Increase road width to 6.5m	CG	AT	24.08.17
I	Revised to suit planning comments. Increase road width to 6.5m	CG	AT	17.08.17
H	Revised to suit planning comments. Increase road width to 6.5m	CG	AT	12.08.17
G	Revised to suit planning comments. Increase road width to 6.5m	CG	AT	02.08.17
F	Revised to suit planning comments. Increase road width to 6.5m	CG	AT	11.02.17
E	Bullrouse amended to suit revised Village Centre Carpark layout	CG	AT	09.06.17
D	Red line limits of Camp Road adopted carriage way and surface updated	CG	AT	01.04.17
C	Adoptable roads revised to suit DCC and architectural comments	CG	AT	02.03.17
B	Regrading added for road 4	CG	JF	16.03.17
A	Regrading added for road 4	CG	JF	16.03.17

PRELIMINARY INFORMATION TENDER CONSTRUCTION AS BUILT

WOODS HARDWICK
ARCHITECTS, ENGINEERS AND DEVELOPMENT CONSULTANTS

TITLE: UPPER HEYFORD

DETAILS: TRIDENT ROADS SURFACE FINISHES

SCALE: 1:500 @ A0 DATE: DECEMBER 2016 DRAWN: CG CHK: JF

Please consider the environment before printing this drawing
Filesize: 11.8Mb

15-17 COLINDALE AVENUE
BARNET, MIDDLESEX HA8 7PP
UK
T: +44 (0)20 349 2000
F: +44 (0)20 349 2001
WWW.WOODSHARDWICK.COM

HEYF-5-1002 S