

- Legend**
- PUBLIC_RIGHTS_OF_WAY STATUS**
- Public Footpath
 - Public Bridleway
 - Restricted Byway
 - Byway Open to all Traffic
 - SWIFT_RECORDS
 - PROTECTED_AND_NOTABLE_SPECIES
 - PROTECTED_SPECIES_BUFFER
 - ROAD_VERGE_NATURE_RESERVES
 - EIL_TEXT
 - ASSETS OF COMMUNITY VALUE
- LISTED BUILDINGS**
- GRADE**
- I
 - II*
 - II
 - DL
- CURTILAGE LISTING**
- LOCALLY_LISTED_BUILDINGS
 - ARTICLE_4
- ARCHAEOLOGICAL CONSTRAINT PRIORITY AREAS**
- SCHEDULED ANCIENT MONUMENT
 - EIL_REGIONS
 - NERC ACT S41 Habitats (Previously UKBAP PRIORITY HABITATS)
 - REGISTERED_COMMON_LAND
 - SPECIAL_SITES_OF_SCIENTIFIC_INTEREST
 - SPECIAL_AREAS_OF_CONSERVATION
 - ANCIENT_WOODLAND
 - CONSERVATION_AREAS
 - DISTRICT_WILDLIFE_SITES
 - LOCAL_WILDLIFE_SITES
 - PROPOSED_NEW_LWS_AND_EXTENSIONS_LWS
 - LOCAL_NATURE_RESERVE
 - PARKS_AND_GARDENS
 - AREAS_OF_OUTSTANDING_NATURAL_BEAUTY
 - RAILWAY_TUNNEL
 - HIGH_PRESSURE_GAS_PIPELINES
 - LGS_POINTS
 - LGS_POLYGONS
- POTENTIALLY CONTAMINATED LAND**
- EA LANDFILL_SITES**
- Buffer Distance**
- 0
 - 50
 - 250
 - HISTORIC_LANDFILL_SITES_10K
 - BANK_TOP_WIDTH_PLANNING
 - NAT_FSA
 - NAT_DEFENCES
 - NAT_AREAS_BENEFIT
 - NAT_CENTRELINES
- HS2 SAFEGUARDING_ZONES**
- Type**
- Safeguarding Limits
 - Sub-Surface
 - Surface
 - NATURALLY_ELEVATED_ARSENIC
 - GREEN_BELT
 - CONSERVATION_TARGET_AREAS
 - MINERAL_CONSULTATION_REGION
 - NATIONAL_GRID_REFERENCE
 - WARDS
 - PARISHES

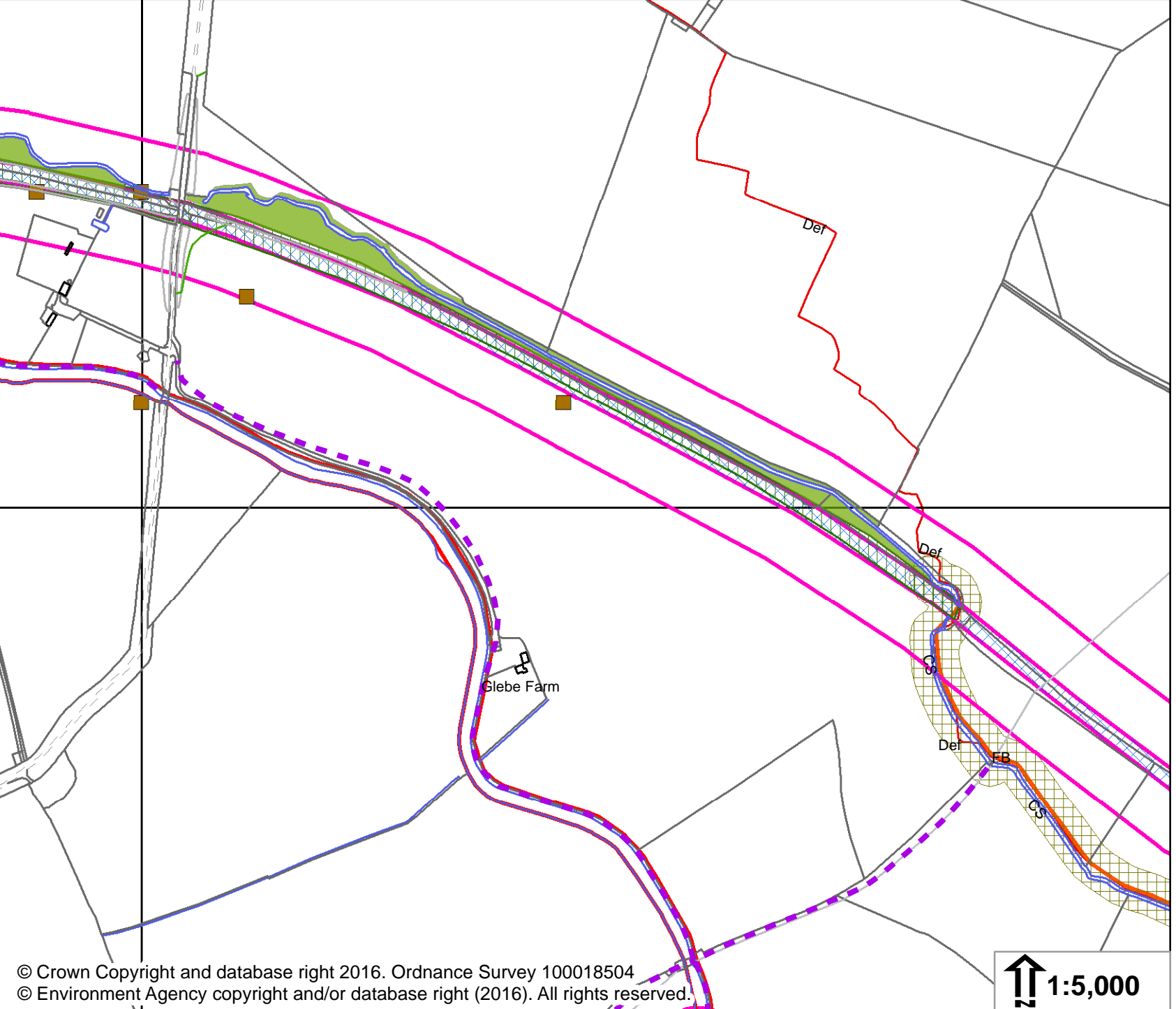

© Crown Copyright and database right 2016. Ordnance Survey 100018504
 © Environment Agency copyright and/or database right (2016). All rights reserved.