

SECTION 104 - NOT APPROVED
SECTION 38 - NOT APPROVED

(Road 1 section continued...)

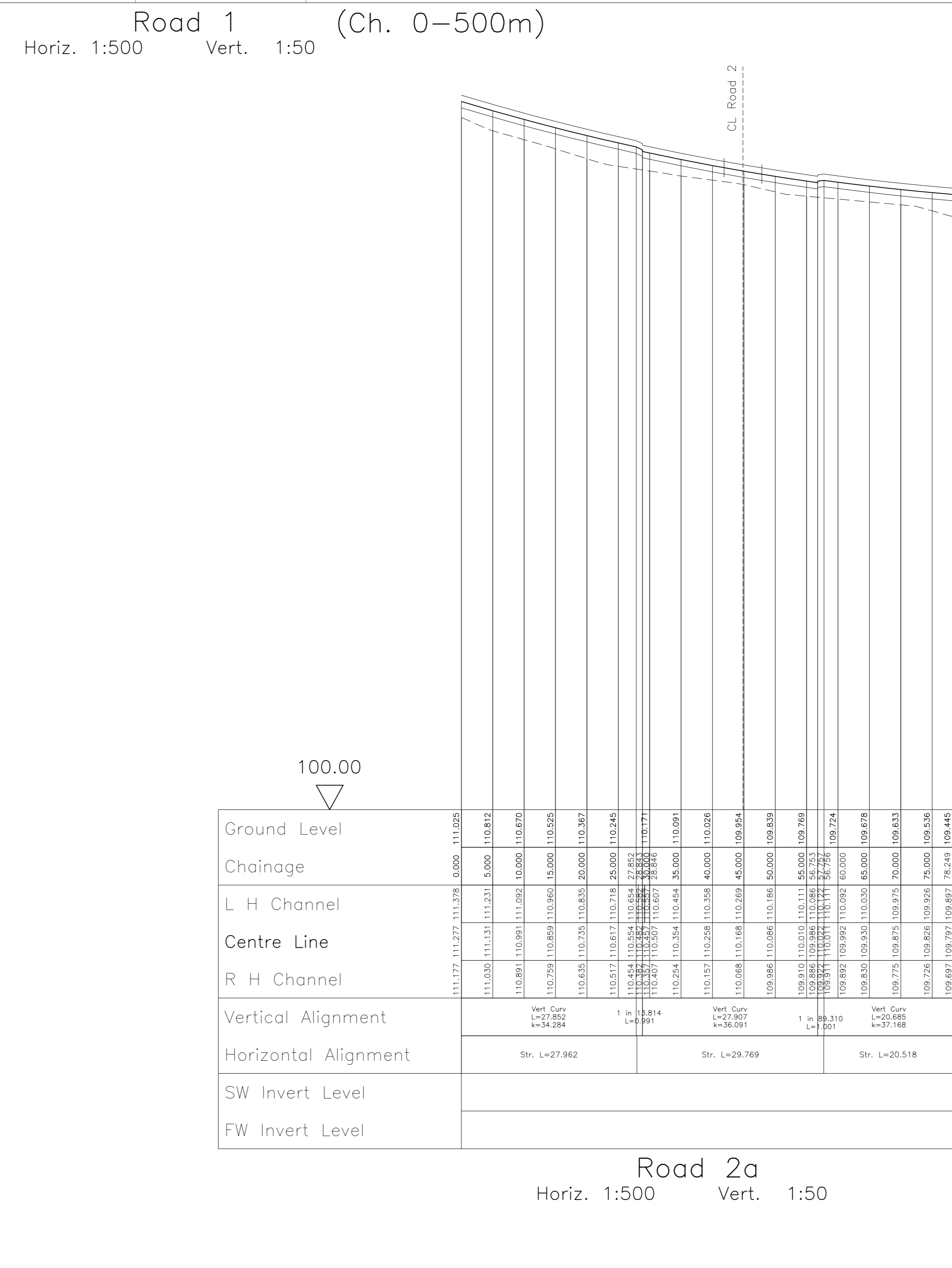
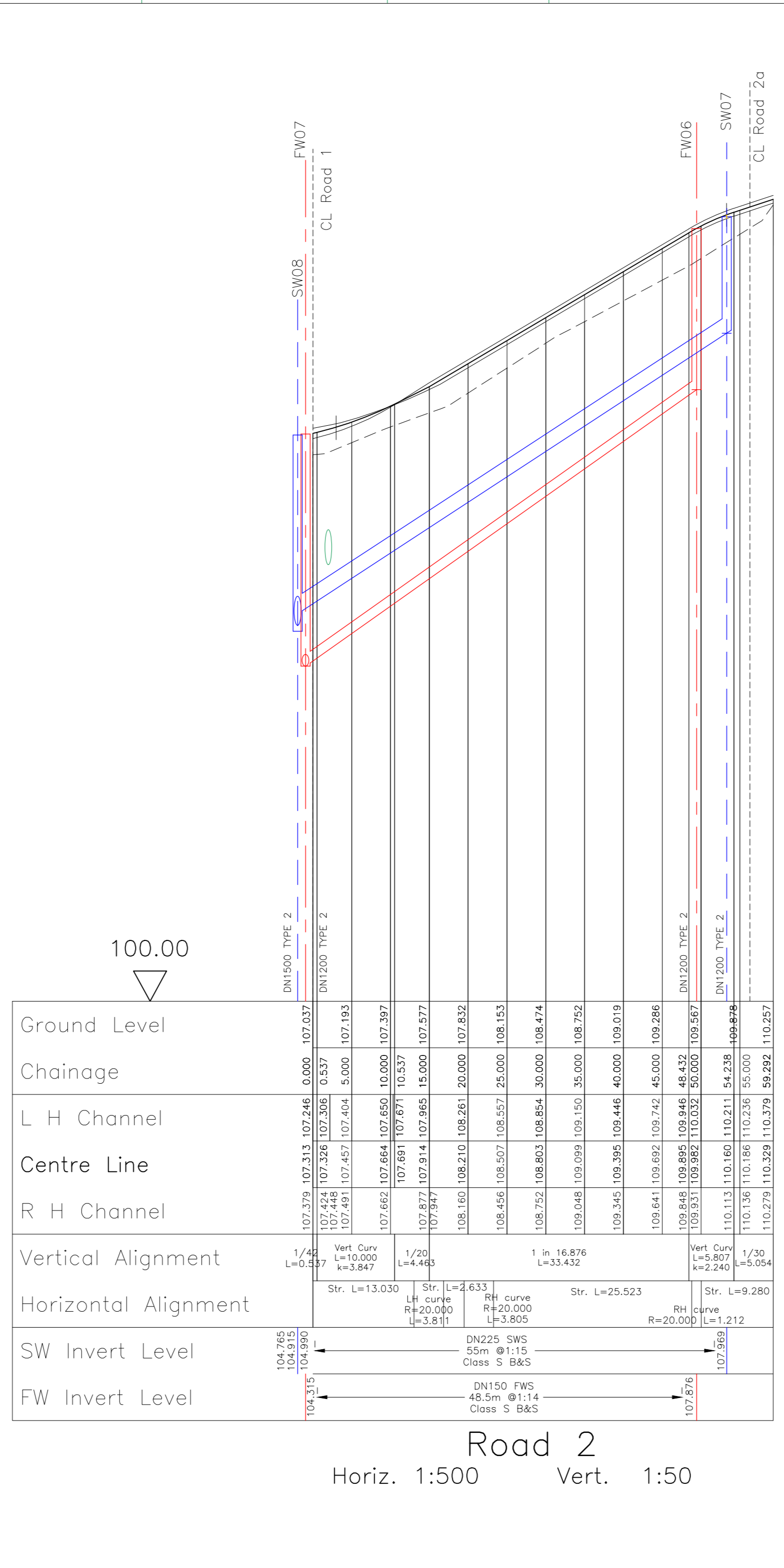
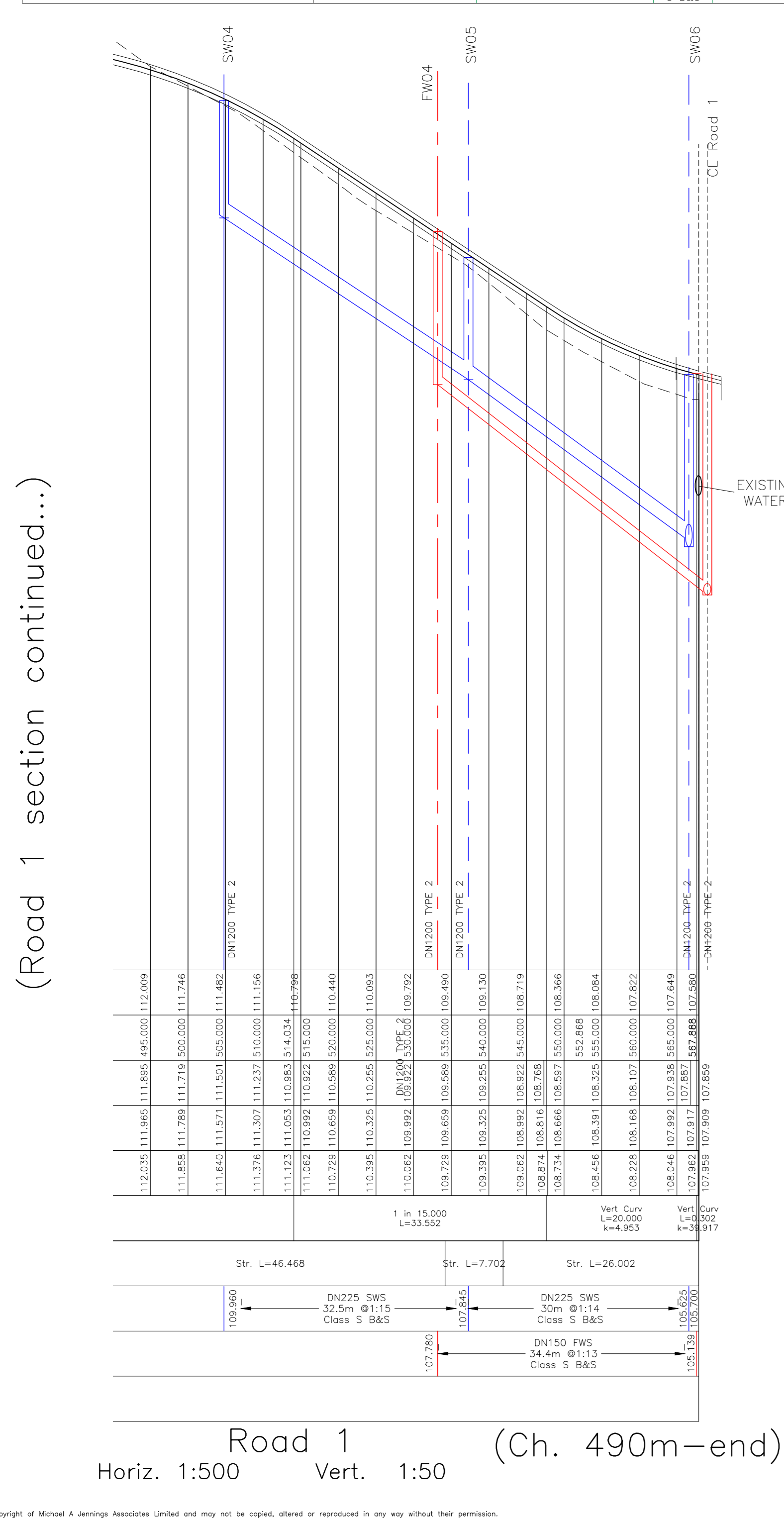
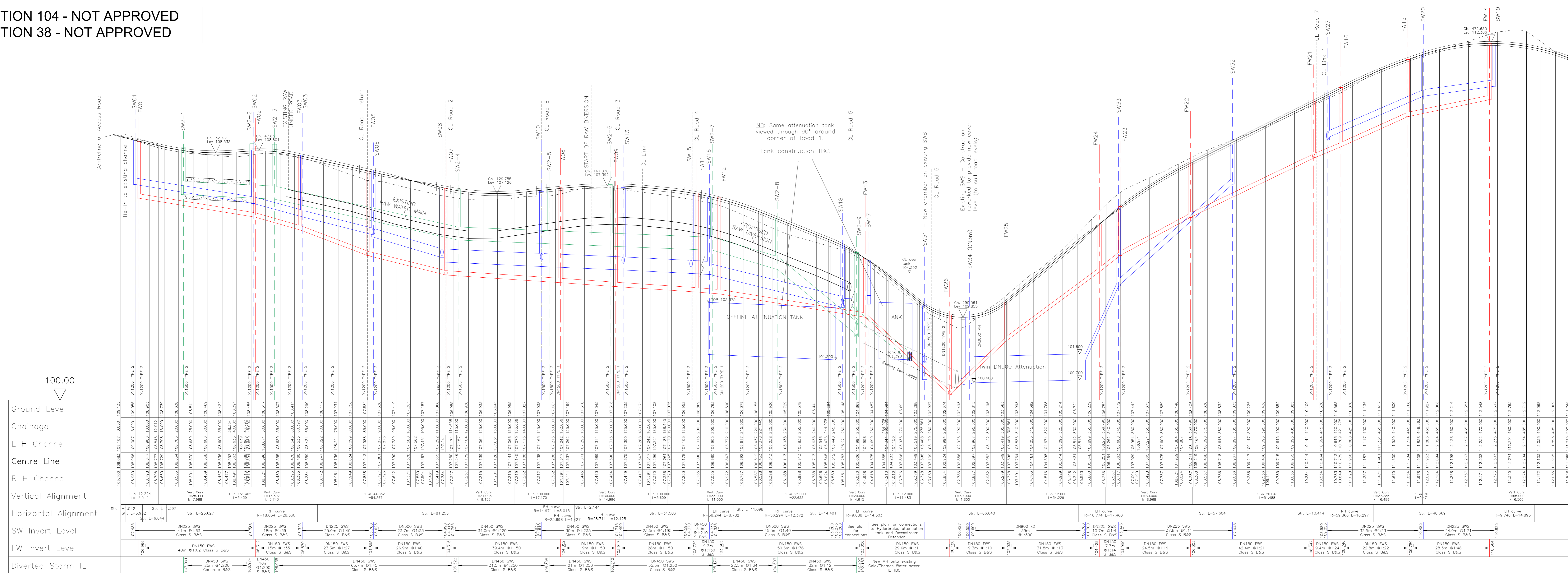

(Road 1 section continued below...)

NB:
Sewers subject to approval by Thames Water.
Roads subject to approval by Oxfordshire C.C.

- NOTES:**
- Do not scale from this drawing.
 - All dimensions in metres and all levels relate to site datum.
 - This drawing is to be read in conjunction with all other engineering drawings. Any discrepancies shall be reported to MJA Consulting.
 - The level and location of all existing services shall be verified on site by the Contractor before commencing any construction work.
 - All adoptable drainage works to be constructed as detailed in Sewers for Adoption, 7th edition or as stipulated in Thames Water's Addendum.
 - All adoptable works to be checked by the Water Authority Inspector.
 - All adoptable pipework up to DN225 shall be Extra Strength Verified Clay (DN300 or above shall be Class II concrete). If the contractor wishes to use structural wall plastic pipe, approval must be gained from the Adopting Water Authority.
 - Sewers and drains of different diameters should be laid soffit to soffit unless otherwise specified.
 - All covers and frames shall be 150mm deep to BS EN 124, bedded SW or FW if requested.
 - Contractor must comply with all current legislation relating to CDM, Health and Safety, and COSHH.
 - Block paved roads with a greater fall than 1:20 to be concrete bedded on concrete every 30m.
 - Chambers for the Highway Storm network shall be catchpits, in accordance with the construction details provided on S27/26-C1.
 - Invert level quoted for Highway catchpits is to sewer pipe inverts. 300mm sump below stated level.

CONSTRUCTION

REV.	NO.	DATE	DESCRIPTION	INITIALS
C1	02.11.18		Sewers design updated to reflect outcome of discussions with Thames Water.	AJW
D	14.08.18		Revised in accordance with current planning layout.	AJW
C	20.07.18		Revised in accordance with current planning layout (extents and layout).	AJW
B	24.04.18		Revised in accordance with current planning layout (extents and layout).	AJW
A	23.01.18		Revised in accordance with current planning layout (extents and layout).	AJW

Client	CREST NICHOLSON		
Project	Bodicote, Banbury		
Title	Longitudinal Sections (Phases 1 & 2)		
Scale	As shown	Drawn	AW
Date	Oct'17	Drawing No.	5692:10
Checked	KTG	Rev	C1

This drawing is the copyright of Michael A. Jennings Associates Limited and may not be copied, altered or reproduced in any way without their permission.