

DO NOT SCALE

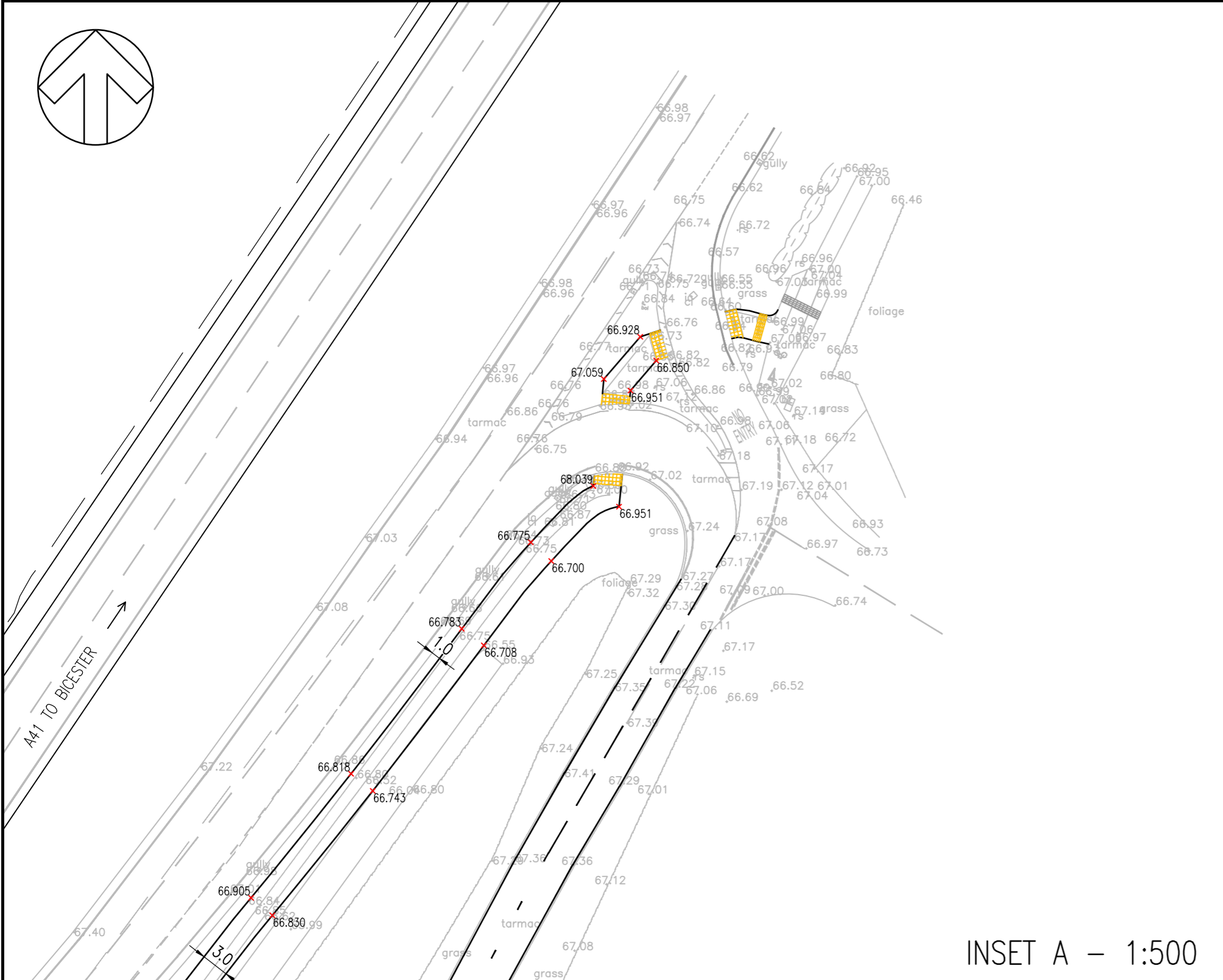
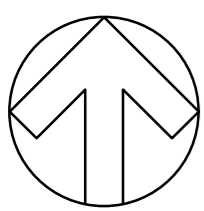

INSET A - 1:500

- NOTES:
1. DIMENSIONS ARE IN METRES UNLESS OTHERWISE STATED.
 2. ALL LEVELS ARE IN METRES ABOVE ORDNANCE DATUM.
 3. WORKS SHALL BE DESIGNED AND CONSTRUCTED IN ACCORDANCE WITH THE OXFORDSHIRE COUNTY COUNCIL HIGHWAY STANDARDS AND SHALL BE CONSTRUCTED IN ACCORDANCE WITH THE RELEVANT B.S AND DEPARTMENT OF TRANSPORTS 'SPECIFICATION FOR HIGHWAY WORKS', PUBLISHED BY HMSO. ALL SPECIFICATION CLAUSES REFER TO THIS DOCUMENT UNLESS OTHERWISE STATED.
 4. THIS DRAWING SHALL BE READ IN CONJUNCTION WITH ALL OTHER SETTING OUT DRAWINGS, RELATED DOCUMENTATION AND STANDARD DETAILS.
 5. ALL LEVELS ARE IN METRES ABOVE ORDNANCE DATUM. ALL DIMENSIONS IN MILLIMETRES UNLESS OTHERWISE STATED. CONTRACTOR TO VERIFY ALL LEVELS PRIOR TO COMMENCEMENT ON SITE.
 6. ALL SETTING OUT SHALL BE IN ACCORDANCE WITH CL 112 OF THE SPECIFICATION OF HIGHWAY WORKS AND TO BE AGREED WITH THE ENGINEER ON SITE.
 7. CONFLICTING INFORMATION SHOWN ON THE ENGINEER'S DRAWINGS OR DISCREPANCIES BETWEEN THE INFORMATION GIVEN BY THE ENGINEER AND THAT PROVIDED BY OTHERS MUST BE REFERRED TO THE ENGINEER BEFORE THE WORKS COMMENCE.
 8. BASED ON TOPOGRAPHICAL SURVEY BY TARGET SURVEYS LIMITED REF 1367/1, 5 CLARENDON PLACE, LEAMINGTON SPA, WARWICKSHIRE CV32 5QL.
 9. ALL WORKS UNDERTAKEN ON PUBLIC HIGHWAY SHALL BE IN COMPLIANCE WITH C1 117.

KEY
 66.350 PROPOSED FINISH LEVEL

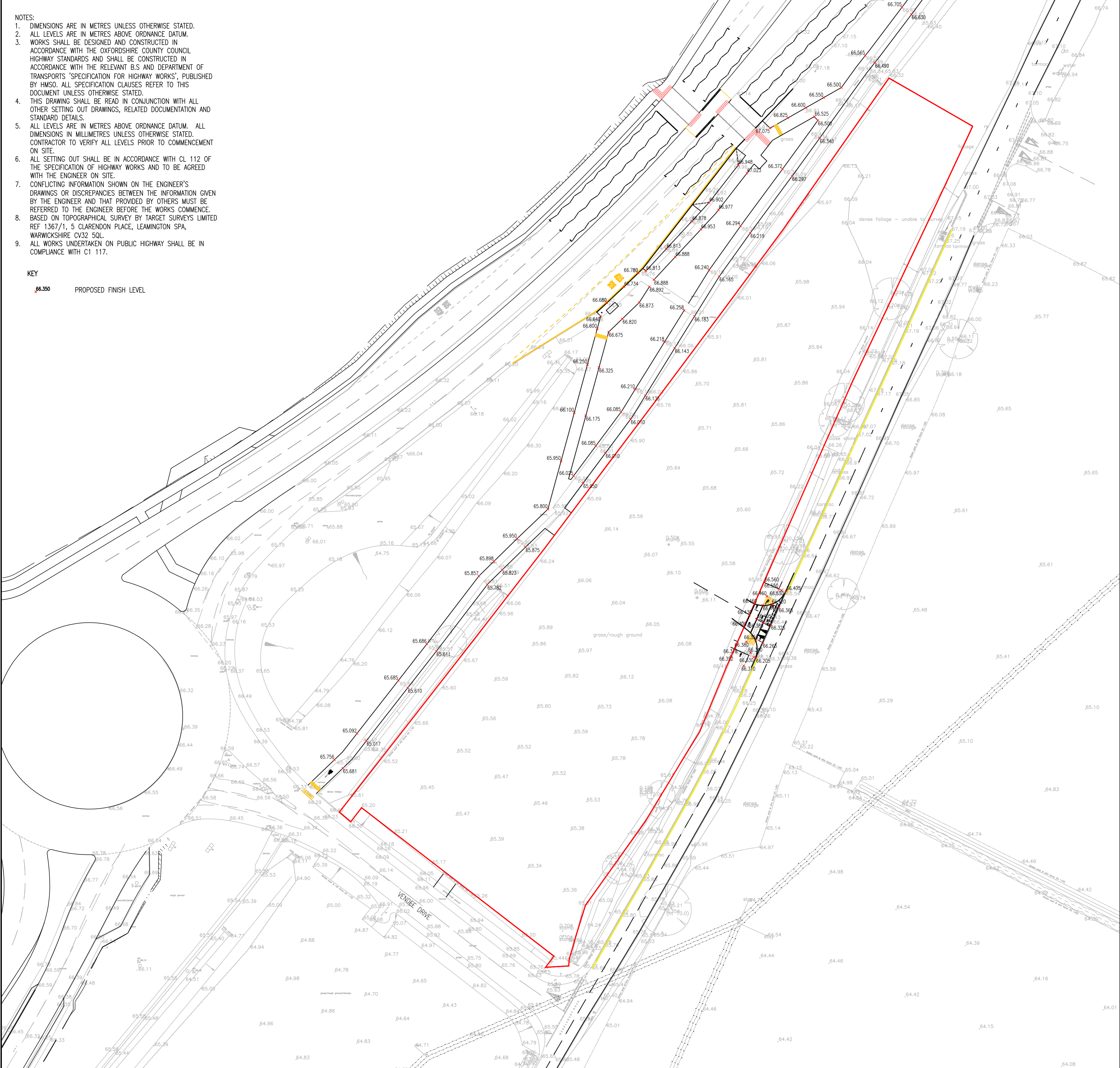

File name: \\uk.wspgroup.com\central_data\projects\3775\3775-XX-DR-CE-7001\3775-XX-DR-CE-7001-DWG.dwg, printed on 28 June 2018 10:08:45, by Maldoon, Maldoon

Unit 9 The Chase John Tate Road Foxholes Business Park Hertford SG13 7NN, UK T+ 44 (0) 1992 526 000 F+ 44 (0) 1992 526 001 wsp.com		CLIENT: ATLAS HOTELS GROUP	PROJECT: HOLIDAY INN EXPRESS BICESTER GATEWAY	SCALE @ A1: 1:500	CHECKED: MPB	APPROVED: MPB
		ARCHITECT: NORR	TITLE: PROPOSED FINISH LEVELS LAYOUT	PROJECT No: 70033775	DESIGNED: DMD	DRAWN: DMD
P01 22/06/2018 DMD FIRST ISSUE				DATE: June 18		
REV DATE BY DESCRIPTION				DRAWING No: 3775-WSP-S278-XX-DR-CE-7001		REV: P01
DRAWING STATUS: S3 - FOR REVIEW				© WSP UK Ltd		