

PLANTING SCHEDULE

Code	Botanical Name	Age Condition/ No. times transplanted	Root condition	Overall height (cm)	Form	Girth (cm)	Location	Mature Height (m)	No. Breaks/ branches	Specification
TREES										
Qr	Quercus robur	-	C	min. 500	SM	20-25cm	As shown	10m	1 stems	1.8-2m clear stem
Ps	Pinus sylvestris	-	C	min. 500	SM	20-25cm	As shown	10m	1 stems	1.8-2m clear stem
Bp	Betula pendula	-	C	min. 500	SM	20-25cm	As shown	8m	1 stems	1.8-2m clear stem
Po	Platanus orientalis	-	C	min. 450-500	EHS	16-18cm	As shown	8m	1 stems	1.8-2m clear stem
PsB	Pinus sylvestris	3x	C	min. 450-500	EHS	16-18cm	As shown	10m	1 stems	1.8-2m clear stem
ScB	Salix caprea	3x	C	min. 450-500	EHS	16-18cm	As shown	8m	1 stems	1.8-2m clear stem
BpB	Betula pendula	3x	C	min. 450-500	EHS	16-18cm	As shown	8m	1 stems	1.8-2m clear stem
AcC	Acer campestre	2x	C	min. 200-300	Standard	8-10cm	As shown	8m	1 stems	1.8-2m clear stem
QrC	Quercus robur	2x	C	min. 200-300	Standard	8-10cm	As shown	10m	1 stems	1.8-2m clear stem
PsC	Pinus sylvestris	2x	C	min. 200-300	Standard	8-10cm	As shown	10m	1 stems	1.8-2m clear stem
ScC	Salix caprea	2x	C	min. 200-300	Standard	8-10cm	As shown	8m	1 stems	1.8-2m clear stem
BpC	Betula pendula	2x	C	min. 200-300	Standard	8-10cm	As shown	8m	1 stems	1.8-2m clear stem
PaC	Prunus avium	2x	C	min. 200-300	Standard	8-10cm	As shown	8m	1 stems	1.8-2m clear stem

Code	Botanical Name	Root condition	Size h=height D=diameter	Min Size or size of container	Density	Mature height (cm)	No. Breaks/ branches	Specification
SHRUBS								
S B T	Berberis 'Thunbergii'	C	h40-60cm	2L	3/m ²	1m	5	Bushy / Even form
S H R	Hebe rakaiensis	C	h20-30cm	2L	3/m ²	1m	5	Bushy / Even form
S Ln M	Lonicera nitida 'Maygreen'	C	h30-40cm	2L	3/m ²	500cm	5	Bushy / Even form
S PI 'OL'	Prunus laurocerasus 'Otto Luyken'	C	h20-30cm	2L	3/m ²	1m	9	Bushy / Even form
S SxC H'	Symphoricarpos + chenautilis 'Hanscock'	C	h30-40cm	2L	3/m ²	2m	5	Bushy / Even form
S V D	Viburnum davidii	C	h30-40cm	2L	3/m ²	1.5m	5	Bushy / Even form

Botanical Name	Root condition	Form	Height (cm)	% Mix
NATIVE WOODLAND PLANTING				
Alnus glutinosa	BR	Feathered	150cm	5
Alnus glutinosa	BR	1+1	60-80cm	10
Betula pendula	BR	1+1	60-80cm	5
Corylus avellana	BR	Feathered	150cm	5
Populus nigra spp. betulifolia	BR	1+1	60-80cm	5
Populus tremula	BR	Feathered	150cm	5
Quercus robur	BR	Feathered	150cm	10
Prunus avium	BR	1+1	60-80cm	5
Acer campestre	BR	Feathered	150cm	5
Salix caprea	BR	1+1	60-80cm	5
Salix fragilis	BR	1+1	60-80cm	5
Malus sylvestris	BR	Feathered	150cm	5
Larix decidua	BR	1+1	60-80cm	5
Pinus sylvestris	BR	Feathered	150cm	5
Cornus sanguinea	BR	bushy, 3 brks	60-80cm	5
Crataegus monogyna	BR	bushy, 3 brks	60-80cm	5
Ilex aquifolium	BR	bushy, 3 brks	60-80cm	5
Sorbus leyana	BR	bushy, 3 brks	60-80cm	5

Code	Botanical Name	Root condition	Form	Height (cm)	% Mix
NATIVE HEDGEROW PLANTING					
Qr	Quercus robur	BR	Feathered, 3x	120-150cm	10
Pa	Prunus avium	BR	Feathered, 3x	120-150cm	10
Ac	Acer campestre	BR	Feathered, 3x	120-150cm	15
Ms	Malus sylvestris	BR	Feathered, 3x	120-150cm	10
Cs	Cornus sanguinea	BR	Feathered, 3x	120-150cm	5
Ee	Euonymus europaeus	BR	bushy, 3 brks	60-80cm	5
Lv	Ligustrum vulgare	BR	bushy, 3 brks	60-80cm	10
Ps	Prunus spinosa	BR	bushy, 3 brks	60-80cm	10
Cm	Crataegus monogyna	BR	bushy, 3 brks	60-80cm	10
Ia	Ilex aquifolium	5L	bushy, 3 brks	60-80cm	10
Rc	Rhamnus cathartica	BR	bushy, 3 brks	60-80cm	5
Sn	Sambucus nigra	BR	bushy, 3 brks	60-80cm	10
Vo	Viburnum opulus	BR	bushy, 3 brks	60-80cm	5

Notch planted in triple staggered rows at 500mm centres with rabbit protection with continual linear coverage of feathered trees planted at 3m centres.

Notch planted in a matrix pattern at 1500mm centres with rabbit protection. Plant in single species groups with 15-30no. plants by species.

PROPRIETARY GRASS SEED MIX	MIXTURE	SUPPLIER	SOW RATE
A4 (low maintenance areas)	Geminal seeds		35g/m ² (350kg/ha)

GRASS SEED MIX TO SWALES	MIXTURE	SUPPLIER	SOW RATE
EG8 (Meadow grass mixture for wetlands)	Emorsgate Seeds		5g/m ² (50kg/ha)

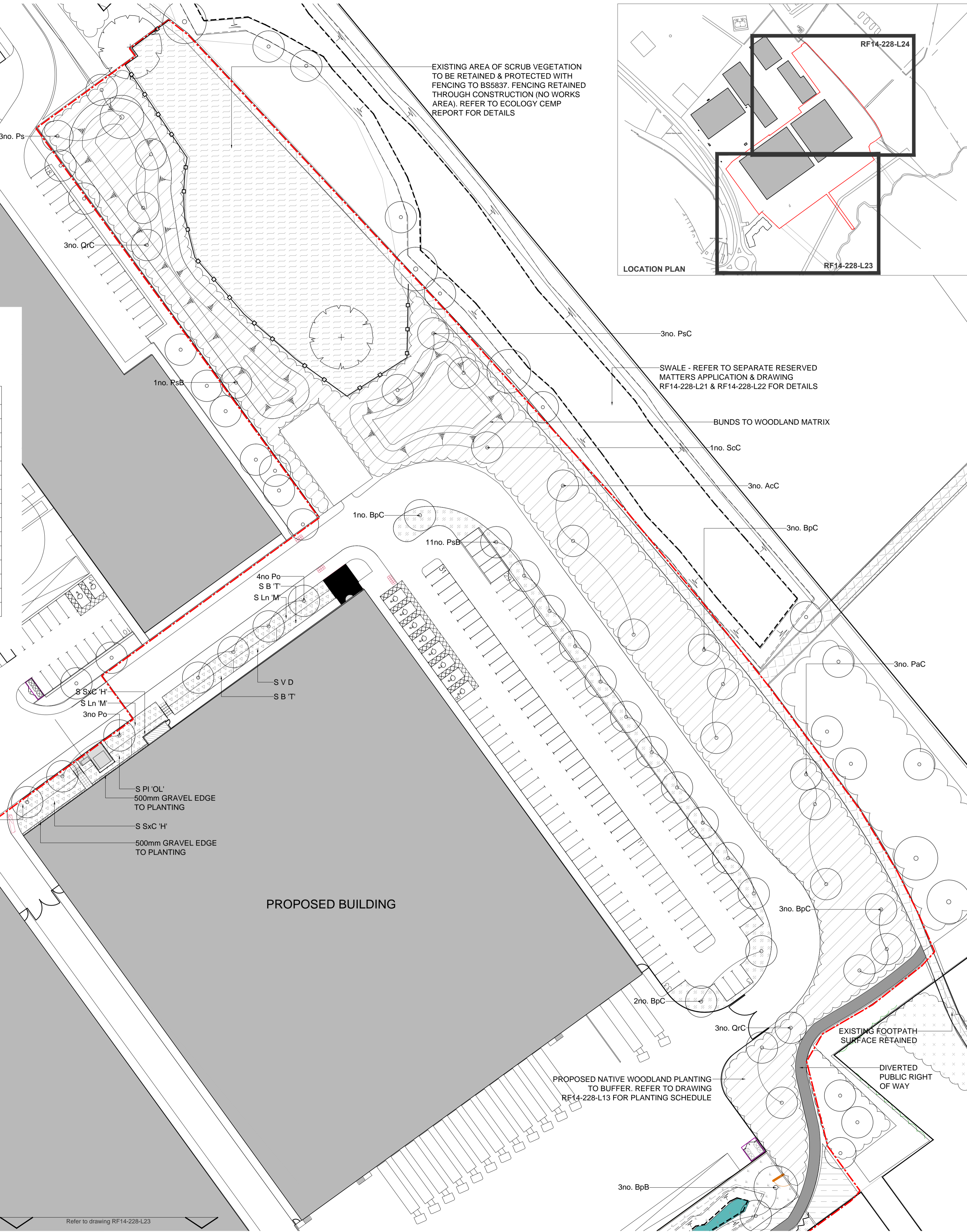
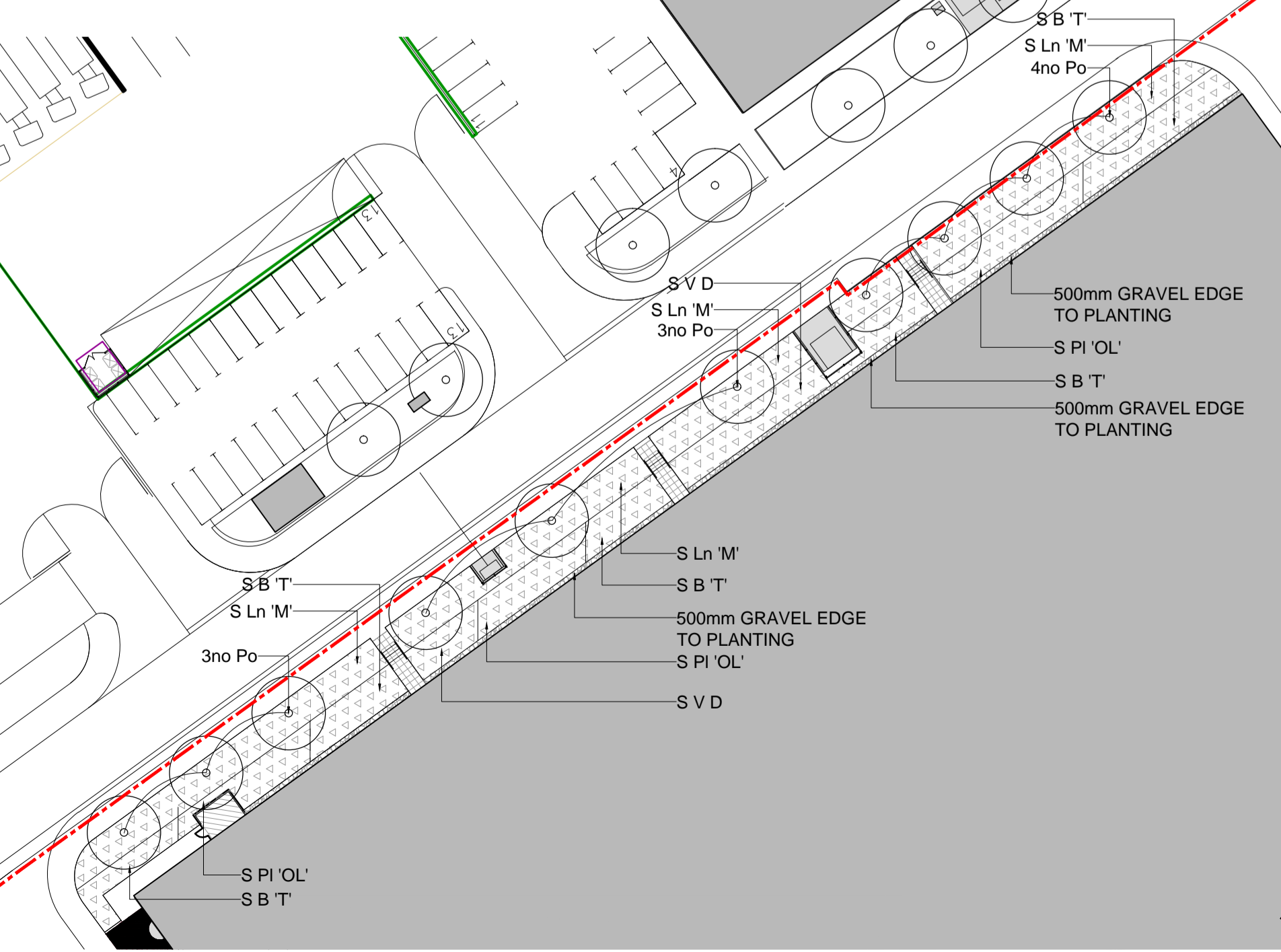

- KEY
- Planning Application Boundary
 - Proposed tree in soft landscape To be grown on to maturity
 - Existing trees to be retained and protected to BS5837:2012
 - Proposed hedgerow planting 400mm topsoil (Q28.315A)
 - Existing hedgerows/linear vegetation to be retained and protected for the duration of the works
 - Proposed native woodland planting
 - Proprietary grass seed mix (Q30.310A) 150mm topsoil (Q28.315A)
 - Amenity Shrub planting 400mm topsoil (Q28.315A)
 - Proprietary grass seed to swales. Refer to planting schedule for species mix 150mm topsoil (Q28.315A)
 - Swale layout
 - Existing hedgerows/linear vegetation to be retained and protected for the duration of the works
 - Area of existing scrub vegetation to be retained to western boundary
 - Diverted section of public footpath
 - Existing footpath route
 - Temporary protective fencing to BS5837:2012 (refer to Arboricultural Method Statement & CEMP Biodiversity Report for details)
 - 1.0m high chestnut pale fencing to proposed diverted public footpath edge; to protect along Langford Beck edge of site

To be read in conjunction with RF14-228-L23 Planting Plan 1 of 2 RF14-228-S03 Landscape Specification RF14-228-R07 Landscape Maintenance Plan

DATE	DRAWN	DESCRIPTION OF REVISION	REVISION LETTER	CHECKED BY
30.11.18	CS	PLANTING AMENDED TO FIT ARCHITECT'S SPECIFICATION	PL04	GD
22.11.18	CS	SELECTIVE SPECIES TO HEDGEROW ADDED	PL03	GD
29.03.18	AF	PLANNING	PL02	GD
28.03.18	AF	PLANNING	PL01	GD
23.03.18	AF	PRELIMINARY-ACOUSTIC BUNDS ADDED	P2	GD
03.03.18	AF	PRELIMINARY	P1	GD

re-form
landscape architecture

Tower Works, Globe Road, Leeds LS11 5QG
T +44 (0)113 2454695 E info@re-formlandscape.com
W www.re-formlandscape.com

Drawing title - **ZONE 01 PLANTING PLAN 2 OF 2**

Drawing number - **RF14-228-L24**

Revision - **PL04**

© re-form landscape architecture 2015