

File name: LUK WSP GROUP COMPANY CENTRAL DATA PROJECTS\0033775-BICESTER GATEWAY HOTEL\00 WSP DRAWINGS\775-WSP-00-ZZ-DR-CE-1002.DWG, printed on 13 February 2018 17:03:55, by Wills, Karl

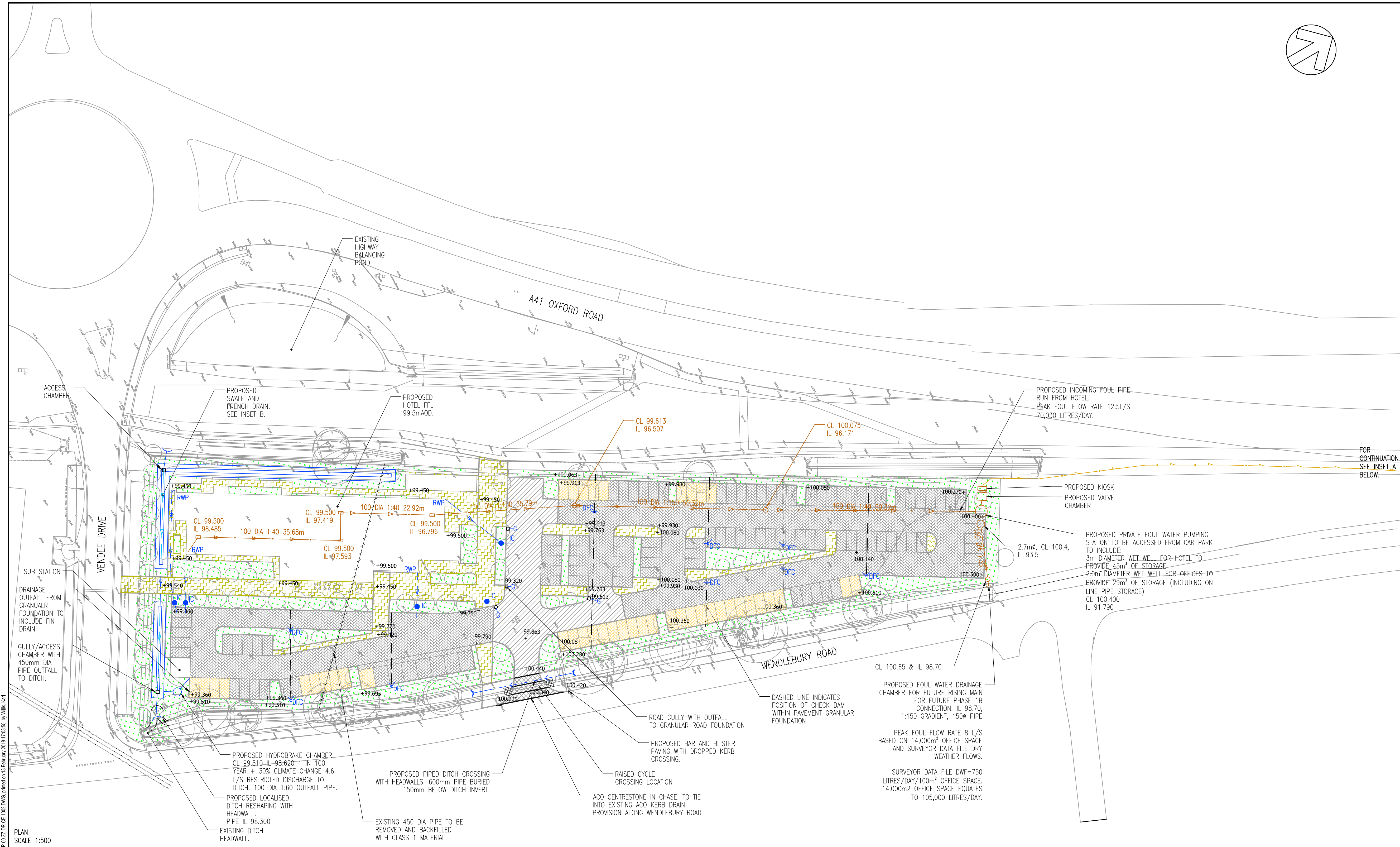

PLAN
SCALE 1:500

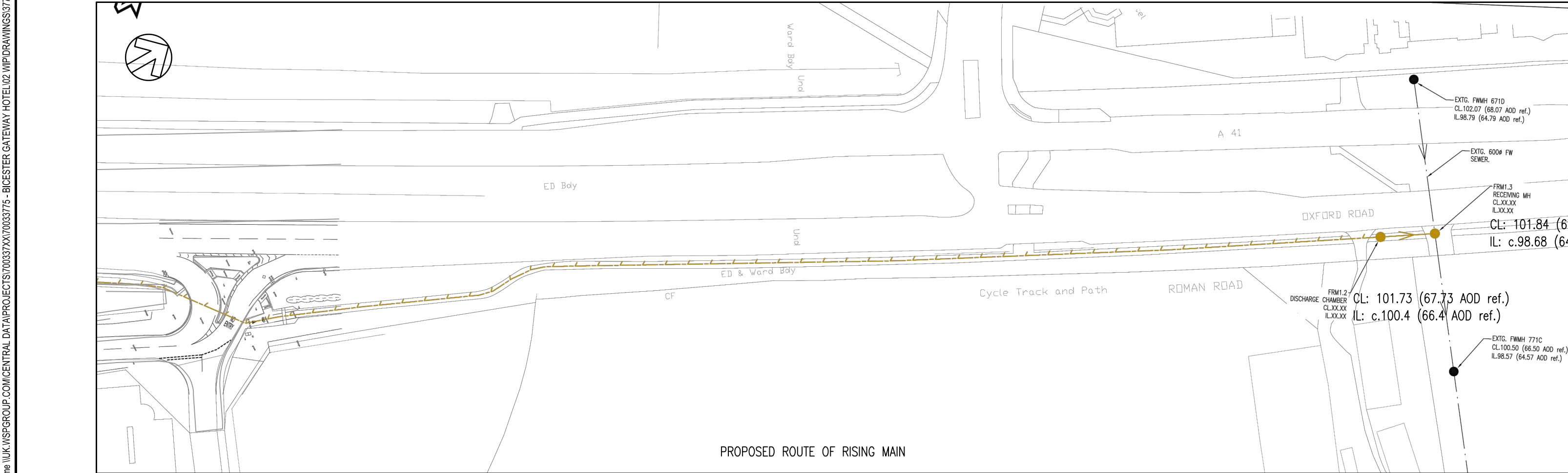

INSET A
SCALE 1:1000

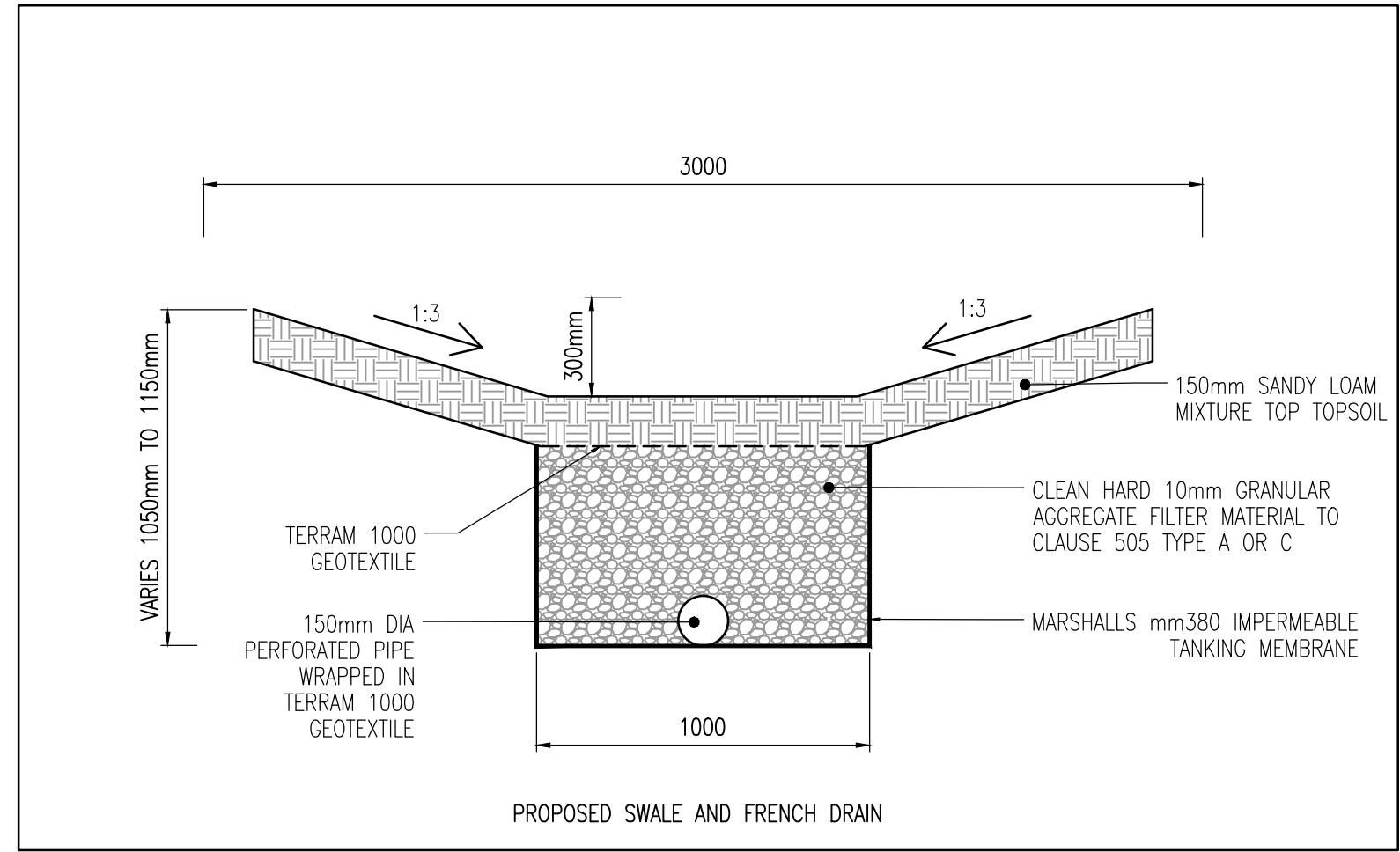

INSET B
SCALE 1:50

NOTES

DO NOT SCALE

1. ALL DIMENSIONS SHOWN ARE IN METRES UNLESS OTHERWISE STATED.

2. ALL LEVELS ARE IN METRES 34.0m ABOVE ORDNANCE DATUM.

3. THIS DRAWING IS BASED ON:

TURKINGTON MARTIN'S LANDSCAPE MASTERPLAN TM336L01 REV B

TOPOGRAPHICAL SURVEY BY TARGET SURVEYS LIMITED REFERENCE 1206/1 DATED APRIL 2015.

4. REFER TO DRAWING NUMBER 3775-WSP-00-ZZ-DR-CE-1004 FOR SECTION AND DETAILS.

KEY

PROPOSED PRIVATE FOUL WATER DRAINAGE

PROPOSED PRIVATE FOUL WATER RISING MAIN

PROPOSED PRIVATE SURFACE WATER DRAINAGE

PROPOSED PRIVATE SURFACE WATER DRAINAGE PERFORATED PIPE

RWP

IC

PROPOSED RAIN WATER PIPE WITH FLOW DIFFUSER CHAMBER AND DISCHARGE TO GRANULAR PAVING CONSTRUCTION.

DFC

PROPOSED CHECK DAM WITH ACCESS CHAMBER TO FLOW CONTROL (MIN 20M PIPE)

PROPOSED CONCRETE BLOCK PAVING TO LANDSCAPE ARCHITECT DETAILS.

PROPOSED TARMAC CONSTRUCTION WITH NORMAL CONSTRUCTION BELOW FOR JUNCTION ACCESS.

PROPOSED ACCESS WAY TARMAC PAVING CONSTRUCTION WITH COURSE GRADED AGGREGATE BELOW TO DETAIL 2. SEE NOTE 4.

PROPOSED PERMEABLE BLOCK PAVING CONSTRUCTION CAR PARK AREAS WITH COURSE GRADED AGGREGATE BELOW TO DETAIL 1. SEE NOTE 4.

PROPOSED PERMEABLE BLOCK PAVING CONSTRUCTION CAR PARKING BAY OVER ROOT PROTECTION AREA TO DETAIL 5. SEE NOTE 4.

PROPOSED SOFT LANDSCAPING NOTE: REFER TO LANDSCAPE ARCHITECT DETAILS FOR TREE PITS.

+99.360 PROPOSED FINISHED LEVEL.

PROPOSED HEADWALL REFER TO DETAIL ON WSP DRAWING NUMBER 3775-WSP-00-ZZ-DR-CE-1006

PD4

13/02/2018

KW

UPDATED TO REVISED MASTERPLAN

MB

MB

PD3

02/01/2018

MM

PIPED DITCH CROSSING SHOWN NOTE 2 REVISED. PUMPING STATION STATION RELOCATED.

AJG

MB

PD2

18/12/2017

MH

UPDATED MASTERPLAN

MB

MB

PD1

15/12/2017

MM

FIRST ISSUE

AJG

MB

REV

DATE

BY

DESCRIPTION

CHK

APP

DRAWING STATUS:

S2 - FOR INFORMATION

wsp

Unit 9 The Chase, John Tate Road, Foxholes Business Park, Hertford, SG13 7NN, UK
T+ 44 (0) 1992 526 000, F+ 44 (0) 1992 526 001
wsp.com

CLIENT:

ATLAS HOTELS GROUP

ARCHITECT:

NORR

SITE/PROJECT:

HOLIDAY INN EXPRESS
BICESTER GATEWAY

TITLE:

PAVING AND DRAINAGE STRATEGY

SCALE @ A1:

AS SHOWN

CHECKED:

AJG

APPROVED:

MB

PROJECT NO:

70033775

DESIGNED:

MM

DRAWN:

MM

DATE:

February 18

DRAWING NO:

3775-WSP-00-ZZ-DR-CE-1002

REV:

P04

© WSP UK Ltd