

File name: I:\UK\WSP\GROUP\COMP\CENTRAL DATA\PROJECTS\70033775\70033775- BICESTER GATEWAY HOTEL\22-DR-CE-1003.DWG, printed on 13 February 2018 16:19:11, by: Marinae-Dowsett, Daniel

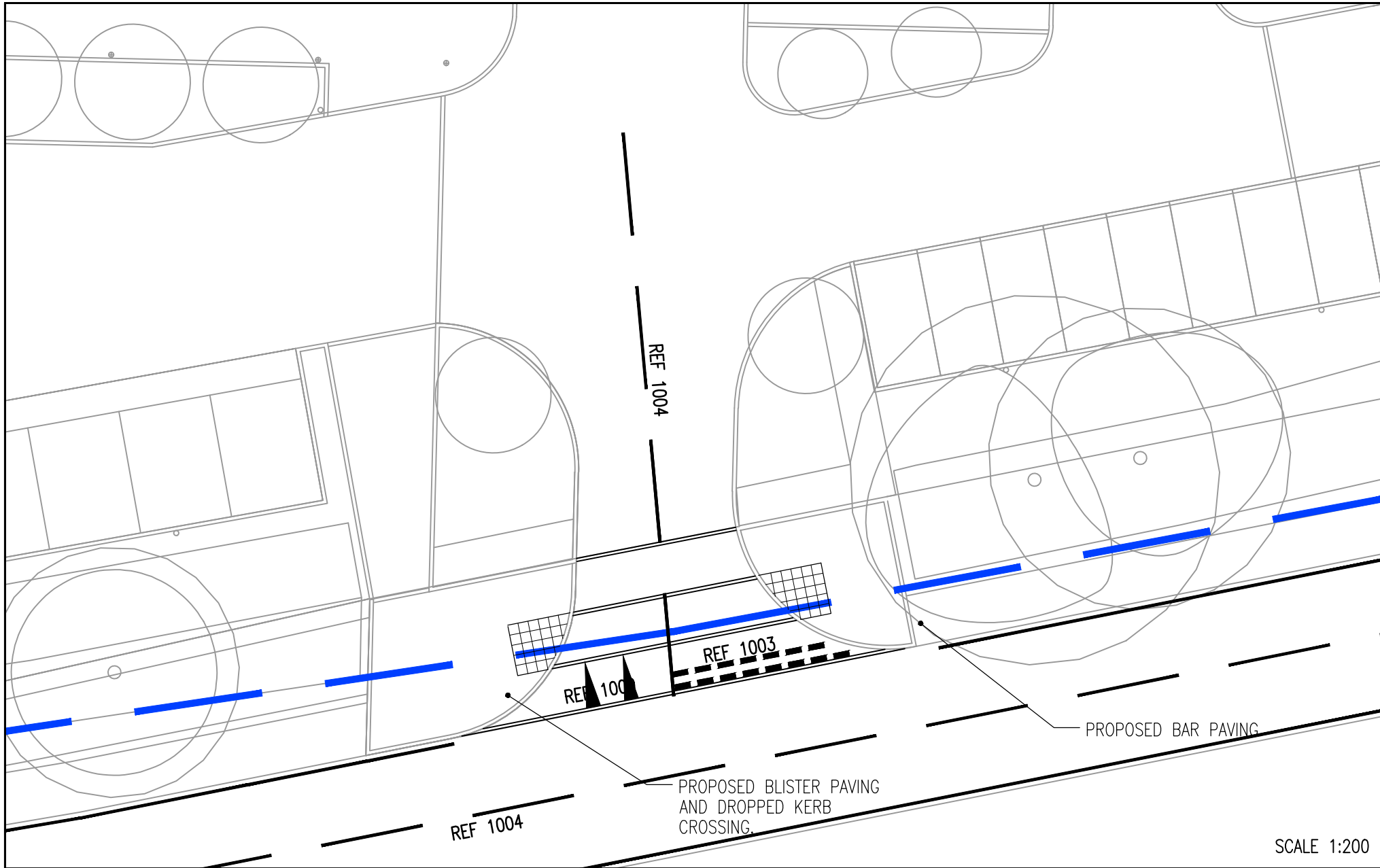
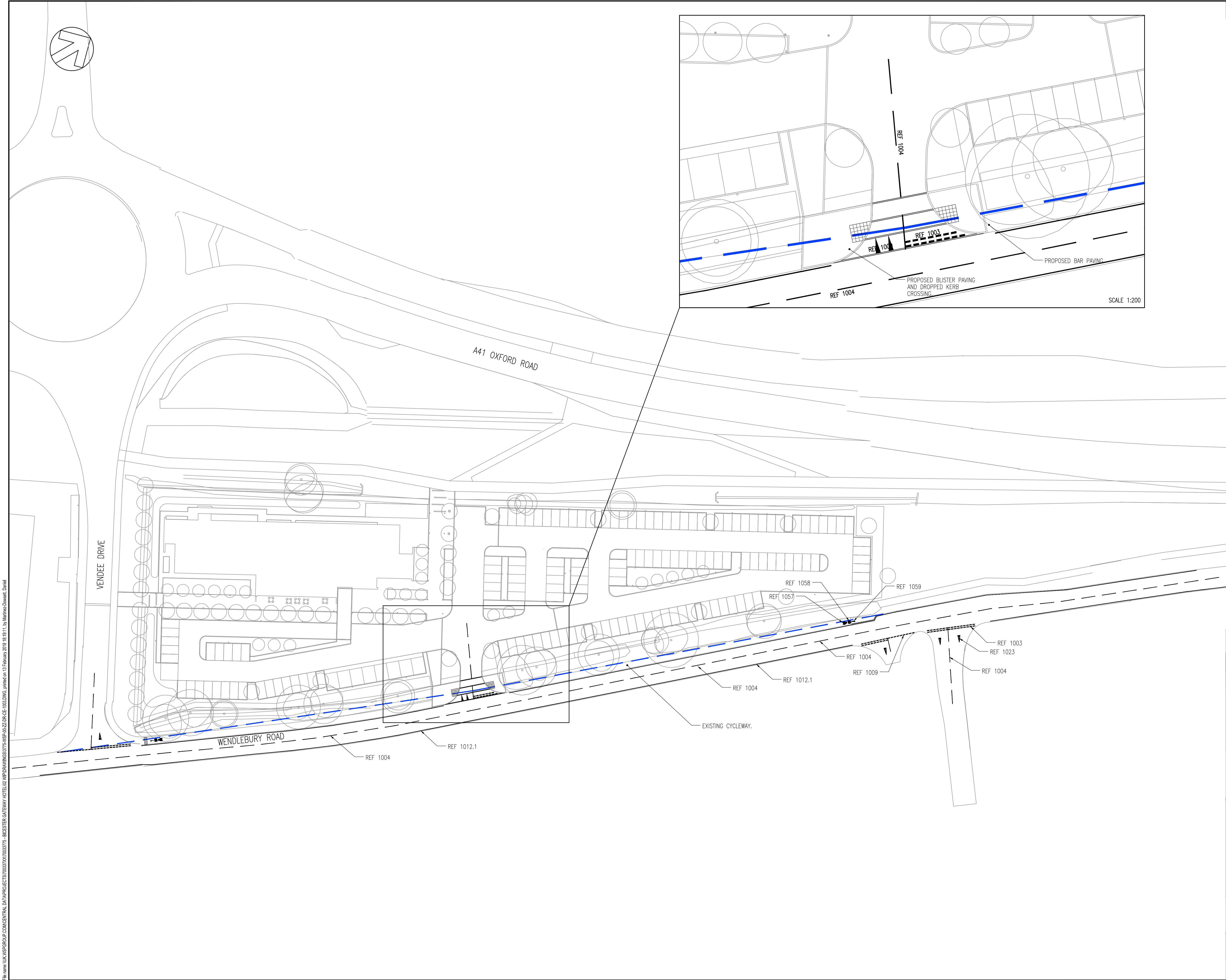

DO NOT SCALE

NOTES

1. ALL DIMENSIONS SHOWN ARE IN METRES UNLESS OTHERWISE STATED.
2. ALL LEVELS ARE IN METRES AT 34.0m ABOVE ORDINANCE DATUM.
3. THIS DRAWING IS BASED ON:
TURKINGTON MARTIN'S LANDSCAPE MASTERPLAN TM336L01
TOPOGRAPHICAL SURVEY BY TARGET SURVEYS LIMITED REFERENCE 1206/1 DATED APRIL 2015

KEY

- 2.4m x 120m VISIBILITY SPLAY BASED ON A 40MPH DESIGN SPEED (DMRB).
- REF 1004 ROAD MARKINGS REFERENCE IN ACCORDANCE WITH TRAFFIC SIGNS REGULATIONS AND GENERAL DIRECTIONS 2016 AND TRAFFIC SIGNS MANUAL

P03	13/02/2018	DMD	CYCLE CROSSING AMENDED	AJG	MB
P02	01/02/2018	MM	NOTES 2 REVISED. ROAD MARKINGS UPDATED.	AJG	MB
P01	15/12/2017	MM	FIRST ISSUE	AJG	MB
REV	DATE	BY	DESCRIPTION	CHK	APP

DRAWING STATUS:	S2 - FOR INFORMATION
-----------------	----------------------



Unit 9 The Chase, John Tate Road, Foxholes Business Park, Hertford, SG13 7NN, UK
T+ 44 (0) 1992 526 000, F+ 44 (0) 1992 526 001
wsp.com

CLIENT:	ATLAS HOTELS GROUP
---------	--------------------

ARCHITECT:	NORR
------------	------

SITE/PROJECT:	HOLIDAY INN EXPRESS BICESTER GATEWAY
---------------	---

TITLE:	VISIBILITY
--------	------------

SCALE @ A1:	1:500	CHECKED:	AJG	APPROVED:	MB
PROJECT NO:	70033775	DESIGNED:	MM	DRAWN:	MM
				DATE:	February 18

DRAWING No:	3775-WSP-00-ZZ-DR-CE-1003	REV:	P03
-------------	---------------------------	------	-----

© WSP UK Ltd
