

**LEGEND**

- Existing trees / vegetation - refer to arboricultural report for detail
- Proposed tree
- Proposed hedge
- Proposed climber
- Proposed specimen plant
- Proposed planting
- Proposed grass
- Proposed root barrier - GreenBlue Urban ReRoot 1000 or similar approved
- Page division lines
- Site application boundary

**GENERAL NOTES**

This drawing is to be used for planting information only, and is subject to alteration through changes to the site layout or until approved by the area designer.

Any species substitution by the contractor must be verified with the Landscape Architect through the Job Architect.

This layout must be checked in accordance with NHBG Standards 2013 (Chapter 4.2 - Building Near Trees & Chapter 9.2 Drives, Paths and Landscaping) by the Regional Engineer prior to implementation.

Excavations: Contractors must ensure that they have full information relating to service and drainage positions before undertaking any excavations.

Root barriers to be used in association with tree planting adjacent to kerbs / services / footpaths etc. (GreenBlue Urban ReRoot products or similar application, in accordance with manufacturer's instructions).

For Planting Schedule refer to LLA drawing 1908 12

For Detailed LEAP Proposals refer to LLA drawing 1908 08

For Landscape Specification, Planting Details and Emorgas Seed Mixes refer to LLA drawing 1908 09

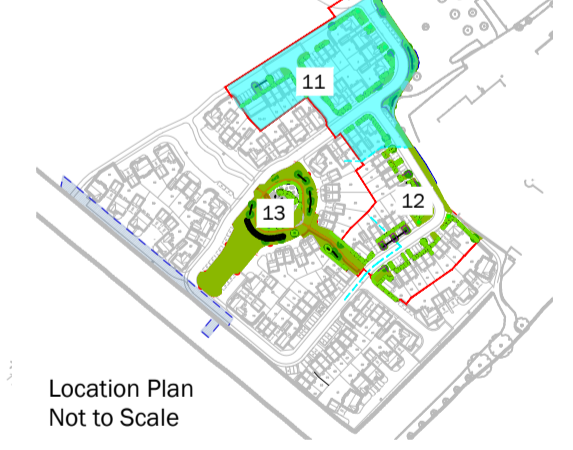

Rev	Date	Description
A	29.01.18	POS updated
B	20.04.18	New architectural layout
C	23.04.18	Amendments to planting
D	24.04.18	Amendments to planting outside plot 37
E	14.05.18	New architectural layout
F	07.06.18	General amendments
G	11.06.18	Updated layout
H	14.06.18	Updated layout
I	18.07.18	Updated layout

Title: Detailed Planting Proposals - Phase 1  
 Sheet 1 of 3  
 Project: Blossom Fields, Bodicote, Banbury  
 Client: Crest Nicholson  
 Date: December 2017  
 Scale: 1:200 @ A1  
 Drawing No: 1908 11 I  
 Rev:

T: +44 (0)1273 647044 E: office@lizlake.com www.lizlake.com  
 COPYRIGHT © Liz Lake Associates  
 Information contained in this drawing is confidential and may not be used for any purpose other than that for which the drawing is supplied without prior written authority of Liz Lake Associates.  
 This drawing is copyright and may not be copied, altered or used without the agreed conditions of use.  
 BEST PRACTICE: Referenced from Ordnance Survey map data by permission of Ordnance Survey © Crown copyright 2014, Licence No. 200001205  
 Ordnance Survey Licence No. 0100012173  
 This drawing may contain information which may be a trade secret or confidential information and its disclosure may be detrimental to the interests of the client.



**FOR CONTINUATION REFER LLA DWG 1908 12**