



- LEGEND**
- Existing Vegetation to be retained
 - Proposed Trees
 - Grass: Meadow (EM1 - Basic general purpose meadow mixture by Emorsgate seeds or similar approved)
 - Grass:Mown
 - Hoggin Footpath
 - Rubber Eco Mulch surfacing in various colours
 - Bowtop fencing and self closing gate

- NOTES:**
- ✓ All Play areas to be subject to ROSPA design standard specifications and post installation inspection
 - ✓ For Landscape Specification refer to drawing 1619 A6 17
 - ✓ For Planting Schedule refer to drawing 1619 A6 14
 - ✓ For Planting Details refer to drawing 1619 A6 15



1 NAT506 - TREE CASTLE BY KOMPAN



2 GSP0005 - PEEKABOO TUNNEL BY KOMPAN



3 MSC5401 - CLOUD CLIMBER BY KOMPAN

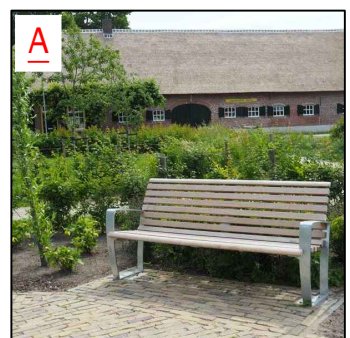

A BX14 4015 - Willenhall seat



B BX45 2552-DD-RC - Derby Double Wheelie Bin



C M213 - KOMPAN Sign for 3 descriptions

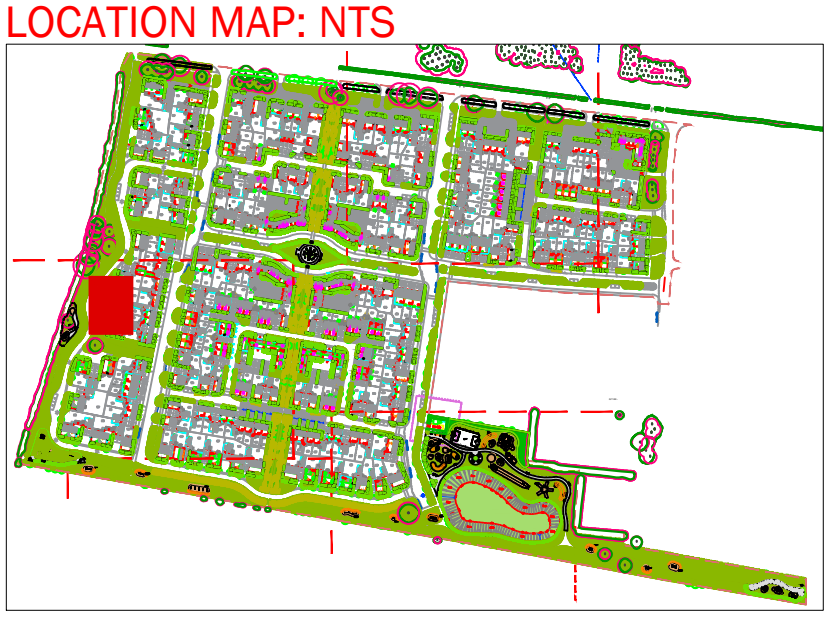

Rev	Date	Description
A	11.11.16	Tree No. reduced following comments
B	15.01.18	Layout alterations following architectural layout amendments
C	07.09.18	Arrangement Adjustments

Title: Western LAP 2 Proposal
 Project: Hordley Park, Chester - Phase 9
 Client: Hordley Park Living
 Date: October 16
 Scale: 1:100@ A2
 Drawing No: 1619 A6 09 C
 Rev:

