

- LEGEND**
- Existing Vegetation to be retained
 - Proposed Trees
 - Native Hedgerow
 - Grass: Meadow (EM1 - Basic general purpose meadow mixture by Emorsgate seeds or similar approved)
 - Grass:Mown
 - Grass: Wetland (EG8 - Meadow grass mixture for wetlands by Emorsgate seeds or similar approved)
 - Rubber Eco Mulch surfacing in various colours
 - Rubber safety surface
 - Hoggin footpath
 - Low Mounding
 - Natural play boulders
 - Bowtop fencing and self closing gate
 - Timber knee rail and access gate

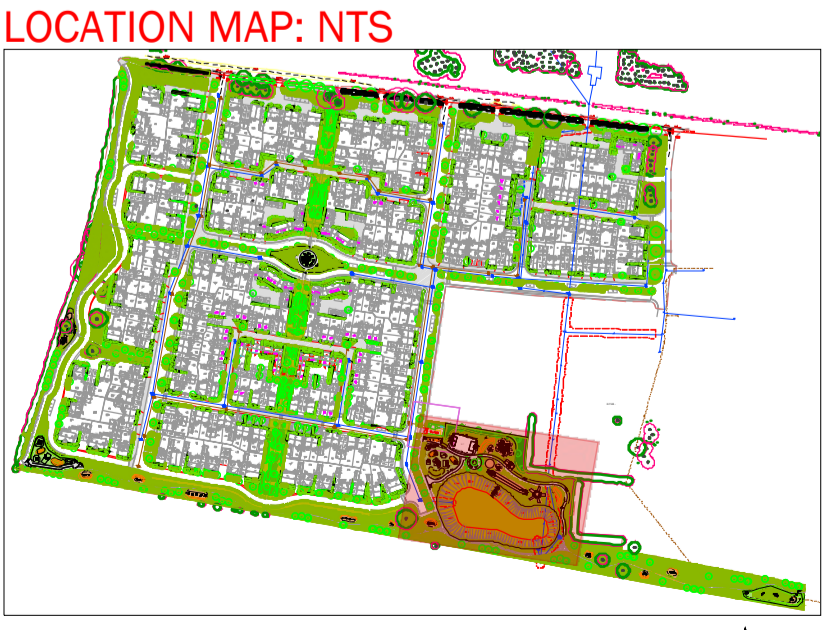

Rev	Date	Description
A	11.11.16	Tree No. reduced following comments
B	15.01.18	Layout alterations following architectural layout amendments

Title: Eastern POS Detailed Proposal
 Client: Hayfield Park, parcel 9
 Project: Planning
 Date: 15.01.18
 Scale: 1:200 @ A1
 Drawing No: 1619 A6 05 B
 Rev: 1

T: +44 (0)1273 647044 E: office@lize.com www.lize.com

LIZ LAKE ASSOCIATES
LANDSCAPE ARCHITECTS

NOTES:

All Play areas to be subject to ROSPA design standard specifications and post installation inspection.

For Landscape Specification refer to drawing 1619 A6 17

For Planting Schedule refer to drawing 1619 A6 14

For Planting Details refer to drawing 1619 A6 18

For Tree Planting Details refer to drawing 1619 A6 03