

NAT807 - OVERHEAD BARS BY KOMPAN

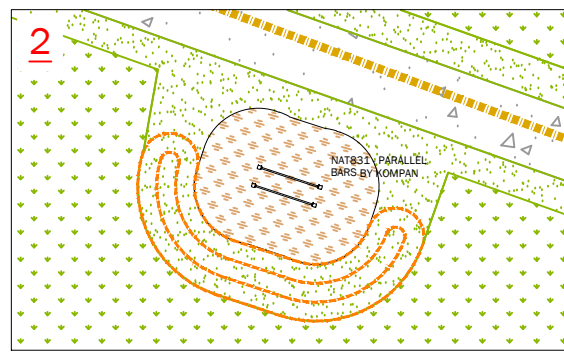

NAT831 - PARALLEL BARS BY KOMPAN

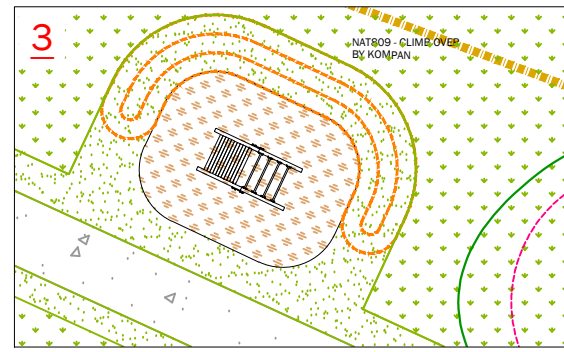

NAT809 - CLIMB OVER BY KOMPAN

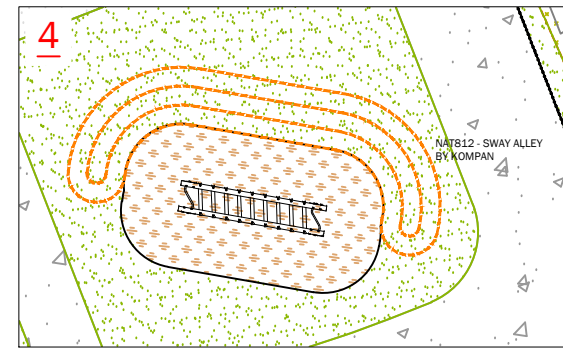

NAT812 - SWAY ALLEY BY KOMPAN

LEGEND

- Proposed Trees
- Grass: Meadow (EM1 – Basic general purpose meadow mixture by Emorsgate seeds or similar approved)
- Grass:Mown
- Rubber Eco Mulch surfacing in various colours
- Low Mounding

NOTES:

All Play areas to be subject to ROSPA design standard specifications and post installation inspection

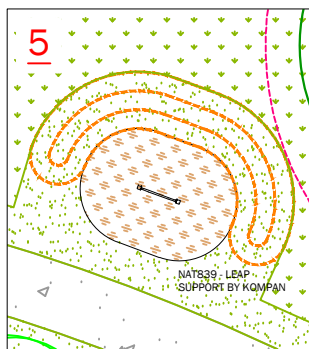

NAT839 - LEAP SUPPORT BY KOMPAN

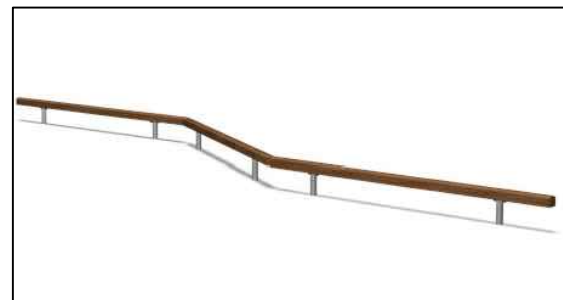
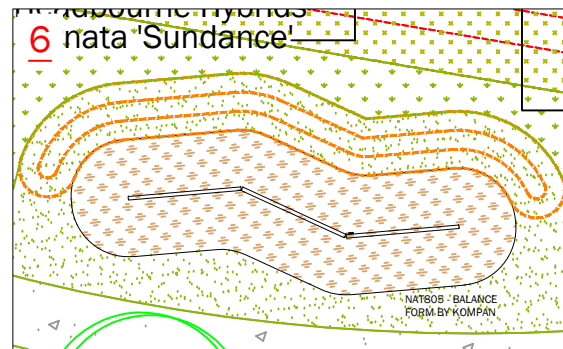

NAT805 - BALANCE FORM BY KOMPAN

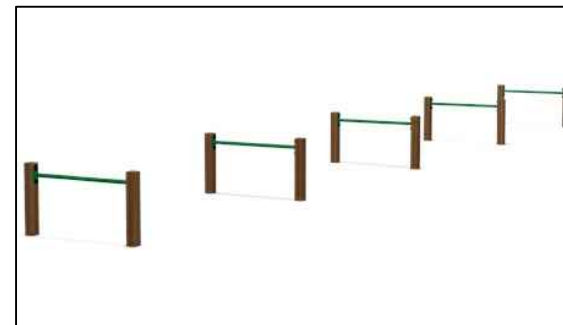
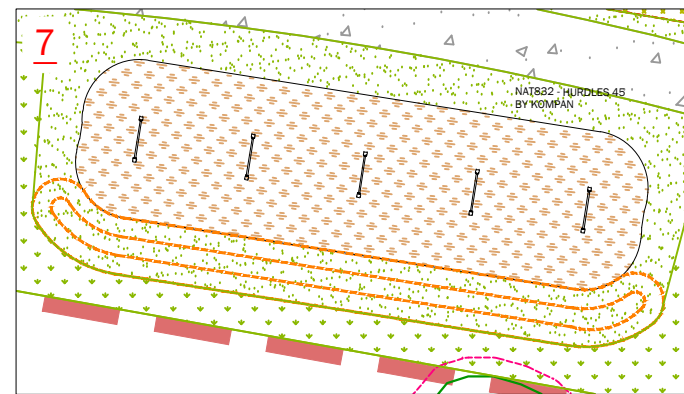

NAT832 - HURDLES 45 BY KOMPAN

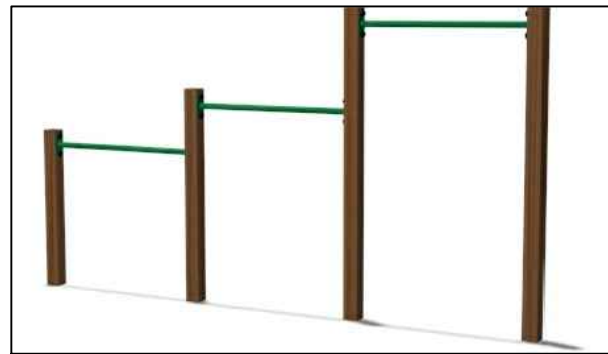
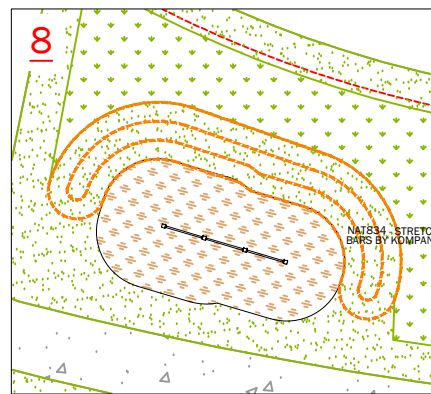

NAT834 - STRETCHING BARS BY KOMPAN

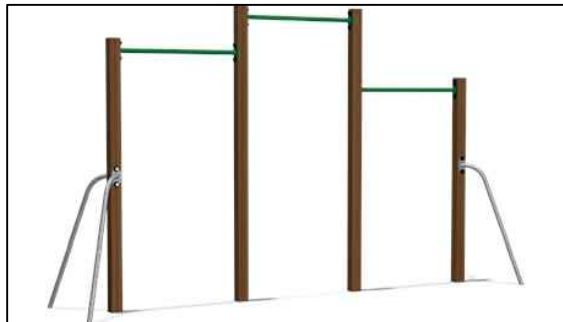
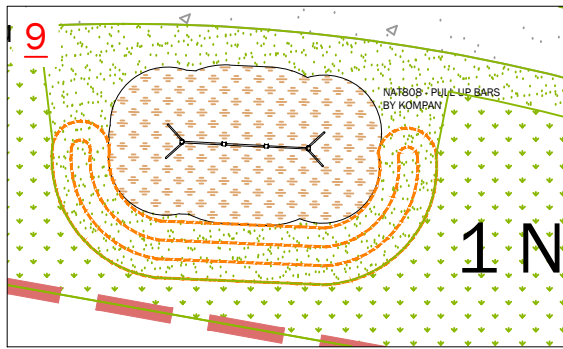

NAT808 - PULL UP BARS BY KOMPAN

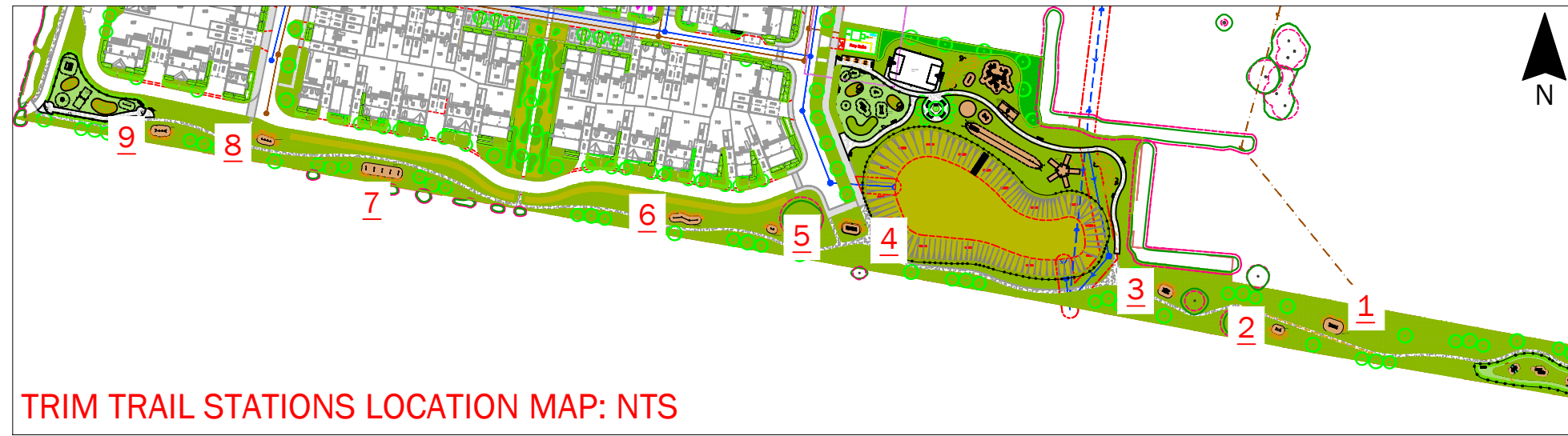

TRIM TRAIL STATIONS LOCATION MAP: NTS

Rev	Date	Description
A	11.11.16	Tree No. reduced following comments
B	15.01.18	Layout alterations following architectural layout amendments

Title: Trim Trail Proposal
 Project: Heyford Park, Bicester parcel 9
 Client: Donchester living
 Date: October 16
 Scale: 1:200@ A3
 Drawing No: 1619 A6 06 B
 Rev:

T: +44 (0)1279 647044 E: office@lizlake.com www.lizlake.com

COPYRIGHT Liz Lake Associates
 Information contained in this drawing is confidential and may not be used for any purpose other than that for which the drawing is supplied without prior written authority of Liz Lake Associates. This drawing is copyright and may not be copied except within the agreed conditions of supply.

BASE MAPPING:
 Reproduced from Ordnance Survey map data by permission of Ordnance Survey © Crown copyright 2014. Licence No. 100007196.
 © Crown copyright and database rights 2014
 Ordnance Survey Licence No. 0100031673.
 This drawing may contain information and/or mapping from a number of sources and its accuracy should be verified on site.

LIZ LAKE ASSOCIATES
 LANDSCAPE ARCHITECTS