

- LEGEND**
- Existing Vegetation to be retained
 - Proposed Trees
 - Hedging
 - Grass: Meadow (EM1 – Basic general purpose meadow mixture by Emorsgate seeds or similar approved)
 - Grass: Mown
 - Grass: Wetland (EG8 – Meadow grass mixture for wetlands by Emorsgate seeds or similar approved)
 - Grass Mounding
 - Hoggin Footpath
 - Rubber safety surface
 - 1.5m Bowtop fencing and self closing gate

NOTES:

All Play areas to be subject to ROSPA design standard specifications and post installation inspection

For Landscape Specification refer to drawing 1619 A6 17

For Planting Schedule refer to drawing 1619 A6 14

For Planting Details refer to drawing 1619 A6 15

For Tree Planting Details refer to drawing 1619 A6 03

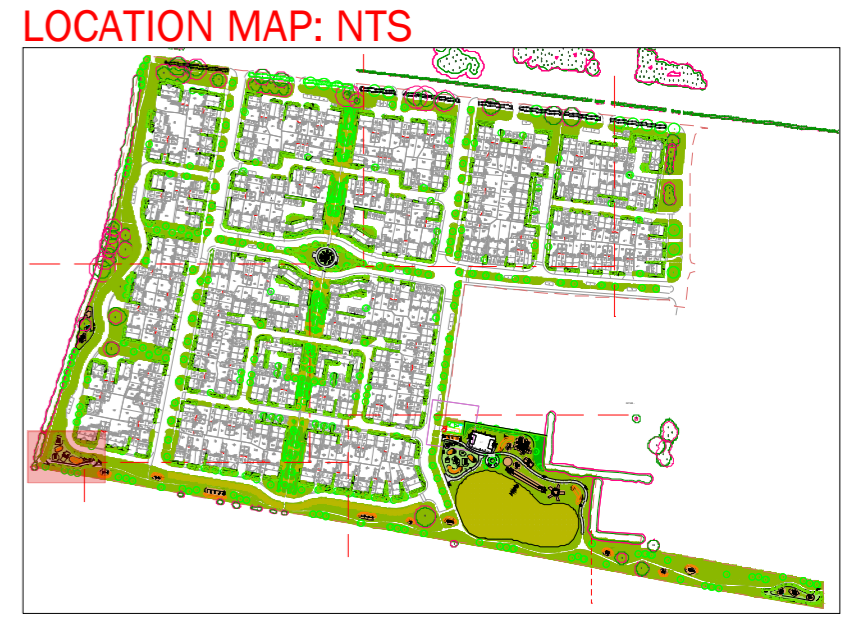

Rev	Date	Description
A	11.11.16	Tree No. reduced following comments
B	15.01.18	Layout alterations following architectural layout amendments
C	30.04.18	Plot number amendments

Title: South Western LEAP Proposal

Project: Heyford Park Water parcel 9

Client: Quaker Living

Date: October 16

Scale: 1:100@ A2

Drawing No: 1619 A6 08 C

Rev:

T: +44 (0)1279 647044 E: office@lizlake.com www.lizlake.com

COPYRIGHT Liz Lake Associates
Information contained in this drawing is confidential and may not be used for any purpose other than that for which the drawing is supplied without prior written authority of Liz Lake Associates. This drawing is copyright and may not be copied except within the agreed conditions of supply.



KPL816 - TOWER WITH CLIMBING WALL BY KOMPAN



NRO109 - CAROUSEL BY KOMPAN



KSW90014-0902 - DOUBLE SWING, PINE, H=2.5M, 90CM IN GROUND BY KOMPAN

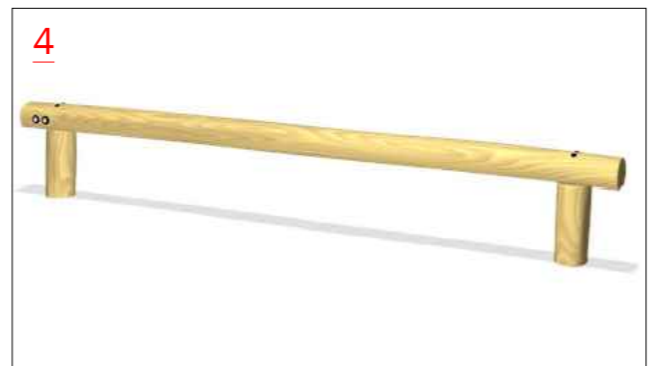

NRO802 - SINGLE BALANCE BEAM BY KOMPAN



BX14 4015 - Willenhall seat



BX45 2552-DD-RC - Derby Double Wheelie Bin

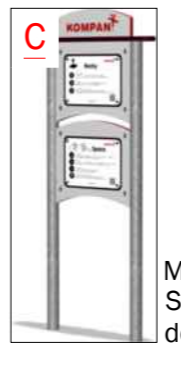

M213 - KOMPAN Sign for 3 descriptions