

**PUBLIC\_RIGHTS\_OF\_WAY**

- STATUS**
  - Public Footpath
  - Public Bridleway
  - Restricted Byway
  - Byway Open to all Traffic
  - SWIFT\_RECORDS
- PROTECTED\_AND\_NOTABLE\_SPECIES**
  - PROTECTED\_SPECIES\_BUFFER
  - ROAD\_VERGE\_NATURE\_RESERVES
  - EIL\_TEXT
  - ASSETS\_OF\_COMMUNITY\_VALUE
- Area TPOs**
  - Area TPOs
  - Group TPOs
  - TPO Trees
  - Woodland TPOs
- LISTED BUILDINGS**
  - GRADE**
    - I
    - II\*
    - II
    - DL
  - CURTLAGE LISTING
  - LOCALLY\_LISTED\_BUILDINGS
  - ARTICLE\_4
  - ARCHAEOLOGICAL\_CONSTRAINT\_PRIORITY\_AREAS
  - SCHEDULED\_ANCIENT\_MONUMENT
  - EIL\_REGIONS
  - PONDS\_MAPPING (INCLUDING GREAT CRESTED NEWTS)
  - NERC ACT S41 Habitats (Previously UKBAP PRIORITY HABITATS)
  - REGISTERED\_COMMON\_LAND
  - SPECIAL\_SITES\_OF\_SCIENTIFIC\_INTEREST
  - SPECIAL\_AREAS\_OF\_CONSERVATION
  - ANCIENT\_WOODLAND
  - CONSERVATION\_AREAS
  - DISTRICT\_WILDLIFE\_SITES
  - LOCAL\_WILDLIFE\_SITES
  - PROPOSED\_NEW\_LWS\_AND\_EXTENSIONS\_LWS
  - LOCAL\_NATURE\_RESERVE
  - PARKS\_AND\_GARDENS
  - AREAS\_OF\_OUTSTANDING\_NATURAL\_BEAUTY
  - RAILWAY\_TUNNEL
  - HIGH\_PRESSURE\_GAS\_PIPELINES
  - LGS\_POINTS
  - LGS\_POLYGONS
- POTENTIALLY\_CONTAMINATED\_LAND**
  - Buffer Distance
    - 0
    - 50
- EA\_LANDFILL\_SITES**
  - Buffer Distance
    - 0
    - 250
  - HISTORIC\_LANDFILL\_SITES\_10K
  - BANK\_TOP\_WIDTH\_PLANNING
  - CRT\_HOUSEHOLD\_AND\_MINOR\_SCALE\_DEVELOPMENTS
  - CRT\_EIA\_AND\_MAJOR\_SCALE\_DEVELOPMENTS
  - Flood Zone 3
  - Flood Zone 2
  - NAT\_FSA
  - NAT\_DEFENCES
  - NAT\_AREAS\_BENEFIT
  - NAT\_CENTRELINES
- HS2\_SAFEGUARDING\_ZONES**
  - Type
    - Safeguarding Limits
    - Sub-Surface
    - Surface
  - NATURALLY\_ELEVATED\_ARSENIC
  - GREEN\_BELT
  - CONSERVATION\_TARGET\_AREAS
  - MINERAL\_CONSULTATION\_AREAS
  - MINERAL\_CONSULTATION\_REGION
- Neighbourhood Development Plans**
  - Details
    - Neighbourhood Plan Area
    - Important Amenity Green Spaces
    - Local Green Spaces
    - NATIONAL\_GRID\_REFERENCE
    - WARDS
    - PARISHES

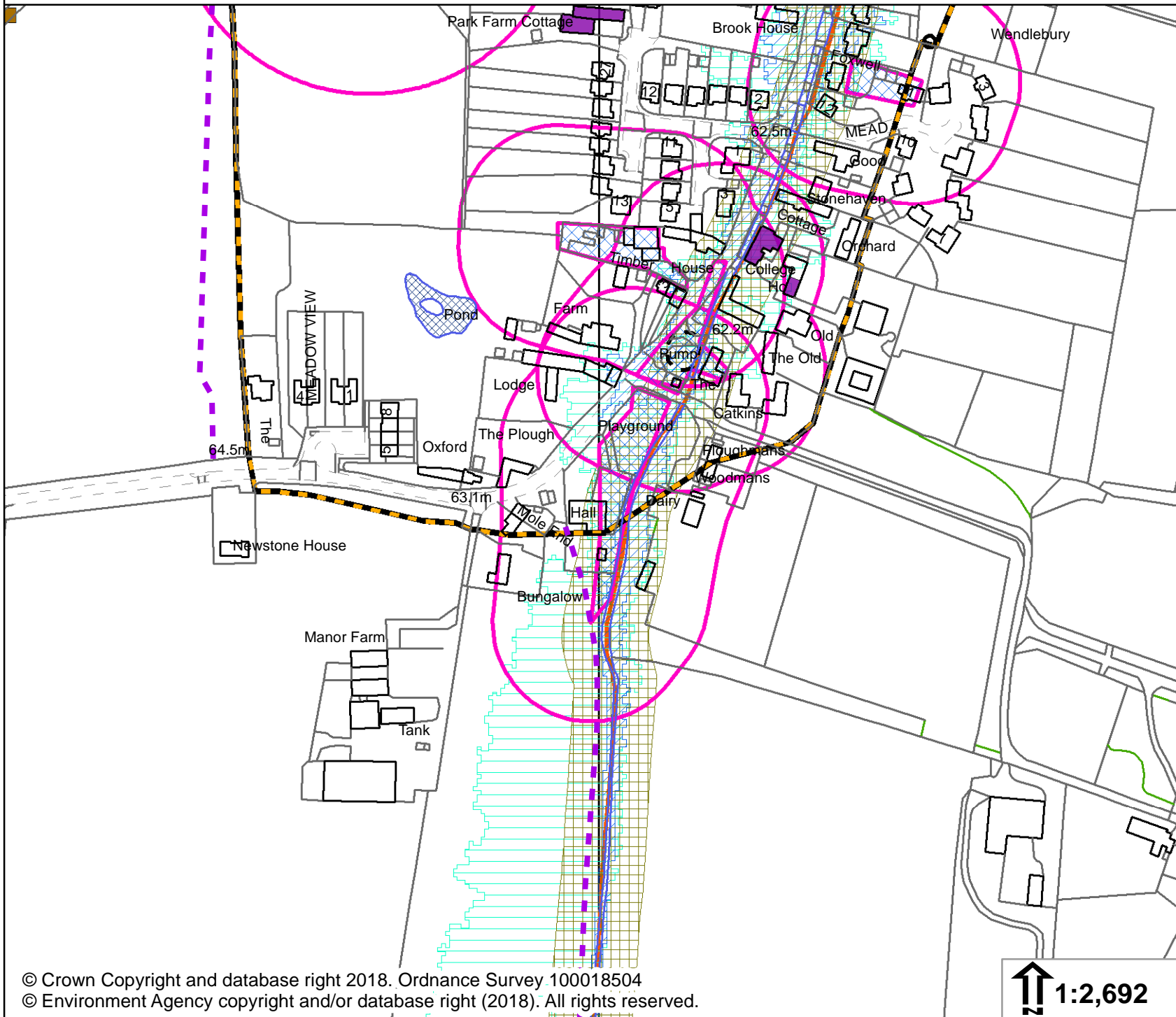

© Crown Copyright and database right 2018. Ordnance Survey 100018504  
© Environment Agency copyright and/or database right (2018). All rights reserved.

↑ 1:2,692