

### SAFETY HEALTH AND ENVIRONMENTAL

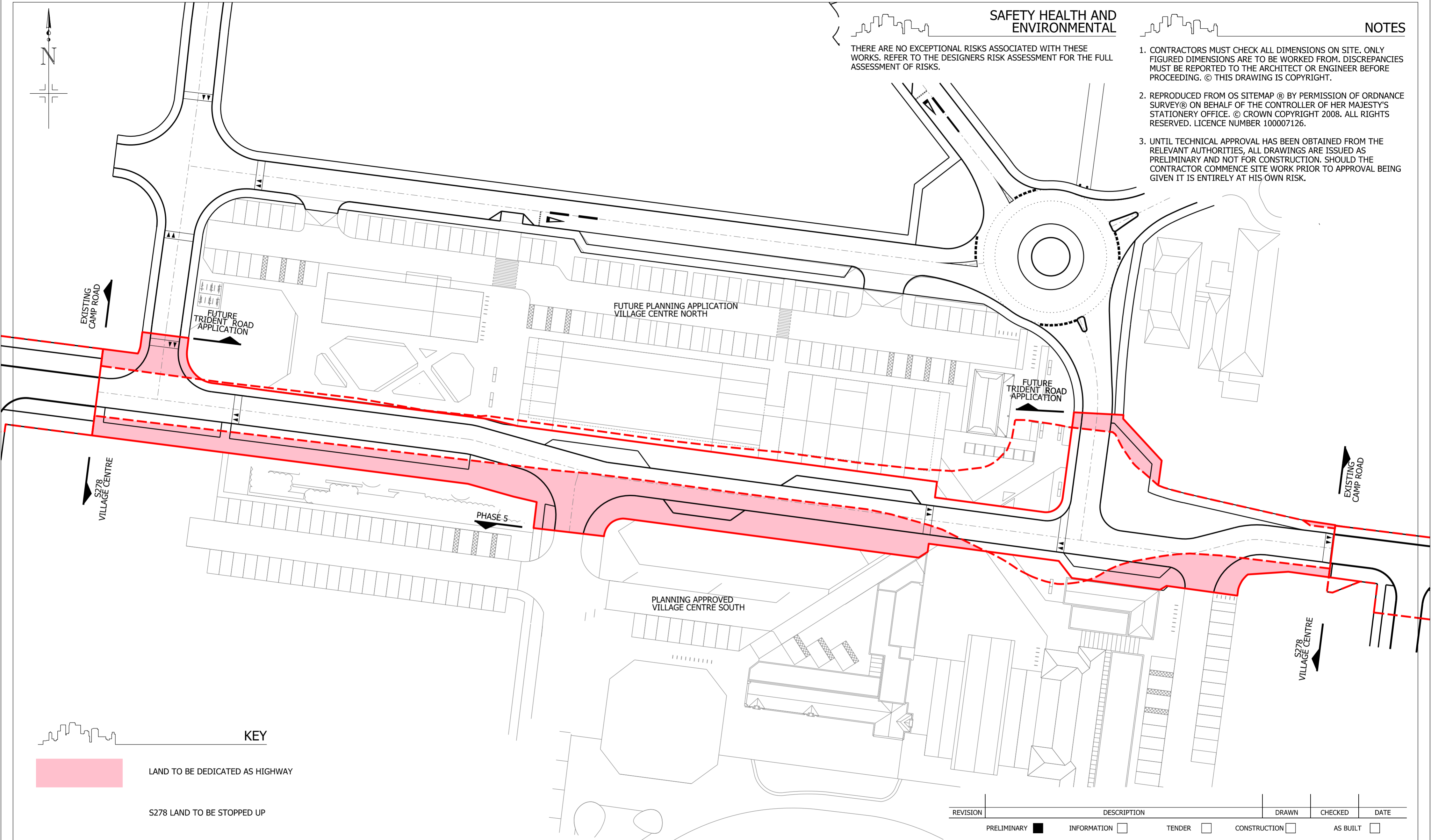



THERE ARE NO EXCEPTIONAL RISKS ASSOCIATED WITH THESE WORKS. REFER TO THE DESIGNERS RISK ASSESSMENT FOR THE FULL ASSESSMENT OF RISKS.

### NOTES

1. CONTRACTORS MUST CHECK ALL DIMENSIONS ON SITE. ONLY FIGURED DIMENSIONS ARE TO BE WORKED FROM. DISCREPANCIES MUST BE REPORTED TO THE ARCHITECT OR ENGINEER BEFORE PROCEEDING. © THIS DRAWING IS COPYRIGHT.
2. REPRODUCED FROM OS SITEMAP ® BY PERMISSION OF ORDNANCE SURVEY® ON BEHALF OF THE CONTROLLER OF HER MAJESTY'S STATIONERY OFFICE. © CROWN COPYRIGHT 2008. ALL RIGHTS RESERVED. LICENCE NUMBER 100007126.
3. UNTIL TECHNICAL APPROVAL HAS BEEN OBTAINED FROM THE RELEVANT AUTHORITIES, ALL DRAWINGS ARE ISSUED AS PRELIMINARY AND NOT FOR CONSTRUCTION. SHOULD THE CONTRACTOR COMMENCE SITE WORK PRIOR TO APPROVAL BEING GIVEN IT IS ENTIRELY AT HIS OWN RISK.



### KEY

-  LAND TO BE DEDICATED AS HIGHWAY
-  S278 LAND TO BE STOPPED UP
-  EXISTING HIGHWAY BOUNDARY WITHIN THE SITE
-  EXISTING HIGHWAY BOUNDARY WITHIN THE SITE

REVISION	DESCRIPTION	DRAWN	CHECKED	DATE
PRELIMINARY	INFORMATION	TENDER	CONSTRUCTION	AS BUILT

**WOODS HARDWICK**  
 ARCHITECTS, ENGINEERS AND DEVELOPMENT CONSULTANTS

TITLE **CAMP ROAD UPPER HEYFORD**

DETAILS **VILLAGE CENTRE - S278 LAND TO BE DEDICATED AS HIGHWAY**

SCALE: 1:500 @ A2    DATE: FEB 2017    DRAWN: CG    CHK: AT

15-17 GOLDINGTON ROAD  
 BEDFORD, MK40 3NH  
 T. +44 (0)1234 268862  
 FORT DUNLOP, FORT PARKWAY  
 BIRMINGHAM, B24 9FE  
 UNITED KINGDOM  
 T. +44 (0)121 6297700  
 MAIL@WOODSHARDWICK.COM  
 WWW.WOODSHARDWICK.COM



Please consider the environment before printing this drawing  
 Filepath: F:\Engineer

HEYF-5-234