

THERE ARE NO EXCEPTIONAL RISKS ASSOCIATED WITH THESE WORKS. REFER TO THE DESIGNERS RISK ASSESSMENT FOR THE FULL ASSESSMENT OF RISKS.

1. CONTRACTORS MUST CHECK ALL DIMENSIONS ON SITE. ONLY FIGURED DIMENSIONS ARE TO BE WORKED FROM. DISCREPANCIES MUST BE REPORTED TO THE ARCHITECT OR ENGINEER BEFORE PROCEEDING. © THIS DRAWING IS COPYRIGHT.

2. REPRODUCED FROM OS SITEMAP © BY PERMISSION OF ORDNANCE SURVEY® ON BEHALF OF THE CONTROLLER OF HER MAJESTY'S STATIONERY OFFICE. © CROWN COPYRIGHT 2008. ALL RIGHTS RESERVED. LICENCE NUMBER 100007126.

3. UNTIL TECHNICAL APPROVAL HAS BEEN OBTAINED FROM THE RELEVANT AUTHORITIES, ALL DRAWINGS ARE ISSUED AS PRELIMINARY AND NOT FOR CONSTRUCTION. SHOULD THE CONTRACTOR COMMENCE SITE WORK PRIOR TO APPROVAL BEING GIVEN IT IS ENTIRELY AT HIS OWN RISK.

BUILDING DRAINAGE
1. ALL CONNECTIONS TO ADOPTABLE MANHOLES FROM GULIES AND PRIVATE BUILDING DRAINAGE TO BE 150mm DIAMETER PIPES UNLESS OTHERWISE SPECIFIED.

2. ALL HOUSE DRAINAGE TO BE 100mm DIA UNLESS OTHERWISE STATED, AND LAID IN ACCORDANCE WITH CURRENT BUILDING REGULATIONS AND BS8301 : 1985.

3. ALL PRIVATE DRAINAGE PRODUCTS ARE TO BE POLYPIPE OR SIMILAR APPROVED.

4. PIPE BEDDING MATERIAL IS TO BE CLASS S WITH 150mm MINIMUM THICKNESS SURROUND.

5. BACKFILL IS TO BE WITH SELECTED FILL FREE OF STONES LARGER THAN 40mm, LUMPS OF CLAY OVER 100mm, TIMBER, FROZEN MATERIAL AND VEGETABLE MATTER.

6. PIPE PROTECTION OF SHALLOW DRAINAGE RUNS TO BE IN ACCORDANCE WITH THE TYPICAL DRAINAGE DETAILS DRAWING. THE CONTRACTOR SHALL SATISFY THEMSELVES AND AGREE WITH THE SITE MANAGEMENT THE ACTUAL EXTENT OF PIPE PROTECTION REQUIRED.

7. PIPES ENTERING AND LEAVING MANHOLES/INSPECTION CHAMBERS SHALL INCLUDE A ROCKER PIPE, 600mm IN LENGTH.

8. BRICKWORK TO CHAMBERS SHALL BE CLASS B ENGINEERING TO BS3921.

9. RAINWATER PIPES ARE TO BE SITED ON SIDE ELEVATIONS WHENEVER POSSIBLE.

11. ALL FLIGHTS OF STEPS TO PRIMARY LEVEL ACCESS, WITH MORE THAN 2 STEPS ARE TO BE PROVIDED WITH HANDRAILING, EXCEPT WHERE THE STEPS ARE 900mm ARE MORE APART.

12. ROAD GULLIES AND ROAD DESIGN SUBJECT TO HIGHWAY AUTHORITY APPROVAL.

13. PRIMARY DRAINAGE SUBJECT TO WATER COMPANY APPROVAL.

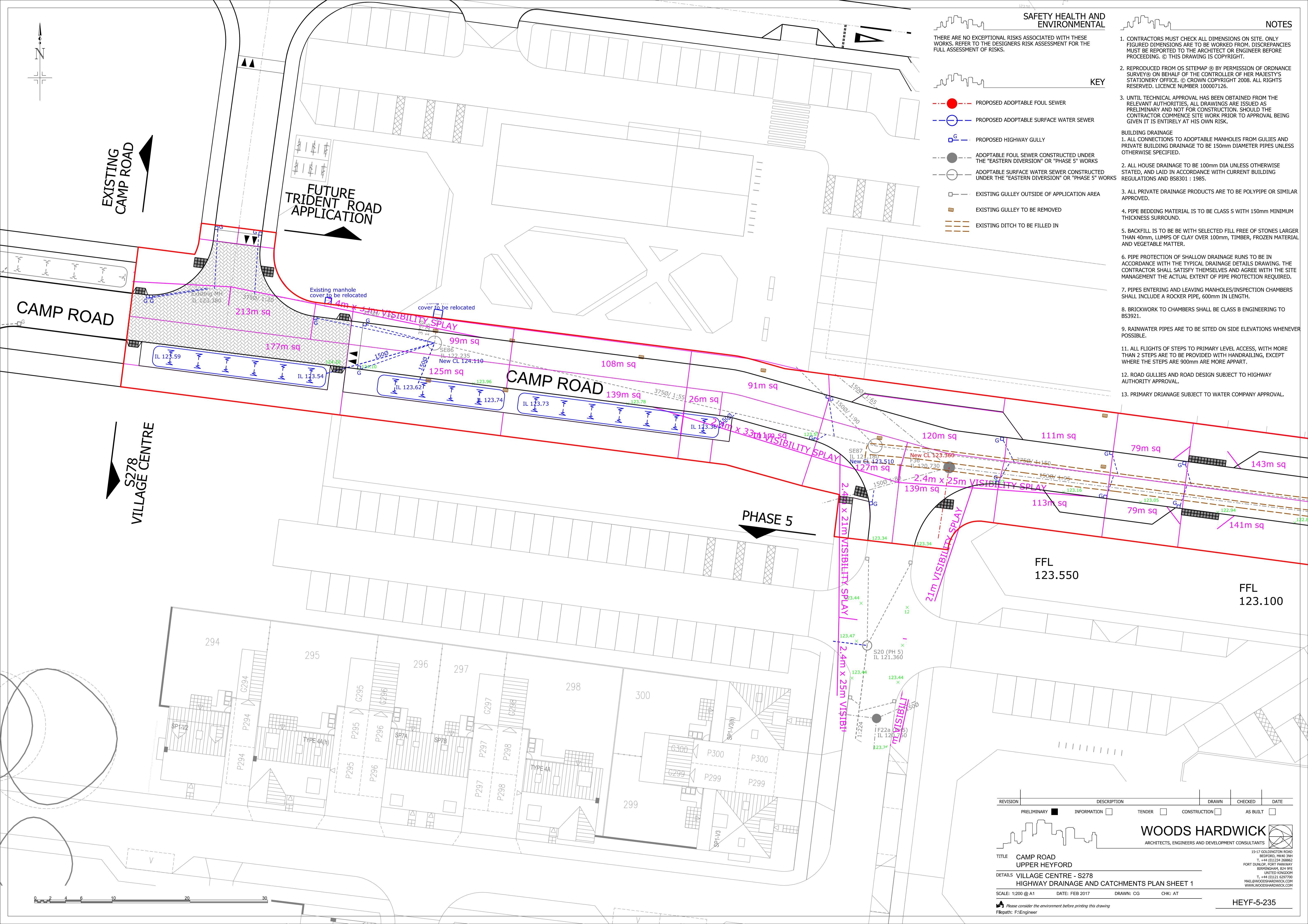
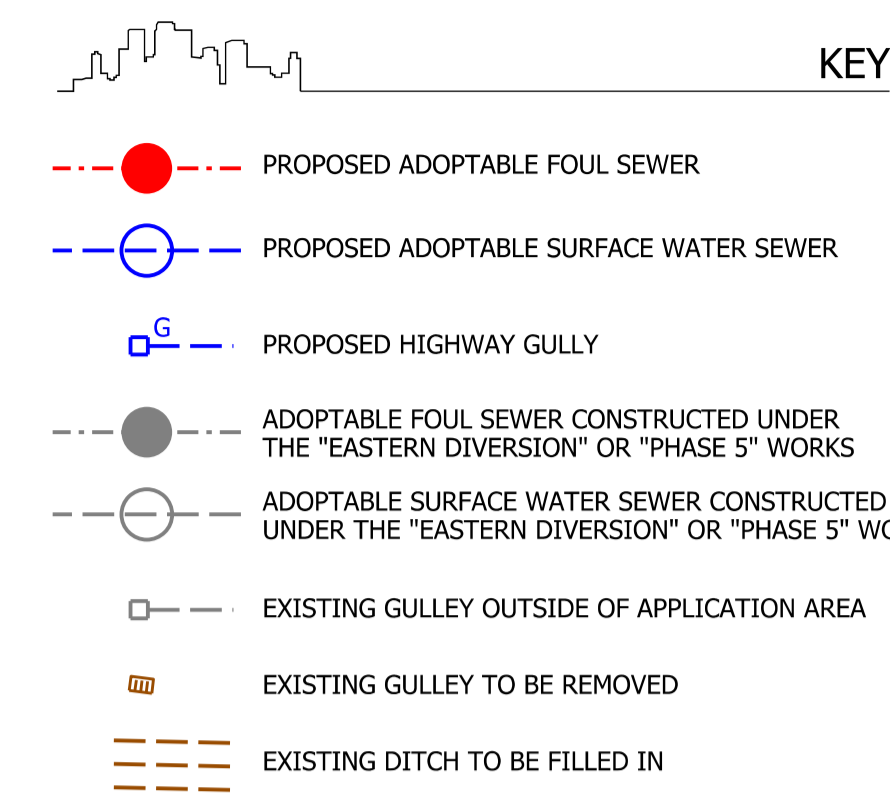

REVISION	DESCRIPTION	DRAWN	CHECKED	DATE
PRELIMINARY	INFORMATION	TENDER	CONSTRUCTION	AS BUILT

WOODS HARDWICK
ARCHITECTS, ENGINEERS AND DEVELOPMENT CONSULTANTS

TITLE: CAMP ROAD UPPER HEYFORD
 DETAILS: VILLAGE CENTRE - S278 HIGHWAY DRAINAGE AND CATCHMENTS PLAN SHEET 1
 SCALE: 1:200 @ A1 DATE: FEB 2017 DRAWN: CG CHK: AT

15-17 GOLDINGTON ROAD BEDFORD, MK40 3JH
 T: +44 (0)1234 26862 FORT DUNLOP FORT PARKWAY BIRKINGHAM, EN WFE UNITED KINGDOM T: +44 (0)121 6297700 MAIL:WOODS@WOODS-HARDWICK.COM WWW.WOODS-HARDWICK.COM