

SAFETY HEALTH AND ENVIRONMENTAL

THERE ARE NO EXCEPTIONAL RISKS ASSOCIATED WITH THESE WORKS. REFER TO THE DESIGNERS RISK ASSESSMENT FOR THE FULL ASSESSMENT OF RISKS.

NOTES

1. CONTRACTORS MUST CHECK ALL DIMENSIONS ON SITE. ONLY FIGURED DIMENSIONS ARE TO BE WORKED FROM. DISCREPANCIES MUST BE REPORTED TO THE ARCHITECT OR ENGINEER BEFORE PROCEEDING. © THIS DRAWING IS COPYRIGHT.
2. REPRODUCED FROM OS SITEMAP ® BY PERMISSION OF ORDNANCE SURVEY® ON BEHALF OF THE CONTROLLER OF HER MAJESTY'S STATIONERY OFFICE. © CROWN COPYRIGHT 2008. ALL RIGHTS RESERVED. LICENCE NUMBER 100007126.
3. UNTIL TECHNICAL APPROVAL HAS BEEN OBTAINED FROM THE RELEVANT AUTHORITIES, ALL DRAWINGS ARE ISSUED AS PRELIMINARY AND NOT FOR CONSTRUCTION. SHOULD THE CONTRACTOR COMMENCE SITE WORK PRIOR TO APPROVAL BEING GIVEN IT IS ENTIRELY AT HIS OWN RISK.
4. ALL SIGNS AND ROAD MARKINGS TO BE IN ACCORDANCE WITH "THE TRAFFIC SIGNS REGULATIONS AND GENERAL DIRECTIONS 2002 AND 2015. STANDARD SIZES ARE TO BE USED UNLESS STATED OTHERWISE.
5. LINE MARKING:- THERMOPLASTIC ROAD MARKING TO BE CARRIED OUT IN ACCORDANCE WITH D.O.T. GUIDELINES BY ROAD MARKING CONTRACTOR.
6. ALL EXISTING REDUNDANT ROAD MARKINGS TO BE REMOVED. WHERE NEW MARKINGS ARE SHOWN, THESE ARE TO TIE INTO EXISTING AS APPROPRIATE.
7. TRAFFIC SIGNS OR LAMP COLUMNS TO BE LOCATED SUCH THAT THERE IS A MINIMUM HORIZONTAL CLEARANCE TO THE SIGN OR LAMP COLUMN OF 450mm FROM THE EDGE OF THE KERB FACE.
8. UNLESS OTHERWISE INDICATED, LOCATION OF THE SIGNS TO BE GAUGED FROM THE POSITION RELATIVE TO THE EXISTING FEATURES SHOWN ON THE DRAWINGS. HOWEVER, ATTENTION IS DRAWN TO THE GUIDANCE NOTES IN THE "TRAFFIC SIGNS MANUAL".

POSITION OF STREET LIGHTING TBC

REVISION	DESCRIPTION	DRAWN	CHECKED	DATE
B A	UPDATED TO SUIT ROAD ALIGNMENT REVISIONS WHITE LINING AROUND ZEBRA CROSSING AND BUS STOP POSITIONS UPDATED	CG AT	AT JF	25.05.17 24.04.17
PRELIMINARY	INFORMATION	TENDER	CONSTRUCTION	AS BUILT

WOODS HARDWICK
ARCHITECTS, ENGINEERS AND DEVELOPMENT CONSULTANTS

15-17 GOLDINGTON ROAD
BEDFORD, MK40 3NH
T. +44 (0)1234 268862
FORT DUNLOP, FORT PARKWAY
BIRMINGHAM, B24 9FE
UNITED KINGDOM
T. +44 (0)121 6297700
MAIL@WOODSHARDWICK.COM
WWW.WOODSHARDWICK.COM

TITLE **CAMP ROAD
UPPER HEYFORD**

DETAILS **VILLAGE CENTRE - S278
WHITE LINING AND SIGNAGE**

SCALE: 1:500 @ A2 DATE: FEB 2017 DRAWN: CG CHK: AT

Please consider the environment before printing this drawing
Filepath: F:\Engineer

HEYF-5-239 B

0 5 10 15 25 50m

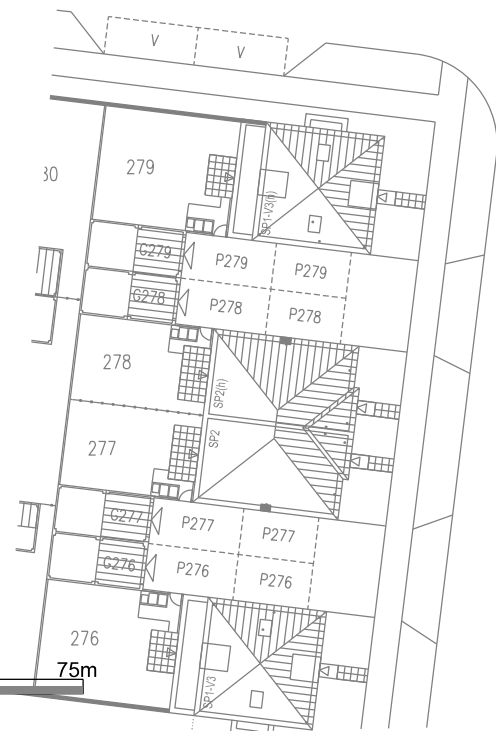
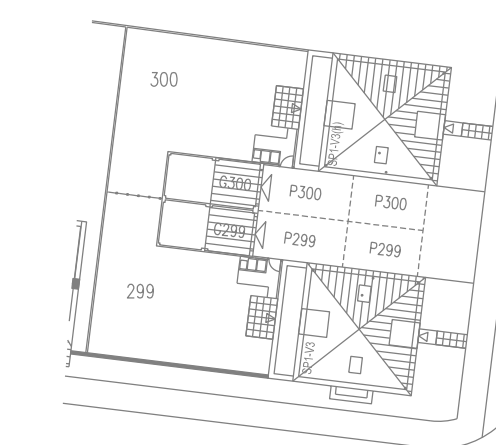

EXISTING
S278
CAMP ROAD

S278
VILLAGE CENTRE

CAMP ROAD

S278
VILLAGE CENTRE

TRIDENT ROAD
APPLICATION

TRIDENT ROAD
APPLICATION

RAMP MARKINGS
TO DIAG. 1062

RAMP MARKINGS
TO DIAG. 1062

DIAG. 1004

DIAG. 1004

DIAG. 1025.1

ZIG ZAG LINES AS
PER TABLE 69
POINT 50

YELLOW GLOBE AS
PER TABLE 69
POINT 30

ZIG ZAG LINES AS
PER TABLE 69
POINT 50

DIAG. 1003

DIAG. 1004

DIAG. 1025.1

RAMP MARKINGS
TO DIAG. 1062

DIAG. 1009

DIAG. 1003

DIAG. 1004

RAMP MARKINGS
TO DIAG. 1062

DIAG. 1004

RAMP MARKINGS
TO DIAG. 1062

DIAG. 1028.3

DIAG. 1003

ZEBRA
CROSSING
BLACK AND
WHITE STRIPES

YELLOW GLOBE AS
PER TABLE 69
POINT 30