

SAFETY HEALTH AND ENVIRONMENTAL

THERE ARE NO EXCEPTIONAL RISKS ASSOCIATED WITH THESE WORKS. REFER TO THE DESIGNERS RISK ASSESSMENT FOR THE FULL ASSESSMENT OF RISKS.

KEY

- PROPOSED ADOPTABLE FOUL SEWER
- PROPOSED ADOPTABLE SURFACE WATER SEWER
- PROPOSED HIGHWAY GULLY
- PROPOSED KERB DRAIN
- ADOPTABLE FOUL SEWER CONSTRUCTED UNDER THE "EASTERN DIVERSION" OR "PHASE 5" WORKS
- ADOPTABLE SURFACE WATER SEWER CONSTRUCTED UNDER THE "EASTERN DIVERSION" OR "PHASE 5" WORKS
- EXISTING GULLY OUTSIDE OF APPLICATION AREA
- EXISTING GULLY TO BE REMOVED
- EXISTING DITCH TO BE FILLED IN

NOTES

- CONTRACTORS MUST CHECK ALL DIMENSIONS ON SITE. ONLY FIGURED DIMENSIONS ARE TO BE WORKED FROM. DISCREPANCIES MUST BE REPORTED TO THE ARCHITECT OR ENGINEER BEFORE PROCEEDING. © THIS DRAWING IS COPYRIGHT.
 - REPRODUCED FROM OS SITEMAP © BY PERMISSION OF ORDNANCE SURVEY® ON BEHALF OF THE CONTROLLER OF HER MAJESTY'S STATIONERY OFFICE. © CROWN COPYRIGHT 2008. ALL RIGHTS RESERVED. LICENCE NUMBER 100007126.
 - UNTIL TECHNICAL APPROVAL HAS BEEN OBTAINED FROM THE RELEVANT AUTHORITIES, ALL DRAWINGS ARE ISSUED AS PRELIMINARY AND NOT FOR CONSTRUCTION. SHOULD THE CONTRACTOR COMMENCE SITE WORK PRIOR TO APPROVAL BEING GIVEN IT IS ENTIRELY AT HIS OWN RISK.
- BUILDING DRAINAGE**
- ALL CONNECTIONS TO ADOPTABLE MANHOLES FROM GULIES AND PRIVATE BUILDING DRAINAGE TO BE 150mm DIAMETER PIPES UNLESS OTHERWISE SPECIFIED.
 - ALL HOUSE DRAINAGE TO BE 100mm DIA UNLESS OTHERWISE STATED, AND LAID IN ACCORDANCE WITH CURRENT BUILDING REGULATIONS AND BS8301 : 1985.
 - ALL PRIVATE DRAINAGE PRODUCTS ARE TO BE POLYPIPE OR SIMILAR APPROVED.
 - PIPE BEDDING MATERIAL IS TO BE CLASS S WITH 150mm MINIMUM THICKNESS SURROUND.
 - BACKFILL IS TO BE WITH SELECTED FILL FREE OF STONES LARGER THAN 40mm, LUMPS OF CLAY OVER 100mm, TIMBER, FROZEN MATERIAL AND VEGETABLE MATTER.
 - PIPE PROTECTION OF SHALLOW DRAINAGE RUNS TO BE IN ACCORDANCE WITH THE TYPICAL DRAINAGE DETAILS DRAWING. THE CONTRACTOR SHALL SATISFY THEMSELVES AND AGREE WITH THE SITE MANAGEMENT THE ACTUAL EXTENT OF PIPE PROTECTION REQUIRED.
 - PIPES ENTERING AND LEAVING MANHOLES/INSPECTION CHAMBERS SHALL INCLUDE A ROCKER PIPE, 600mm IN LENGTH.
 - BRICKWORK TO CHAMBERS SHALL BE CLASS B ENGINEERING TO BS5921.
 - RAINWATER PIPES ARE TO BE SITED ON SIDE ELEVATIONS WHENEVER POSSIBLE.
 - ALL FLIGHTS OF STEPS TO PRIMARY LEVEL ACCESS, WITH MORE THAN 2 STEPS ARE TO BE PROVIDED WITH HANDRAILING, EXCEPT WHERE THE STEPS ARE 900mm ARE MORE APPART.
 - ROAD GULLIES AND ROAD DESIGN SUBJECT TO HIGHWAY AUTHORITY APPROVAL.
 - PRIMARY DRIANAGE SUBJECT TO WATER COMPANY APPROVAL.

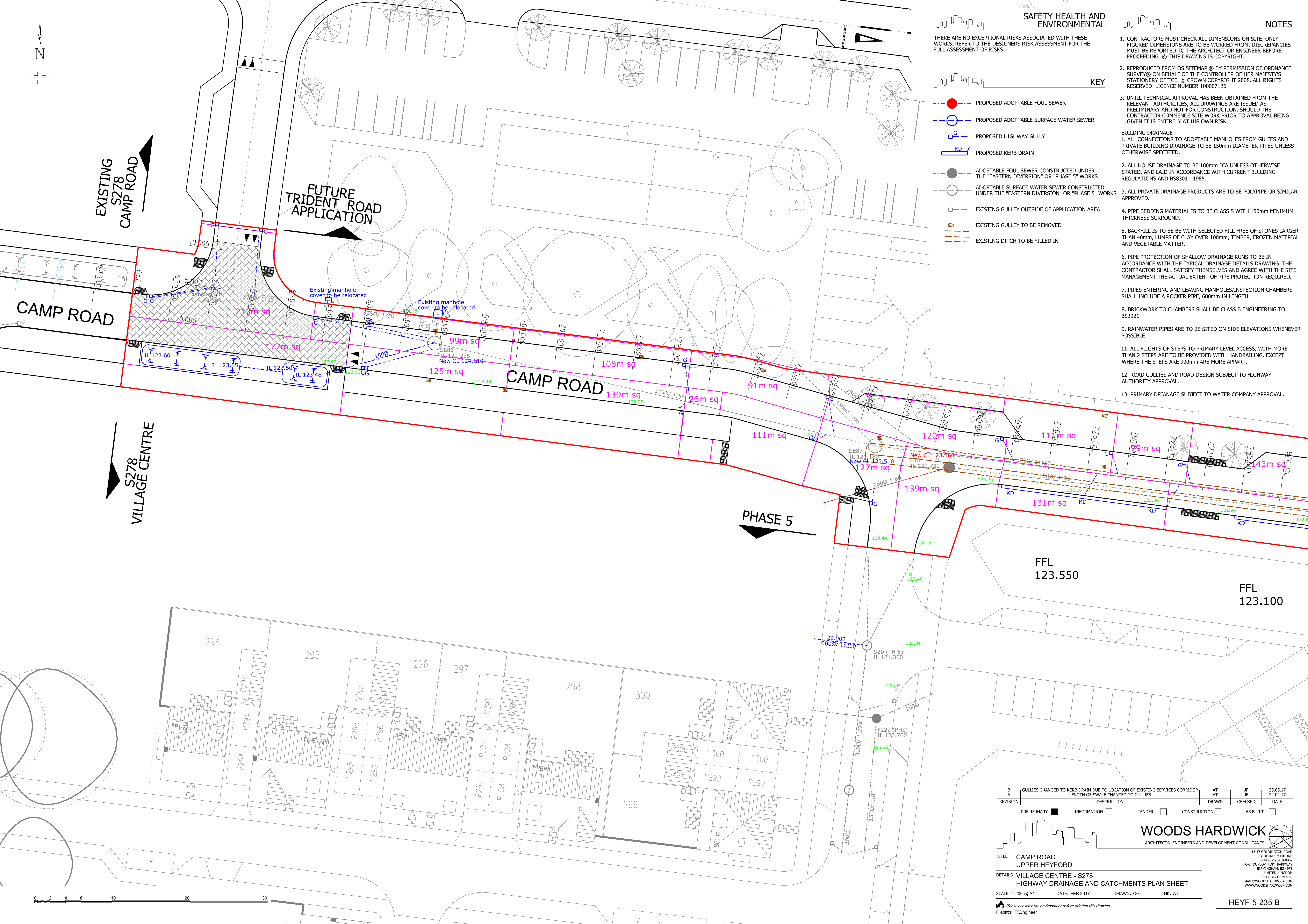

REVISION	DESCRIPTION	AT	JF	DATE
B	GULLIES CHANGED TO KERB DRAIN DUE TO LOCATION OF EXISTING SERVICES CORRIDOR	AT	JF	25.05.17
A	LENGTH OF SWALE CHANGED TO GULLIES	AT	JF	24.04.17
1	PRELIMINARY	AT	JF	25.05.17
2	INFORMATION	AT	JF	24.04.17
3	TENDER	AT	JF	25.05.17
4	CONSTRUCTION	AT	JF	24.04.17
5	AS BUILT	AT	JF	25.05.17

WOODS HARDWICK
ARCHITECTS, ENGINEERS AND DEVELOPMENT CONSULTANTS

15-17 GOLDINGTON ROAD
BEDFORD, MK40 3NH
T: +44 (0)1234 268862
F: +44 (0)1234 268862
FORD DUNLOP, FORT PARKWAY
BIRMINGHAM, B24 9FE
UNITED KINGDOM
T: +44 (0)121 6297700
MAIL@WOODSHARDWICK.COM
WWW.WOODSHARDWICK.COM