

## SAFETY HEALTH AND ENVIRONMENTAL

THERE ARE NO EXCEPTIONAL RISKS ASSOCIATED WITH THESE WORKS. REFER TO THE DESIGNERS RISK ASSESSMENT FOR THE FULL ASSESSMENT OF RISKS.

## NOTES

1. CONTRACTORS MUST CHECK ALL DIMENSIONS ON SITE. ONLY FIGURED DIMENSIONS ARE TO BE WORKED FROM. DISCREPANCIES MUST BE REPORTED TO THE ARCHITECT OR ENGINEER BEFORE PROCEEDING. © THIS DRAWING IS COPYRIGHT.
2. REPRODUCED FROM OS SITEMAP ® BY PERMISSION OF ORDNANCE SURVEY® ON BEHALF OF THE CONTROLLER OF HER MAJESTY'S STATIONERY OFFICE. © CROWN COPYRIGHT 2008. ALL RIGHTS RESERVED. LICENCE NUMBER 100007126.
3. UNTIL TECHNICAL APPROVAL HAS BEEN OBTAINED FROM THE RELEVANT AUTHORITIES, ALL DRAWINGS ARE ISSUED AS PRELIMINARY AND NOT FOR CONSTRUCTION. SHOULD THE CONTRACTOR COMMENCE SITE WORK PRIOR TO APPROVAL BEING GIVEN IT IS ENTIRELY AT HIS OWN RISK.

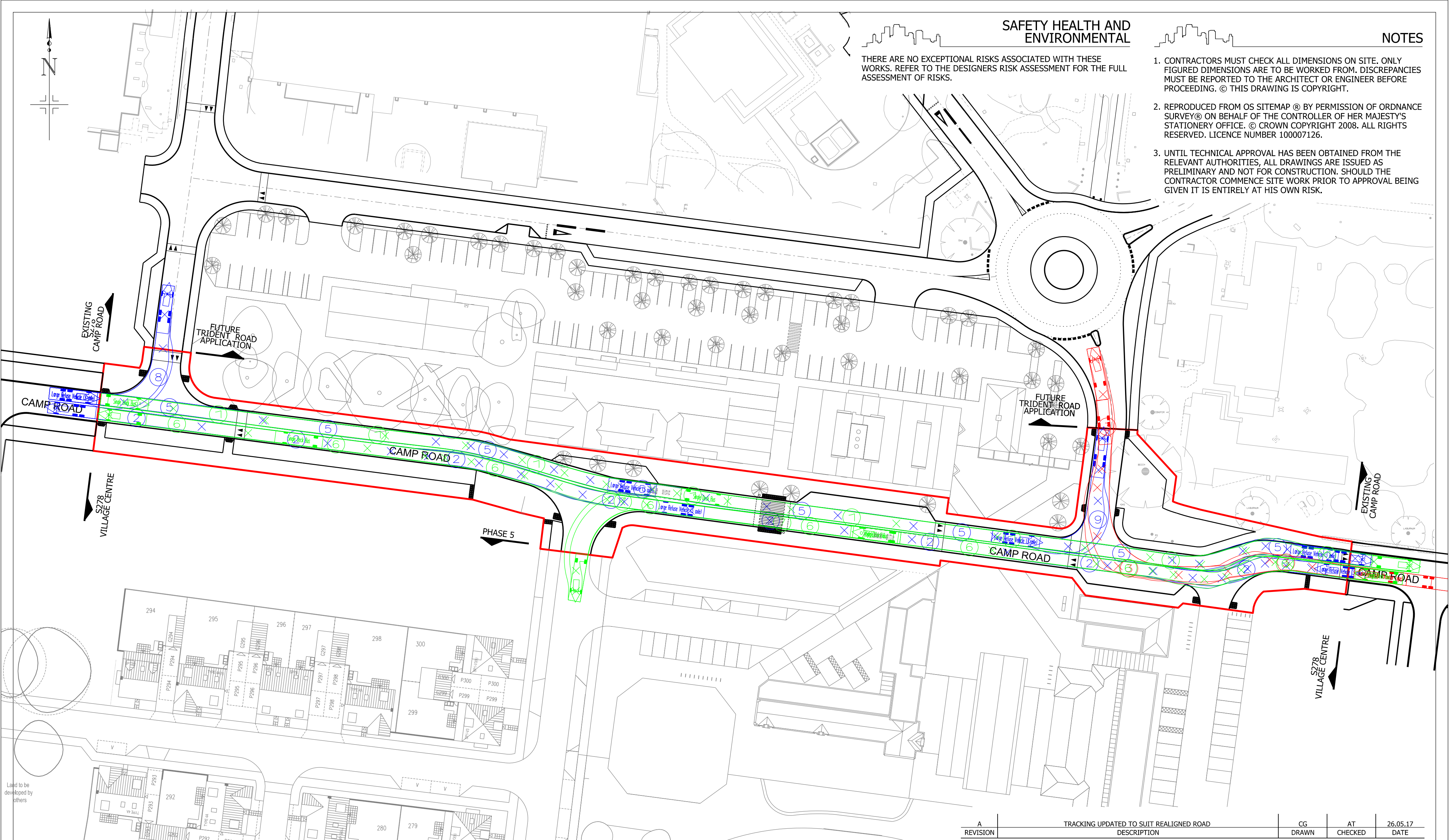

Land to be developed by others

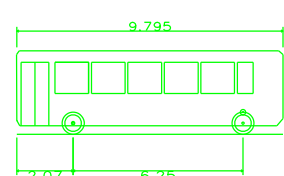

Single Deck Bus  
Overall Length 9.795m  
Overall Width 2.500m  
Overall Body Height 3.070m  
Min Body Ground Clearance 2.366m  
Track Width 2.322m  
Lock to Lock Time 6.000s  
Kerb to Kerb Turning Radius 10.111m

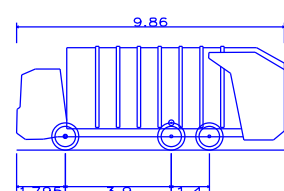

Large Refuse Vehicle (3 axle)  
Overall Length 9.860m  
Overall Width 2.450m  
Overall Body Height 3.814m  
Min Body Ground Clearance 2.366m  
Track Width 2.450m  
Lock to Lock Time 4.000s  
Kerb to Kerb Turning Radius 9.500m

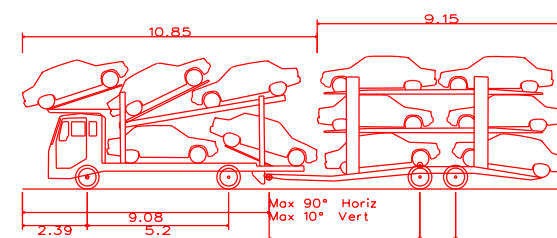

Car Transporter (Drawbar Type)  
Overall Length 20.000m  
Overall Width 2.500m  
Overall Body Height 4.884m  
Min Body Ground Clearance 2.366m  
Max Track Width 2.500m  
Lock to Lock Time 6.000s  
Wall to Wall Turning Radius 10.500m

A	TRACKING UPDATED TO SUIT REALIGNED ROAD	CG	AT	26.05.17
REVISION	DESCRIPTION	DRAWN	CHECKED	DATE
PRELIMINARY	INFORMATION	TENDER	CONSTRUCTION	AS BUILT

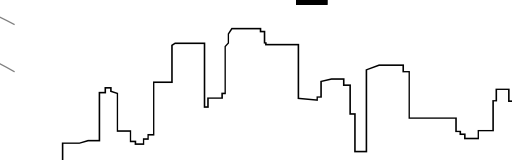

**WOODS HARDWICK**

ARCHITECTS, ENGINEERS AND DEVELOPMENT CONSULTANTS

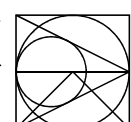

TITLE **CAMP ROAD  
UPPER HEYFORD**

DETAILS **VILLAGE CENTRE - S278  
TRACKING**

SCALE: 1:500 @ A2 DATE: FEB 2017 DRAWN: CG CHK: AT

Please consider the environment before printing this drawing  
Filepath: F:\Engineer

15-17 GOLDINGTON ROAD  
BEDFORD, MK40 3NH  
T. +44 (0)1234 268862  
FORT DUNLOP, FORT PARKWAY  
BIRMINGHAM, B24 9FE  
UNITED KINGDOM  
T. +44 (0)121 6297700  
MAIL@WOODSHARDWICK.COM  
WWW.WOODSHARDWICK.COM

HEYF-5-237 A