

On-slope measurements

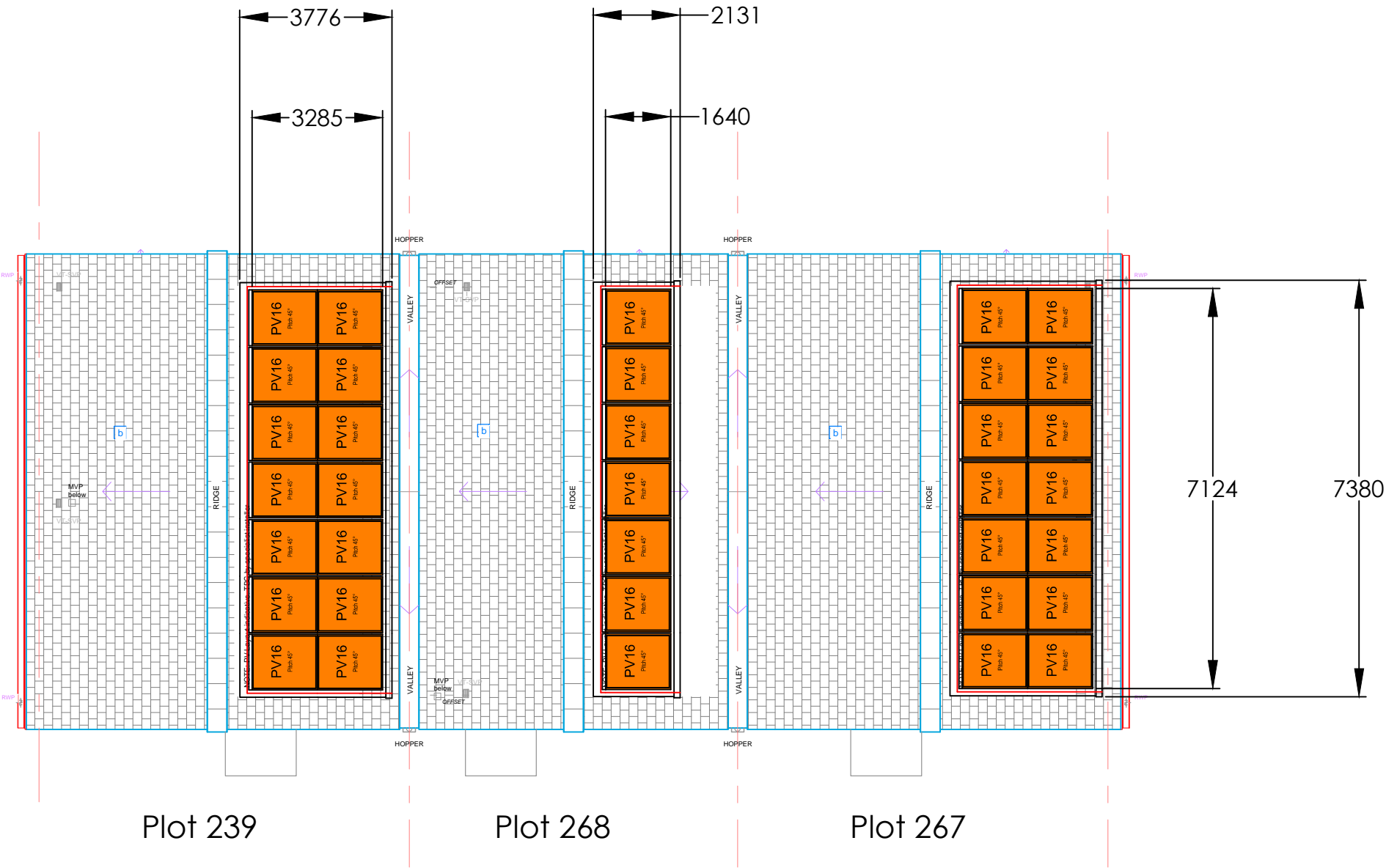

Note:

Viridian Solar has produced this design based on information and drawings supplied by the client. It remains the client's responsibility to ensure that shading from nearby buildings and trees does not affect the system.

Weight of solar panels:

PV16	21kg
V20/PV20	43kg/41kg
V30/PV30	64kg/57kg

Where the panels are fitted into a pitched tiled/slate roof, they are fixed directly to the roof battens with a uniformly distributed load of 21kg per m² (20 and 30 series) or 13kg per m² for PV16. Therefore, they probably weigh less than the roof covering they are replacing. Roof structure modifications are unlikely to be necessary.

Revisions:

Notes:



Viridian Solar
Atlas Building,
68 Stirling Way, Papworth,
Cams. CB23 3GY
T 01480 831501
F 01480 831831
www.viridiansolar.co.uk

TITLE

Viridian Fusion solar arrangement
for Bicester Village -
Plots 239, 267 & 268

DRAWN	DG	CHECKED	N/A
DRAWING NUMBER	8721 / SK6	Sheet Number	
DATE	14.11.16	SCALE	1:100 @ A3