

OXFORDSHIRE COUNTY COUNCIL STREET LIGHTING SPECIFICATION - A4286a

Column
←-08 No.
5m tubular steel column (BS EN 40) BD94/07 (Style 2 drg HSD/13/010) suitable for post top mounted lantern. Rationalised wind loading factor (RWF) for Oxfordshire as specified in PD6547:2009 for design of lighting columns.

Bracket
Post top mounted at 0° upflit.

Lantern
LED Roadway lighting NXT series small - Green RAL 6013

Lantern ref
NXT-12S-0-6-2ES-3-RAL6013-3-CE-X-2H

Lamp
12 Watt LED 350mA 4000K Colour temperature

Switch
One piece photocell Nema 7 pin type (Zodion Super 6) set at 35/18 Lux Pre-set to dim to 50% between 10:00pm to 6:00am.

Column
←-02 No.
5m tubular steel column (BS EN 40) BD94/07 (Style 2 drg HSD/13/010) suitable for post top mounted lantern. Rationalised wind loading factor (RWF) for Oxfordshire as specified in PD6547:2009 for design of lighting columns.

Bracket
Post top mounted at 0° upflit.

Lantern
LED Roadway lighting NXT series small - Green RAL 6013

Lantern ref
NXT-12S-0-6-2ES-3-RAL6013-3-CE-X-2H

Lamp
12 Watt LED 450mA 4000K Colour temperature

Switch
One piece photocell Nema 7 pin type (Zodion Super 6) set at 35/18 Lux Pre-set to dim to 50% between 10:00pm to 6:00am.

Column
←-03 No.
5m tubular steel column (BS EN 40) BD94/07 (Style 2 drg HSD/13/010) suitable for post top mounted lantern. Rationalised wind loading factor (RWF) for Oxfordshire as specified in PD6547:2009 for design of lighting columns.

Bracket
Post top mounted at 0° upflit.

Lantern
LED Roadway lighting NXT series small - Black RAL 9011

Lantern ref
NXT-12S-0-6-4AH-3-RAL9011-3-CE-X-2H

Lamp
12 Watt LED 350mA 4000K Colour temperature

Switch
One piece photocell Nema 7 pin type (Zodion Super 6) set at 35/18 Lux Pre-set to dim to 50% between 10:00pm to 6:00am.

Column
←-04 No.
5m tubular steel column (BS EN 40) BD94/07 (Style 2 drg HSD/13/010) suitable for post top mounted lantern. Rationalised wind loading factor (RWF) for Oxfordshire as specified in PD6547:2009 for design of lighting columns.

Bracket
Post top mounted at 0° upflit.

Lantern
LED Roadway lighting NXT series small - Black RAL 9011

Lantern ref
NXT-12S-0-6-2ES-3-RAL9011-3-CE-X-2H

Lamp
12 Watt LED 350mA 4000K Colour temperature

Switch
One piece photocell Nema 7 pin type (Zodion Super 6) set at 35/18 Lux Pre-set to dim to 50% between 10:00pm to 6:00am.

Column Finish
EPA Compliant Epoxy/Polysiloxane Amended Oxfordshire County Council Specification
i.e. Requirements for Lighting Columns, Bracket Arms & Doors [See Oxfordshire amended Appendix 19/3]. Upper Additional overall coats to be applied in shop to a clean, degreased, dry surface.

1st Coat:
Internal roof to 250mm above ground level & external overall Item 121, Dacrylate 2-Pack Extended Cure Epoxy MIO, Ref: 90-270, Airless Spray, Minimum Dry Film Thickness 100 microns.

2nd Coat:
External roof to 250mm above ground level Dacrylate Epidac 2 Glass Reinforced 2-Pack Epoxy, ref 79-489, Brush/Airless Spray, Minimum Dry Film Thickness 200 microns.

3rd Coat:
External overall Dacrylate dactil 200 2-Pack Polysiloxane Finish RAL 6013 (or other specified colour), 200-line, Conventional Spray, Minimum Dry Film Thickness 75 microns.

- Additional Notes:**
- Columns to be sited at the rear of footpath and within adaptable area.
 - Positions are approximate. The Local Authority Engineer reserves the right to alter positions depending on site conditions.
 - All equipment shall comply with the Oxfordshire County Council General Technical Specification.
 - The Contractor shall obtain samples of the paint and technical Data Sheets from the Manufacturers prior to commencement of work.
 - In order to assist the developer, OCC will mark out all of the column positions.
 - All Street Lighting works must be carried out by a Highway Electrical Association Registered Contractor.
 - All columns to be numbered two metres from ground level.
 - Electrical Supply to Street Lighting Columns and Illuminated Signs are to be serviced/owned by the local Distributions Network Operator (i.e. Regional Electricity Company).
 - The 'A' file reference number which is on the drawing, is to be quoted in all correspondence.
 - No trees are to be planted within five metres of a column.
 - Columns in vulnerable position to have a column barrier protection system see HSD/12/304.

NB: Touch up on site using 2 Pack paints applied by brush will never offer the same appearance as that of a spray applied finish. For this reason every effort should be made to minimize handling/transportation.

Street Lighting to be adopted by OXFORDSHIRE COUNTY COUNCIL

Note: Where Columns are situated in shared areas or in a position to have a vehicle strike then a column barrier protection system will be required. See drawing HSD/12/304. Please see drawing showing initial proposed columns, final quantities to be agreed on site by OCC Engineer

Note: Columns and lanterns in private areas to be black RAL 9011

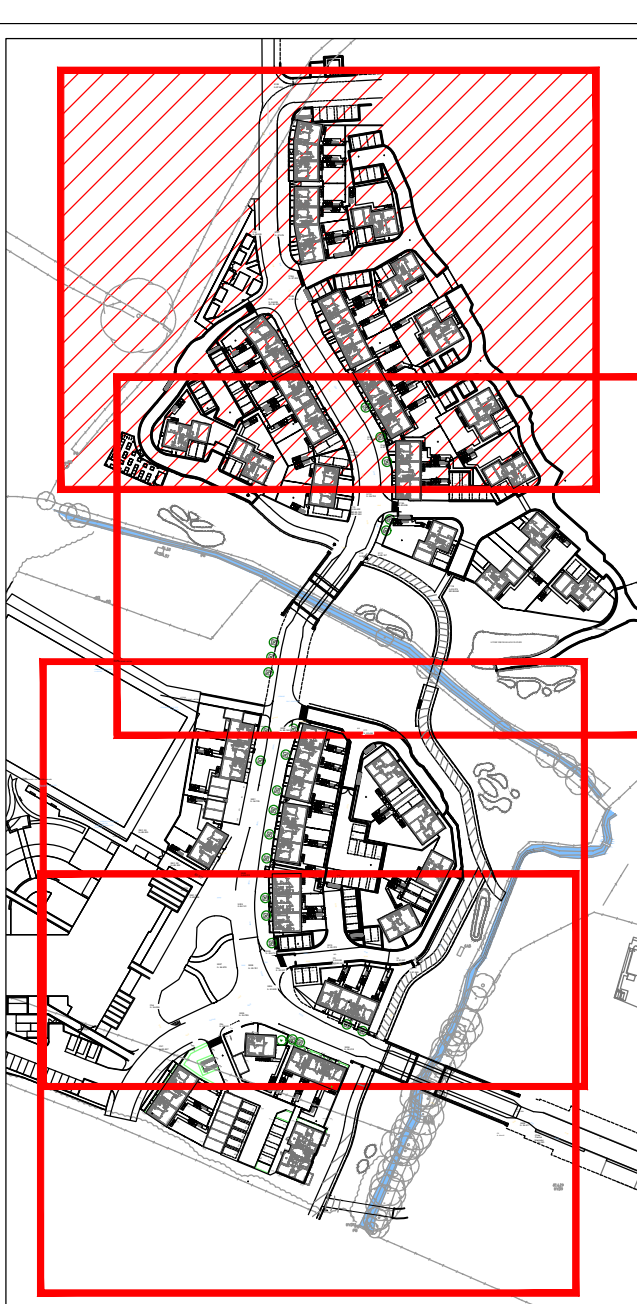
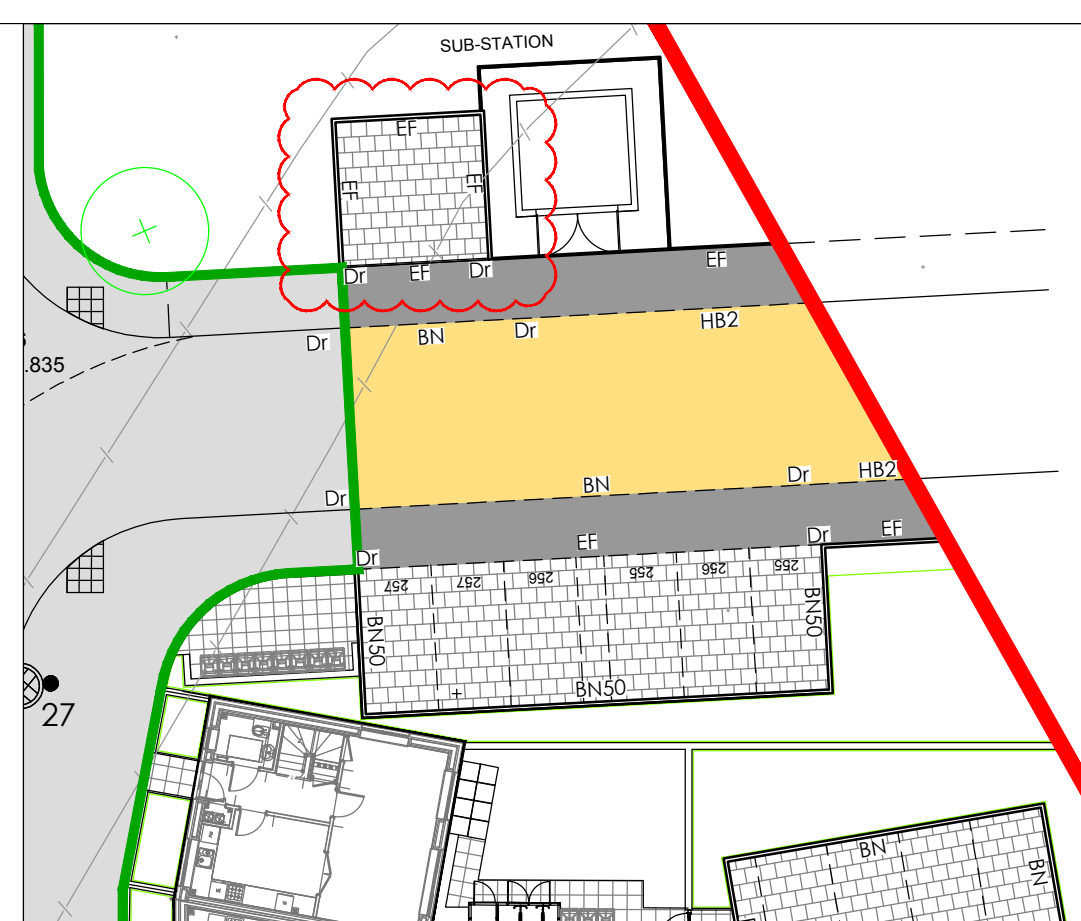

Sheet Arrangement (1:2500)

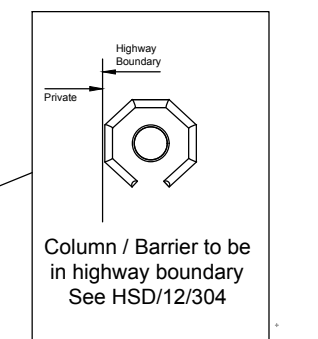

Column / Barrier to be in highway boundary See HSD/12/304

2 Columns to have a column barrier protection system final quantities to be agreed on site by OCC Engineer

SURVEY INFORMATION
MK Surveys - 01908 565561
DRG NUMBER: 17523 - Sheets 1-12 DATE RECEIVED: 17/12/2014

ARCHITECT SITE PLAN INFORMATION
PRP Architects - 020 7453 3464
DRG NUMBER: AL6157C-3000/3100 DATE RECEIVED: 06/12/2016

NOTES

- All dimensions and levels are in metres unless otherwise noted
- This drawing is to be read in conjunction with the relevant Architect's/Engineer's drawings, specifications and CDM documentation
- This drawings has been produced electronically and may have been photo reduced or enlarged when copied. Work to figured dimensions only (DO NOT SCALE). All dimensions to be checked on site. Any errors or omissions to be reported to the engineer immediately.
- This drawing contains coloured lines / information that may not be clear if reproduced in black and white.

DESIGNERS CDM NOTE - RESIDUAL RISKS NOT IDENTIFIED

The design Engineer(s) have assessed this design as the scheme has been developed in order to identify if there are any residual risk hazards (i.e. unusual, unexpected, abnormal or difficult).

No residual risks have been identified for this scheme and therefore no entries were added to the risk register.

This statement assumes that a competent Contractor with the appropriate qualified staff will be employed for the works, and that they will be familiar with site wide construction risks and hazards that they can reasonably be expected to encounter as part of their work.

Kerb Legend

Kerb Ref	Type	Dimensions	Notes
BN50	BN	125x255	50mm upstand eg shared access kerb edge
BN	BN	125x255	15mm upstand eg vehicle crossover dropped kerb
BN6	BN	125x255	0-6m upstand eg dropped kerbing to dwelling primary access crossover
BN0	BN	125x255	Flush kerb laid with slight fall to channel; kerb laid outside down where permitted as CS2 alternative
CS0	CS2	150x150	Flush kerb laid with slight fall to channel eg Pedestrian crossing
EF	EF	50x150	Square edged path edging laid flush unless otherwise stated
Dr	-	125x255/150	Dropper kerb either left or right drop as required

	Marshalls Myriad Piora 200 x 100 x 80mm
	Marshalls Myriad Piora 200 x 200 x 80mm
	Marshalls Renaissance 450 x 450 x 50mm to private footpaths, Marshalls Penden River 600 x 600 x 38mm to private rear gardens.
	Self Binding Gravel. To Communal Allotments
	Section 38 footway
	Section 38 carriageway
	Grasscrete access
	Phase 1 Section 38 works - Refer to Hyder drawings
	River corridor - Refer to Hyder/PRP Architects drawings for details
	Section 38 Permeable Block paving carriageway

Refer to PRP Architects drawings for all surface finishes colour specifications

Rev	Drawn by	Chk'd by	Comments	Date
C07	NJ	TST	Column 3 relocated, light spill protection added and kerbing to SS amended	24/01/17
C06	NJ	TST	Hatch order amended	09/01/17
C05	NJ	TST	Kerb types amended. Refer to clouded areas	02/12/16
C04	SNN	TST	BN25 Kerb ref. amended to BN with 15mm upstand	04/11/16
C03	SNN	TST	Surface Finishes amended as Client Comments	20/09/16
C02	SNN	TST	BN Kerb ref. amended to 25mm upstand	11/08/16
C01	ATD	TST	Issued for construction.	14/07/16

DRAWING TITLE
Surface Finishes & Kerb Type Plan
Sheet 1/4

PROJECT
Phase 2
Bicester Eco Village
Bicester
Oxon

DESIGNED BY TST	DRAFTED BY NJ	APPROVED BY DJ
DATE 05/02/2016	STATUS CONSTRUCTION	
SCALE 1:250 @ A1	Scale bar @ 1:250 0m 4.25m 12.5m	

CLIENT 	
JOB NUMBER 15-1859	DRAWING NUMBER 04-1
REVISION C07	