

CHAINAGE	0.000	5.000	10.000	15.000	20.000	25.000	30.000	35.000	40.000	45.000	50.000	55.000	60.000	63.469	65.000	70.000	75.000	80.000	82.214	83.182	85.000	86.066	
TRIAL LEVEL														84.251	84.349								
PROPOSED LEVEL	83.601	84.575	85.607	86.649	87.306	87.096	87.050	87.050	87.407	87.267	87.248	87.224			86.700	86.469	86.700	86.700	86.700	87.235	87.179		
BASE LEVEL	83.601	83.754	83.939	84.133	84.361	84.725	85.121	85.526	85.937	86.330	86.598	86.679	86.841	86.954	87.052	87.140	87.140	87.197	87.244	87.244	87.244	87.244	87.244

Section F-F

Scale: 1:200 Horizontal  
1:100 Vertical

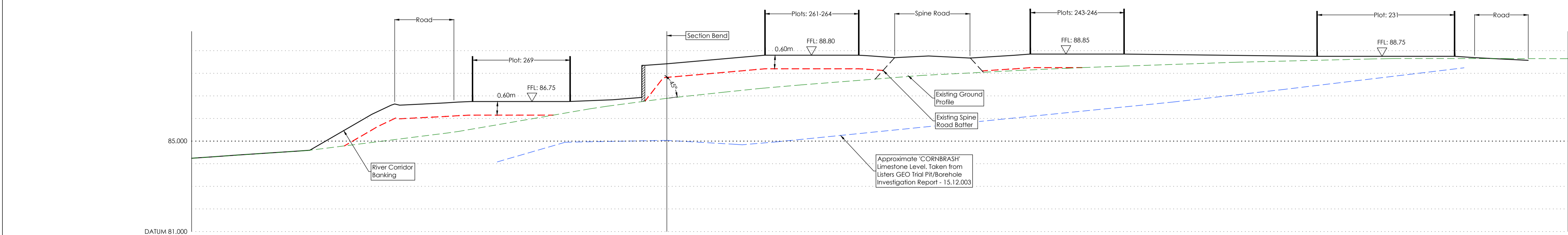

CHAINAGE	0.000	5.000	10.000	15.000	20.000	25.000	27.089	30.000	35.000	40.000	45.000	50.000	60.000	65.000	70.000	80.000	85.000	90.000	95.000	100.000	105.000	110.000	112.794	115.000	118.267	120.000	122.006
TRIAL LEVEL							84.080	84.500																			
PROPOSED LEVEL	84.242	84.414	84.580	85.903	86.677	86.750	86.750	86.750	86.792	88.350	88.546	88.800	88.775	88.757	88.705	88.850	88.836	88.807	88.778	88.750	88.750	88.750	88.242	88.659	88.578	88.448	88.447
BASE LEVEL	84.243	84.409	84.575	84.879	85.192	85.543	85.972	86.402	86.752	87.047	87.308	87.524	87.720	87.912	88.040	88.144	88.270	88.357	88.443	88.517	88.578	88.637	88.653	88.650	88.648	88.647	88.647

Section G-G

Scale: 1:200 Horizontal  
1:100 Vertical

SURVEY INFORMATION  
MK Surveys - 01908 565561  
DRG NUMBER: 17523 - Sheets 1-12  
DATE RECEIVED: 17/12/2014

ARCHITECT SITE PLAN INFORMATION  
PRP Architects - 020 7653 3464  
DRG NUMBER: AA2699  
DATE RECEIVED: 22/12/2015

- NOTES
- All dimensions and levels are in metres unless otherwise noted
  - This drawing is to be read in conjunction with the relevant Architect's/Engineer's drawings, specifications and CDM documentation
  - This drawing has been produced electronically and may have been photo reduced or enlarged when copied. Work to figured dimensions only (DO NOT SCALE). All dimensions to be checked on site. Any errors or omissions to be reported to the engineer immediately.
  - This drawing contains coloured lines / information that may not be clear if reproduced in black and white.

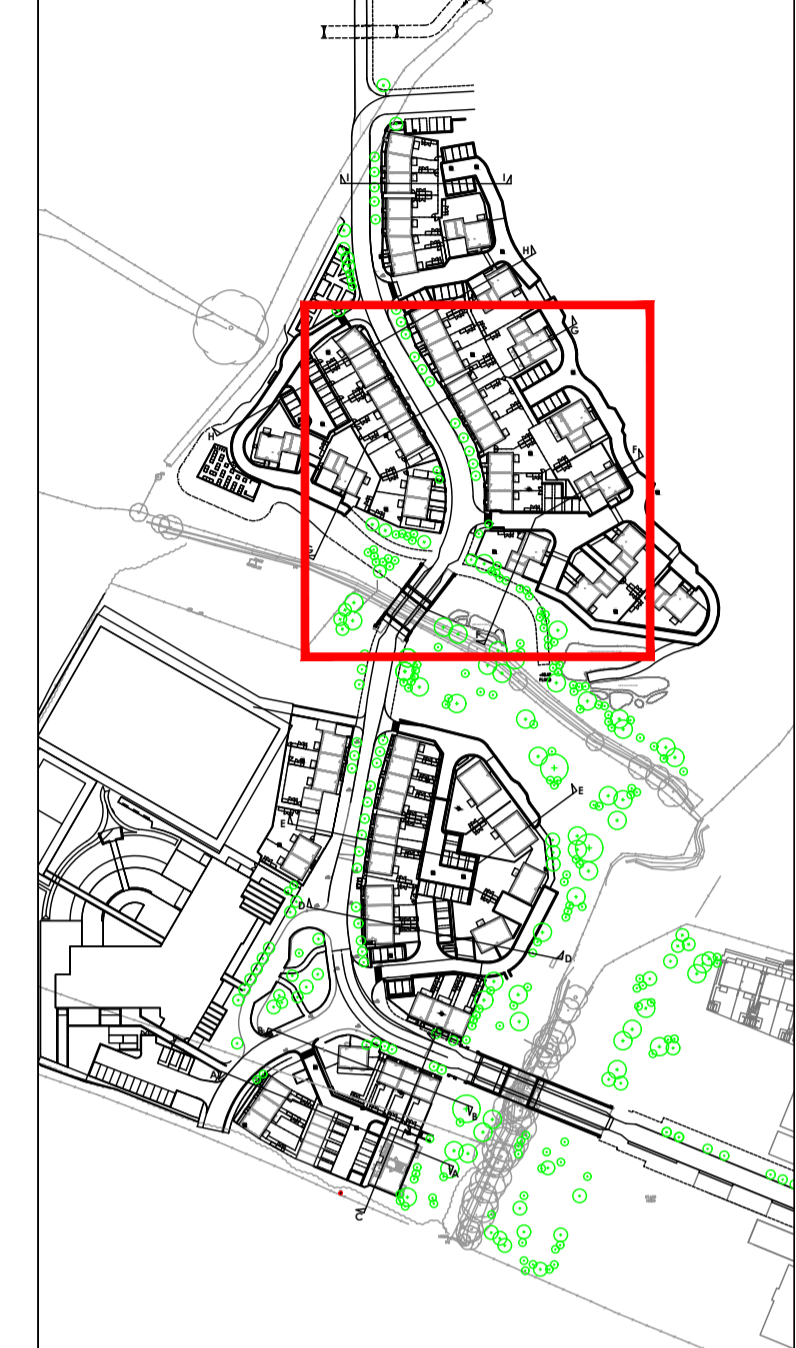

Sheet Arrangement (1:2500)

Key:

	Retaining Element
	River Corridor Retaining
	Typical Fill Level

POI	SNN	TST	Initial Issue	Date
Rev	Drawn by	Chkd by	Comments	22/02/16

DRAWING TITLE  
Site Cross Sections  
Sheet 3 of 4

PROJECT  
Phase 2  
Bicester Eco Village  
Bicester  
Oxon

DESIGNED BY TST	DRAFTED BY SNN	APPROVED BY DJ
DATE 22/02/2016	STATUS <b>INFORMATION</b>	

SCALE  
As Noted

CLIENT

JOB NUMBER 15-1859	DRAWING NUMBER 44-3	REVISION P01
-----------------------	------------------------	-----------------