

Key Plan

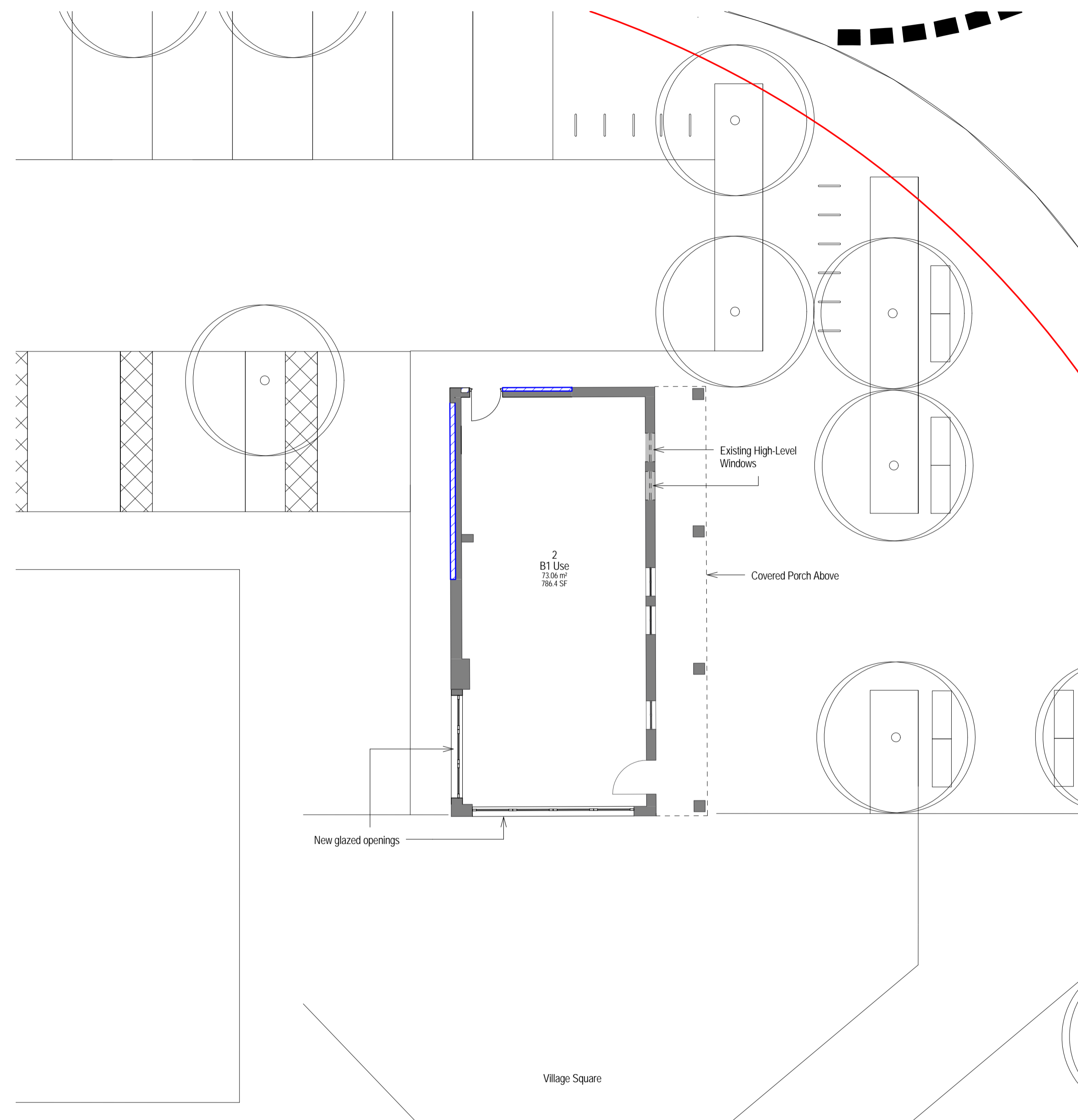

1 BUILDING 100 - PROPOSED GROUND FLOOR PLAN
1 : 100

Notes:

1. Measured Survey Information:
Please note the existing building layout indicated on this drawing is derived from the measured survey information produced by Open Architecture (London) Ltd. (Drawing Refs. 16012-002-Rev.P1, Dated 06/05/2016). The existing building position relative to the wider site context is derived from the topographical site survey information produced by Woods Hardwick Ltd. (Issued to ADP on 17/10/2016); ADP take no responsibility for the reliability/accuracy of the survey information.

2. Levels:
All levels are in metres relating to an ordnance datum derived from the topographical site survey information produced by Woods Hardwick Ltd. (Issued to ADP on 17/10/2016); ADP take no responsibility for the reliability/accuracy of the survey information.

3. Site Boundary:
Please note the site boundary position identified on this drawing remains subject to confirmation from Land Registry's verification with the land owner's title deeds; ADP take no responsibility for the reliability/accuracy of this survey information.

Key

- Existing Wall to be Retained
- New Wall Construction
- Structure Above
- Application Site Boundary

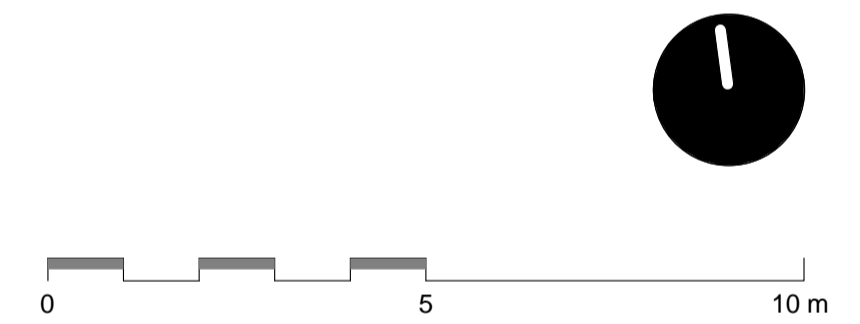

REVISION	DATE	DESCRIPTION	DRAWN	CHECKED
S2-P 1	07/04/17	Issued for information	RH	ADP
S2-P 2	13/04/17	Key plan updated	JMet	ADP
S2-P 3	20/03/18	Reserved Matter Application	JMet	ADP
S2-P 4	22/03/18	Reserved Matters Applications	JMet	ADP

CHECK ALL DIMENSIONS AND VERIFY ON SITE. REPORT ANY ERRORS OR OMISSIONS

CORDE

Charity Housing
 Park End Street Oxford OX1 1JD
 T +44 (0) 1865 248045
 E info@corde.co.uk
 www.corde.co.uk

JOB TITLE:
 HEYFORD PARK VILLAGE CENTRE
 (NORTH OF CAMP ROAD)

DRAWING TITLE:
 BUILDING 100 - PROPOSED GROUND FLOOR PLAN

SCALE: As indicated	DRAWING SHEET SIZE: A1
JOB CODE: CD2316	DRAWING NUMBER: CRD-01-00-DR-A-01025
REVISION: S2-P 4	