

© Copyright 2018 Hook Survey Partnership
 The Copyright of these Plans shall remain vested with Hook Survey Partnership who will grant an irrevocable licence for use by the Client once payment has been received in full. No Third Party may use the plans even if payment has been made to the Client but not received by the Company. Please see our terms and conditions of supply at www.hooksurvey.com for further details.

Hook Survey Legend

Hedge		Telephone line	
Undergrowth		Power line	
Tree		Banking	
Bush		Contour line	6.4
Building		Survey Station	H5
Glass Building		Gate	
Open Building		Level	115.28
Ordnance Survey Benchmark			
Foul Drainage			
Storm Drainage			

Abbreviations

Animal Sett	Sett
Air Valve	AV
Borehole	BH
Bus Stop	BS
Cover Level	CL
Earth Rod	ER
Electricity Pole	EP
Fire Hydrant	FH
Inspection Cover	IC
Invert Level	IL
Lamp Post	LP
Manhole	MH
Marker	MK
Name Plate	RNP
Power Pole	PP
Rain water Pipe	RWP
Road Sign	RS
Rodding Eye	RE
Reinforced Steel Joint	RSJ
Soil Vent Pipe	SVP
Stop Valve	SV
Survey Station	STN
Telegraph Pole	TP
Tree Stump	TS
Trial Hole	TH
Unable To Lift	UTL
Vent Pipe	VP
Water Valve	WV



Notes
 All trees are identified where possible. Species, spread, height and girth are indicative only.
 Drainage has been surveyed where found, and traced where possible.
 Eaves and ridge heights of surrounding buildings have been surveyed where possible.

Survey control

Stn	Easting	Northing	Height
H1	435877.846	237844.159	182.002
H2	435885.435	237820.631	183.915
H3	435881.804	237829.858	183.229

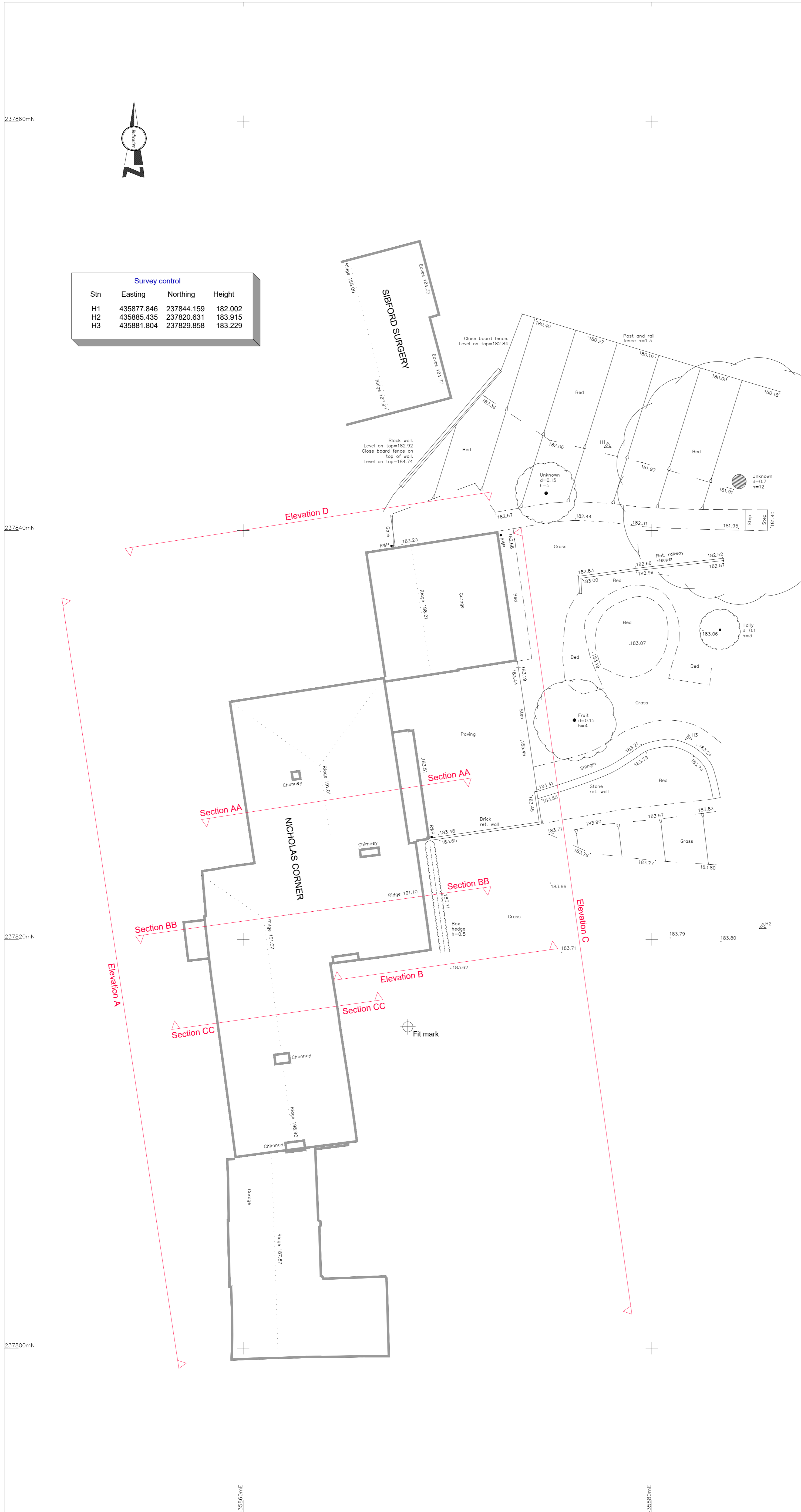
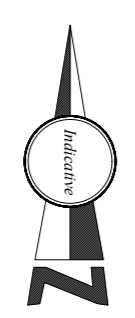

HOOK SURVEY PARTNERSHIP

Land & Building Surveyors
www.hooksurvey.com

Project:
 Nicholas Corner, Burdrop, Banbury, Oxfordshire, OX15 5RQ

Client:
 Fowler Architecture and Planning

Drawing title:
 Part Topographical Survey

Job No. : S18/6449	Dwg No. : S18/6449/01	Revision : -
Scale : 1:100	Date : April 2018	Drawn by : B.C.

Grid & Levels related to :
 Psuedo Ordnance Survey Coordinate System at a scale of 1.0000 based around Stations H1 & H2

Head Office
 Unit 1, Bybow Farm
 Orchard Way
 Dartford, Kent
 DA2 7ER
 Email > mail@hooksurvey.com
 Tel > 01322 277221

Midlands Office
 54 Stratford Road
 Shipston on Stour
 Warwickshire
 CV36 4AZ
 Email > midlands@hooksurvey.com
 Tel > 01608 430346

www.hooksurvey.com