

SITE LOCATION
(Scale 1:50000)

Ordnance Survey map extract based upon Landranger map series with the permission of the controller of Her Majesty's Stationery Office Licence No. 0100023487 Crown copyright.

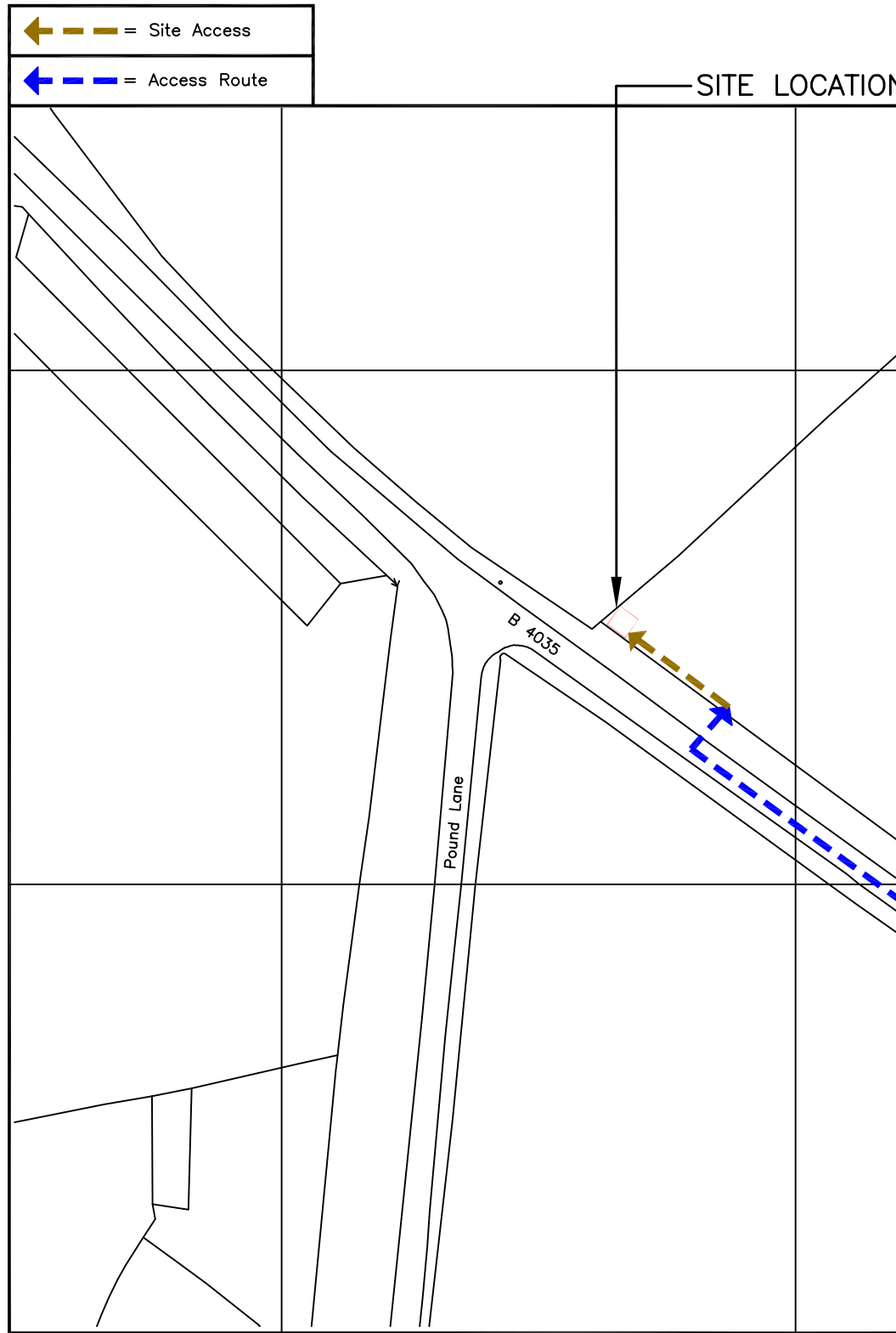

SITE PHOTOGRAPH

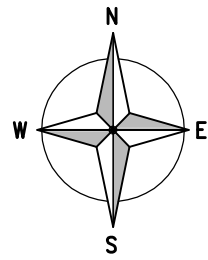

DETAILED SITE LOCATION
(Scale 1:1250)

Based upon Ordnance Survey map extract with the permission of the Controller of Her Majesty's Stationery Office. Crown copyright. Licence No. 100020449

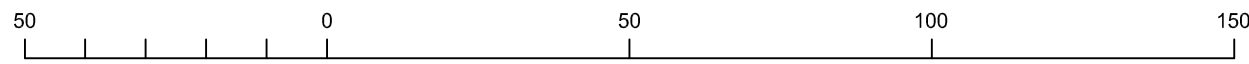

ORIGINAL SCALE AT A3 - 1:1250

ALL DIMENSIONS IN METRES

ALL DIMENSIONS ARE IN mm UNLESS NOTED OTHERWISE

N.G.R | E: 435470 N: 239064

CONCESSION REQUIRED | NO

DIRECTIONS TO SITE:
FROM BANBURY TAKE THE B4035 TOWARDS SIBFORD FERRIS. CONTINUE THROUGH BROUGHTON, LOWER TADMARTON, UPPER TADMARTON AND ONTO SWALCLIFFE. CONTINUE PAST HAWKS LANE. THE SITE IS ANOTHER 1.5KM ALONG THIS ROAD ON THE RIGHT HAND SIDE APPROXIMATELY 60m BEFORE POUND LANE. SITE IS LOCATED THROUGH FARM GATE ON THE LEFT CORNER OF FARM FIELD

NOTES:

A	Issued for Construction	SPD	DS	03.10.17
REV	MODIFICATION	BY	CH	DATE

McGEE Networks NORTHERN OFFICE, THE MEDIA CENTRE, 7 NORTHUMBERLAND STREET, HUDDERSFIELD, HD1 1RL

NOKIA

O₂
CTIL - BEACON

Cell Name		Opt.
LAND OFF B4035		-
Cell ID No		
CTIL	TEF	VF
201348	074758	N/A

Site Address / Contact Details	
SIBFORD FERRIS OXFORDSHIRE OX156LL	

Drawing Title:		SITE LOCATION MAPS	
Purpose of issue:		CONSTRUCTION	
Drawing Number:		100	
Surveyed By:		Original Sheet Size:	
VC		A3	
Pack Issue:		A	
Drawn:	Date:	Checked:	Date:
SPD	03.10.17	DS	03.10.17

The drawings comply with TEF & Vodafone Standard ICNIRP guidelines. Designed in accordance with CTIL document: SDN0008

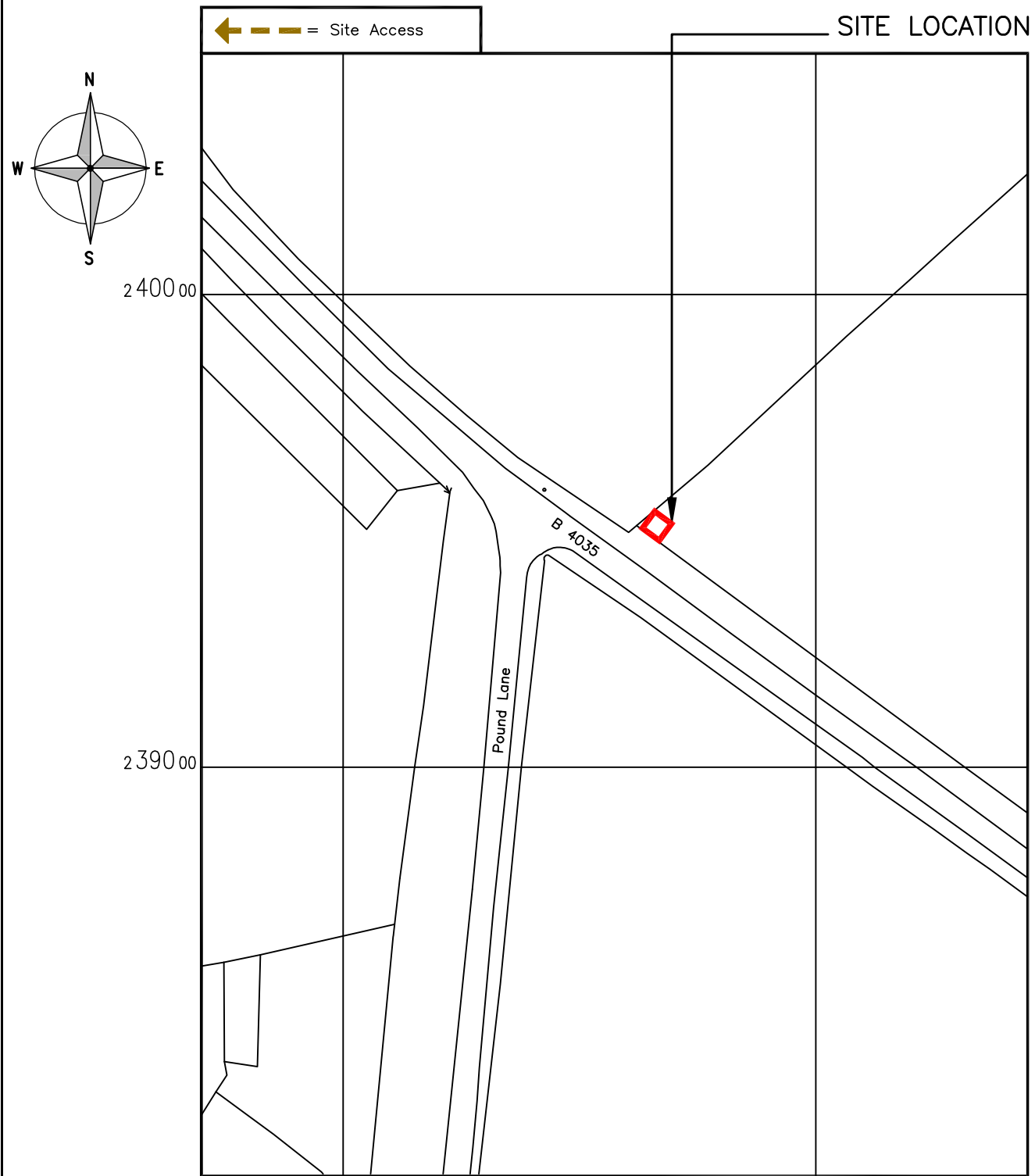

DETAILED SITE LOCATION
(Scale 1:1250)

Based upon Ordnance Survey map extract with the permission of the Controller of Her Majesty's Stationery Office. Crown copyright. Licence No. 100020449

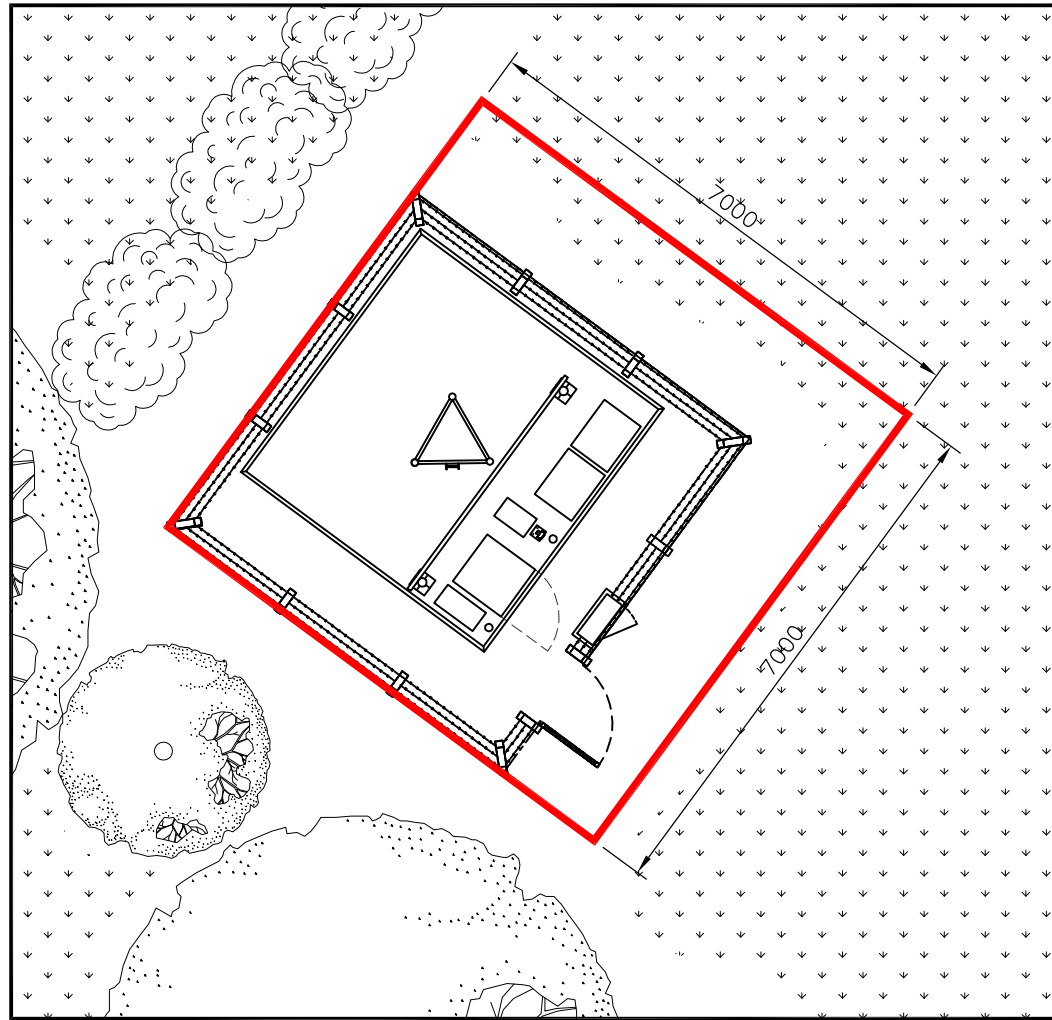
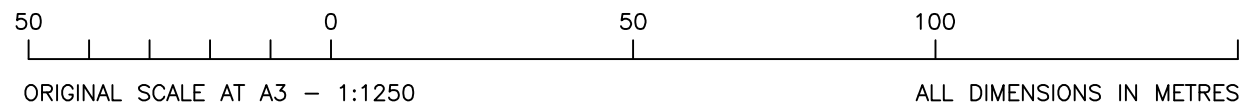
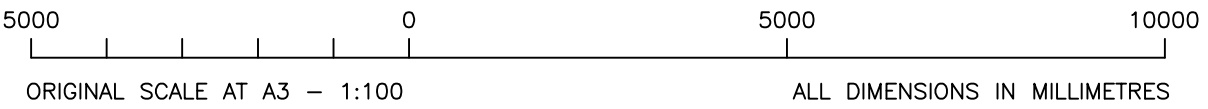

DEMISE PLAN
(1:100)

ALL DIMENSIONS ARE IN mm UNLESS NOTED OTHERWISE

N.G.R | E: 435470 N: 239064

CONCESSION REQUIRED | NO

NOTES:
DRAWINGS TO SCALE WHEN PRINTED AT A3.

A	Issued for Construction	SPD	DS	03.10.17
REV	MODIFICATION	BY	CH	DATE

MCGEE Networks NORTHERN OFFICE, THE MEDIA CENTRE, 7 NORTHUMBERLAND STREET, HUDDERSFIELD, HD1 1RL

NOKIA

O₂
CTIL - BEACON

Cell Name	Opt.
LAND OFF B4035	-

Cell ID No		
CTIL	TEF	VF
201348	074758	N/A

Site Address / Contact Details	
SIBFORD FERRIS OXFORDSHIRE OX156LL	
Drawing Title: LEASE DRAWING	

Purpose of issue:	CONSTRUCTION	Dwg Rev:
Drawing Number:	101	A

Surveyed By:	VC	Original Sheet Size:	A3	Pack Issue:				
Drawn:	SPD	Date:	03.10.17	Checked:	DS	Date:	03.10.17	A

The drawings comply with TEF & Vodafone Standard ICNIRP guidelines.
Designed in accordance with CTIL document: SDN0008

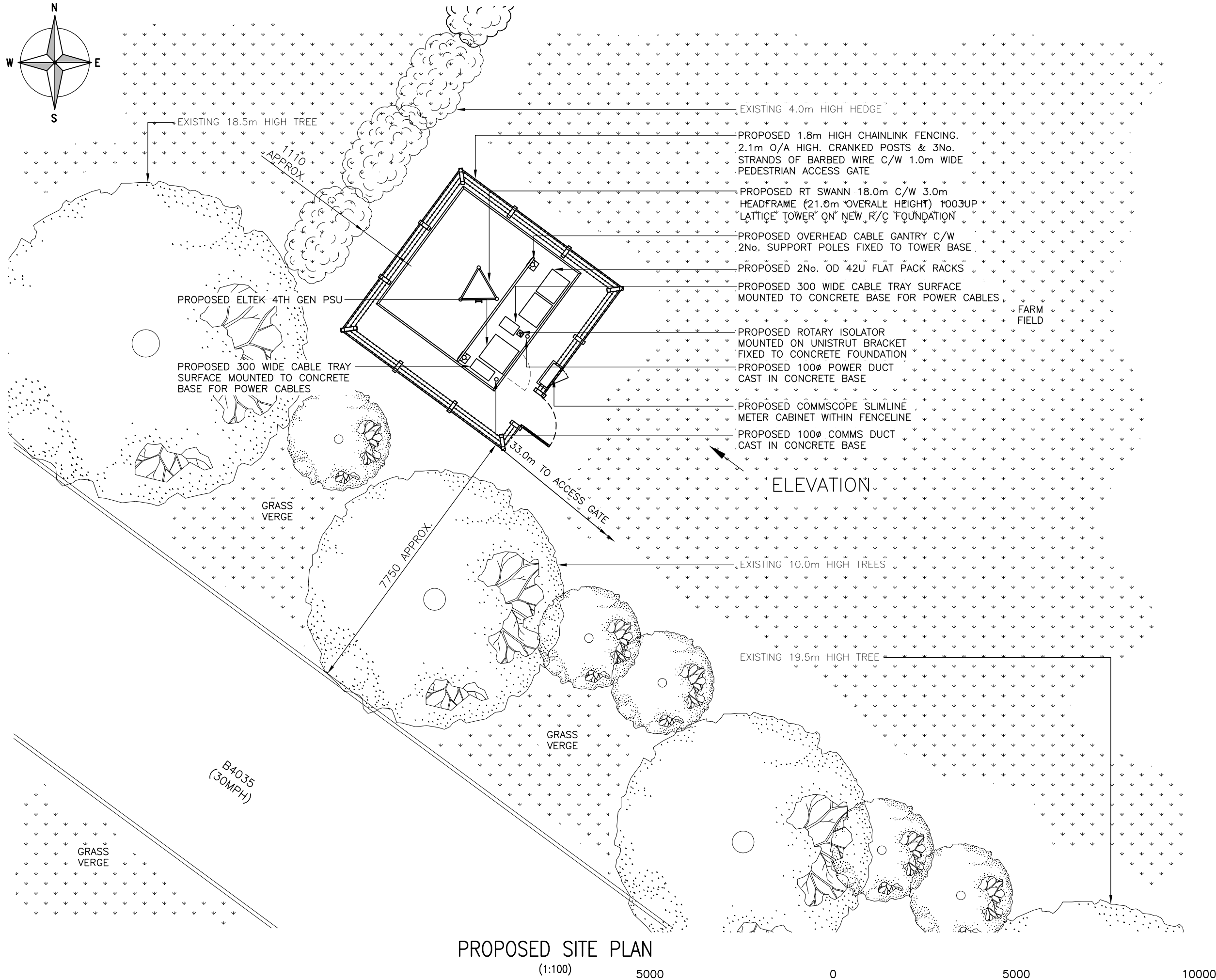

ALL DIMENSIONS ARE IN mm UNLESS NOTED OTHERWISE

N.G.R | E: 435470 N: 239064

CONCESSION REQUIRED | NO

NOTES:

FOR REFERENCE DRAWING DETAILS
PLEASE SEE DRAWING 400

C	Minor Amendment	VC	IJ	30.11.17
B	Minor Amendment	VC	IJ	24.11.17
A	Issued for Construction	SPD	DS	03.10.17

REV	MODIFICATION	BY	CH	DATE
-----	--------------	----	----	------

McGEE Networks
NORTHERN OFFICE,
THE MEDIA CENTRE,
7 NORTHUMBERLAND STREET,
HUDDERSFIELD,
HD1 1RL

NOKIA

O₂

CTIL - BEACON

Cell Name | Opt.

LAND OFF B4035 | -

Cell ID No

CTIL	TEF	VF
201348	074758	N/A

Site Address / Contact Details

SIBFORD FERRIS
OXFORDSHIRE
OX156LL

Drawing Title: PROPOSED SITE PLAN

Purpose of issue: CONSTRUCTION | Dwg Rev:

Drawing Number: 200 | C

Surveyed By: VC | Original Sheet Size: A3 | Pack Issue:

Drawn: SPD | Date: 03.10.17 | Checked: DS | Date: 03.10.17 | A

The drawings comply with TEF & Vodafone Standard ICNIRP guidelines.
Designed in accordance with CTIL document: SDN0008

5000 0 5000 10000
ORIGINAL SCALE AT A3 - 1:100 ALL DIMENSIONS IN MILLIMETRES

ALL DIMENSIONS ARE IN mm UNLESS NOTED OTHERWISE

N.G.R | E: 435470 N: 239064

CONCESSION REQUIRED | NO

NOTES:

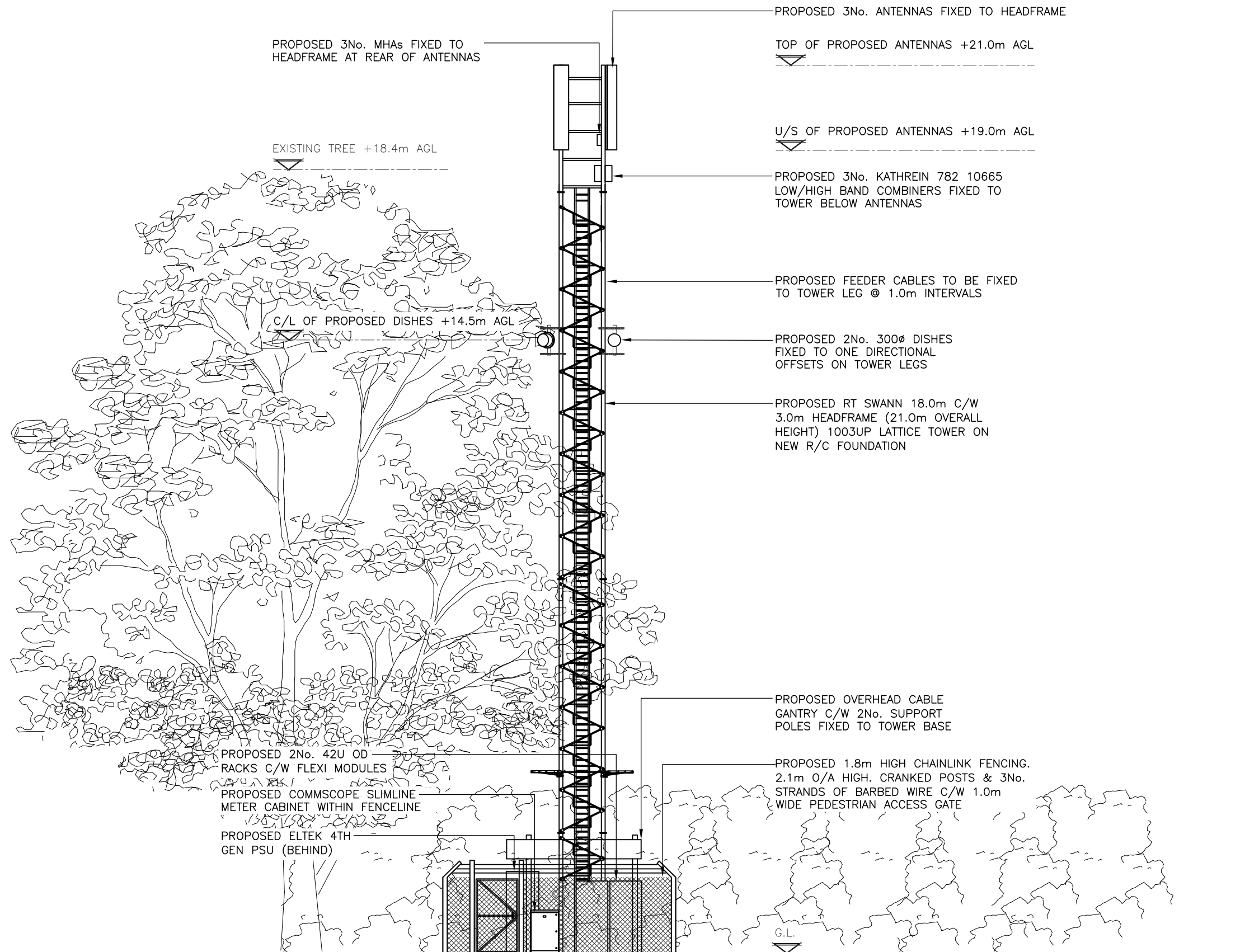

PROPOSED SOUTH EAST ELEVATION

(1:100)



ORIGINAL SCALE AT A3 - 1:100

ALL DIMENSIONS IN MILLIMETRES

The drawings comply with TEF & Vodafone Standard ICNIRP guidelines.
Designed in accordance with CTIL document: SDN0008

REV	MODIFICATION	BY	CH	DATE
B	Config Revised	VC	IJ	22.01.18
B	Minor Ammendment	VC	IJ	30.11.17
A	Issued for Construction	SPD	DS	03.10.17

McGEE Networks
NORTHERN OFFICE,
THE MEDIA CENTRE,
7 NORTHUMBERLAND STREET,
HUDDERSFIELD,
HD1 1RL



CTIL - BEACON

Cell Name | Opt.

LAND OFF B4035 | -

Cell ID No

CTIL | TEF | VF

201348 | 074758 | N/A

Site Address / Contact Details

SIBFORD FERRIS
OXFORDSHIRE
OX156LL

Drawing Title:
PROPOSED SOUTH EAST ELEVATION

Purpose of issue: CONSTRUCTION | Dwg Rev:

Drawing Number: 300 | C

Surveyed By: VC | Original Sheet Size: A3 | Pack Issue:

Drawn: SPD | Date: 03.10.17 | Checked: DS | Date: 03.10.17 | A