

PROPOSED PLAN WITH TEMPORARY USE OF SHED AS ACCOMMODATION FOR CARER LOOKING AFTER OCCUPANT IN MAIN HOUSE

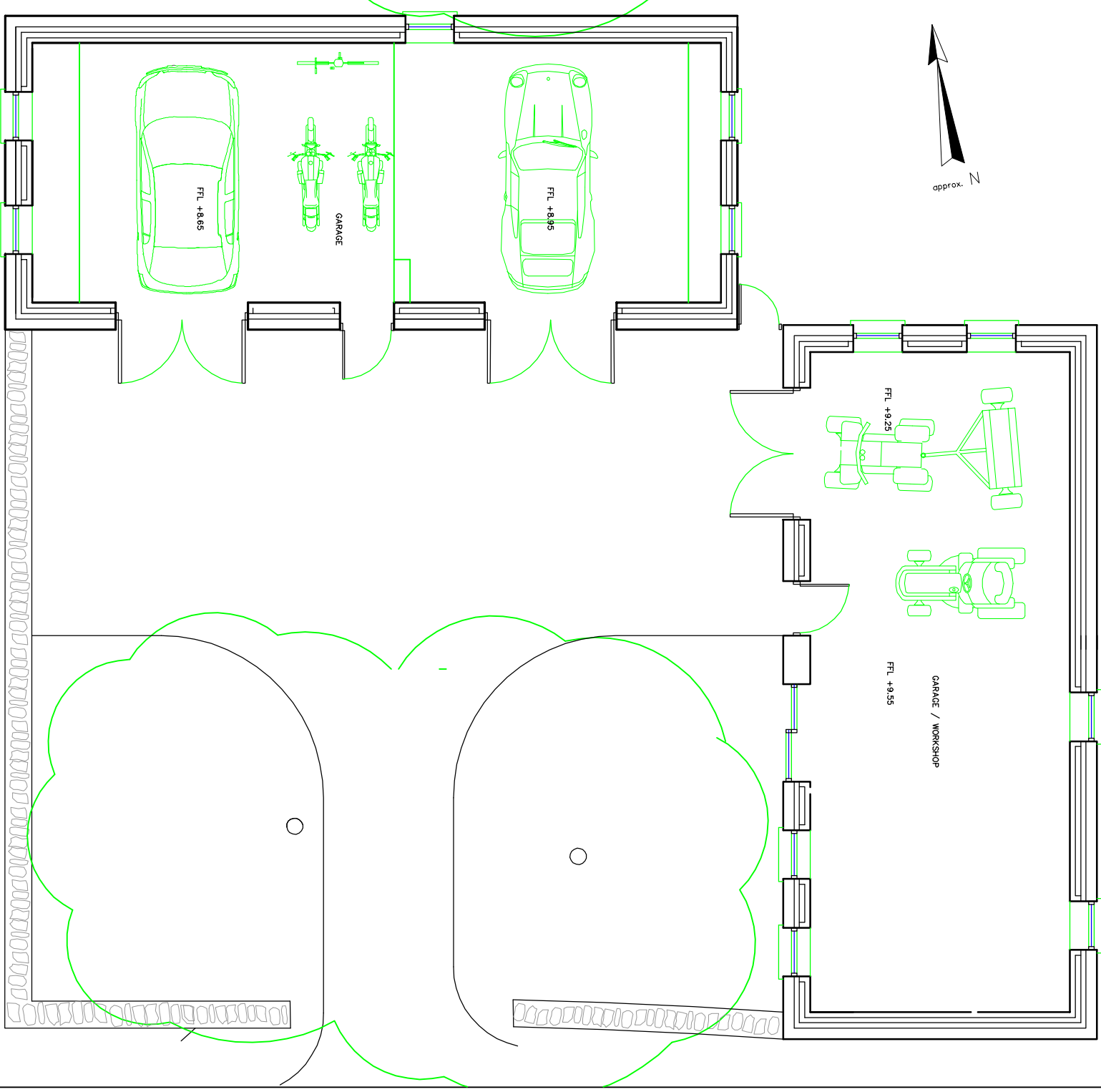

PROPOSED PLAN AS CONSENTED



	<p>© <b>TIM COLQUHOUN ARCHITECTS LTD</b>          SLALEY WOOD, LITTLE LOVESTON, PEMB.S. SA68 0NR          TEL / FAX : 01834 891555          EMAIL: timcolquoun@btinternet.com</p>	<p><b>PROJECT</b>          Handywater House, OX15 5AE          Temporary carers accommodation</p>	<p>DATE          24.07.15</p>	<p>DWG          HW/15/02</p>
	<p>1:100 metres</p>	<p>SCALE          1:100 on A3</p>	<p><b>DRAWING</b>          Existing and proposed floor plans</p>	<p>REVISION</p>
	<p>0 1 2 3 4 5</p>	<p>0 1 2 3 4 5</p>		