

ALL ROAD / DRAINAGE TO COMPLY WITH OCC STANDARD DETAILS & SPECIFICATIONS & DRMB & MCHW

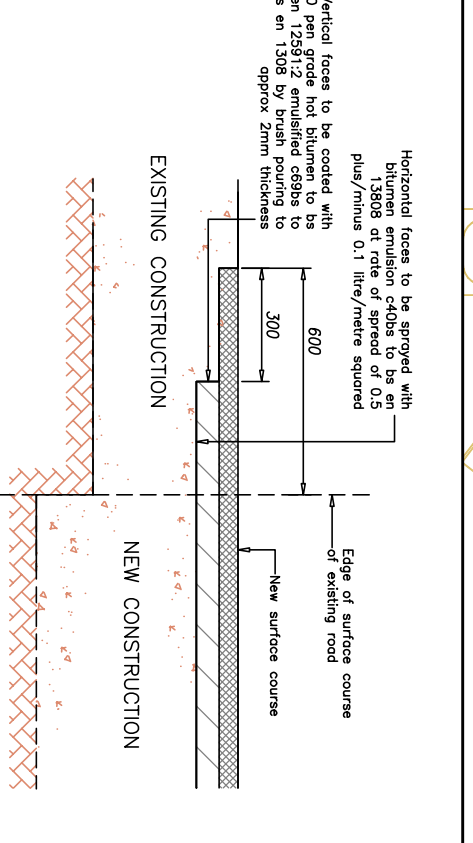
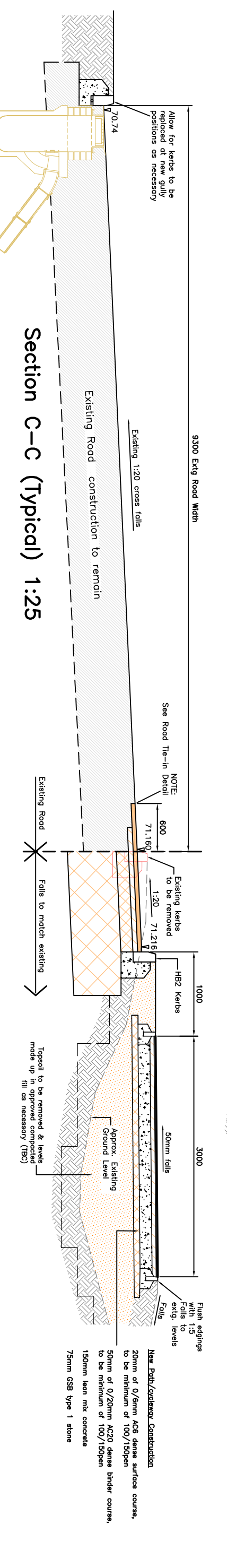
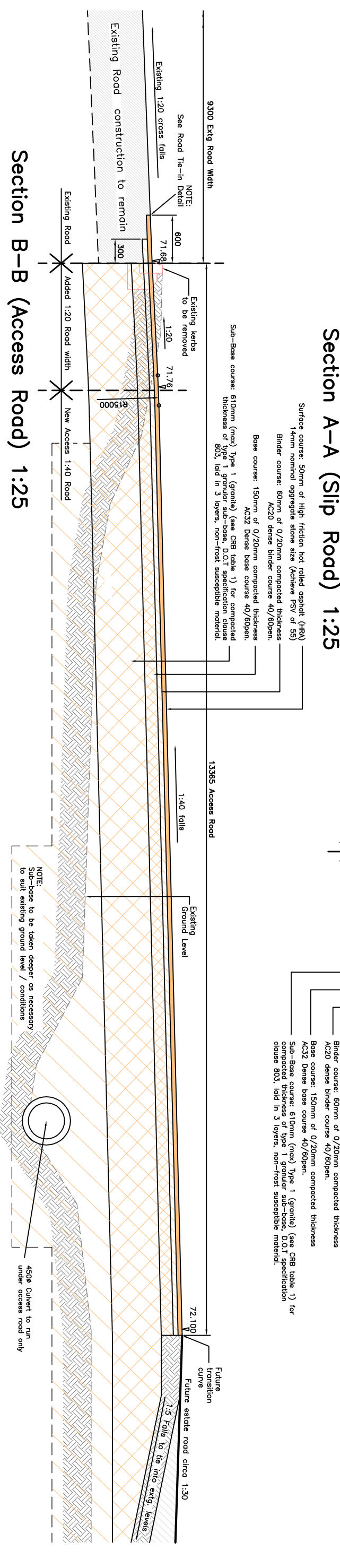
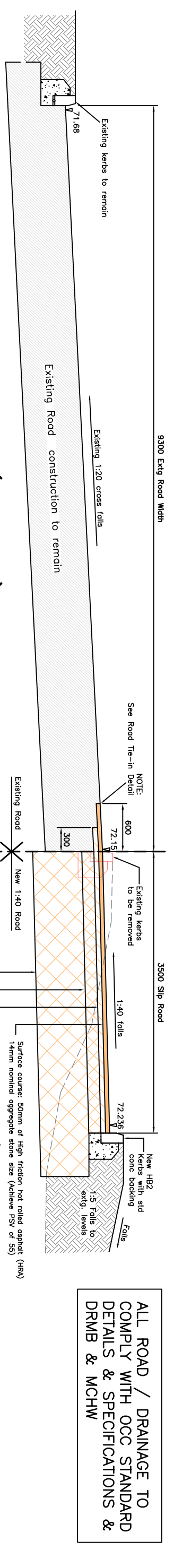

CBR Table 1 (Impermeable Pavements)

NOTE: 1. Oxfordshire County Council require min. 150mm sub-base for permeable road construction, regardless of CBR. 2. Extend of temporary replacement or remedial work to be confirmed, subject to developer and Highway Authority confirmation. In-situ CBR testing required at 30m centres.

Sub-base Thickness (mm)	2	2.5	3	4	5	6	7	8	9	10	12	15	20	30
0														
100														
200														
300														
400														
500														
600														

For low CBR values of <2.5% see Pavement Foundation Notes

Key: Capping/Sub-base Design

Sub-base only Design for flexible and flexible composition pavements, capping not required

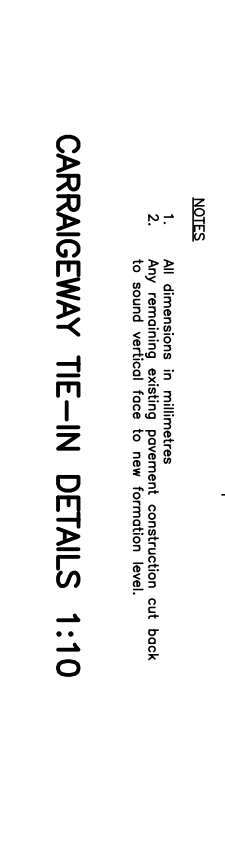

CBR Table 1 (Impermeable Pavements)

NOTE: 1. Oxfordshire County Council require min. 150mm sub-base for permeable road construction, regardless of CBR. 2. Extend of temporary replacement or remedial work to be confirmed, subject to developer and Highway Authority confirmation. In-situ CBR testing required at 30m centres.

Sub-base Thickness (mm)	2	2.5	3	4	5	6	7	8	9	10	12	15	20	30
0														
100														
200														
300														
400														
500														
600														

For low CBR values of <2.5% see Pavement Foundation Notes

Key: Capping/Sub-base Design

Sub-base only Design for flexible and flexible composition pavements, capping not required

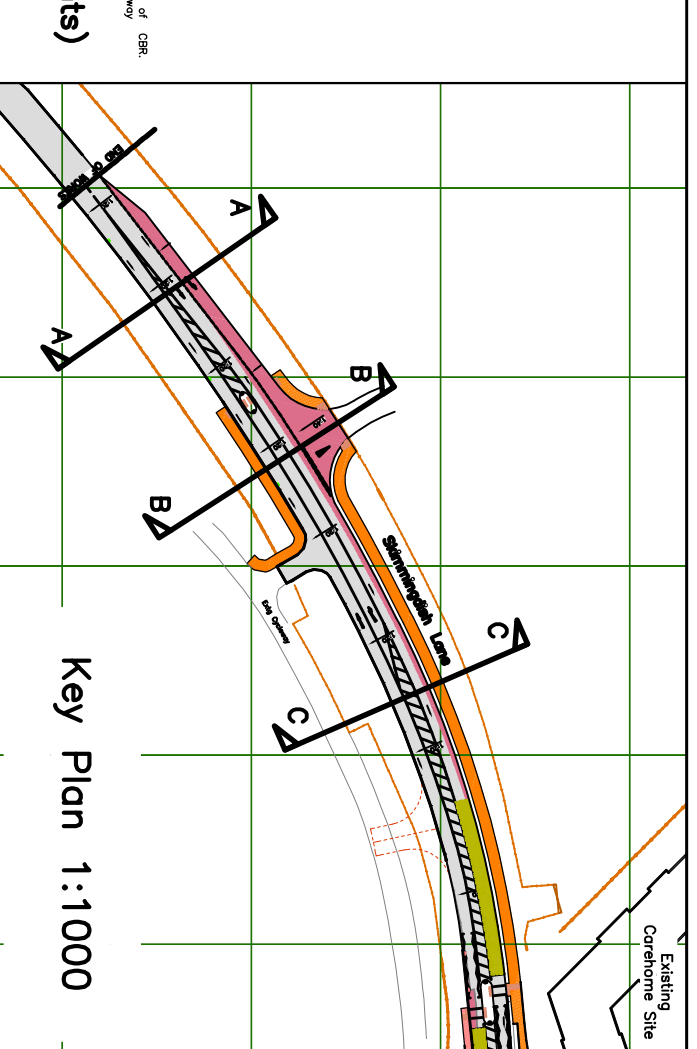

S278 Application

C	23.08.16	Updated to OCC comments (27.07.16)
B	01.07.16	OCC comments
A	24.06.16	Road Safety Audit stage 2

LINK 9

Skimmingdish Lane

Bicester

Albion Land Ltd

Section 278 works

Skimmingdish Lane

Cross Sections

BAILEY JOHNSON HAYES

Consulting Engineers

STABLENS: Site 4, Phoenix House, 63 Campfield Rd, STABLENS, Herts AL1 9TL

MANCHESTER: Orange House, John Dalton Street, MANCHESTER, M2 6RW

Scale: 1:25 @A1

Date: 23.05.16

Drawn: DJC

S1230-S278-07C